

APPLICATION FOR PERMIT TO DRILL OR DEEPEN

1a. TYPE OF WORK

DRILL ☒ DEEPEN ☐

b. TYPE OF WELL

OIL
WELL ☒GAS
WELL ☐OTHER ☐SINGLE
ZONE ☒MULTIPLE
ZONE ☐

2. NAME OF OPERATOR

Rubicon Oil & Gas, LLC

3. ADDRESS AND TELEPHONE NO.

400 West Illinois, Ste. 1130, Midland, Texas 79701 432/687-5100

4. LOCATION OF WELL (Report location clearly and in accordance with any State requirements.)*

At surface

Unit J, 1980' FSL & 1830' FEL

At proposed prod. zone

Same

14. DISTANCE IN MILES AND DIRECTION FROM NEAREST TOWN OR POST OFFICE*

7 Miles N-NE from Loco Hills, New Mexico

15. DISTANCE FROM PROPOSED*

LOCATION TO NEAREST

PROPERTY OR LEASE LINE, FT.

(Also to nearest drilg. unit line, if any)

840' Lse.

840' Unit

18. DISTANCE FROM PROPOSED LOCATION*

TO NEAREST WELL, DRILLING, COMPLETED,
OR APPLIED FOR, ON THIS LEASE, FT.

N/A

16. NO. OF ACRES IN LEASE

40

19. PROPOSED DEPTH

13,000'

17. NO. OF ACRES ASSIGNED
TO THIS WELL

40

20. ROTARY OR CABLE TOOLS

Rotary

21. ELEVATIONS (Show whether DF, RT, GR, etc.)

GR - 3851'

ROSWELL CONTROLLED WATER BASIN

22. APPROX. DATE WORK WILL START*

July 15, 2003

23.

PROPOSED CASING AND CEMENTING PROGRAM

SIZE OF HOLE	GRADE SIZE OF CASING	WEIGHT PER FOOT	SETTING DEPTH	QUANTITY OF CEMENT
17-1/2"	13-3/8", H-40	48#	400' - 475'	450 sx "C" - Circ.
11" WITNESS	8-5/8", J-55	32#	3500'	1500 sx Lite, 200 sx "C" - Circ.
7-7/8"	5-1/2", S-95	17#	Surf. - 1700'	Two Stage Cement - Tool @ 9000'±
	5-1/2", N-80	17#	1700' - 10,800'	1st Stage - 600 sx - ETOC-10,000'±
	5-1/2", S-95	17#	10,800' - 13,000'	2nd Stage - 800 sx - ETOC-3500'±

MUD PROGRAM

INTERVAL	MUD WEIGHT	VISCOSITY	WL CONTROL	COMMENT
0 - 400'	8.6 - 9.0#	32 - 34	N/C	Fresh Water, Gel, Lime
400 - 3500'	10.0 - 10.2#	29 - 30	N/C	Brine Water
3,500 - 10,300'	8.4 - 9.3#	28 - 29	N/C	Fresh Water & Cut Brine
10,300 - 13,000'	9.0 - 9.6#	36 - 40	15 - 8cc	Cut Brine System

BOP PROGRAM

A 13-5/8" - 3000# double ram BOP will be installed on the 13-3/8" casinghead and tested to 1000# with the rig pump. An 11" - 5000# double ram BOP and an 11" - 3000# annular BOP will be installed on the 8-5/8" casing spool. The spool, double ram and choke manifold will be tested to 5000# by a third party certified tester before drilling out 8-5/8" shoe and re-tested to 5000# before drilling below 10,000'. Annular preventer will be tested to 3000# each time BOP stack and manifold is tested.

IN ABOVE SPACE DESCRIBE PROPOSED PROGRAM: If proposal is to deepen, give data on present productive zone and proposed new productive zone. If proposal is to drill or deepen directionally, give pertinent data on subsurface locations and measured and true vertical depths. Give blowout preventer program, if any.

24.

SIGNED

TITLE

Agent APPROVAL SUBJECT TO 5-23-03

(This space for Federal or State office use)

GENERAL REQUIREMENTS
AND SPECIAL STIPULATIONS
ATTACHED

PERMIT NO.

APPROVAL DATE

Application approval does not warrant or certify that the applicant holds legal or equitable title to those rights in the subject lease which would entitle the applicant to conduct operations thereon.
CONDITIONS OF APPROVAL, IF ANY:

/s/ Joe G. Lara

ACTING

FIELD MANAGER

17 JUL 2003

APPROVED BY

TITLE

DATE

*See Instructions On Reverse Side

APPROVAL FOR 1 YEAR

PROPOSED DRILLING PROGRAM

RUBICON OIL & GAS, LLC
HENSHAW FEDERAL "A" #1
1980' FSL & 1830' FEL OF SECTION 14, T16S, R30E
EDDY COUNTY, NEW MEXICO
LEASE NO. NMNM 11814

In conjunction with Form 3160-3, "Application for Permit to Drill" this well, Rubicon Oil & Gas, LLC submits the following items of pertinent information in accordance with BLM requirements:

1. Estimated tops of important geologic markers:

Rustler – 280'	Atoka – 10,370'
Queen – 2300'	Morrow - 10,620'
San Andres - 3020'	Mississippian Lime – 11,150'
Yeso – 4515'	Woodford – 11,665'
Abo – 6520'	Devonian – 11,680'
Pennsylvanian – 8550'	Ellenburger – 12,730'
2. Estimated depths at which the top and bottom of anticipated water, oil, gas or other minerals are expected to be encountered.

Ground Water, Fresh - 50' to 260'	Surface Casing
Oil w/gas – Queen 2300 – 2400'	Intermediate Casing
San Andres 3020 – 4500'	Intermediate & Production Casing
Abo 6520 – 7500'	Production Casing
Gas & Condensate – Atoka 10,370-10,600'	Production Casing
Morrow 10,620 – 11,000'	Production Casing
Devonian 11,680 – 12,000'	Production Casing
Ellenburger 12,730 – 12,900'	Production Casing
3. Pressure Control Equipment:

See Form 3160-3 and Exhibit "B" and Exhibit "C"
4. Proposed Casing Program:

See Form 3160-3

DISTRICT I
P.O. Box 1980, Hobbs, NM 88241-1980

DISTRICT II
P.O. Drawer DD, Artesia, NM 88211-0719

DISTRICT III
1000 Rio Brazos Rd., Aztec, NM 87410

DISTRICT IV
P.O. Box 2088, Santa Fe, N.M. 87504-2088

State of New Mexico
Energy, Minerals and Natural Resources Department

OIL CONSERVATION DIVISION

P.O. Box 2088
Santa Fe, New Mexico 87504-2088

Form C-102
Revised February 10, 1994
Submit to Appropriate District Office
State Lease - 4 Copies
Fee Lease - 3 Copies

WELL LOCATION AND ACREAGE DEDICATION PLAT

☐ AMENDED REPORT

API Number	Pool Code	Pool Name Wildcat
Property Code	Property Name HENSHAW FEDERAL "A"	Well Number 1
OGRID No. 194266	Operator Name RUBICON OIL & GAS LLC	Elevation 3851'

Surface Location

UL or lot No. J	Section 14	Township 16-S	Range 30-E	Lot Idn	Feet from the 1980'	North/South line SOUTH	Feet from the 1830'	East/West line EAST	County EDDY
--------------------	---------------	------------------	---------------	---------	------------------------	---------------------------	------------------------	------------------------	----------------

Bottom Hole Location If Different From Surface

UL or lot No.	Section	Township	Range	Lot Idn	Feet from the	North/South line	Feet from the	East/West line	County
---------------	---------	----------	-------	---------	---------------	------------------	---------------	----------------	--------

Dedicated Acres 40	Joint or Infill	Consolidation Code	Order No.
-----------------------	-----------------	--------------------	-----------

NO ALLOWABLE WILL BE ASSIGNED TO THIS COMPLETION UNTIL ALL INTERESTS HAVE BEEN CONSOLIDATED
OR A NON-STANDARD UNIT HAS BEEN APPROVED BY THE DIVISION

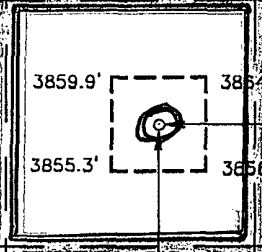
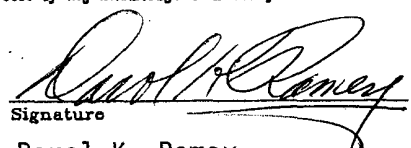
				OPERATOR CERTIFICATION I hereby certify the the information contained herein is true and complete to the best of my knowledge and belief.  Signature Darol K. Ramey Printed Name Agent Title 5-23-03 Date	
				SURVEYOR CERTIFICATION I hereby certify that the well location shown on this plat was plotted from field notes of actual surveys made by me or under my supervision, and that the same is true and correct to the best of my belief. April 28, 2003 Date Surveyed Signature of GARY EIDSON Professional Surveyor RONALD J. EIDSON 5/10/03 03.11.0446 Certificate No. RONALD J. EIDSON 3239 GARY EIDSON 12641	

EXHIBIT "A"
DND

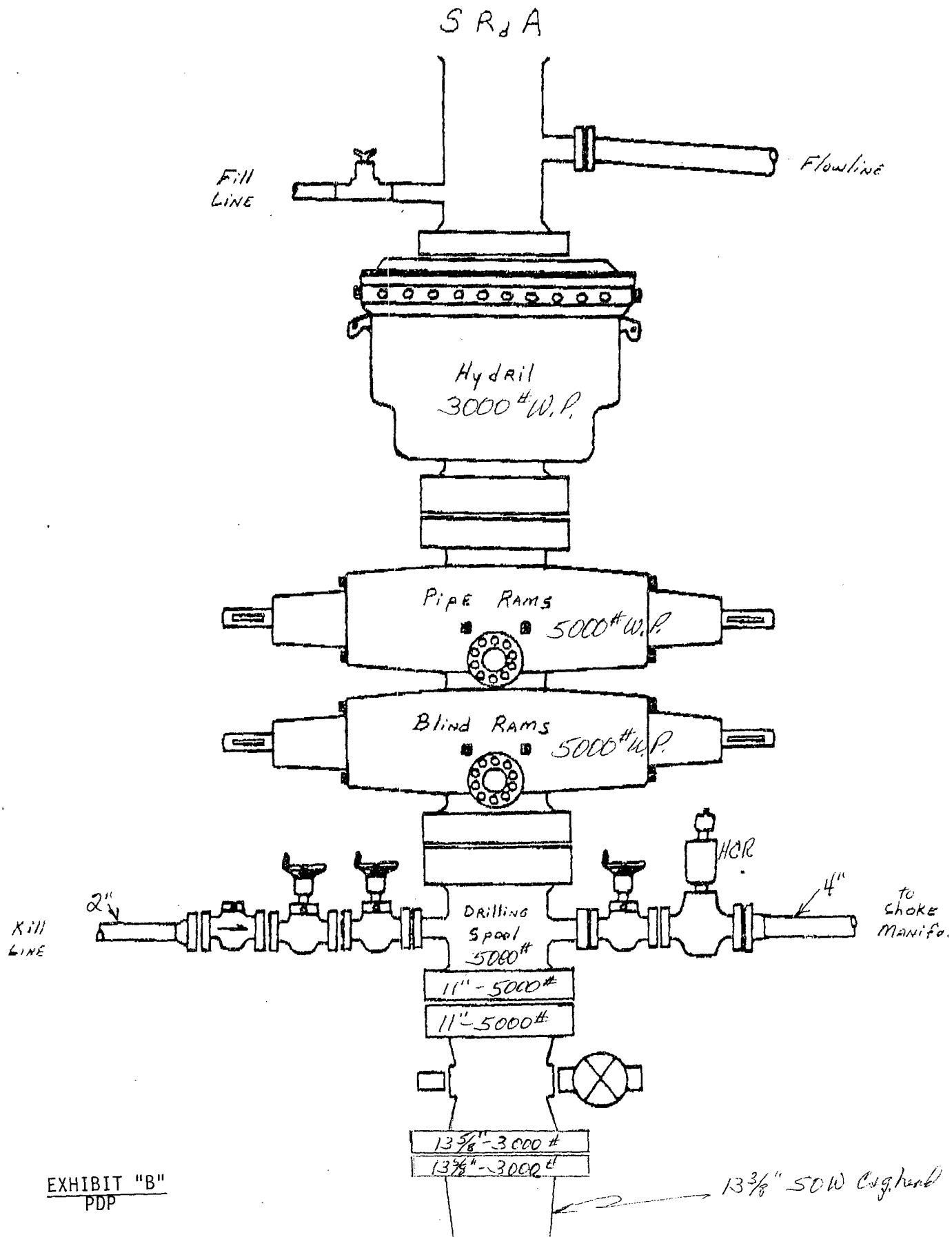


EXHIBIT "B"
PDP

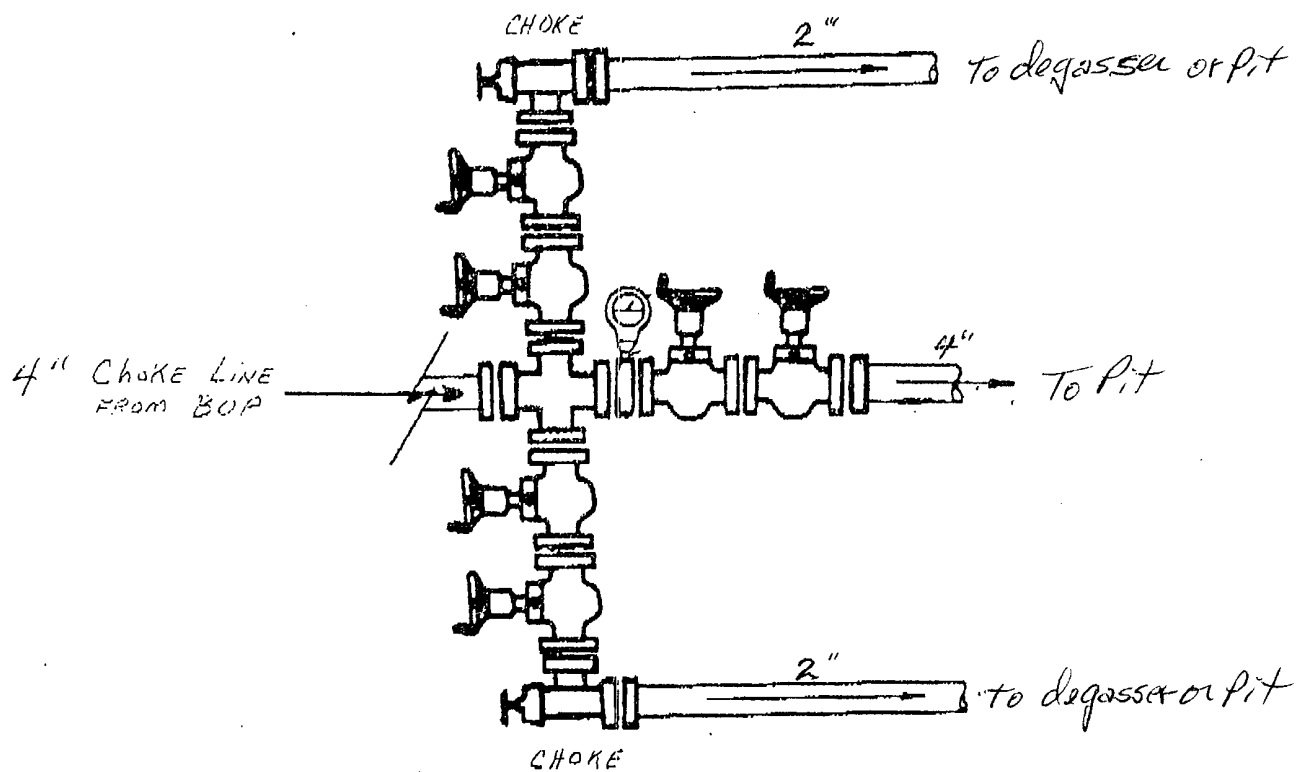


EXHIBIT "C"
PDP