

**NM OIL CONSERVATION  
ARTESIA DISTRICT**

**FEB 06 2019**

Form C-102

Revised August 1, 2011

District I  
1625 N. French Dr., Hobbs, NM 88240  
Phone: (575) 393-6161 Fax: (575) 393-0720  
District II  
811 S. First St., Artesia, NM 88210  
Phone: (575) 748-1283 Fax: (575) 748-9720  
District III  
1000 Rio Brazos Road, Aztec, NM 87410  
Phone: (505) 334-6178 Fax: (505) 334-6170  
District IV  
1220 S. St. Francis Dr., Santa Fe, NM 87505  
Phone: (505) 476-3460 Fax: (505) 476-3462

State of New Mexico  
Energy, Minerals & Natural Resources Department  
**OIL CONSERVATION DIVISION**  
1220 South St. Francis Dr.  
Santa Fe, NM 87505

**RECEIVED**

Submit one copy to appropriate  
District Office

☐ AMENDED REPORT

**WELL LOCATION AND ACREAGE DEDICATION PLAT**

<sup>1</sup> API Number <b>30-015-45682</b>	<sup>2</sup> Pool Code 98220	<sup>3</sup> Pool Name PURPLE SAGE WOLFCAMP GAS POOL
<sup>4</sup> Property Code <b>324950</b>	<sup>5</sup> Property Name BEAGLE 35-34-22-27 FEE	<sup>6</sup> Well Number 401H
<sup>7</sup> OGRID No. 246289	<sup>8</sup> Operator Name RKI EXPLORATION & PRODUCTION, LLC	<sup>9</sup> Elevation 3,079'

<sup>10</sup> Surface Location

UL or lot no.	Section	Township	Range	Lot Idn	Feet from the	North/South line	Feet from the	East/West line	County
L	36	22 S	27 E		2,339	SOUTH	402	WEST	EDDY

<sup>11</sup> Bottom Hole Location If Different From Surface

UL or lot no.	Section	Township	Range	Lot Idn	Feet from the	North/South line	Feet from the	East/West line	County
L	34	22 S	27 E		2,120	SOUTH	230	WEST	EDDY

<sup>12</sup> Dedicated Acres 640 AC S/2	<sup>13</sup> Joint or Infill	<sup>14</sup> Consolidation Code	<sup>15</sup> Order No.
---	-------------------------------	----------------------------------	-------------------------

No allowable will be assigned to this completion until all interests have been consolidated or a non-standard unit has been approved by the division.

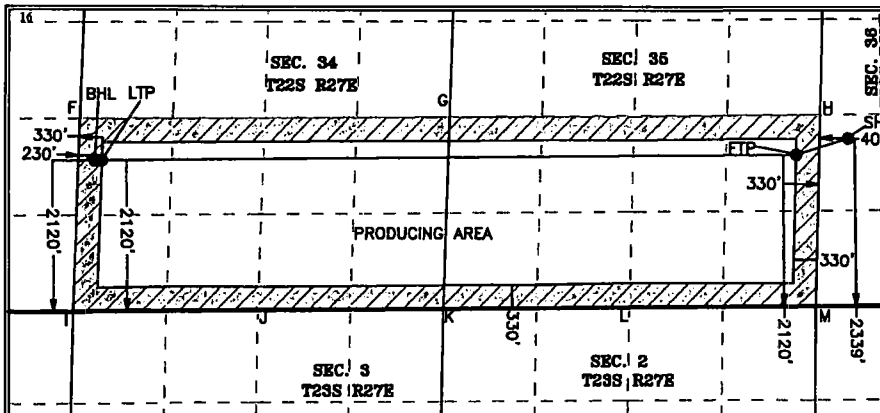

**SURFACE HOLE LOCATION**  
NAD 83 (NME)  
Y= 490,402.6  
X= 597,756.9  
LAT.= 32.348055°N  
LONG.= 104.150635°W  
NAD 27 (NME)  
Y= 490,343.2  
X= 556,575.4  
LAT.= 32.347936°N  
LONG.= 104.150134°W

**LAST TAKE POINT**  
NAD 83 (NME)  
Y= 490,090.1  
X= 587,106.7  
LAT.= 32.347242°N  
LONG.= 104.185124°W  
NAD 27 (NME)  
Y= 490,030.8  
X= 545,925.3  
LAT.= 32.347123°N  
LONG.= 104.184622°W

**FIRST TAKE POINT**  
NAD 83 (NME)  
Y= 490,175.9  
X= 597,019.8  
LAT.= 32.347436°N  
LONG.= 104.153023°W  
NAD 27 (NME)  
Y= 490,116.5  
X= 555,838.3  
LAT.= 32.347318°N  
LONG.= 104.152522°W

**BOTTOM HOLE LOCATION**  
NAD 83 (NME)  
Y= 490,089.2  
X= 587,006.6  
LAT.= 32.347240°N  
LONG.= 104.185448°W  
NAD 27 (NME)  
Y= 490,029.9  
X= 545,825.2  
LAT.= 32.347121°N  
LONG.= 104.184946°W

**<sup>17</sup> OPERATOR CERTIFICATION**

I hereby certify that the information contained herein is true and complete to the best of my knowledge and belief, and that this organization either owns a working interest or unleased mineral interest in the land including the proposed bottom hole location or has a right to drill this well at this location pursuant to a contract with an owner of such a mineral or working interest, or to a voluntary pooling agreement or a compulsory pooling order previously entered by the division.

Signature: *Larry E. Rader*  
Date: 1/15/19  
Printed Name: **Larry E. Rader**  
E-mail Address: **larry.rader@wpxenergy.com**

**<sup>18</sup> SURVEYOR CERTIFICATION**

I hereby certify that the well location shown on this plat was plotted from field notes of actual surveys made by me or under my supervision, and that the same is true and correct to the best of my belief.

01-11-2019

Date of Survey

Signature and Seal of  
Professional Surveyor:

MARK DILLON HARP 23786  
Certificate Number



RR 2018051182

*Rwp 2-6-19*

### 8-3/4" Setting Balanced Cement Plug

	<b>Objective:</b> The objective is to set a 500' balanced plug to plug back the pilot and provide a kickoff 8691' point to drill the curve for a lower wolfcamp A
1	P/U muleshoe, 2-7/8" stinger, and 2-7/8" x 5" S-135 4-1/2" IF XO, float sub and float <ol style="list-style-type: none"><li>Verify stinger and XO have been drifted before RIH</li><li>Verify muleshoe sub is ported around OD</li></ol>
2	TIH to 10100' to set viscous pill. Circulate bottoms up through chokes at 10100' <ol style="list-style-type: none"><li>Verify kelly down for space-out when we pick up out of pill</li></ol>
3	Verify BBL IN/OUT while spotting viscous-weighted pill and cement plug in following steps
4	Pump 5 bbls of viscous-weighted pill ~ 80 visc from slugging pit and displace with 168.75 bbls of mud
5	P/U out of the pill 50-ft, this will place the bottom of the stinger at 8941' which should be the top of the pill.
6	Rig up cementers, test lines to 5,000 psi, and pump job as follows: <ol style="list-style-type: none"><li>Pump 20 bbls fresh water spacer</li><li>Mix and pump 309 sks, 17.5 ppg, 0.9372 ft<sup>3</sup>/sk Class H cement @ 3-4 bpm<ol style="list-style-type: none"><li>Monitor pressure closely as cement approaches and passes through drillpipe float</li></ol></li><li>Displace with 1.28 bbls of FW followed by 144.17 bbls mud from active @ 3-4 bpm<ol style="list-style-type: none"><li>NOTE: Slow down pumps to 2 bpm at 140.17 bbls displaced and pump last 4 bbls of displacement at 2 bpm</li><li>NOTE: Total displacement is 144.17 bbls</li></ol></li></ol>
7	Pull 10 stands at 2 min/stand to place end of stinger at approximately 8011' (430' above TOC)
8	Circulate while full rate rotating and reciprocating pipe verifying drillpipe, stinger, and backside are clear of cement
9	Discuss plan forward with entire team after circulating at least two bottoms up.
10	WOC 24 Hrs before dressing plug