

UNITED STATES  
DEPARTMENT OF THE INTERIOR  
BUREAU OF LAND MANAGEMENT

RECEIVED  
JUN 30 2006  
MAIL ROOM

FORM APPROVED  
OMB No. 1004-0137  
Expires: March 31, 2007

**SUNDRY NOTICES AND REPORTS ON WELLS**

*Do not use this form for proposals to drill or to re-enter an abandoned well. Use Form 3160-3 (APD) for such proposals.*

**SUBMIT IN TRIPLICATE- Other instructions on reverse side.**

1. Type of Well <input checked="" type="checkbox"/> Oil Well <input type="checkbox"/> Gas Well <input type="checkbox"/> Other		5. Lease Serial No. <b>NMNM 63757</b>
2. Name of Operator <b>CHESAPEAKE OPERATING, INC    ATTN: LINDA GOOD</b>		6. If Indian, Allottee or Tribe Name
3a. Address <b>P.O. BOX 18496, OKLAHOMA CITY, OK 73154-0496</b>	3b. Phone No. (include area code) <b>405-767-4275</b>	7. If Unit or CA/Agreement, Name and/or No.
4. Location of Well (Footage, Sec., T., R., M., or Survey Description) <b>410 FNL 1651 FEL, NWNE, SEC 9-24S-31E</b>		8. Well Name and No. <b>Lotos C Federal 907</b>
		9. API Well No.
		10. Field and Pool, or Exploratory Area <b>Cotton Draw; Bonespring, (Oil)</b>
		11. County or Parish, State <b>Eddy County, NM</b>

**12. CHECK APPROPRIATE BOX(ES) TO INDICATE NATURE OF NOTICE, REPORT, OR OTHER DATA**

TYPE OF SUBMISSION	TYPE OF ACTION			
<input type="checkbox"/> Notice of Intent	<input type="checkbox"/> Acidize	<input type="checkbox"/> Deepen	<input type="checkbox"/> Production (Start/Resume)	<input type="checkbox"/> Water Shut-Off
<input checked="" type="checkbox"/> Subsequent Report	<input type="checkbox"/> Alter Casing	<input type="checkbox"/> Fracture Treat	<input type="checkbox"/> Reclamation	<input type="checkbox"/> Well Integrity
<input type="checkbox"/> Final Abandonment Notice	<input type="checkbox"/> Casing Repair	<input type="checkbox"/> New Construction	<input type="checkbox"/> Recomplete	<input type="checkbox"/> Other <b>Final Rig Plat</b>
	<input type="checkbox"/> Change Plans	<input type="checkbox"/> Plug and Abandon	<input type="checkbox"/> Temporarily Abandon	
	<input type="checkbox"/> Convert to Injection	<input type="checkbox"/> Plug Back	<input type="checkbox"/> Water Disposal	

13. Describe Proposed or Completed Operation (clearly state all pertinent details, including estimated starting date of any proposed work and approximate duration thereof. If the proposal is to deepen directionally or recomplate horizontally, give subsurface locations and measured and true vertical depths of all pertinent markers and zones. Attach the Bond under which the work will be performed or provide the Bond No. on file with BLM/BIA. Required subsequent reports must be filed within 30 days following completion of the involved operations. If the operation results in a multiple completion or recompletion in a new interval, a Form 3160-4 must be filed once testing has been completed. Final Abandonment Notices must be filed only after all requirements, including reclamation, have been completed, and the operator has determined that the site is ready for final inspection.)

Please find the attached final rig plat layout for the Lotos C Federal 907.

BLM NATIONWIDE BOND #NM2634.

(CHK PN 610633)

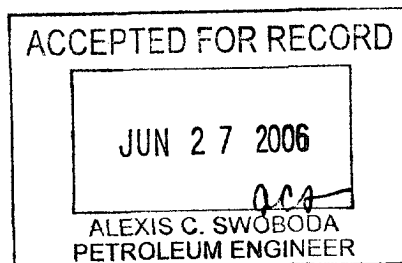

14. I hereby certify that the foregoing is true and correct  
Name (Printed/Typed)

LINDA GOOD

Title PERMITTING AGENT

Signature

*Linda Good*

Date

**THIS SPACE FOR FEDERAL OR STATE OFFICE USE**

Approved by

Conditions of approval, if any, are attached. Approval of this notice does not warrant or certify that the applicant holds legal or equitable title to those rights in the subject lease which would entitle the applicant to conduct operations thereon.

Title

Date

Office

Title 18 U.S.C. Section 1001 and Title 43 U.S.C. Section 1212, make it a crime for any person knowingly and willfully to make to any department or agency of the United States any false, fictitious or fraudulent statements or representations as to any matter within its jurisdiction.

(Instructions on page 2)

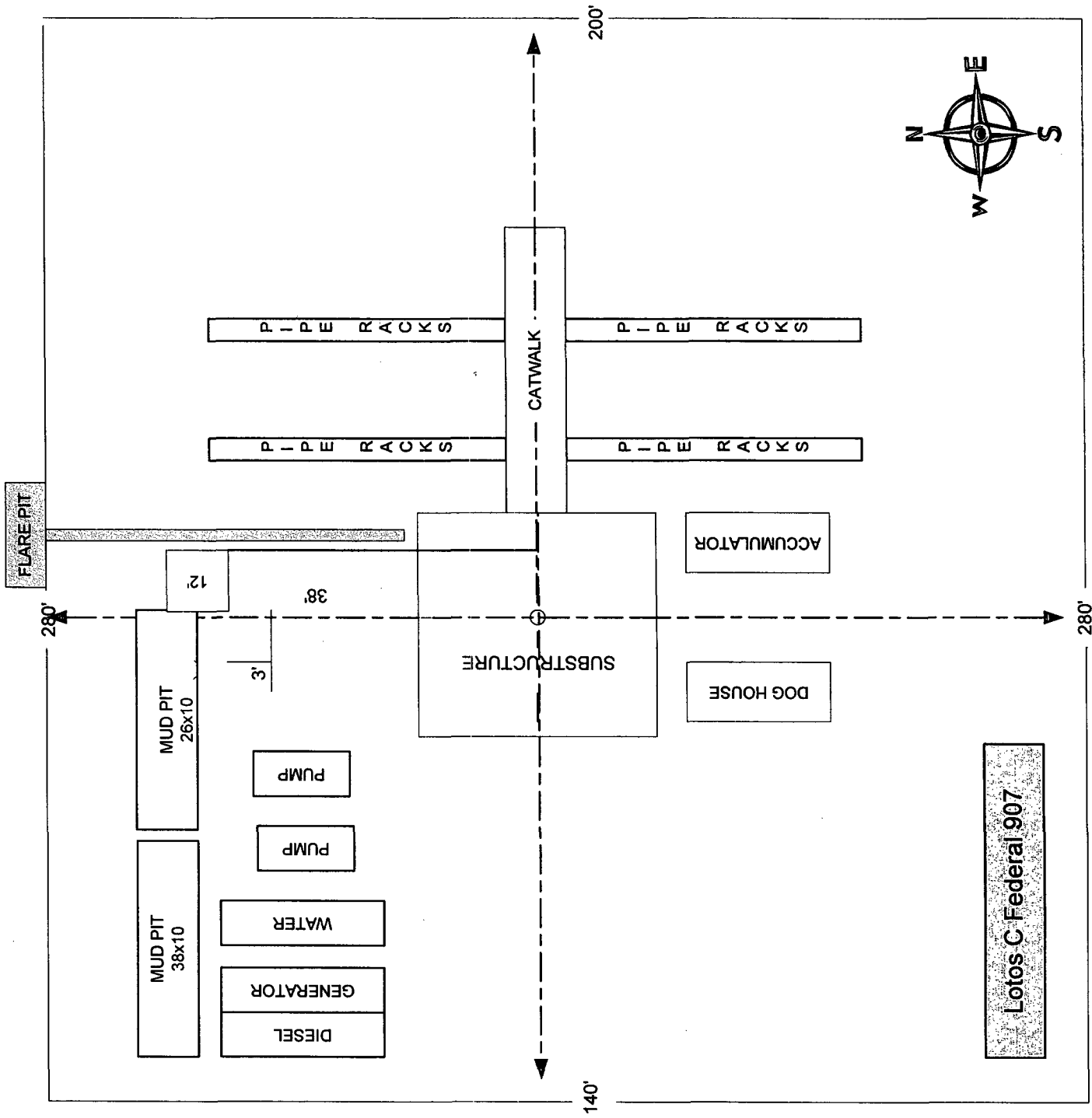

(Prevailing Winds from the North in Winter and from the South in Summer)

PATTERSON RIG #58