

Submit 3 Copies To Appropriate District
Office
District I
1625 N. French Dr., Hobbs, NM 88240
1 W. Grand Ave., Artesia, NM 88210
1000 Rio Pecos Rd., Aztec, NM 87410
1220 S. Francis Dr., Santa Fe, NM
87505

State of New Mexico
Energy, Minerals and Natural Resources

Form C-103
May 27, 2004

OIL CONSERVATION DIVISION
1220 South St. Francis Dr.
Santa Fe, NM 87505

WELL API NO. 30-015-34667
5. Indicate Type of Lease STATE <input type="checkbox"/> FEE <input checked="" type="checkbox"/>
6. State Oil & Gas Lease No.
7. Lease Name or Unit Agreement Name Frio B 8 Fee
8. Well Number 2H
9. OGRID Number 7377
10. Pool name or Wildcat Cottonwood Creek; Wolfcamp (Gas)

SUNDRY NOTICES AND REPORTS ON WELLS
(DO NOT USE THIS FORM FOR PROPOSALS TO DRILL OR TO DEEPEN OR PLUG A WELL TO A DIFFERENT RESERVOIR. USE "APPLICATION FOR PERMIT" (FORM C-101) FOR SUCH PROPOSALS.)

1. Type of Well: Oil Well ☐ Gas Well ☒ Other

2. Name of Operator
EOG Resources, Inc.

3. Address of Operator
P.O. Box 2267 Midland, Texas 79702

4. Well Location

Unit Letter: P: 660 feet from the South line and 760 feet from the East line

Section 8

Township 16S

Range 25E

NMPM

County Eddy

11. Elevation (Show whether DR, RKB, RT, GR, etc.)
3515'

Pit or Below-grade Tank Application ☒ or Closure ☐

Pit type: Ground Depth to Groundwater: 75' Distance from nearest fresh water well: >1,000' Distance from nearest surface water: >1,000'

Pit Liner Thickness: 12 mil Below-Grade Tank: Volume 10,300 bbls; Construction Material: Synthetic

12. Check Appropriate Box to Indicate Nature of Notice, Report or Other Data

NOTICE OF INTENTION TO:

PERFORM REMEDIAL WORK ☐ PLUG AND ABANDON ☐
TEMPORARILY ABANDON ☐ CHANGE PLANS ☒
PULL OR ALTER CASING ☐ MULTIPLE COMPL ☐

OTHER: Change surface location and bottom-hole ☒

SUBSEQUENT REPORT OF:

REMEDIAL WORK ☐ ALTERING CASING ☐
COMMENCE DRILLING OPNS. ☐ P AND A ☐
CASING/CEMENT JOB ☐

OTHER: ☐

13. Describe proposed or completed operations. (Clearly state all pertinent details, and give pertinent dates, including estimated date of starting any proposed work). SEE RULE 1103. For Multiple Completions: Attach wellbore diagram of proposed completion or recompletion.

The surface hole location and bottom hole location have been incorrectly entered on the C-101. Please revise to the following as per the attached C-102.

SURFACE LOCATION: 660' FSL & 760' FEL

BOTTOM HOLE: 660' FNL & 760' FEL

I hereby certify that the information above is true and complete to the best of my knowledge and belief. I further certify that any pit or below-grade tank has been/will be constructed or closed according to NMOCD guidelines X, a general permit ☐ or an (attached) alternative OCD-approved plan ☐.

SIGNATURE Donny G. Glanton TITLE: Agent

DATE: 11/21/2006

Type or print name: Donny G. Glanton E-mail address: donny_glanton@eogresources.com Telephone No. (432) 686-3642

For State Use Only

BRYAN G. ARANT

APPROVED BY: DISTRICT II GEOLOGIST TITLE

Conditions of Approval (if any):

NOV 29 2006
DATE

District I
1625 N. French Dr., Santa Fe, NM 87505
District II
1301 W. Grand Avenue, Santa Fe, NM 87505
District III
1000 Rio Brazos Rd., Santa Fe, NM 87505
District IV
1220 S. St. Francis Dr., Santa Fe, NM 87505

State of New Mexico
Energy, Minerals & Natural Resources Department
OIL CONSERVATION DIVISION
1220 South St. Francis Dr.
Santa Fe, NM 87505

Form C-102
Revised October 12, 2005
Submit to Appropriate District Office
State Lease- 4 Copies
Fee Lease- 3 Copies
AMENDED REPORT

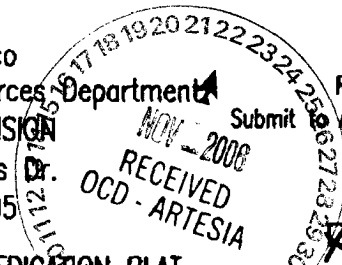

WELL LOCATION AND ACREAGE DEDICATION PLAT

API Number 30-015-34667	Pool Code 75260	Pool Name cottonwood Creek, NE, West (Gas)
Property Code	Property Name FRIO B 8 FEE	Well Number 2H
OGPD No. 7377	Operator Name EOG RESOURCES INC.	Elevation 3515'

Surface Location

UL or lot no.	Section	Township	Range	Lot Idn	Feet from the	North/South line	Feet from the	East/West line	County
P	8	16 SOUTH	25 EAST, N.M.P.M.		660	SOUTH	760	EAST	EDDY

Bottom Hole Location If Different From Surface

UL or lot no.	Section	Township	Range	Lot Idn	Feet from the	North/South line	Feet from the	East/West line	County
A	8	16 SOUTH	25 EAST, N.M.P.M.		660	NORTH	760	EAST	EDDY

Dedicated Acres 320	Joint or Infill	Consolidation Code	Order No.
-------------------------------	-----------------	--------------------	-----------

No allowable will be assigned to this completion until all interests have been consolidated or a non-standard unit has been approved by the division.

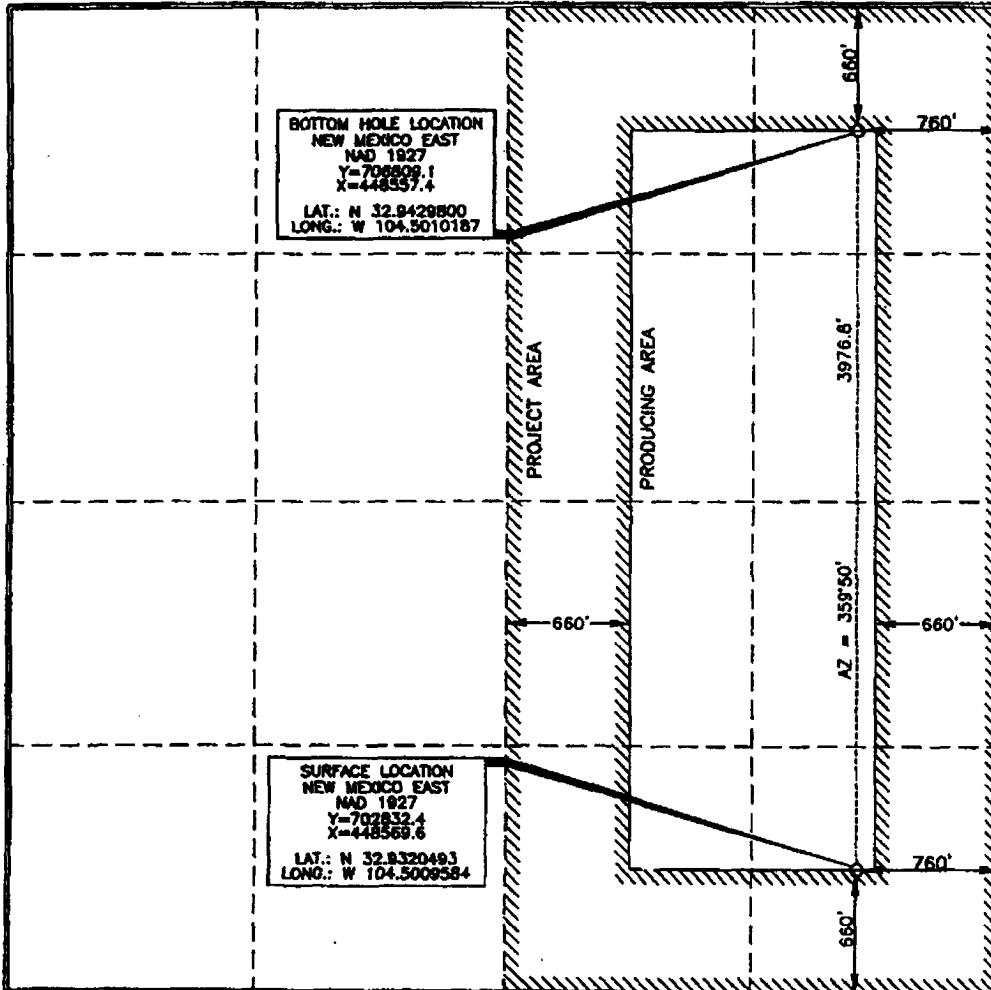

OPERATOR CERTIFICATION

I hereby certify that the information contained herein is true and complete to the best of my knowledge and belief, and that this organization either owns a working interest or unleased mineral interest in the land including the proposed bottom hole location or has a right to drill this well at this location pursuant to a contract with an owner of such a mineral or working interest, or to a voluntary pooling agreement or a compulsory pooling order heretofore entered by the division.

Donny G. Ganton 6/8/06
Signature Date

Donny G. Ganton
Printed Name

SURVEYOR CERTIFICATION

I hereby certify that the well location shown on this plat was plotted from field notes of a duly sworn surveyor by me or under my supervision, and that the same is true and correct to the best of my belief.

15079
Date of Survey
Signature and Seal of Professional Surveyor
Terry J. Carl
Certificate Number 15079

WOP 060603WL-d (A)