

District I

1625 N. French Dr., Hobbs, NM 88240

District II

1301 W. Grand Ave., Artesia, NM 88210

District III

1000 Rio Brazos Rd., Aztec, NM 87410

District IV

1220 S. St. Francis Dr., Santa Fe, NM 87505

State of New Mexico  
Energy, Minerals and Natural Resources

OIL CONSERVATION DIVISION  
1220 South St. Francis Dr.  
Santa Fe, NM 87505

Form C-103  
May 27, 2004

<p><b>SUNDRY NOTICES AND REPORTS ON WELLS</b> (DO NOT USE THIS FORM FOR PROPOSALS TO DRILL OR TO DEEPEN OR PLUG BACK TO A DIFFERENT RESERVOIR. USE "APPLICATION FOR PERMIT" (FORM C-101) FOR SUCH PROPOSALS.)</p>		<p>WELL API NO. 30-005-63849</p>
<p>1. Type of Well: Oil Well <input type="checkbox"/> Gas Well <input checked="" type="checkbox"/> Other <input type="checkbox"/></p>		<p>5. Indicate Type of Lease STATE <input type="checkbox"/> FEE <input checked="" type="checkbox"/></p>
<p>2. Name of Operator MYCO INDUSTRIES, INC.</p>		<p>6. State Oil &amp; Gas Lease No.</p>
<p>3. Address of Operator P.O. BOX 840 ARTESIA, NM 88211-0840</p>		<p>7. Lease Name or Unit Agreement Name MILO 33 FEE</p>
<p>4. Well Location Unit Letter P : 710' feet from the SOUTH line and 186' feet from the EAST line Section 32 Township 15S Range 25E NMPMCHAVES County NM</p>		<p>8. Well Number #1H</p>
<p>11. Elevation (Show whether DR, RKB, RT, GR, etc.) 3459'</p>		<p>9. OGRID Number 015445</p>
<p>Pit or Below-grade Tank Application <input checked="" type="checkbox"/> or Closure <input type="checkbox"/></p>		<p>10. Pool name or Wildcat WILDCAT; WOLFCAMP</p>
<p>Pit type DRILLING Depth to Groundwater 100' Distance from nearest fresh water well &gt;1000' Distance from nearest surface water &gt;1000'</p>		
<p>Pit Liner Thickness: 12 mil Below-Grade Tank: Volume 10100 bbls; Construction Material</p>		

12. Check Appropriate Box to Indicate Nature of Notice, Report or Other Data

NOTICE OF INTENTION TO:

PERFORM REMEDIAL WORK ☐ PLUG AND ABANDON ☐  
TEMPORARILY ABANDON ☐ CHANGE PLANS ☐  
PULL OR ALTER CASING ☐ MULTIPLE COMPL ☐

SUBSEQUENT REPORT OF:

REMEDIAL WORK ☐ ALTERING CASING ☐  
COMMENCE DRILLING OPNS. ☐ P AND A ☐  
CASING/CEMENT JOB ☐

OTHER: ☐

OTHER: LOCATION AND NAME CHANGE ☒

13. Describe proposed or completed operations. (Clearly state all pertinent details, and give pertinent dates, including estimated date of starting any proposed work). SEE RULE 1103. For Multiple Completions: Attach wellbore diagram of proposed completion or recompletion.

12.28.2006

MYCO INDUSTRIES, INC. REQUESTS THAT THE LOCATION FOR THE WELL BE CHANGED TO THE FOLLOWING:

SURFACE: 710' FSL & 186' FEL OF SECTION 32-T15S-R25E  
BOTTOM-HOLE: 710' FSL & 660' FEL OF SECTION 33-T15S-R25E  
(SEE ATTACHED C-102)

MYCO REQUESTS THAT THE NAME OF THE WELL BE CHANGED TO MILO 33 FEE #1H.

\*NOTE: DIRECTIONAL DRILLING SURVEY TO FOLLOW.

I hereby certify that the information above is true and complete to the best of my knowledge and belief. I further certify that any pit or below-grade tank has been/will be constructed or closed according to NMOC guidelines ☐, a general permit ☒ or an (attached) alternative OCD-approved plan ☐.

SIGNATURE Hannah Palomin TITLE ENGR/LAND TECH DATE 12/28/2006

Type or print name HANNAH PALOMIN

E-mail address: hannah@mycoinc.com

Telephone No. (505)748-4288

For State Use Only

BRYAN G. ARANT

APPROVED BY: DISTRICT II GEOLOGIST TITLE

DATE JAN 03 2007

## DISTRICT I

1625 N. FRENCH DR., HOBBS, NM 88240

## DISTRICT II

1301 W. GRAND AVENUE, ARTESIA, NM 88210

## DISTRICT III

1000 Rio Brazos Rd., Aztec, NM 87410

## DISTRICT IV

1220 S. ST. FRANCIS DR., SANTA FE, NM 87505

## State of New Mexico

Energy, Minerals and Natural Resources Department

OIL CONSERVATION DIVISION  
1220 SOUTH ST. FRANCIS DR.  
Santa Fe, New Mexico 87505

Form C-102

Revised October 12, 2005

Submit to Appropriate District Office

State Lease - 4 Copies

Fee Lease - 3 Copies

## WELL LOCATION AND ACREAGE DEDICATION PLAT

☐ AMENDED REPORT

API Number		Pool Code		Well Name	
Property Code	Property Name MILO 33 FEE				Well Number 1
OGRID No.	Operator Name MYCO INDUSTRIES, INC.				Elevation 3459'

## Surface Location

UL or lot No.	Section	Township	Range	Lot Idn	Feet from the	North/South line	Feet from the	East/West line	County
P	32	15-S	25-E		710	SOUTH	186	EAST	CHAVES

## Bottom Hole Location If Different From Surface

UL or lot No.	Section	Township	Range	Lot Idn	Feet from the	North/South line	Feet from the	East/West line	County
P	33	15-S	25-E		710	SOUTH	660	EAST	CHAVES

Dedicated Acres	Joint or Infill	Consolidation Code	Order No.
320			

NO ALLOWABLE WILL BE ASSIGNED TO THIS COMPLETION UNTIL ALL INTERESTS HAVE BEEN CONSOLIDATED  
OR A NON-STANDARD UNIT HAS BEEN APPROVED BY THE DIVISION

SCALE - 1"=2000'

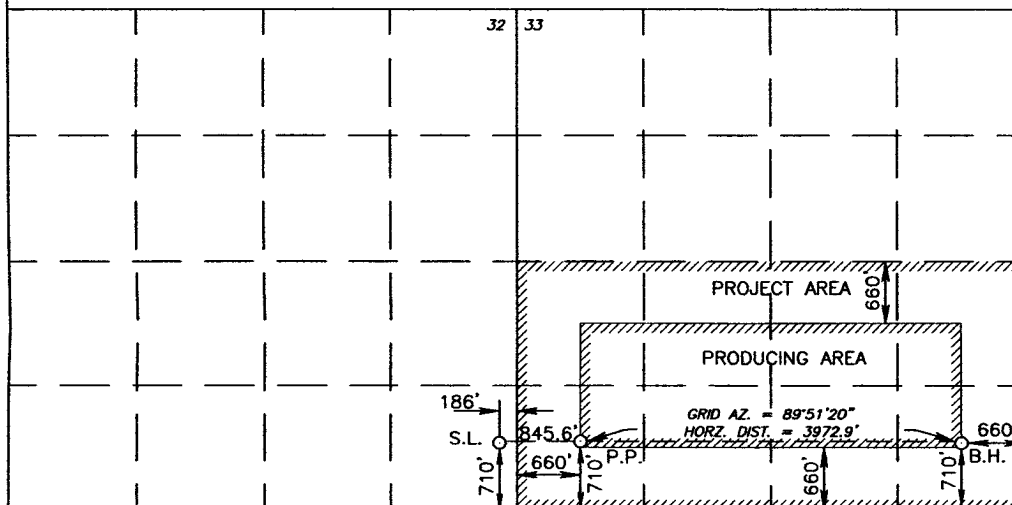

## OPERATOR CERTIFICATION

I hereby certify that the information herein is true and complete to the best of my knowledge and belief, and that this organization either owns a working interest or unleased mineral interest in the land including the proposed bottom hole location or has a right to drill this well at this location pursuant to a contract with an owner of such mineral or working interest, or to a voluntary pooling agreement or a compulsory pooling order heretofore entered by the division.

*[Signature]* 12.28.06  
Signature Date  
STARRI HODGES  
Printed Name

## SURVEYOR CERTIFICATION

I hereby certify that the well location shown on this plat was plotted from field notes of actual surveys made by me or under my supervision, and that the same is true and correct to the best of my belief.

DECEMBER 13, 2006

Date Surveyed LA REV: 12/21/06  
Signature & Seal of Professional Surveyor

*[Signature]* 12/21/06  
06.11.1942

Certificate No. GARY EIDSON 12641

GEODETIC COORDINATES  
NAD 27 NME  
SURFACE HOLE LOCATION  
Y=715226.7 N  
X=462261.0 E

LAT.=32.966169° N  
LONG.=104.456382° W

PENETRATION POINT  
Y=715228.8 N  
X=463106.4 E

BOTTOM HOLE LOCATION  
Y=715238.8 N  
X=467078.2 E  
LAT.=32.966217° N  
LONG.=104.440675° W