

UNITED STATES  
DEPARTMENT OF THE INTERIOR  
BUREAU OF LAND MANAGEMENT

OCD-ARTESIA

FORM APPROVED  
OM B No. 1004-0137  
Expires: March 31, 2007

## SUNDRY NOTICES AND REPORTS ON WELLS

Do not use this form for proposals to drill or to re-enter an abandoned well. Use Form 3160-3 (APD) for such proposals.

SUBMIT IN TRIPLICATE- Other instructions on reverse side.

1. Type of Well

☐

Oil Well

☒

Gas Well

☐

Other

2. Name of Operator

EOG RESOURCES, INC.

3a. Address

P.O. Box 2267 Midland, Texas 79702

3b. Phone No. (include area code)

432 686 3642

4. Location of Well (Footage, Sec., T., R., M., or Survey Description)

2072' FSL &amp; 1705' FWL of Section 24, T17S - R30E, N.M.P.M.

5. Lease Serial No.

NM2747(S/L); NM74939; LC055264

6. If Indian, Allottee or Tribe Name

7. If Unit or CA/Agreement, Name and/or No.

8. Well Name and No.

Burnett Oil 24 Fed Com No. 3

9. API Well No.

30-015-35418

10. Field and Pool, or Exploratory Area

Cedar Lake Morrow (74560)

11. County or Parish, State

Eddy, New Mexico

## 12. CHECK APPROPRIATE BOX(ES) TO INDICATE NATURE OF NOTICE, REPORT, OR OTHER DATA

TYPE OF SUBMISSION	TYPE OF ACTION			
<input type="checkbox"/> Notice of Intent	<input type="checkbox"/> Acidize	<input type="checkbox"/> Deepen	<input type="checkbox"/> Production (Start/Resume)	<input type="checkbox"/> Water Shut-Off
<input type="checkbox"/> Subsequent Report	<input type="checkbox"/> Alter Casing	<input type="checkbox"/> Fracture Treat	<input type="checkbox"/> Reclamation	<input type="checkbox"/> Well Integrity
<input type="checkbox"/> Final Abandonment Notice	<input type="checkbox"/> Casing Repair	<input type="checkbox"/> New Construction	<input type="checkbox"/> Recomplete	<input checked="" type="checkbox"/> Other CHANGE SHL
	<input checked="" type="checkbox"/> Change Plans	<input type="checkbox"/> Plug and Abandon	<input type="checkbox"/> Temporarily Abandon	
	<input type="checkbox"/> Convert to Injection	<input type="checkbox"/> Plug Back	<input type="checkbox"/> Water Disposal	

13. Describe Proposed or Completed Operation (clearly state all pertinent details, including estimated starting date of any proposed work and approximate duration thereof. If the proposal is to deepen directionally or recompleat horizontally, give subsurface locations and measured and true vertical depths of all pertinent markers and zones. Attach the Bond under which the work will be performed or provide the Bond No. on file with BLM/BIA. Required subsequent reports must be filed within 30 days following completion of the involved operations. If the operation results in a multiple completion or recompleat in a new interval, a Form 3160-4 must be filed once testing has been completed. Final Abandonment Notices must be filed only after all requirements, including reclamation, have been completed, and the operator has determined that the site is ready for final inspection.)

EOG Resources, Inc. (EOG) discovered two buried pipelines which would have interfered with the construction of the well pad as per the APD approved on 2/3/2007.

Therefore, EOG has moved the surface hole location as per the Amended C-102 attached hereto. Pursuant to the move, the location will V-Door SE (pit positioned NE).

14. I hereby certify that the foregoing is true and correct  
Name (Printed/Typed)

Donny G. Glanton

Title Senior Lease Operations ROW Representative

Signature

Date

02/09/2007

## THIS SPACE FOR FEDERAL OR STATE OFFICE USE

Approved by

Conditions of approval, if any, are attached. Approval of this notice does not warrant or certify that the applicant holds legal or equitable title to those rights in the subject lease which would entitle the applicant to conduct operations thereon.

Title

FIELD MANAGER

Date

Office

CARLSBAD FIELD OFFICE

Title 18 U.S.C. Section 1001 and Title 43 U.S.C. Section 1212, make it a crime for any person knowingly and willfully to make to any department or agency of the United States any false, fictitious or fraudulent statements or representations as to any matter within its jurisdiction.

(Instructions on page 2)

District I  
1625 N. French Dr., Hobbs, NM 88240  
District II  
1301 W. Grand Avenue, Artesia, NM 88210  
District III  
1000 Rio Brazos Rd., Aztec, NM 87410  
District IV  
1220 S. St. Francis Dr., Santa Fe, NM 87505

State of New Mexico  
Energy, Minerals & Natural Resources Department  
OIL CONSERVATION DIVISION  
1220 South St. Francis Dr.  
Santa Fe, NM 87505

Form C-102  
Revised October 12, 2005  
Submit to Appropriate District Office  
State Lease- 4 Copies  
Fee Lease- 3 Copies

☒ AMENDED REPORT

WELL LOCATION AND ACREAGE DEDICATION PLAT

API Number	Pool Code 74560	Pool Name CEDAR LAKE MORROW, Gas
Property Code	Property Name BURNETT OIL 24 FED. COM	Well Number 3
GRID No. 7377	Operator Name EOG RESOURCES INC.	Elevation 3690'

Surface Location

UL or lot no. K	Section 24	Township 17 SOUTH	Range 30 EAST, N.M.P.M.	Lot Idn	Feet from the 2072'	North/South line SOUTH	Feet from the 1705'	East/West line WEST	County EDDY
--------------------	---------------	----------------------	----------------------------	---------	------------------------	---------------------------	------------------------	------------------------	----------------

Bottom Hole Location If Different From Surface

UL or lot no.	Section	Township	Range	Lot Idn	Feet from the	North/South line	Feet from the	East/West line	County
---------------	---------	----------	-------	---------	---------------	------------------	---------------	----------------	--------

Dedicated Acres 320	Joint or Infill	Consolidation Code	Order No.
------------------------	-----------------	--------------------	-----------

No allowable will be assigned to this completion until all interests have been consolidated or a non-standard unit has been approved by the division.

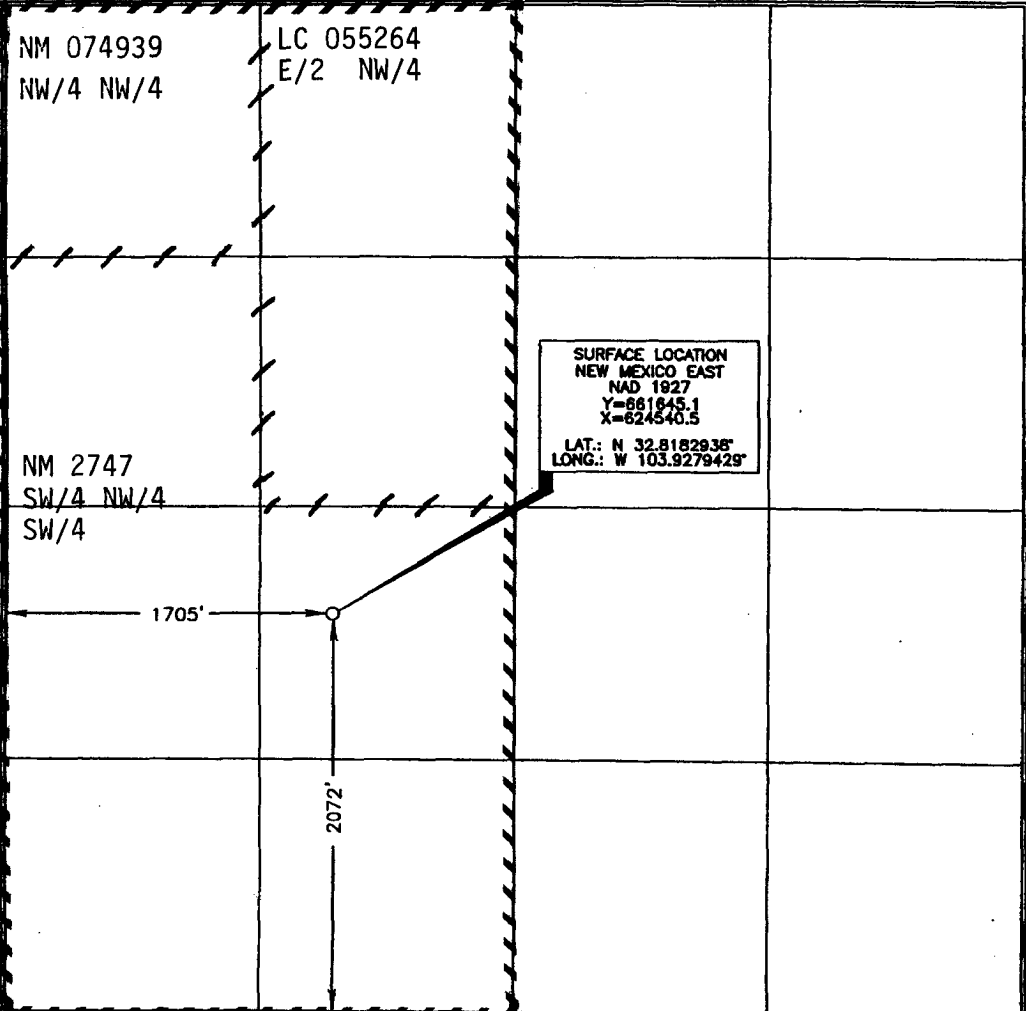
	<b>OPERATOR CERTIFICATION</b> I hereby certify that the information contained herein is true and complete to the best of my knowledge and belief, and that this organization either owns a working interest or unleased mineral interest in the land including the proposed bottom hole location or has a right to drill this well at this location pursuant to a contract with an owner of such a mineral or working interest, or to a voluntary pooling agreement or a compulsory pooling order heretofore entered by the division. <i>Dmy S. Mch</i> 2/9/07 Signature Date <i>Donny G. Glanton</i> Printed Name
	<b>SURVEYOR CERTIFICATION</b> I hereby certify that the well location shown on this plat was plotted from field notes or other surveys made by me or under my supervision, and that the same is true and correct to the best of my belief. FEBRUARY 08, 2007 Date of Survey Signature and Seal of Professional Surveyor <i>Terry G. Deel</i> 2/9/2007 Certificate Number 15079

NE

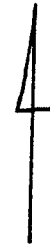

Burnett Oil 24 Fed Com 3

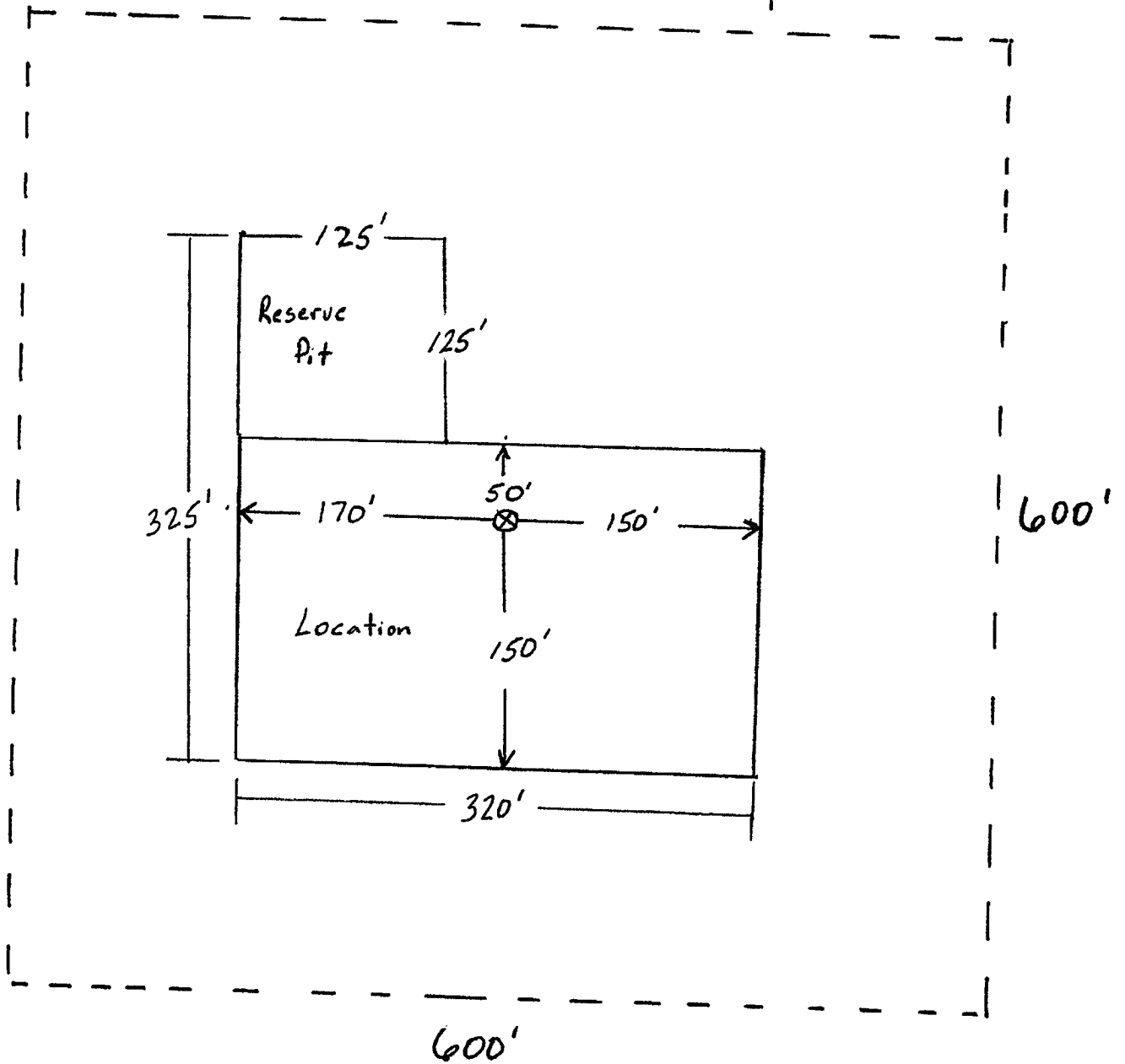

# SPECIAL DRILLING STIPULATIONS

## THE FOLLOWING DATA IS REQUIRED ON THE WELL SIGN

Operator's Name: EOG Resources, Inc. Well Name & #: Burnett Oil 24 Fed. Com. #3  
 Location 2072 F S L & 1705 F W L; Sec. 24, T. 17 S., R. 30 E.  
 Lease #: NM-2747 County: Eddy State: New Mexico

The Special stipulations check marked below are applicable to the above described well and approval of this application to drill is conditioned upon compliance with such stipulations in addition to the General Requirements. The permittee should be familiar with the General Requirements, a copy of which is available from a Bureau of Land Management office. EACH PERMITTEE HAS THE RIGHT OF ADMINISTRATIVE APPEAL TO THESE STIPULATIONS PURSUANT TO TITLE 43 CFR 3165.3 AND 3165.4.

This permit is valid for a period of one year from the date of approval or until lease expiration or termination whichever is shorter.

### I. SPECIAL ENVIRONMENT REQUIREMENTS

- ( ☒ ) Lesser Prairie Chicken (stips attached) ( ) Flood plain (stips attached)  
 ( ) San Simon Swale (stips attached) ( ) Other

### II. ON LEASE - SURFACE REQUIREMENTS PRIOR TO DRILLING

- ( ☒ ) The BLM will monitor construction of this drill site. Notify the ( ☒ ) Carlsbad Field Office at (505) 234-5972 ( ) Hobbs Office (505) 393-3612, at least 3 working days prior to commencing construction.
- ( ☒ ) Roads and the drill pad for this well must be surfaced with 6 inches of compacted caliche upon completion of well and it is determined to be a producer.
- ( ) All topsoil and vegetation encountered during the construction of the drill site area will be stockpiled and made available for resurfacing of the disturbed area after completion of the drilling operation. Topsoil on the subject location is approximately \_\_\_\_\_ inches in depth. Approximately \_\_\_\_\_ cubic yards of topsoil material will be stockpiled for reclamation.
- ( ☒ ) Other. **V-Door East (Reserve pits to the East).**

### III. WELL COMPLETION REQUIREMENTS

- ( ) A Communitization Agreement covering the acreage dedicated to the well must be filed for approval with the BLM. The effective date of the agreement must be prior to any sales.
- ( ☒ ) Surface Restoration: If the well is a producer, the reserve pit(s) will be backfilled when dry, and cut-and-fill slopes will be reduced to a slope of 3:1 or less. All areas of the pad not necessary for production must be re-contoured to resemble the original contours of the surrounding terrain, and topsoil must be re-distributed and re-seeded with a drill equipped with a depth indicator (set at depth of 1/2 inch) with the following seed mixture, in pounds of Pure Live Seed (PLS), per acre. If broadcasting, the seeding rate must be doubled.
- |   |   |
|---|---|
| ( ) A. Seed Mixture 1 (Loamy Sites)                     | ( <input checked="" type="checkbox"/> ) B. Seed Mixture 2 (Sandy Sites) |
| Side Oats Grama ( <i>Bouteloua curtipendula</i> ) 5.0   | Sand Dropseed ( <i>Sporobolus cryptandrus</i> ) 1.0                     |
| Sand Dropseed ( <i>Sporobolus cryptandrus</i> ) 1.0     | Sand Lovegrass ( <i>Eragrostis trichodes</i> ) 1.0                      |
| Plains lovegrass ( <i>Eragrostis intermedia</i> ) 0.5   | Plains Bristlegrass ( <i>Setaria magrostachya</i> ) 2.0                 |
| ( ) C. Seed Mixture 3 (Shallow Sites)                   | ( ) D. Seed Mixture 4 (Gypsum Sites)                                    |
| Side oats Grama ( <i>Bouteloua curtipendula</i> ) 5.0   | Alkali Sacaton ( <i>Sporobolus airoides</i> ) 1.0                       |
| Green Spangletop ( <i>Leptochloa dubia</i> ) 2.0        | Four-Wing Saltbush ( <i>Atriplex canescens</i> ) 5.0                    |
| Plains Bristlegrass ( <i>Setaria magrostachya</i> ) 1.0 |   |

### ( ) OTHER SEE ATTACHED SEED MIXTURE

Seeding should be done either late in the fall (September 15 - November 15, before freeze up, or early as possible the following spring to take advantage of available ground moisture.

### Painting Requirement:

All above-ground structures including meter housing that are not subject to safety requirements shall be painted a flat non-reflective paint color, shale green, Munsell Soil Color Chart Number 5Y 4/2.

- ( ) Other

#### RESERVE PIT CONSTRUCTION STANDARDS

The reserve pit shall be constructed entirely in cut material and lined with 6-mil plastic.

Mineral material extracted from within the boundary of the APD during construction of the well pad and reserve pits and be used for the construction of this well pad and its immediate access road only, as long as that portion of the access road it is use on remains on-lease. Removal of any additional material from this location for construction or improvement of other well pads and other access or lease roads must first be purchased from BLM.

Reclamation: Reclamation of this type of deep pit will consist of pushing the pit walls into the pit when sufficiently dry to support track equipment. The pit liner is NOT TO BE RUPTURED to facilitate drying; a ten month period after completion of the well is allowed for drying of the pit contents.

The pit area must be contoured to the natural terrain with all contaminated drilling mud buried with at least 3 feet of clean soil. The reclaimed area will then be seeded as specified in this permit.

#### CULTURAL

Whether or not an archaeological survey has been completed and notwithstanding that operations are being conducted as approved, the lessee/operator/grantee shall notify the BLM immediately if previously unidentified cultural resources are observed during surface disturbing operations. From the time of the observation, the lessee/operator/grantee shall avoid operations that will result in disturbance to these cultural resources until directed to process by BLM.

#### TRASH PIT STIPS

All trash, junk, and other waste material shall be contained in trash cages or bins to prevent scattering and will be removed and deposited in an approved sanitary landfill. Burial on site is not permitted.

PRAIRIE CHICKENS

No surface use is allowed during the following time periods; unless otherwise specified, this stipulation does not apply to operation and maintenance of production facilities.

On the lands described below:

T. 17 S., R. 30 E.

Section 24: ALL

For the purpose of: Protecting Prairie Chickens:

Drilling for oil and gas, and 3-D geophysical exploration operations will not be allowed in Lesser Prairie Chicken Habitat during the period of March 15 through June 15, each year. During that period, other activities that produce noise or involve human activity, such as the maintenance of oil and gas facilities, geophysical exploration other than 3-D operations, and pipeline, road, and well pad construction, will be allowed except between 3:00 a.m. and 9:00 a.m. The 3:00 a.m. and 9:00 a.m. restriction will not apply to normal, around-the-clock operations, such as venting, flaring, or pumping, which do not require a human presence during the period. Additionally, no new drilling will be allowed within up to 200 meters of leks known at the time of permitting. Normal vehicle use on existing roads will not be restricted. Exhaust noise from pump jack engines must be muffled or otherwise controlled so as not to exceed 75 db measured at 30 feet from the source of the noise.

Bureau of Land Management  
Carlsbad Field Office

SENM-S-22  
December 1997