

District I
1625 N. French Dr., Hobbs, NM 88240
District II
1301 W. Grand Avenue, Artesia, NM 88210
District III
1000 Rio Brazos Road, Aztec, NM 87410
District IV
1220 S. St. Francis Dr., Santa Fe, NM 87505

State of New Mexico
Energy Minerals and Natural Resources

S Oil Conservation Division
100 South St. Francis Dr.
Santa Fe, NM 87505

For drilling and production facilities, submit to appropriate NMOCD District Office.
For downstream facilities, submit to Santa Fe office.

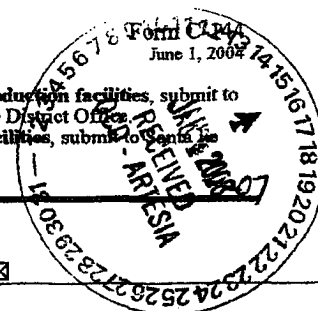

Pit or Below-Grade Tank Registration or Closure

Is pit or below-grade tank covered by a "general plan"? Yes ☒ No ☐

Type of action: Registration of a pit or below-grade tank ☐ Closure of a pit or below-grade tank ☒

Operator: Yates Petroleum Corporation Telephone: 505-748-4500 e-mail address: mikes@ypcnm.com

Address: 105 South 4th Street, Artesia, NM 88210

Facility or well name: Seinfeld BBK Federal #1 API #: 30-005-62117 U/L or Qtr/Qtr M Sec 12 T6S R 26E

County: Chaves Latitude 33.8033 Longitude 104.25525 NAD: 1927 ☒ 1983 ☐

Surface Owner: Federal ☒ State ☐ Private ☐ Indian ☐

Month - Year
MAR 15 2007
OCD - ARTESIA, NM

Pit Type: Drilling <input type="checkbox"/> Production <input type="checkbox"/> Disposal <input type="checkbox"/> Work over <input checked="" type="checkbox"/> Emergency <input type="checkbox"/> Lined <input checked="" type="checkbox"/> Unlined <input type="checkbox"/> Liner type: Synthetic <input checked="" type="checkbox"/> Thickness <u>12</u> mil Clay <input type="checkbox"/> Pit Volume _____ bbl	Below-grade tank Volume: _____ bbl Type of fluid: _____ Construction material: _____ Double-walled, with leak detection? Yes <input type="checkbox"/> If not, explain why not: _____
Depth to ground water (vertical distance from bottom of pit to seasonal high water elevation of ground water.)	Less than 50 feet (20 points) 50 feet or more, but less than 100 feet (10 points) 100 feet or more (0 points) XXXX
Wellhead protection area: (Less than 200 feet from a private domestic water source, or less than 1000 feet from all other water sources.)	Yes (20 points) No (0 points) XXXX
Distance to surface water: (horizontal distance to all wetlands, playas, irrigation canals, ditches, and perennial and ephemeral watercourses.)	Less than 200 feet (20 points) 200 feet or more, but less than 1000 feet (10 points) 1000 feet or more (0 points) XXXX
Ranking Score (Total Points) 0 Points	

this is a pit closure: (1) Attach a diagram of the facility showing the pit's relationship to other equipment and tanks. (2) Indicate disposal location: (check the onsite box if you are burying place) onsite ☐ offsite ☒ If offsite, name of facility: N/A (3) Attach a general description of remedial action taken including remediation start date and end date. (4)

roundwater encountered: No ☐ Yes ☐ If yes, show depth below ground surface _____ ft. and attach sample results.

) Attach soil sample results and a diagram of sample locations and excavations.

Additional Comments: Closure work plan for workover pit. The workover pit contents will be excavated and hauled to an OCD approved soil waste facility.

The excavated area will be backfilled to grade using a minimum of 3' of clean soil and like material. A one call and a 48 hour notice will be provided to the Oil Conservation Division.

Pit Closure start date: N/A Final closure date: N/A

I hereby certify that the information above is true and complete to the best of my knowledge and belief. I further certify that the above-described pit or below-grade tank has been/will be constructed or closed according to NMOCD guidelines ☐, a general permit ☒, or an (attached) alternative OCD-approved plan ☐.

Date: 01/08/2007

Printed Name/Title Mike Stubblefield / Environmental Regulatory Agent

Signature Mike Stubblefield

Your certification and NMOCD approval of this application/closure does not relieve the operator of liability should the contents of the pit or tank contaminate ground water or otherwise endanger public health or the environment. Nor does it relieve the operator of its responsibility for compliance with any other federal, state, or local laws and/or regulations.

Approval:

Printed Name/Title Jim W. Brown District II Supervisor

Date: 1/22/07

PIT CLOSURE FINAL

DATE 3/2/2007

Accepted for record

NMOCD MAR 22 2007

New Mexico Office of the State Engineer
POD Reports and DownloadsSEINFELD BBK FEDERAL
#1

Township: 06S Range: 26E Sections:

NAD27 X: Y: Zone: Search Radius:

County: Basin: Number: Suffix:

Owner Name: (First) (Last) ☐ Non-Domestic ☐ Domestic ☒ All

POD / Surface Data Report

Avg Depth to Water Report

Water Column Report

Clear Form

IWATERS Menu

Help

AVERAGE DEPTH OF WATER REPORT 01/09/2007

Bsn	Tws	Rng	Sec	Zone	X	Y	Wells	(Depth Water in Feet)		
								Min	Max	Avg
FS	06S	26E	17				1	65	65	65
FS	06S	26E	33				1	6	6	6

Record Count: 2

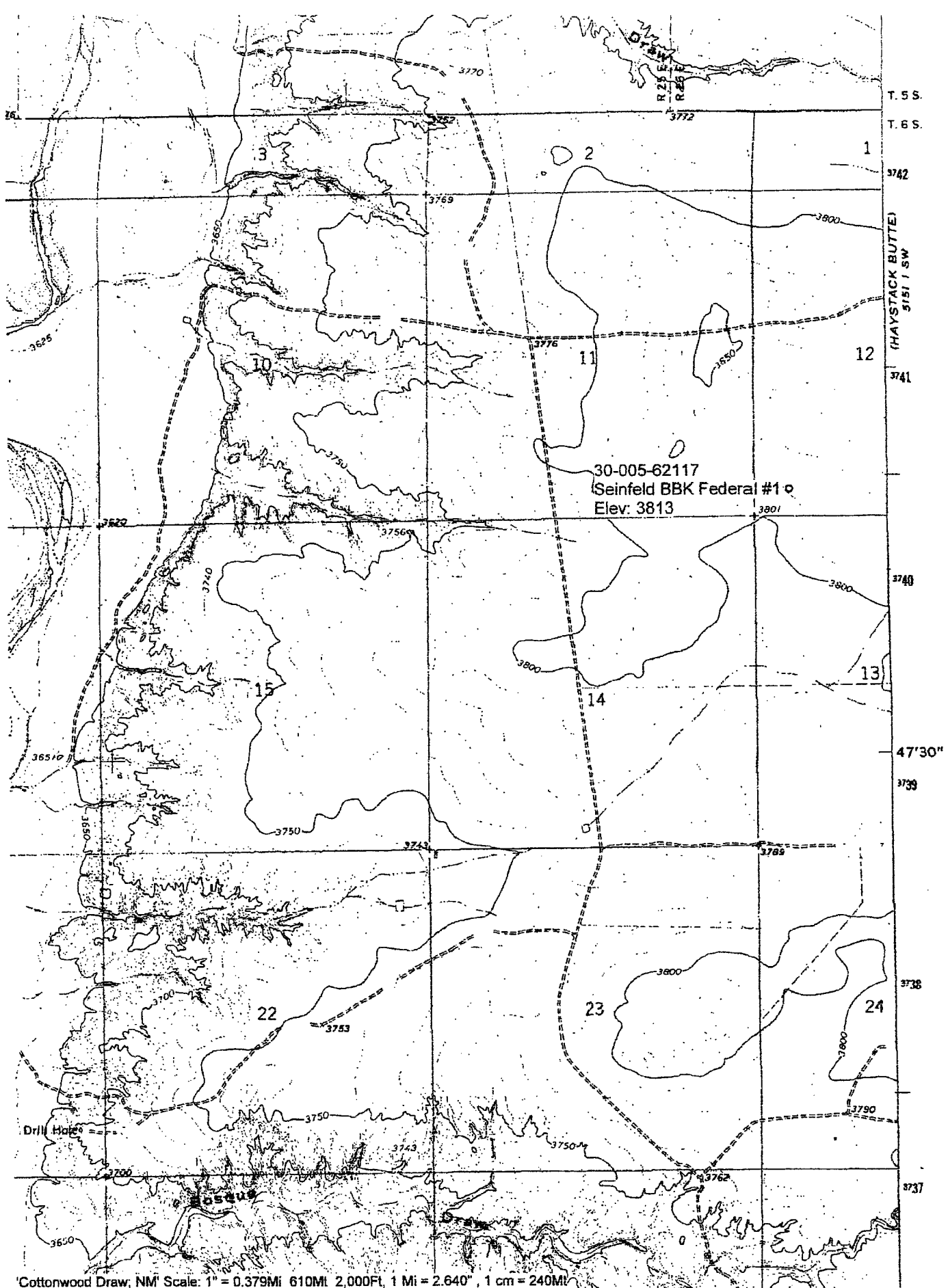

MARTIN YATES, III
1912 - 1985
FRANK W. YATES
1936 - 1986



105 SOUTH FOURTH STREET
ARTESIA, NEW MEXICO 88210-2118
TELEPHONE (505) 748-1471

S. P. YATES
CHAIRMAN OF THE BOARD
JOHN A. YATES
PRESIDENT
PEYTON YATES
EXECUTIVE VICE PRESIDENT
RANDY G. PATTERSON
SECRETARY
DENNIS G. KINSEY
TREASURER

I certify that on 3/1/2007, tests were conducted on soil samples from the
30-005-62117 UT-M 12-65-26e Seinfeld

Following are the results of those tests.

EPA Method 9074, TPH 50 ppm.

EPA Method 9253 170 ppm.

PID Meter, BTEX 11 ppm

All testing was done at Yates Petroleum Corporation or on location.

Respectfully,

Mike Stubblefield

Mike Stubblefield
Environmental Regulatory Agent