

Month - Year
MAR 28 2007
OCD - ARTESIA, NM

OCD-ARTESIA

R-111-POTASH

RESUBMITTAL

ATS-07-18

OMB No. 1004-0136

Expires November 30, 2000

UNITED STATES
DEPARTMENT OF THE INTERIOR
BUREAU OF LAND MANAGEMENT

APPLICATION FOR PERMIT TO DRILL OR REENTER

1a. Type of Work: ☒ DRILL ☐ REENTER

b. Type of Well: ☒ Oil Well ☐ Gas Well ☐ Other ☐ Single Zone ☐ Multiple Zone

2. Name of Operator

Yates Petroleum Corporation 25575

3A. Address 105 South Fourth Street
Artesia, New Mexico 88210

3b. Phone No. (include area code)
(505) 748-1471

4. Location of Well (Report location clearly and in accordance with any State requirements. *)

At surface 660' FNL and 1980' FWL, Unit C

At proposed prod. Zone Same

14. Distance in miles and direction from nearest town or post office*

Approximately 24 miles northeast of Loving, New Mexico.

15. Distance from proposed*
location to nearest
property or lease line, ft.
(Also to nearest drig. unit line, if any)

16. No. of Acres in lease
640

17. Spacing Unit dedicated to this well
40 NE/NW

18. Distance from proposed location*
to nearest well, drilling, completed,
applied for, on this lease, ft.

19. Proposed Depth
8200'

20. BLM/BIA Bond No. on file
NM8000434 585997

21. Elevations (Show whether DF, KDB, RT, GL, etc.)
3401' GR

22. Approximate date work will start*
ASAP

23. Estimated duration
35 days

24. Attachments

The following, completed in accordance with the requirements of Onshore Oil and Gas Order No. 1, shall be attached to this form:

- Well plat certified by a registered surveyor.
- A Drilling Plan.
- A Surface Use Plan (if the location is on National Forest System Lands, the SUPO shall be filed with the appropriate Forest Service Office).
- Bond to cover the operations unless covered by an existing bond on file (see Item 20 above).
- Operator certification.
- Such other site specific information and/or plans as may be required by the authorized office.

25. Signature 

Name (Printed/Typed)
Cy Cowan cy@ypcnm.com

Date
Dec. 28, 2006

Title:
Regulatory Agent/Land Department

Approved by (Signature) /s/ Linda S.C. Rundell

Name (Printed/Typed)
/s/ Linda S.C. Rundell
NM STATE OFFICE

Date
MAR 26 2007

Title
STATE DIRECTOR

Application approval does not w
operations thereon.

Conditions of approval, if any, a

Title 18 U.S.C. Section 1001 and
States any false, fictitious or frau

If earthen pits are used in
association with the drilling of this
well, an OCD pit permit must be
obtained prior to pit construction.

those rights in the subject lease which would entitle the applicant to conduct

nowingly and willfully to make to any department or agency of the United
jurisdiction. APPROVAL FOR 1 YEAR

*(Instructions on reverse)

CARLSBAD CONTROLLED WATER BASIN

SEE ATTACHED FOR
CONDITIONS OF APPROVAL

APPROVAL SUBJECT TO
GENERAL REQUIREMENTS
AND SPECIAL STIPULATIONS
ATTACHED

District I

1625 N. French Dr., Hobbs, NM 88240

State of New Mexico
En J, Minerals & Natural Resources Department

Form C-102

Revised August 15, 2000

District II

811 South First, Artesia, NM 88210

OIL CONSERVATION DIVISION

Submit to Appropriate District Office

District III

1000 Rio Brazos Rd., Aztec, NM 87410

1220 South St. Francis Dr.

State Lease - 4 Copies

Santa Fe, NM 87505

Fee Lease - 3 Copies

District IV

1220 S. St. Francis Dr., Santa Fe, NM 87505

☐ AMENDED REPORT

WELL LOCATION AND ACREAGE DEDICATION PLAT

¹ API Number 30-015-32192	² Pool Code S3818	³ Pool Name Sand Dunes, Delaware South
⁴ Property Code	⁵ Property Name ADELINE ALN FEDERAL	⁶ Well Number 4
⁷ OGRID No. 025575	⁸ Operator Name Yates Petroleum Corporation	⁹ Elevation 3401'

¹⁰ Surface Location

UL or lot no.	Section	Township	Range	Lot Idn	Feet from the	North/South line	Feet from the	East/West line	County
C	6	24S	31E		660	North	1980	West	Eddy

¹¹ Bottom Hole Location If Different From Surface

UL or lot no.	Section	Township	Range	Lot Idn	Feet from the	North/South line	Feet from the	East/West line	County

¹² Dedicated Acres 40	¹³ Joint or Infill	¹⁴ Consolidation Code	¹⁵ Order No.
--	-------------------------------	----------------------------------	-------------------------

NO ALLOWABLE WILL BE ASSIGNED TO THIS COMPLETION UNTIL ALL INTERESTS HAVE BEEN CONSOLIDATED OR A NON-STANDARD UNIT HAS BEEN APPROVED BY THE DIVISION

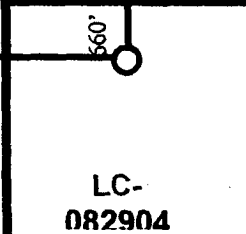
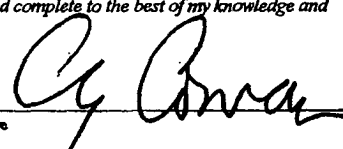
¹⁶ 1980'				¹⁷ OPERATOR CERTIFICATION I hereby certify that the information contained herein is true and complete to the best of my knowledge and belief.  Signature Cy Cowan Printed Name Regulatory Agent Title 12/24/2003 Date
				¹⁸ SURVEYOR CERTIFICATION I hereby certify that the well location shown on this plat was plotted from field notes of actual surveys made by me or under my supervision, and that the same is true and correct to the best of my belief. REFER TO ORIGINAL PLAT Date of Survey Signature and Seal of Professional Surveyor: Certificate Number

Submit to Appropriate
District Office
State Lease - 4 copies
Fee Lease - 3 copies

State of New Mexico
Energy, Minerals and Natural Resources Department

Form C-102
Revised 1-1-89

OIL CONSERVATION DIVISION

P.O. Box 2088

Santa Fe, New Mexico 87504-2088

DISTRICT I

P.O. Box 1980, Hobbs, NM 88240

DISTRICT II

P.O. Drawer DD, Artesia, NM 88210

DISTRICT III

1000 Rio Brazos Rd., Aztec, NM 87410

WELL LOCATION AND ACREAGE DEDICATION PLAT

All Distances must be from the outer boundaries of the section

Operator YATES PETROLEUM CORPORATION			Lease ADELINE "ALN" FEDERAL		Well No. 4
Unit Letter C	Section 6	Township 24 SOUTH	Range 31 EAST	County EDDY	
Actual Footage Location of Well: 660 feet from the NORTH line and 1980 feet from the WEST line					
Ground Level Elev. 3401	Producing Formation Delaware		Pool Wildcat Delaware		Dedicated Acreage: 40 Acres

1. Outline the acreage dedicated to the subject well by colored pencil or hatchure marks on the plat below.
2. If more than one lease is dedicated to the well, outline each and identify the ownership thereof (both as to working interest and royalty).
3. If more than one lease of different ownership is dedicated to the well, have the interest of all owners been consolidated by communalization, unitization, force-pooling, etc.?
☐ Yes ☐ No If answer is "yes" type of consolidation _____
If answer is "no" list the owners and tract descriptions which have actually been consolidated. (Use reverse side of this form if necessary.) _____
No allowable will be assigned to the well until all interests have been consolidated (by communalization, unitization, forced-pooling, or otherwise) or until a non-standard unit, eliminating such interest, has been approved by the Division.

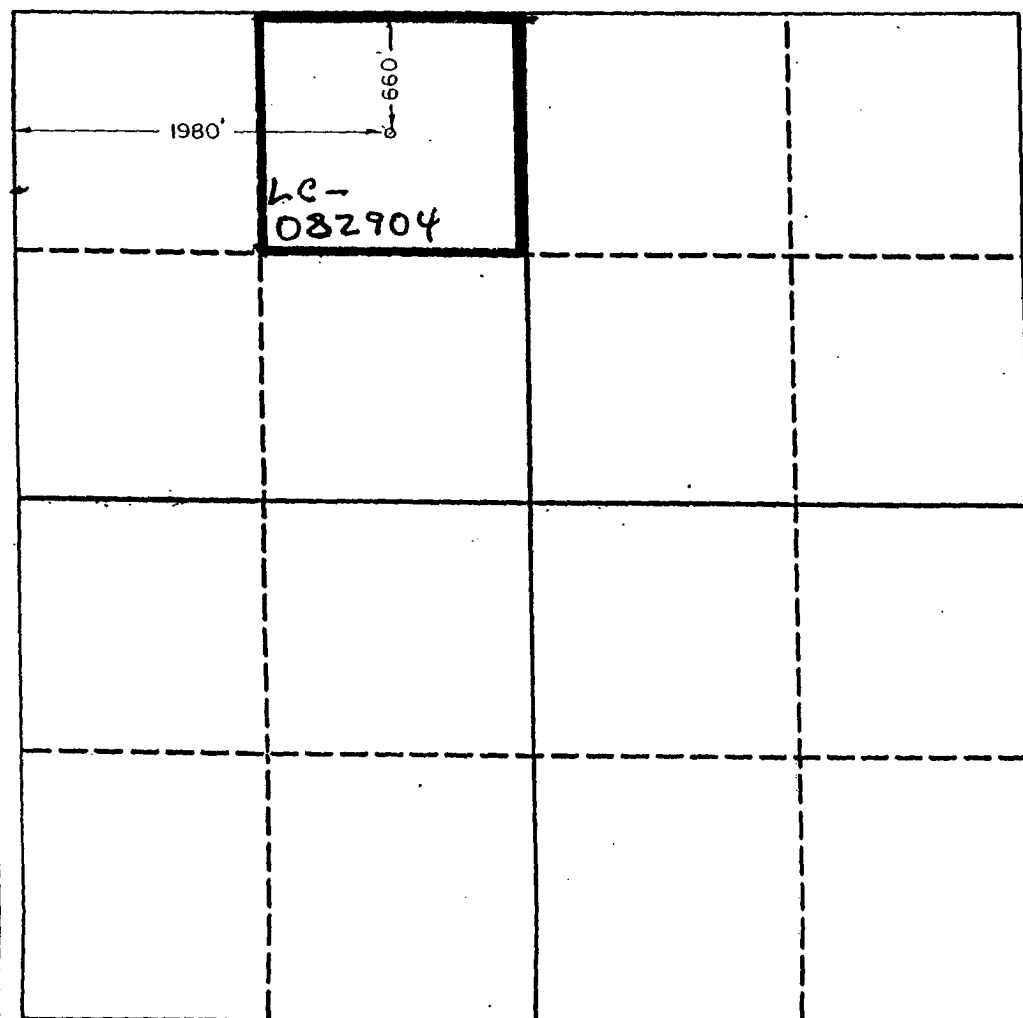

OPERATOR CERTIFICATION

I hereby certify that the information contained herein is true and complete to the best of my knowledge and belief.

Signature *Cy Cowan*

Printed Name **Cy Cowan**

Position **Permit Agent**

Company **Yates Petroleum Corporation**

Date **October 31, 2001**

SURVEYOR CERTIFICATION

I hereby certify that the well location shown on this plat was plotted from field notes actual surveys made by me or under my supervision, and that the same is true and correct to the best of my knowledge and belief.

Date Surveyed **7/23/92**

Signature & Seal of Professional Surveyor

Herschel L. Jones
HERSCHEL L. JONES
3640
NEW MEXICO
LAND SURVEYOR

YATES PETROLEUM CORPORATION
Adeline "ALN" Federal #4
 660' FNL & 1980' FWL
 Sec. 6-T24S-R31-E
 Eddy County, New Mexico

1. The estimated tops of geologic markers are as follows:

Rustler	477'
Top of Salt	863'
Base of Salt	3932'
Bell Canyon	4150'
Cherry Canyon	5129'
Brushy Canyon	6810'
Bone Spring Lime	8010'
TD	8200'

2. The estimated depths at which anticipated water, oil or gas formations are expected to be encountered:

Water: Approx 150'
 Oil or Gas: Brushy Canyon 5129' and Bone Spring 8010'

3. Pressure Control Equipment: BOPE will be installed on the 13 3/8" casing and rated for 3000 BOP systems will be consistent with API RP 53. Pressure tests will be conducted before drilling out from under all casing strings which are set and cemented in place. Blowout Preventor controls will be installed prior to drilling the surface plug and will remain in use until the well is completed or abandoned. Preventors will be inspected and operated at least daily to ensure good mechanical working order, and this inspection recorded on the daily drilling report. See Exhibit B.

Auxiliary Equipment:

- A. Auxiliary Equipment: Kelly cock, pit level indicators, flow sensor equipment and a sub with full opening valve to fit the drill pipe and collars will be available on the rig floor in the open position at all times for use when kelly is not in use.

4. THE PROPOSED CASING AND CEMENTING PROGRAM:

- A. Casing Program: (All New)

CoA	Hole Size	Casing Size	Wt./Ft	Grade	Coupling	Interval	Length	
—	17 1/2"	13 3/8"	48#	H-40	ST&C	0-750'	750'	825'
	11"	8 5/8"	32#	J-55	ST&C	0-4100'	4100'	SS
	7 7/8"	5 1/2"	17#	J-55	LT&C	0-100'	100'	
	7 7/8"	5 1/2"	15.5#	J-55	LT&C	100'-6800'	6700'	
	7 7/8"	5 1/2"	17#	J-55	LT&C	6800'-8200'	1400'	

Minimum Casing Design Factors: Collapse 1.125, Burst 1.0, Joint Strength 1.8

B. CEMENTING PROGRAM:

Surface casing: 450 sx Lite (YLD 1.96 WT.12.6) Tail in w/ 200 sx Class "C" + 2% CaCl₂ (YLD 1.34 WT 14.8).

Intermediate Casing: 1000 sx Lite (YLD 2.5 WT 11.9); Tail in w/ 250 sx "C" w/ 2% CaCl₂ (YLD 1.34 WT. 14.8)

Production Casing: (TOC=3700') Stage I; 450 sx Super "H" (YLD 1.67 WT. 13.0). Tail in with 50 sx Thixotropic (Yld. 1.4 Wt 14.4) Stage II: Lead w/350 sx Lite (YLD 2.0 WT 12.0) Tail in w/ 50 sx Super "H" (Yld 1.67 Wt 13.0). DV tool at 6500'.

COA

5. Mud Program and Auxiliary Equipment:

Interval	Type	Weight	Viscosity	Fluid Loss
0-750'	FW/Native Mud	8.6-9.2	28-36	N/C
750'-4100'	Brine	10.0-10.2	28	N/C
4100'-6800'	Cut Brine	8.6-9.1	28	N/C
6800'-8200'	Cut Brine/Starch	8.6-9.1	28-32	<15cc

COA
825'

Sufficient mud material(s) to maintain mud properties, control lost circulation and contain a blow out will be available at the well site during drilling operations. Mud will be checked hourly by rig personnel.

6. EVALUATION PROGRAM:

Samples: 10 samples out from under surface casing.

Logging: CNL/LDT TD to casing; GR w/CNL to Surface; DLL x/RXO TD to casing.

Coring: None Anticipated.

DST's: As warranted.

7. Abnormal Conditions, Bottom hole pressure and potential hazards:

Anticipated BHP:

From: 0	TO: 750'	Anticipated Max.	BHP: 500	PSI
From: 750'	TO: 4100'	Anticipated Max.	BHP: 1790	PSI
From: 4100'	TO: 8200'	Anticipated Max.	BHP: 4100	PSI

No abnormal pressures or temperatures are anticipated.

Lost Circulation Zones Anticipated: None.

H₂S Zones Anticipated: None

Maximum Bottom Hole Temperature: 198 F

8. ANTICIPATED STARTING DATE:

Plans are to drill this well as soon as possible after receiving approval. It should take approximately 20 days to drill the well with completion taking another 15 days.

MULTI-POINT SURFACE USE AND OPERATIONS PLAN
Yates Petroleum Corporation
Adeline "ALN" Federal #4
660' FNL & 1980' FWL
Sec. 6-T24S-R31-E
Eddy County, New Mexico

This plan is submitted with Form 3160-3, Application for Permit to Drill, covering the above described well. The purpose of this plan is to describe the location of the proposed well, the proposed construction activities and operations plan, the magnitude of the surface disturbance involved and the procedures to be followed in rehabilitating the surface after completion of the operations, so that a complete appraisal can be made of the environmental effect associated with the operations.

1. EXISTING ROADS:

Exhibit A is a portion of the BLM map showing the well and roads in the vicinity of the proposed location. The proposed wellsite is located approximately 24 miles northwest of Loving, New Mexico and the access route to the location is indicated in red and green on Exhibit A.

DIRECTIONS:

Go east of Carlsbad on Highway 285 to Highway 31. Go east on Highway 31 to Highway 128 (Jal Highway). Go approximately 12 miles to County Road 787 (Twin Wells Road). Turn South and go approximately 4 miles. The new road will start here going west to the well location.

2. PLANNED ACCESS ROAD.

- A. The proposed new access will be approximately 0.2 of a mile in length from the point of origin to the northeast corner of the drilling pad. The road will lie in an east to west direction.
- B. The new road will be 14 feet in width (driving surface) and will be adequately drained to control runoff and soil erosion.
- C. The new road will be bladed with drainage on one side. Traffic turnouts may be built.
- D. The route of the road is visible.
- E. Existing roads will be maintained in the same or better condition.

3. LOCATION OF EXISTING WELL

- A. There is drilling activity within a one-mile radius of the wellsite.
- B. Exhibit D shows existing wells within a one-mile radius of the proposed wellsite.

4. LOCATION OF EXISTING AND/OR PROPOSED FACILITIES

- A. There are production facilities on this lease at the present time.
- B. In the event that the well is productive, the necessary production facilities will be installed on the drilling pad. If the well is productive oil, a gas or diesel self-contained unit will be used to provide the necessary power. No power will be required if the well is productive of gas.

5. LOCATION AND TYPE OF WATER SUPPLY:

- A. It is planned to drill the proposed well with a fresh water system. The fresh water will be obtained from commercial sources and will be hauled to the location by truck over the existing and proposed roads shown in Exhibit A.

6. SOURCE OF CONSTRUCTION MATERIALS:

Dirt contractor will locate closest pit and obtain any permits and materials needed for construction.

7. METHODS OF HANDLING WASTE DISPOSAL:

- A. Drill cuttings will be disposed of in the reserve pits.
- B. Drilling fluids will be allowed to evaporate in the reserve pits until the pits are dry.
- C. Water produced during operations will be collected in tanks until hauled to an approved disposal system, or separate disposal application will be submitted.
- D. Oil produced during operations will be stored in tanks until sold.
- E. Current laws and regulations pertaining to the disposal of human waste will be complied with.
- F. All trash, junk, and other waste materials will be contained in trash cages or bins to prevent scattering and will be removed and deposited in an approved sanitary land fill. Burial on site is not approved.

8. ANCILLARY FACILITIES: Amend the surface use plan to include the following, one 3" SDR Poly surface flow line from this well. Flow line will follow access road to pipeline ROW. NM-94388 then north. One (1) three phase 640 volt raptor proof power line from this well to the Adeline ALN Federal Com. #15 to follow access road due east.

9. WELLSITE LAYOUT:

- A. Exhibit C shows the relative location and dimensions of the well pad, the reserve pits, the location of the drilling equipment, rig orientation and access road approach.
- B. The reserve pits will be plastic lined and will face to the south.
- C. A 400' x 400' area has been staked and flagged.

10. PLANS FOR RESTORATION

- A. After finishing drilling and/or completion operations, all equipment and other material not needed for further operations will be removed. The location will be cleaned of all trash and junk to leave the wellsite in as aesthetically pleasing a condition as possible.
- B. Unguarded pits, if any, containing fluids will be fenced until they have dried and been leveled.
- C. If the proposed well is non-productive, all rehabilitation and/or vegetation requirements of the Bureau of Land Management will be complied with and will be accomplished as expeditiously as possible. All pits will be filled level after they have evaporated and dried.

11. SURFACE OWNERSHIP: Federal surface, Administered by the Bureau of Land Management, Carlsbad, New Mexico.

12. OTHER INFORMATION:

- A. Topography: Refer to the existing archaeological report for a description of the topography, flora, fauna, soil characteristics, dwellings, historical and cultural sites.
- B. The primary surface use is for grazing.

13. OPERATOR'S REPRESENTATIVE

A. Through A.P.D. Approval:

Cy Cowan, Regulatory Agent
Yates Petroleum Corporation
105 South Fourth Street
Artesia, New Mexico 88210
Phone (505) 748-1471

B. Through Drilling Operations,
Completions and Production:

Pinson McWhorter, Operations Manager
Yates Petroleum Corporation
105 South Fourth Street
Artesia, New Mexico 88210
Phone (505) 748-1471

14. CERTIFICATION:

I hereby certify that I, or persons under my direct supervision, have inspected the proposed drill site and access route, that I am familiar with the conditions which presently exist; that the statements made in this plan are to the best of my knowledge, true and correct; and , that the work associated with the operations proposed herein will be performed by Yates Petroleum Corporation and its contractors and subcontractors in conformity with this plan and the terms and conditions under which it is approved. This statement is subject to the provisions of 18 U.S.C. 1001 for the filing of a false statement.

12/28/06



Regulatory Agent



Yates Petroleum Corporation

BOP-3

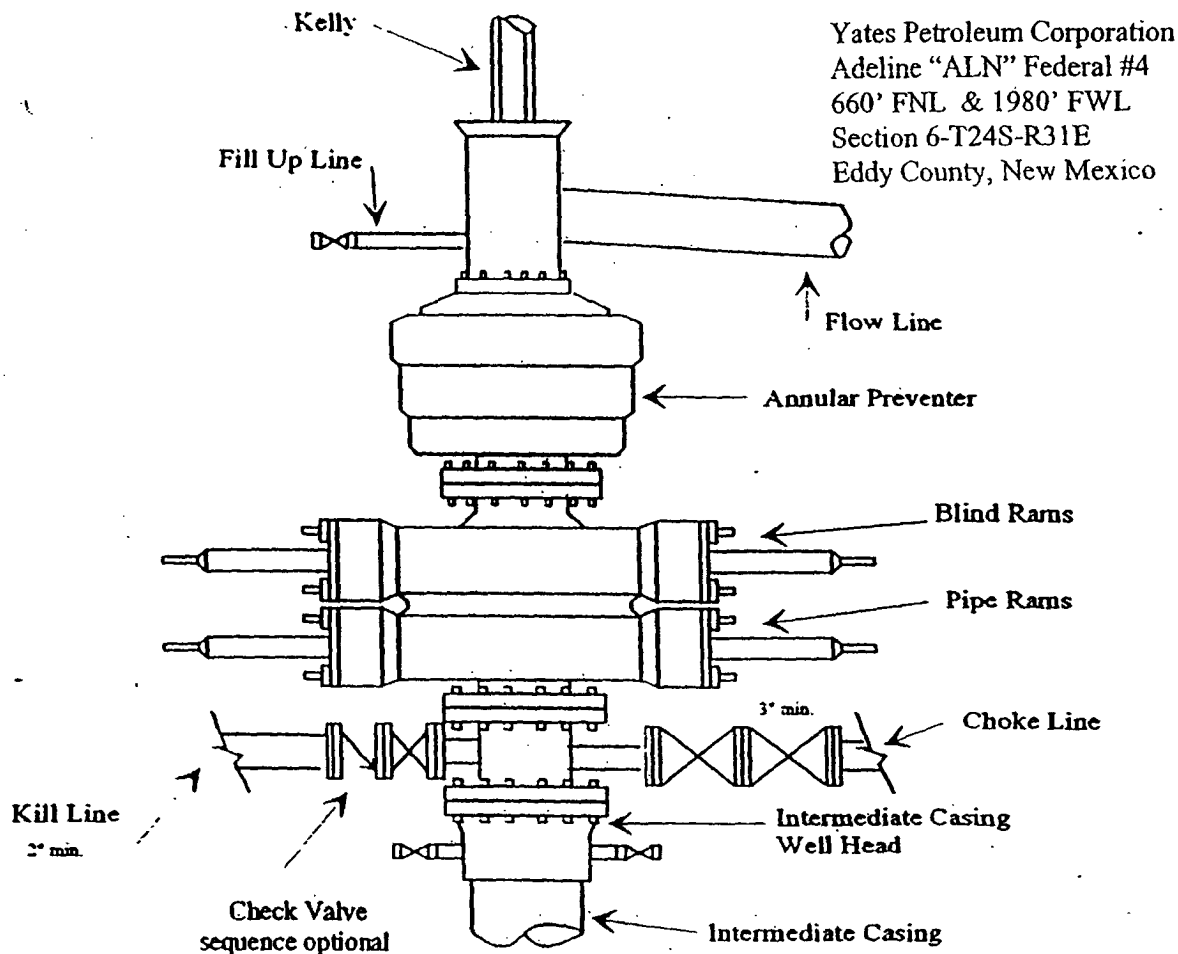
Typical 3,000 psi Pressure System Schematic Annular with Double Ram Preventer Stack



Typical 3,000 psi choke manifold assembly with at least these minimum features

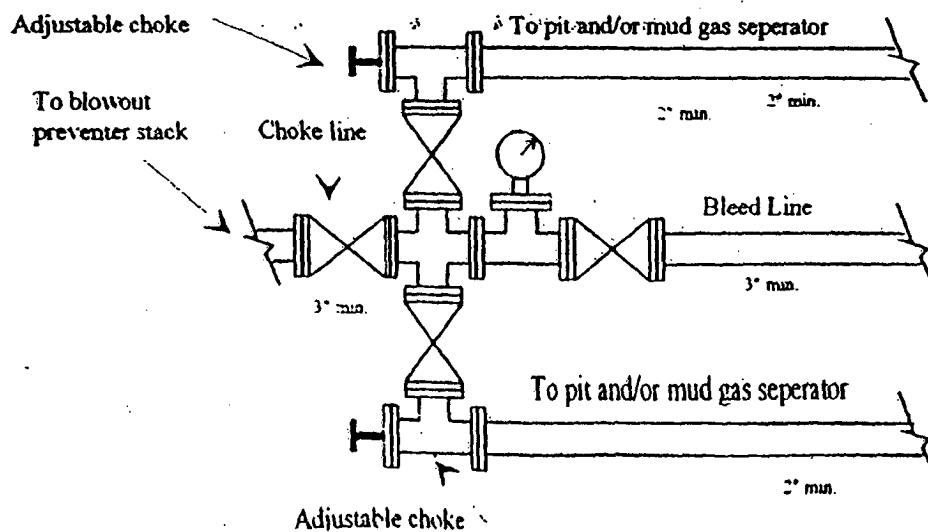

District I
1625 N. French Dr., Hobbs, NM 88240
District II
1301 W. Grand Avenue, Artesia, NM 88210
District III
1000 Rio Brazos Road, Aztec, NM 87410
District IV
1220 S. St. Francis Dr., Santa Fe, NM 87505

State of New Mexico
Energy Minerals and Natural Resources

Oil Conservation Division
1220 South St. Francis Dr.
Santa Fe, NM 87505

Form C-144
March 12, 2004

For drilling and production facilities, submit to
appropriate NMOCD District Office.
For downstream facilities, submit to Santa Fe
office

Pit or Below-Grade Tank Registration or Closure

Is pit or below-grade tank covered by a "general plan"? Yes x No ☐

Type of action: Registration of a pit or below-grade tank x Closure of a pit or below-grade tank ☐

Operator: Yates Petroleum Corporation Telephone: (505) 748-1471 e-mail address: cy@yocnm.com
Address: 105 South Fourth Street, Artesia, NM 88210
Facility or well name: Adeline ALN Federal #4 API #: 30-015-33940 U/L or Qtr/Qtr C Sec 6 T 24S R 31E
County: Eddy Latitude _____ Longitude _____ NAD: 1927 ☐ 1983 ☐ Surface Owner Federal ☒ State ☐ Private ☐ Indian ☐

Pit

Type: Drilling ☒ Production ☐ Disposal ☐

Workover ☐ Emergency ☐

Lined ☐ Unlined ☐

Liner type: Synthetic ☒ Thickness 12 mil Clay ☐ Volume

_____ bbl

Below-grade tank

Volume: _____ bbl Type of fluid: _____

Construction material: _____

Double-walled, with leak detection? Yes ☐ If not, explain why not. _____

Depth to ground water (vertical distance from bottom of pit to seasonal high water elevation of ground water.)

Less than 50 feet

(20 points)

50 feet or more, but less than 100 feet

(10 points)

100 feet or more

☒ 0 points

Wellhead protection area: (Less than 200 feet from a private domestic water source, or less than 1000 feet from all other water sources.)

Yes

(20 points)

No

☒ 0 points

Distance to surface water: (horizontal distance to all wetlands, playas, irrigation canals, ditches, and perennial and ephemeral watercourses.)

Less than 200 feet

(20 points)

200 feet or more, but less than 1000 feet

(10 points)

1000 feet or more

☒ 0 points

Ranking Score (Total Points)

0 POINTS

If this is a pit closure: (1) attach a diagram of the facility showing the pit's relationship to other equipment and tanks. (2) Indicate disposal location:

onsite ☐ offsite ☐ If offsite, name of facility _____ (3) Attach a general description of remedial action taken including remediation start date and end date. (4) Groundwater encountered: No ☐ Yes ☐ If yes, show depth below ground surface _____ ft. and attach sample results. (5) Attach soil sample results and a diagram of sample locations and excavations.

I hereby certify that the information above is true and complete to the best of my knowledge and belief. I further certify that the above described pit or below-grade tank has been/will be constructed or closed according to NMOCD guidelines ☐, a general permit ☒, or an (attached) alternative OGD approved plan ☐.

Date: January 12, 2006

Printed Name/Title Cy Cowan, Regulatory Agent/Land Department

Signature Cy Cowan

Your certification and NMOCD approval of this application/closure does not relieve the operator of liability should the contents of the pit or tank contaminate ground water or otherwise endanger public health or the environment. Nor does it relieve the operator of its responsibility for compliance with any other federal, state, or local laws and/or regulations.

Approved MAR 16 2006

Date: _____

Printed Name/Title _____

Signature [Signature]

CONDITIONS OF APPROVAL - DRILLING

Well Name & No. 4-Adeline ALN Federal
Operator's Name: Yates Petroleum Corp.
Location: 0660FNL, 1980FWL, Section 6, T-24-S, R-31-E
Lease: NM82904

I. DRILLING OPERATIONS REQUIREMENTS:

1. The Bureau of Land Management (BLM) is to be notified at the Carlsbad Field Office, 620 East Greene St., Carlsbad, NM 88220, (505) 361-2822 - for wells in Eddy County, in sufficient time for a representative to witness:
 - A. Spudding
 - B. Cementing casing: 13-3/8 inch 8-5/8 inch 5-1/2 inch
 - C. BOP tests
2. Hydrogen Sulfide (H₂S) is always possible, but not reported in this area.
3. Unless the production casing has been run and cemented or the well has been properly plugged, the drilling rig shall not be removed from over the hole without prior approval.
4. Submit a Sundry Notice (Form 3160-5, one original and five copies) for each casing string, describing the casing and cementing operations. Include pertinent information such as; spud date, hole size, casing (size, weight, grade and thread type), cement (type, quantity and top), water zones and problems or hazards encountered. The Sundry shall be submitted within 15 days of completion of each casing string. The reports may be combined into the same Sundry if they fall within the same 15 day time frame.
5. The API No. assigned to the well by NMOCD shall be included on the subsequent report of setting the first casing string.
6. A Communitization Agreement covering the acreage dedicated to this well must be filed for approval with the BLM. The effective date of the agreement shall be prior to any sales.
7. Gamma-Ray/Neutron logs shall be run from the base of the Salado Formation to the surface; cable speed not to exceed 30 feet per minute.

II. CASING:

1. The 13-3/8 inch surface casing shall be set at approximately 825 feet to cover deep water zone, below usable water and cement circulated to the surface. If cement does not circulate to the surface the appropriate BLM office shall be notified and a temperature survey or cement bond log shall be run to verify the top of the cement. Remedial cementing shall be completed prior to drilling out that string.

Fresh water mud to be used to setting depth of surface casing.

2. The minimum required fill of cement behind the 8-5/8 inch salt protection casing is cement shall circulate to surface.
3. The minimum required fill of cement behind the 5-1/2 inch production casing is cement shall circulate to surface. Both stages to circulate.
4. Whenever a casing string is cemented in the R-111-P Potash Area, cement shall be allowed to stand a minimum of twelve (12) hours under pressure and a total of twenty-four (24) hours before drilling the plug or initiating tests.

III. PRESSURE CONTROL:

1. All BOP systems and related equipment shall comply with well control requirements as described in Onshore Oil and Gas Order No. 2. The BOP and related equipment shall be installed and operational before drilling below the 13-3/8 inch casing shoe and shall be tested as described in Onshore Order No. 2. Any equipment failing to test satisfactorily shall be repaired or replaced.
2. Minimum working pressure of the blowout preventer and related equipment (BOPE) required for drilling the surface and intermediate casing shall be 2M psi. Minimum working pressure of the blowout preventer and related equipment (BOPE) required for drilling below the 8-5/8 inch casing shall be 3M psi.
3. The appropriate BLM office shall be notified in sufficient time for a representative to witness the tests.
 - The tests shall be done by an independent service company.
 - The results of the test shall be reported to the appropriate BLM office.
 - Testing fluid must be water or an appropriate clear liquid suitable for sub-freezing temperatures. Use of drilling mud for testing is not permitted since it can mask small leaks.
 - Testing must be done in a safe workman-like manner. Hard line connections shall be required.

Engineer on call phone: 505-706-2779

WWI 011907