

District I
1625 N. French Dr., Hobbs, NM 88240
District II
1301 W. Grand Avenue, Artesia, NM 88210
District III
1000 Rio Brazos Road, Aztec, NM 87410
District IV
1220 S. St. Francis Dr., Santa Fe, NM 87505

State of New Mexico
Energy Minerals and Natural Resources
Oil Conservation Division
1220 South St. Francis Dr.
Santa Fe, NM 87505

Form C-144
June 1, 2004

For drilling and production facilities, submit to appropriate NMOCD District Office.
For downstream facilities, submit to Santa Fe office

Pit or Below-Grade Tank Registration or Closure

Is pit or below-grade tank covered by a "general plan"? Yes ☒ No ☐
Type of action: Registration of a pit or below-grade tank ☐ Closure of a pit or below-grade tank ☒

Operator: EOG Resources Telephone: 432.486.3642 e-mail address: seay04@lenex.net
Address: P.O. Box 22167 Midland Tx 79702
Facility or well name: Meramec 34 #2H API #: 30.015.35391 U/L or Qtr/Qtr H Sec 4 T 16 R 25
County: Edley Latitude 32° 05' 41" N Longitude 104° 48' 34" W NAD: 1927 ☒ 1983 ☐
Surface Owner: Federal ☐ State ☐ Private ☒ Indian ☐

Pit Type: Drilling <input checked="" type="checkbox"/> Production <input type="checkbox"/> Disposal <input type="checkbox"/> Workover <input type="checkbox"/> Emergency <input type="checkbox"/> Lined <input checked="" type="checkbox"/> Unlined <input type="checkbox"/> Liner type: Synthetic <input checked="" type="checkbox"/> Thickness <u>12</u> mil Clay <input type="checkbox"/> Pit Volume <u>10300</u> bbl	Below-grade tank Volume: _____ bbl Type of fluid: _____ Construction material: _____ Double-walled, with leak detection? Yes <input type="checkbox"/> If not, explain why not: _____
Depth to ground water (vertical distance from bottom of pit to seasonal high water elevation of ground water.) <u>35 ft</u>	Less than 50 feet (20 points) 50 feet or more, but less than 100 feet (10 points) 100 feet or more (0 points)
Wellhead protection area: (Less than 200 feet from a private domestic water source, or less than 1000 feet from all other water sources.)	Yes (20 points) No (0 points)
Distance to surface water: (horizontal distance to all wetlands, playas, irrigation canals, ditches, and perennial and ephemeral watercourses.)	Less than 200 feet (20 points) 200 feet or more, but less than 1000 feet (10 points) 1000 feet or more (0 points)
Ranking Score (Total Points) <u>30</u>	

If this is a pit closure: (1) Attach a diagram of the facility showing the pit's relationship to other equipment and tanks. (2) Indicate disposal location: (check the onsite box if you are burying in place) onsite ☐ offsite ☒ If offsite, name of facility: _____ (3) Attach a general description of remedial action taken including remediation start date and end date. (4) Groundwater encountered: No ☐ Yes ☐ If yes, show depth below ground surface _____ ft. and attach sample results. (5) Attach soil sample results and a diagram of sample locations and excavations.

Additional Comments: Plan to excavate the content of the drilling pit and haul to a OGD approved facility. Sample the bottom of the excavation, and backfill level and seal only after the OGD approves.
Will notify the OGD before starting and file summary notice after closing will begin soon after approved.

I hereby certify that the information above is true and complete to the best of my knowledge and belief. I further certify that the above-described pit or below-grade tank has been/will be constructed or closed according to NMOCD guidelines ☐, a general permit ☒, or an (attached) alternative OCD-approved plan ☒.

Date: 7/11/07
Printed Name/Title: Eddie W Seay Agent Signature: Eddie W Seay

Your certification and NMOCD approval of this application/closure does not relieve the operator of liability should the contents of the pit or tank contaminate ground water or otherwise endanger public health or the environment. Nor does it relieve the operator of its responsibility for compliance with any other federal, state, or local laws and/or regulations.

Notify OCD 24 hours prior to beginning pit closure.
Signature: _____ Signed By: Mike Brannon Date: JUL 13 2007

Samples are to be obtained from pit area and analysis submitted to NMOCD prior to back-filling

(2)

District I
1625 N. French Dr., Hobbs, NM 88240
District II
1301 W. Grand Avenue, Artesia, NM 88210
District III
1000 Rio Brazos Rd., Aztec, NM 87410
District IV
1220 S. St. Francis Dr., Santa Fe, NM 87505

State of New Mexico
Energy, Minerals & Natural Resources Department
OIL CONSERVATION DIVISION
1220 South St. Francis Dr.
Santa Fe, NM 87505

Form C-102
Revised October 12, 2005
Submit to Appropriate District Office
State Lease- 4 Copies
Fee Lease- 3 Copies

☐ AMENDED REPORT

WELL LOCATION AND ACREAGE DEDICATION PLAT

API Number 30-015-35381	Pool Code 75250	Pool Name COTTONWOOD CREEK WOLFCAMP (GAS)
Property Code 36264	Property Name MERAMEC "B" 4 FEE	Well Number 2H
OGRID No. 7377	Operator Name EOG RESOURCES, INC.	Elevation 3469'

Surface Location

UL or lot no.	Section	Township	Range	Lot kdn	Feet from the	North/South line	Feet from the	East/West line	County
16	4	16 SOUTH	25 EAST, N.M.P.M.		3400'	SOUTH	660'	EAST	EDDY

Bottom Hole Location If Different From Surface

UL or lot no.	Section	Township	Range	Lot kdn	Feet from the	North/South line	Feet from the	East/West line	County
13	4	16 SOUTH	25 EAST, N.M.P.M.		3400'	SOUTH	660'	WEST	EDDY

Dedicated Acres	Joint or Infill	Consolidation Code	Order No.
320			

No allowable will be assigned to this completion until all interests have been consolidated or a non-standard unit has been approved by division.

OPERATOR CERTIFICATION

I hereby certify that the information contained herein is true and complete to the best of my knowledge and belief, and that this organization either owns a working interest or unleased mineral interest in the land including the proposed bottom hole location or has a right to drill this well at this location pursuant to a contract with an owner of such a mineral or working interest, or to a voluntary pooling agreement or a compulsory pooling order heretofore entered by the division.

Donny G. Glanton 1/18/06
Signature Date

Donny G. Glanton
Printed Name

SURVEYOR CERTIFICATION

I hereby certify that the well location shown on this plat was plotted from field notes of actual surveys made by me or under my supervision, and that the same is true and correct to the best of my belief.

15079
DECEMBER 06, 2005
Date of Survey
Signature and Seal of Professional Surveyor

Terry G. Asel 1/10/20
Certificate Number 15079

WO# 061206WL-s (

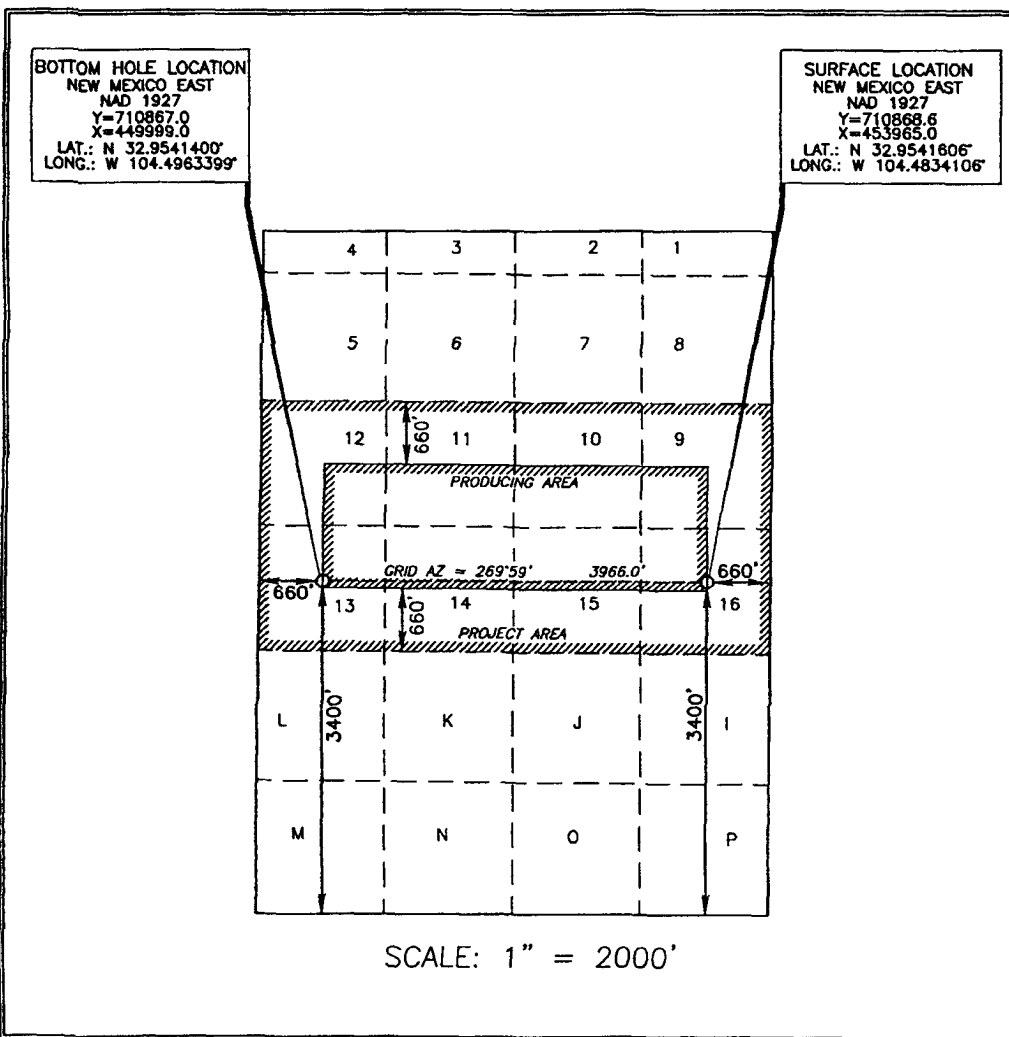

New Mexico Double Horseshoe Reserve Pit Design

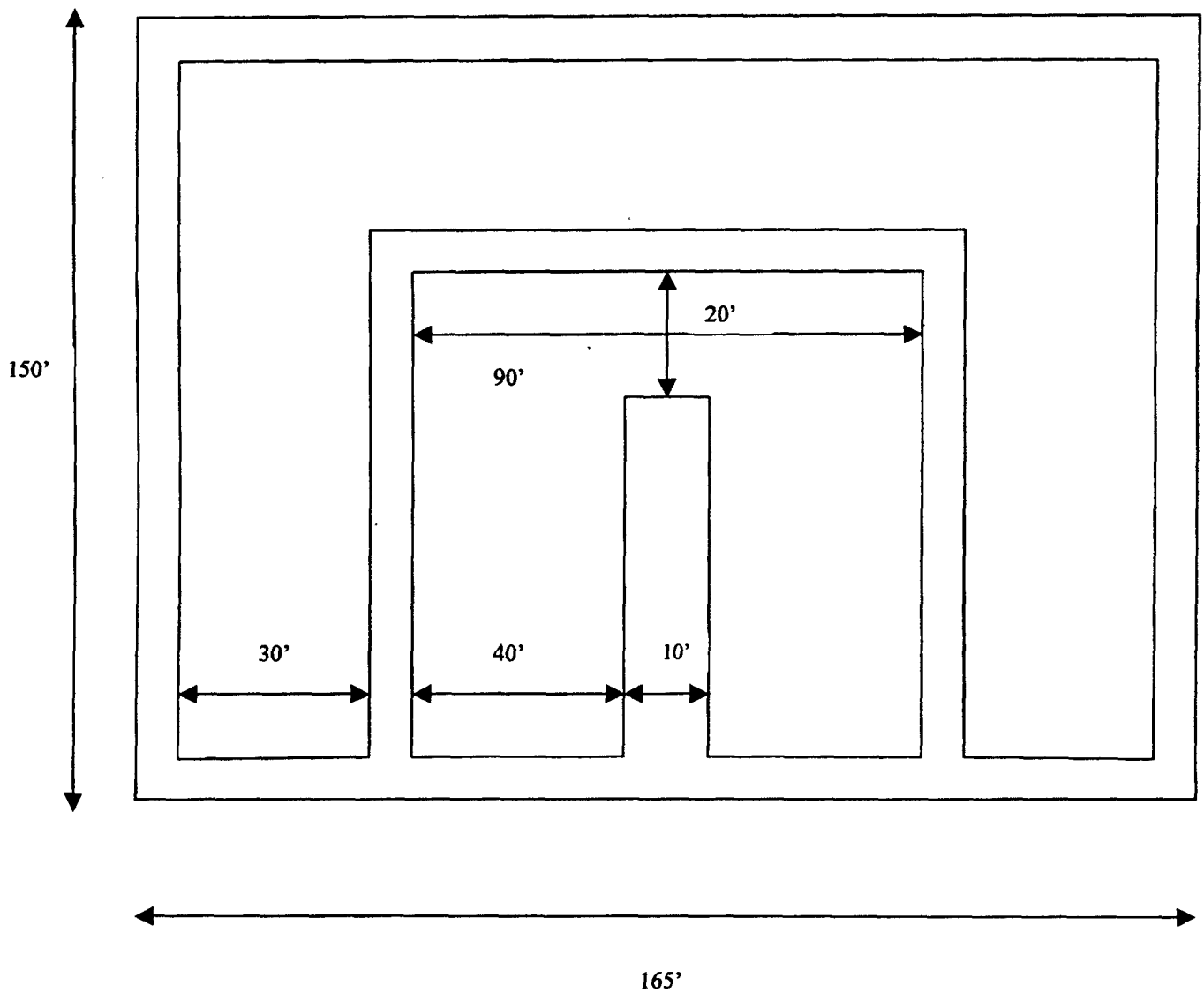

Approximate Inside Reserve Volume: 4500 bbls
Approximate Outside Reserve Volume: 5800 bbls

New Mexico Office of the State Engineer
POD Reports and Downloads

Township: Range: Sections:

NAD27 X: Y: Zone: Search Radius:

County: Basin: Number: Suffix:

Owner Name: (First) (Last) ☐ Non-Domestic ☐ Domestic ☒ All

AVERAGE DEPTH OF WATER REPORT 07/11/2007

(Depth Water in Feet)

Bsn	Tws	Rng	Sec	Zone	X	Y	Wells	Min	Max	Avg
-----	-----	-----	-----	------	---	---	-------	-----	-----	-----

No Records found, try again

New Mexico Office of the State Engineer
POD Reports and Downloads

Township: Range: Sections:

NAD27 X: Y: Zone: Search Radius:

County: Basin: Number: Suffix:

Owner Name: (First) (Last) ☐ Non-Domestic ☐ Domestic ☒ All

AVERAGE DEPTH OF WATER REPORT 07/11/2007

Bsn	Tws	Rng	Sec	Zone	X	Y	Wells	(Depth Water in Feet)		
								Min	Max	Avg
RA	16S	25E	01				5	20	80	38
RA	16S	25E	02				2	42	53	48
RA	16S	25E	03				1	18	18	18
RA	16S	25E	05				1	60	60	60
RA	16S	25E	06				1	27	27	27
RA	16S	25E	07				4	22	60	41
RA	16S	25E	10				6	75	95	81
RA	16S	25E	11				5	75	90	82
RA	16S	25E	12				12	27	87	59
RA	16S	25E	13				11	25	140	89
RA	16S	25E	14				3	40	115	83
RA	16S	25E	15				1	100	100	100
RA	16S	25E	17				1	100	100	100
RA	16S	25E	24				18	50	155	103
RA	16S	25E	25				10	130	176	156
RA	16S	25E	26				1	285	285	285
RA	16S	25E	34				1	140	140	140
RA	16S	25E	36				1	175	175	175

Record Count: 84

