

District I
1625 N. French Dr., Hobbs, NM 88240
District II
1301 W. Grand Avenue, Artesia, NM 88210
District III
1000 Rio Brazos Road, Aztec, NM 87410
District IV
1220 S. St. Francis Dr., Santa Fe, NM 87505

State of New Mexico
Energy Minerals and Natural Resources

Form C-144
June 1, 2004

Oil Conservation Division
1220 South St. Francis Dr.
Santa Fe, NM 87505

For drilling and production facilities, submit to appropriate NMOCD District Office.
For downstream facilities, submit to Santa Fe office

Pit or Below-Grade Tank Registration or Closure

AUG 09 2007

Is pit or below-grade tank covered by a "general plan"? Yes ☒ No ☐

Type of action: Registration of a pit or below-grade tank ☐ Closure of a pit or below-grade tank ☒ NMOCD-ARTESIA

Operator: Burnett Oil Co. Inc Telephone: 505-677-2313 e-mail address: seay@leaco.net
Address: P.O. Box 188 Loco Hills NM 88255
Facility or well name: Stevens A #10 API #: 30-015-32793 U/L or Qtr/Qtr L Sec 13 T 17 R 30
County: Eddy Latitude _____ Longitude _____ NAD: 1927 ☐ 1983 ☐
Surface Owner: Federal ☒ State ☐ Private ☐ Indian ☐

Pit	Below-grade tank
Type: Drilling <input checked="" type="checkbox"/> Production <input type="checkbox"/> Disposal <input type="checkbox"/> Workover <input type="checkbox"/> Emergency <input type="checkbox"/> Lined <input checked="" type="checkbox"/> Unlined <input type="checkbox"/> Liner type: Synthetic <input type="checkbox"/> Thickness <u>12</u> mil Clay <input type="checkbox"/> Pit Volume <u>200</u> bbl	Volume: _____ bbl Type of fluid: _____ Construction material: _____ Double-walled, with leak detection? Yes <input type="checkbox"/> If not, explain why not.
Depth to ground water (vertical distance from bottom of pit to seasonal high water elevation of ground water.) <u>200 + feet</u>	Less than 50 feet (20 points) 50 feet or more, but less than 100 feet (10 points) 100 feet or more (0 points)
Wellhead protection area: (Less than 200 feet from a private domestic water source, or less than 1000 feet from all other water sources.)	Yes (20 points) No (0 points)
Distance to surface water: (horizontal distance to all wetlands, playas, irrigation canals, ditches, and perennial and ephemeral watercourses.)	Less than 200 feet (20 points) 200 feet or more, but less than 1000 feet (10 points) 1000 feet or more (0 points)
	Ranking Score (Total Points) <u>0</u>

If this is a pit closure: (1) Attach a diagram of the facility showing the pit's relationship to other equipment and tanks. (2) Indicate disposal location: (check the onsite box if you are burying in place) onsite ☒ offsite ☐ If offsite, name of facility _____. (3) Attach a general description of remedial action taken including remediation start date and end date. (4) Groundwater encountered: No ☐ Yes ☐ If yes, show depth below ground surface _____ ft. and attach sample results.
5) Attach soil sample results and a diagram of sample locations and excavations.

Additional Comments: Our plan is to deep bury onsite. line trench with 12 mil liner make sure all contents of drilling pit are in lined area. Cover pit with 20 mil liner and 3 ft of clean soil. level and seed.
Notify BLM & OCD before closing. file secondary notice after closing will start soon after approved.

I hereby certify that the information above is true and complete to the best of my knowledge and belief. I further certify that the above-described pit or below-grade tank has been/will be constructed or closed according to NMOCD guidelines ☒, a general permit ☒, or an (attached) alternative OCD-approved plan ☐.

Date: 9/8/07

Printed Name/Title Eddie W Seay Asst Signature Eddie W Seay

Your certification and NMOCD approval of this application/closure does not relieve the operator of liability should the contents of the pit or tank contaminate ground water or otherwise endanger public health or the environment. Nor does it relieve the operator of its responsibility for compliance with any other federal, state, or local laws and/or regulations.

NOTIFY OCD 24 HOURS PRIOR to beginning closure and 24 HOURS PRIOR to obtaining samples. Samples are to be obtained from pit area and analyses submitted to OCD prior to back-filling.

If burial trench is to be constructed in pit area, samples are to be obtained and analyses submitted to OCD PRIOR to lining trench.

Signature

Signed By Mike Brannan

Date:

AUG 09 2007

2

DISTRICT I
P.O. Box 1980, Hobbs, NM 88241-1980

DISTRICT II
P.O. Drawer DD, Artesia, NM 88211-0719

DISTRICT III
1000 Rio Brazos Rd., Artec, NM 87410

DISTRICT IV
P.O. BOX 2088, SANTA FE, N.M. 87504-2088

State of New Mexico
Energy, Minerals and Natural Resources Department

OIL CONSERVATION DIVISION
P.O. Box 2088
Santa Fe, New Mexico 87504-2088

Form C-1
Revised February 10, 19
Submit to Appropriate District Off
State Lease - 4 Cop
Fee Lease - 3 Cop

WELL LOCATION AND ACREAGE DEDICATION PLAT

☐ AMENDED REPORT

API Number 38-015	Pool Code 96831	Pool Name CEDAR LAKE YESO
Property Code 228145	Property Name STEVENS A	Well Number 10
OGRID No. 223082	Operator Name BURNETT OIL COMPANY	Elevation 3701'

Surface Location

UL or lot No.	Section	Township	Range	Lot Idn	Feet from the	North/South line	Feet from the	East/West line	Count
L	13	17-S	30-E		1880	SOUTH	880	WEST	EDC

Bottom Hole Location If Different From Surface

UL or lot No.	Section	Township	Range	Lot Idn	Feet from the	North/South line	Feet from the	East/West line	Count
Dedicated Acres	Joint or Infill	Consolidation Code	Order No.						

NO ALLOWABLE WILL BE ASSIGNED TO THIS COMPLETION UNTIL ALL INTERESTS HAVE BEEN CONSOLIDATED
OR A NON-STANDARD UNIT HAS BEEN APPROVED BY THE DIVISION

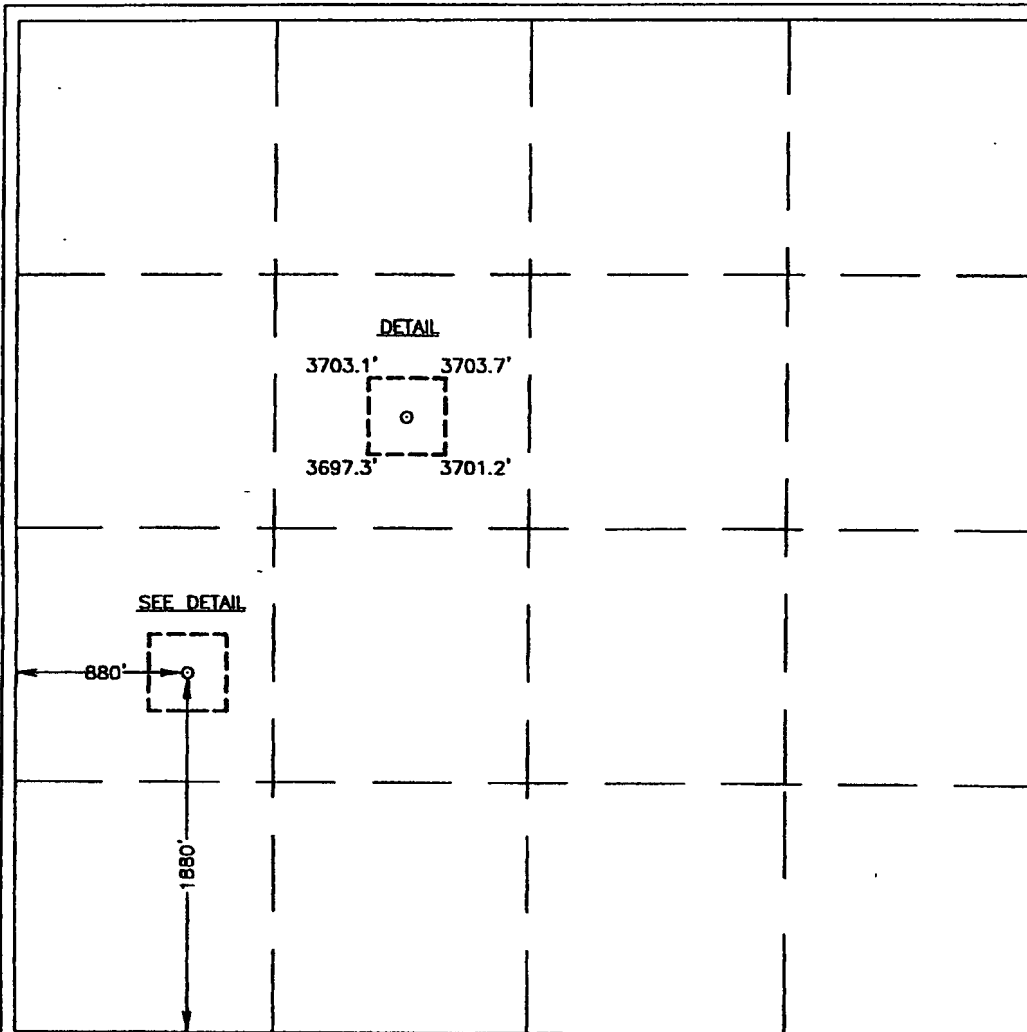

OPERATOR CERTIFICATION

I hereby certify that the information contained herein is true and complete to the best of my knowledge and belief.

Sterling Randolph
Signature

STERLING RANDOLPH

Printed Name

PETROLEUM ENGINEER

Title

MARCH 14, 2003

Date

SURVEYOR CERTIFICATION

I hereby certify that the well location shown on this plat was plotted from field notes of actual surveys made by me or under my supervision, and that the same is true and correct to the best of my belief.

JANUARY 24, 2003

Date Surveyed L.A.

Signature of Professional Surveyor

Ronald G. Edson
Professional Surveyor
NEW MEXICO
1/27/03
Certificate No. RONALD G. EDSON 323
GARY EDSON 126

Groundwater

