

If earthen pits are used in association with the drilling of this well, an OCD pit permit must be obtained prior to pit construction.

SEP 17 2007  
OCD-ARTESIA

ATS-07-590

Form 3160-3  
(August 1999)

UNITED STATES  
DEPARTMENT OF THE INTERIOR  
BUREAU OF LAND MANAGEMENT

RESUBMITTAL

APPLICATION FOR PERMIT TO DRILL OR REENTER

1a. Type of Work: <input checked="" type="checkbox"/> DRILL <input type="checkbox"/> REENTER		5. Lease Serial No. <b>NM-82902</b>
b. Type of Well: <input type="checkbox"/> Oil Well <input checked="" type="checkbox"/> Gas Well <input type="checkbox"/> Other <input checked="" type="checkbox"/> Single Zone <input type="checkbox"/> Multiple Zone		6. If Indian, Allottee or Tribe Name <b>N/A</b>
2. Name of Operator <b>Yates Petroleum Corporation 25575 Capitan Controlled Water Basin</b>		7. If Unit or CA Agreement, Name and No. <b>22903</b>
3A. Address <b>105 South Fourth Street Artesia, New Mexico 88210</b>	3b. Phone No. (include area code) <b>(505) 748-1471</b>	8. Lease Name and Well No. <b>Domino AOJ Fed. Com. #7</b>
4. Location of Well (Report location clearly and in accordance with any State requirements. *) At surface <b>1650' FNL &amp; 660' FWL</b> At proposed prod. Zone <b>Same as above</b>		9. API Well No. <b>30-015-35805</b>
14. Distance in miles and direction from nearest town or post office* <b>15 miles southeast of Loco Hills, New Mexico.</b>		10. Field and Pool, or Exploratory <b>Wildcat Mississippian</b>
15. Distance from proposed* location to nearest property or lease line, ft. (Also to nearest drig. unit line, if any) <b>1650'</b>	16. No. of Acres in lease <b>120.00</b>	11. Sec., T, R., M., or Blk, and Survey or Area <b>Section 8, T19S-R31E</b>
18. Distance from proposed location* to nearest well, drilling, completed, applied for, on this lease, ft. <b>2640'</b>	19. Proposed Depth <b>12,400</b>	12. County or Parish <b>Eddy County</b>
21. Elevations (Show whether DF, KDB, RT, GL, etc.) <b>3506' GL</b>	22. Approximate date work will start* <b>ASAP</b>	13. State <b>NM</b>
23. Estimated duration <b>60 days</b>		

24. Attachments

The following, completed in accordance with the requirements of Onshore Oil and Gas Order No. 1, shall be attached to this form.

- |   |   |
|---|---|
| 1. Well plat certified by a registered surveyor.  | 4. Bond to cover the operations unless covered by an existing bond on file (see Item 20 above).   |
| 2. A Drilling Plan.   | 5. Operator certification.  |
| 3. A Surface Use Plan (if the location is on National Forest System Lands, the SUPO shall be filed with the appropriate Forest Service Office). | 6. Such other site specific information and/or plans as may be required by the authorized office. |

25. Signature <i>Cy Cowan</i>	Name (Printed/Typed) <b>Cy Cowan</b>	Date <b>7/20/2007</b>
----------------------------------	---	--------------------------

Regulatory Agent

Regulatory Agent

Approved by (Signature)

**/s/ Don Peterson**

Name (Printed/Typed)

**/s/ Don Peterson**

Date **SEP 13 2007**

Title **FIELD MANAGER**

Office **CARLSBAD FIELD OFFICE**

Application approval does not warrant or certify that the applicant holds legal or equitable title to those rights in the subject lease which would entitle the applicant to conduct operations thereon.

**APPROVAL FOR TWO YEARS**

Conditions of approval, if any, are attached.

Title 18 U.S.C. Section 1001 and Title 43 U.S.C. Section 1212, make it a crime for any person knowingly and willfully to make to any department or agency of the United States any false, fictitious or fraudulent statements or representations as to any matter within its jurisdiction.

\*(Instructions on reverse) C-144 attached

**SEE ATTACHED FOR  
CONDITIONS OF APPROVAL**

*Previously Approved*

**APPROVAL SUBJECT TO  
GENERAL REQUIREMENTS  
AND SPECIAL STIPULATIONS  
ATTACHED**

**District I**  
1625 N. French Dr., Hobbs, NM 88240  
**District II**  
1301 W. Grand Avenue, Artesia, NM 88210  
**District III**  
1000 Rio Brazos Rd., Aztec, NM 87410  
**District IV**  
1220 S. St. Francis Dr., Santa Fe, NM 87505

State of New Mexico  
Energy, Minerals & Natural Resources Department  
**OIL CONSERVATION DIVISION**  
1220 South St. Francis Dr.  
Santa Fe, NM 87505

Form C-102  
Revised October 12, 2005  
Submit to Appropriate District Office  
State Lease - 4 Copies  
Fee Lease - 3 Copies

☐ AMENDED REPORT

**WELL LOCATION AND ACREAGE DEDICATION PLAT**

<sup>1</sup> API Number		<sup>2</sup> Pool Code 97338		<sup>3</sup> Pool Name Wildcat Mississippian	
<sup>4</sup> Property Code		<sup>5</sup> Property Name Domino "AOJ" Federal Com.			<sup>6</sup> Well Number 7
<sup>7</sup> OGRID No. 025575		<sup>8</sup> Operator Name YATES PETROLEUM CORPORATION			<sup>9</sup> Elevation 3500

<sup>10</sup> Surface Location

UL or lot no. E	Section 8	Township 19S	Range 31E	Lot Idn	Feet from the 1650	North/South line NORTH	Feet from the 660	East/West line WEST	County EDDY
--------------------	--------------	-----------------	--------------	---------	-----------------------	---------------------------	----------------------	------------------------	----------------

<sup>11</sup> Bottom Hole Location If Different From Surface

UL or lot no.	Section	Township	Range	Lot Idn	Feet from the	North/South line	Feet from the	East/West line	County
<sup>12</sup> Dedicated Acres W/2-320		<sup>13</sup> Joint or Infill		<sup>14</sup> Consolidation Code		<sup>15</sup> Order No.			

No allowable will be assigned to this completion until all interests have been consolidated or a non-standard unit has been approved by the division.

<sup>16</sup> <div style="display: flex; justify-content: space-between;"> <div style="border: 1px solid black; padding: 5px;"> NM-101112 1650' </div> <div style="border: 1px solid black; padding: 5px;"> NM-82902 </div> </div>		<sup>17</sup> <b>OPERATOR CERTIFICATION</b> I hereby certify that the information contained herein is true and complete to the best of my knowledge and belief, and that this organization either owns a working interest or unleased mineral interest in the land including the proposed bottom hole location or has a right to drill this well at this location pursuant to a contract with an owner of such a mineral or working interest, or to a voluntary pooling agreement or a compulsory pooling order heretofore entered by the division <div style="display: flex; justify-content: space-between;"> <div> <i>[Signature]</i>  Signature  Cy Cowan  Printed Name </div> <div> 7/23/2007  Date  Regulatory Agent </div> </div>	
<div style="border: 1px solid black; padding: 5px;"> NM-94614 </div>			

Form C-103

Revised March 17, 1989

Instruction on back  
Submit to Appropriate District Office  
State Lease - 4 Copies  
Fee Lease - 3 Copies

State of New Mexico  
Energy, Minerals and Natural Resources Department

OIL CONSERVATION DIVISION  
P.O. Box 2088  
Santa Fe, New Mexico 87504-2088

☐ AMENDED REPORT

WELL LOCATION AND ACREAGE DEDICATION PLAT

API Number	Pool Code	Pool Name
		Wildcat Mississippian
Property Code	Property Name	Well Number
	DOMINO "AOJ" FEDERAL COM.	7
OCRD No.	Operator Name	Elevation
025575	YATES PETROLEUM CORPORATION	3500

Surface Location

UL or lot No.	Section	Township	Range	Lot Lin	Feet from the	North/South Line	Feet from the	East/West Line	County
E	8	19S	31E		1650	NORTH	660	WEST	EDDY

Bottom Hole Location If Different From Surface

UL or lot No.	Section	Township	Range	Lot Lin	Feet from the	North/South Line	Feet from the	East/West Line	County

Dedicated Acres	Joint or Infill	Consolidation Code	Order No.
320			

NO ALLOWABLE WILL BE ASSIGNED TO THIS COMPLETION UNTIL ALL INTERESTS HAVE BEEN CONSOLIDATED  
OR A NON-STANDARD UNIT HAS BEEN APPROVED BY THE DIVISION

	<p><b>OPERATOR CERTIFICATION</b></p> <p>I hereby certify that the information contained herein is true and complete to the best of my knowledge and belief.</p> <p><i>Cy Cowan</i></p> <p>Signature</p> <p>Cy Cowan</p> <p>Printed Name</p> <p>Regulatory Agent</p> <p>Title</p> <p>June 12, 2001</p> <p>Date</p>	
	<p><b>SURVEYOR CERTIFICATION</b></p> <p>I hereby certify that the well location shown on this plat was plotted from field notes of actual surveys made by me or under my supervision, and that the same is true and correct to the best of my belief.</p> <p>6/07/2001</p> <p>Date Surveyed</p> <p>Signature &amp; Seal of Professional Surveyor</p> <p><i>Herschell L. Jones</i></p> <p>Herschell L. Jones</p> <p>Certificate No. Herschel L. Jones RLS 3640</p> <p>DOMINO 7</p> <p>GENERAL SURVEYING COMPANY</p> <p>PROFESSIONAL</p>	

# YATES PETROLEUM CORPORATION

Domino AOJ Federal Com. #7

1650' FNL & 660' FWL

Section. 8 -T19S-R31-E

Eddy County, New Mexico

1. The estimated tops of geologic markers are as follows:

Yates	2340'	Oil Pay
Queen	3450'	Oil Pay
Bone Springs	6750'	Oil Pay
Wolfcamp	9900'	Oil Pay
Strawn	10900'	Gas Pay
Atoka	11100'	Gas Pay
Morrow Clastic	11650'	Gas Pay
Chester	12150'	Gas Pay
TD	12400'	Gas Pay

2. The estimated depths at which anticipated water, oil or gas formations are expected to be encountered:

Water: Approximately 250' - 350'  
Oil or Gas: All Potential Zones

3. Pressure Control Equipment: BOPE will be installed on the 8 5/8" casing and rated for 5000 BOP systems will be consistent with API RP 53. Pressure tests will be conducted before drilling out from under all casing strings which are set and cemented in place. Blowout Preventor controls will be installed prior to drilling the surface plug and will remain in use until the well is completed or abandoned. Preventors will be inspected and operated at least daily to ensure good mechanical working order, and this inspection recorded on the daily drilling report. See Exhibit B.

## Auxiliary Equipment:

A. Auxiliary Equipment: Kelly cock, pit level indicators, flow sensor equipment and a sub with full opening valve to fit the drill pipe and collars will be available on the rig floor in the open position at all times for use when kelly is not in use.

4. THE PROPOSED CASING AND CEMENTING PROGRAM:

## A. Casing Program: (All New)

Hole Size	Casing Size	Wt./Ft	Grade	Coupling	Interval	Length
17 1/2"	13 3/8"	48#	H-40	ST&C	0-600'	600'
12 1/4"	8 5/8"	32#	J-55	ST&C	0-3500'	3500'
7 7/8"	5 1/2"	17#	L-80	LT&C	0-3300'	3300'
7 7/8"	5 1/2"	17#	J-55	LT&C	3300-7400'	4100'
7 7/8"	5 1/2"	17#	N-80	LT&C	7400-10400'	3000'
7 7/8"	5 1/2"	20#	P-110	LT&C	10400-12400'	1000'

Minimum Casing Design Factors: Collapse 1.125, Burst 1.0, Joint Strength 1.8

CO

B. CEMENTING PROGRAM:

Surface casing: 250 sx Lite (Yld 2.01 Wt.12.4) Tail in w/200 sx "C" (Yld 1.34 Wt 14.8)  
TOC-Surface

Intermediate Casing: 1300 sx Lite (Yld 2.06 Wt 12.4); Tail in w/200 sx "C"  
(Yld 1.32 Wt. 14.8) TOC-Surface

Production Casing: 975 sx Super "C" (Yld 1.67 wt. 13.0). TOC-6200',

5. Mud Program and Auxiliary Equipment:

<u>Interval</u>	<u>Type</u>	<u>Weight</u>	<u>Viscosity</u>	<u>Fluid Loss</u>
0-600'	FW/Spud Mud	8.4-9.0	32-36	N/C
600'-3500'	Brine	10.0-10.2	28	N/C
3500'-10900'	Cut Brine	8.8-9.2	28	N/C
10900'-TD	Salt Gel/Starch/Drispac	9.5-10.0	32-40	<12

Sufficient mud material(s) to maintain mud properties, control lost circulation and contain a blow out will be available at the well site during drilling operations. Mud will be checked hourly by rig personnel.

6. EVALUATION PROGRAM:

Samples: 10 samples out from under surface casing.

Logging: GR, NEUTRON, DENSITY, LATERLOG.

Coring: As warranted.

DST's: As warranted.

7. Abnormal Conditions, Bottom hole pressure and potential hazards:

Anticipated BHP:

From: 0	TO: 600'	Anticipated Max. BHP:	250	PSI
From: 600'	TO: 3500'	Anticipated Max. BHP:	1800	PSI
From: 3500'	TO: TD	Anticipated Max. BHP:	6400	PSI

No abnormal pressures or temperatures are anticipated.

Lost Circulation Zones Anticipated: None.

H2S Zones Anticipated: None

8. ANTICIPATED STARTING DATE:

Plans are to drill this well as soon as possible after receiving approval. It should take approximately 45 days to drill the well with completion taking another 15 days.

## Domino AOJ Federal Com. #7 Production Casing Des

0 ft to 3,000 ft				Make up Torque	
O.D.	Weight	Grade	Threads	opt.	min.
5.5 inches	17 #/ft	L-80	LT&C	3410	2560
Collapse Resistance	Internal Yield	Joint Strength		Body Yield	
6,290	7,740 psi	338 ,000 #		397 ,000 #	

3,000 ft to 7,500 ft				Make up Torque	
O.D.	Weight	Grade	Threads	opt.	min.
5.5 inches	17 #/ft	J-55	LT&C	2470	1850
Collapse Resistance	Internal Yield	Joint Strength		Body Yield	
4,910	5,320 psi	247 ,000 #		273 ,000 #	

7,500 ft to 12,400 ft				Make up Torque	
O.D.	Weight	Grade	Threads	opt.	min.
5.5 inches	17 #/ft	HCP-110	LT&C	4620	3470
Collapse Resistance	Internal Yield	Joint Strength		Body Yield	
8,580 psi	10,640 psi	445 ,000 #		546 ,000 #	

## sign

ft-lbs	Total ft = 3,000
mx.	
4260	
Drift	
4.767	

ft-lbs	Total ft = 4,500
mx.	
3090	
Drift	
4.767	

ft-lbs	Total ft = 4,900
mx.	
5780	
Drift	
4.767	

**Yates Petroleum Corporation**  
106 SOUTH 4th STREET  
ARTESIA, NEW MEXICO 88210

Domino AOU Federal Com. #7  
1650' FWL and 1980' FWL  
Section 8, T19S-R31E  
Eddy County, New Mexico  
NM-82902

**Yates Petroleum Corporation**  
Location Layout for Permian Basin  
12,000' to 14,000'

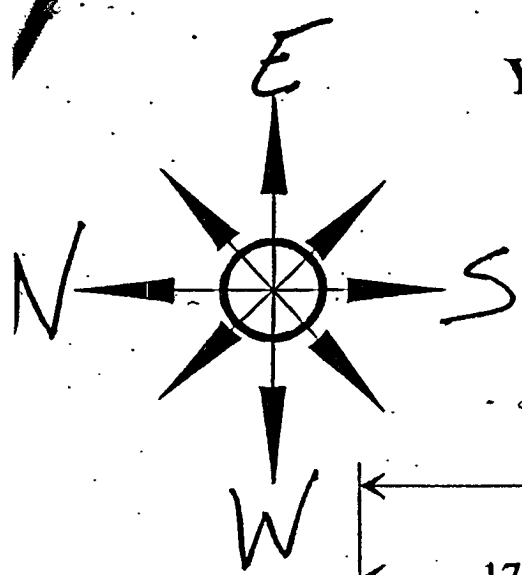

*Pits to the  
East North east  
v Don South Southeast*

*See  
Special  
Drilling  
Steps*

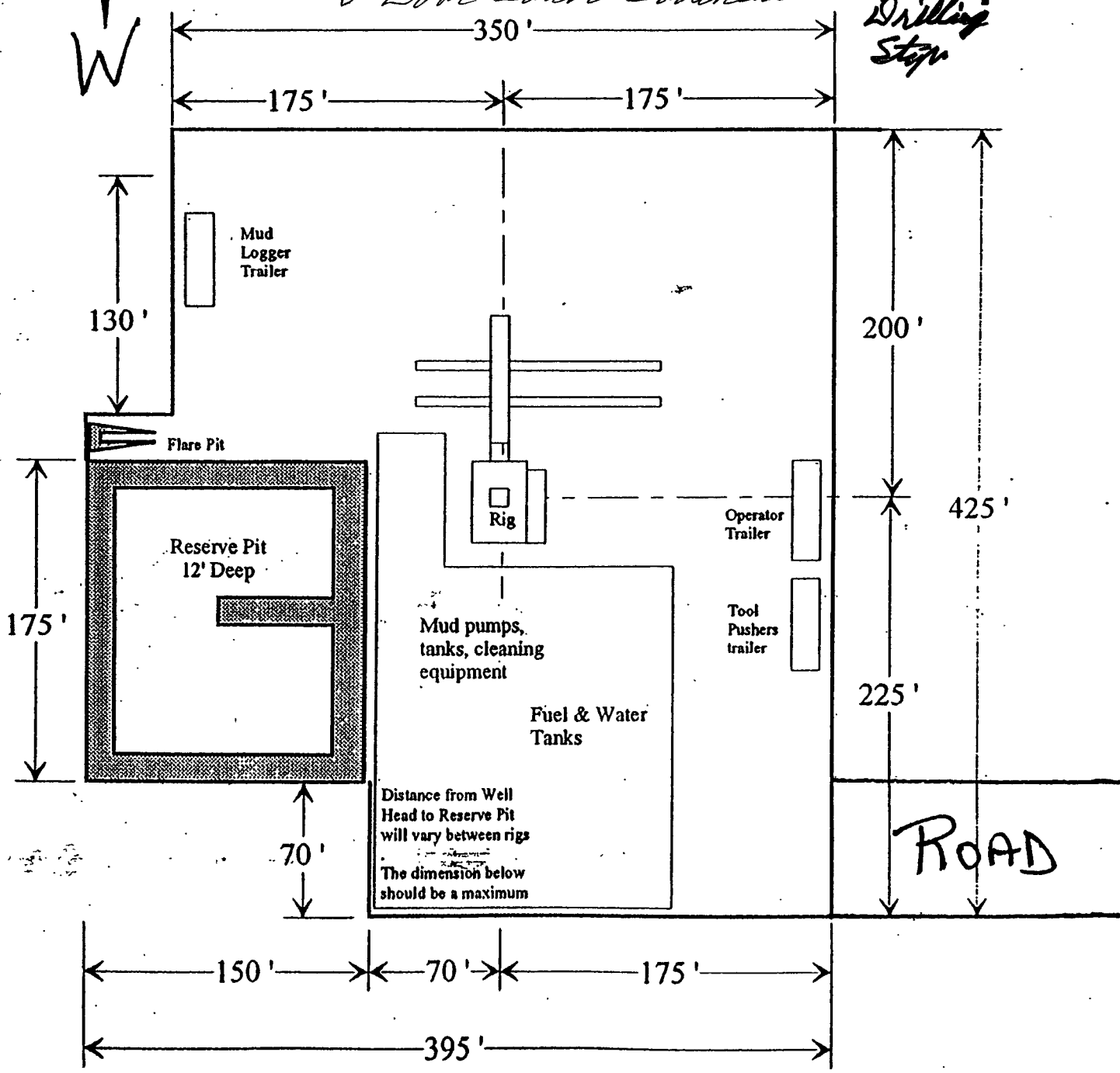





## **MULTI-POINT SURFACE USE AND OPERATIONS PLAN**

**Yates Petroleum Corporation**

Domino AOJ Federal Com. #7

1650' FNL & 660' FWL

Section. 8, T-19S-R31-E

Eddy County, New Mexico

This plan is submitted with Form 3160-3, Application for Permit to Drill, covering the above described well. The purpose of this plan is to describe the location of the proposed well, the proposed construction activities and operations plan, the magnitude of the surface disturbance involved and the procedures to be followed in rehabilitating the surface after completion of the operations, so that a complete appraisal can be made of the environmental effect associated with the operations.

### **1. EXISTING ROADS:**

Exhibit A is a portion of the BLM map showing the well and roads in the vicinity of the proposed location. The proposed wellsite is located approximately 15 miles southeast of Loco Hills, New Mexico and the access route to the location is indicated in red and green on Exhibit A.

#### **DIRECTIONS:**

Go east of Loco Hills on Highway 82 approx. 4.8 miles to County Road (222) Sugart Road. Turn south and go approx. 10 miles cattle guard on right. Turn west, crossing cattle guard and go on caliche road for approx. 1 mile. Turn north here and go 0.3 of a mile toward the Domino AOJ #5 well. The new road starts here going west for approx. 0.5 of a mile to the southeast corner of the well location.

### **2. PLANNED ACCESS ROAD.**

- A. The proposed new access will go north for approximately 0.3 of a mile on the existing two-track road to the southwest corner of the drilling pad. The road will lie in a south to north direction.
- B. The new road will be 14 feet in width (driving surface) and will be adequately drained to control runoff and soil erosion.
- C. The new road will be bladed with drainage on one side. Traffic turnout may be built.
- D. The route of the road is visible.
- E. Existing roads will be maintained in the same or better condition.

### **3. LOCATION OF EXISTING WELL**

- A. There is drilling activity within a one-mile radius of the wellsite.
- B. Exhibit D shows existing wells within a one-mile radius of the proposed wellsite.

### **4. LOCATION OF EXISTING AND/OR PROPOSED FACILITIES**

- A. There are production facilities on this lease at the present time.
- B. In the event that the well is productive, the necessary production facilities will be installed on the drilling pad. If the well is productive oil, a gas or diesel self-contained unit will be used to provide the necessary power. No power will be required if the well is productive of gas.

5. LOCATION AND TYPE OF WATER SUPPLY:

- A. It is planned to drill the proposed well with a fresh water system. The water will be obtained from commercial sources and will be hauled to the location by truck over the existing and proposed roads shown in Exhibit A.

6. SOURCE OF CONSTRUCTION MATERIALS:

Dirt contractor will locate closest pit and obtain any permits and materials needed for construction.

7. METHODS OF HANDLING WASTE DISPOSAL:

- A. Drill cuttings will be disposed of in the reserve pits.
- B. Drilling fluids will be allowed to evaporate in the reserve pits until the pits are dry.
- C. Water produced during operations will be collected in tanks until hauled to an approved disposal system, or separate disposal application will be submitted.
- D. Oil produced during operations will be stored in tanks until sold.
- E. Current laws and regulations pertaining to the disposal of human waste will be complied with.
- F. All trash, junk, and other waste materials will be contained in trash cages or bins to prevent scattering and will be removed and deposited in an approved sanitary land fill. Burial on site is not approved.

8. ANCILLARY FACILITIES: None.

9. WELLSITE LAYOUT:

- A. Exhibit C shows the relative location and dimensions of the well pad, the reserve pits, the location of the drilling equipment, rig orientation and access road approach.
- B. The reserve pits will be plastic lined.
- C. A 400' x 400' area has been staked and flagged.

10. PLANS FOR RESTORATION

- A. After finishing drilling and/or completion operations, all equipment and other material not needed for further operations will be removed. The location will be cleaned of all trash and junk to leave the wellsite in as aesthetically pleasing a condition as possible.
- B. Unguarded pits, if any, containing fluids will be fenced until they have dried and been leveled.
- C. If the proposed well is non-productive, all rehabilitation and/or vegetation requirements of the Bureau of Land Management will be complied with and will be accomplished as expeditiously as possible. All pits will be filled level after they have evaporated and dried.

11. SURFACE OWNERSHIP: Federal surface, Administered by the Bureau of Land Management, Carlsbad, New Mexico.

12. OTHER INFORMATION:

- A. Topography: Refer to the existing archaeological report for a description of the topography, flora, fauna, soil characteristics, dwellings, historical and cultural sites.
- B. The primary surface use is for grazing.

13. OPERATOR'S REPRESENTATIVE

- A. Through A.P.D. Approval:

Cy Cowan, Regulatory Agent  
Yates Petroleum Corporation  
105 South Fourth Street  
Artesia, New Mexico 88210  
Phone (505) 748-1471

- B. Through Drilling Operations,  
Completions and Production:

Ray Stall,  
Operations Manager  
Yates Petroleum Corporation  
105 South Fourth Street  
Artesia, New Mexico 88210  
Phone (505) 748-1471

CERTIFICATION  
YATES PETROLEUM CORPORATION  
Domino AOJ Federal Com #7

I hereby certify that I, or someone under my direct supervision, have inspected the drill site and access route proposed herein; that I am familiar with the conditions which currently exist; that I have full knowledge of state and federal laws applicable to this operation; that the statements made in this APD package are, to the best of my knowledge, true and correct; and that the work associated with the operations proposed herein will be performed in conformity with this APD package and the terms and conditions under which it is approved. I also certify that I, or the company I represent, am responsible for the operations conducted under this application. These statements are subject to the provisions of 18 U.S.C. 1001 for the filing of false statements.

Executed this 24<sup>th</sup> day of July, 2007.

Name Paul A. Lopez for Cy Cowan

Position Title Regulatory Agent

Address 105 South Fourth Street, Artesia, NM 88210

Telephone \_\_\_\_\_

Field Representative (if not above signatory) Jim Krogman

Address (if different from above) Same

Telephone (if different from above) 505-748-4215

E-mail (optional) \_\_\_\_\_

## B. CASING

1. The 13.375 inch surface casing shall be set **above the salt, at least 25 feet into the Rustler Anhydrite @ approximately 600 feet** and cemented to the surface.
  - a. If cement does not circulate to the surface, the appropriate BLM office shall be notified and a temperature survey utilizing an electronic type temperature survey with a surface log readout will be used or a cement bond log shall be run to verify the top of the cement.
  - b. Wait on cement (WOC) time for a primary cement job will be a minimum 18 hours for a water basin, 24 hours in the potash area, or 500 pounds compressive strength, whichever is greater. (This is to include the lead cement).
  - c. Wait on cement (WOC) time for a remedial job will be a minimum of 4 hours after bringing cement to surface or 500 pounds compressive strength, whichever is greater.
  - d. If cement falls back, remedial action will be done prior to drilling out that string.
2. The minimum required fill of cement behind the 8.625 inch intermediate casing is:
  - ☒ Cement to surface. If cement does not circulate see B.1.a-d above.
3. The minimum required fill of cement behind the 5.5 inch production casing is:
  - ☒ Cement should tie-back at least 500 feet into previous casing string and cover the top of the J-55 grade 5.5" casing. Operator shall provide method of verification. **This proposed modified casing string can only be run if the well bore is standing full of mud at the time that the casing is run.**
4. If hardband drill pipe is rotated inside casing, returns will be monitored for metal. If metal is found in samples, drill pipe will be pulled and rubber protectors which have a larger diameter than the tool joints of the drill pipe will be installed prior to continuing drilling operations.

### **C. PRESSURE CONTROL**

1. All blowout preventer (BOP) and related equipment (BOPE) shall comply with well control requirements as described in Onshore Oil and Gas Order No. 2 and API RP 53 Sec. 17.
2. Minimum working pressure of the blowout preventer (BOP) and related equipment (BOPE) required for drilling below the surface casing shoe shall be 2000 (2M) psi.
3. Minimum working pressure of the blowout preventer (BOP) and related equipment (BOPE) required for drilling below the 8.625 intermediate casing shoe shall be 5000(5m) psi.
4. The appropriate BLM office shall be notified a minimum of 4 hours in advance for a representative to witness the tests.
  - a. The tests shall be done by an independent service company.
  - b. The results of the test shall be reported to the appropriate BLM office.
  - c. All tests are required to be recorded on a calibrated test chart. A copy of the BOP/BOPE test chart and a copy of independent service company test will be submitted to the appropriate BLM office.
  - d. The BOP/BOPE test shall include a low pressure test from 250 to 300 psi. The test will be held for a minimum of 10 minutes if test is done with a test plug and 30 minutes without a test plug.
  - e. The formation below the shoe of the 8.625 inch intermediate will be tested according to Onshore Order # 2.III.B.1.i.

### **D. DRILLING MUD**

Mud system monitoring equipment, with derrick floor indicators and visual and audio alarms, shall be operating before drilling into the Wolfcamp formation, and shall be used until production casing is run and cemented.

### **E. DRILL STEM TEST**

If drill stem tests are performed, Onshore Order 2.III.D shall be followed.

**F. HAZARDS**

1. Our geologist has indicated that there is potential for lost circulation in the Artesia group and the Capitan Reef.
2. Our geologist has indicated that there is potential for flows in the Artesia group.
3. Our geologist has indicated that there is potential for abnormal pressure in the Wolfcamp formation and the Pennsylvanian system.

Engineering can be reached @ 505-706-2779 for variances.

FWright: 8/23/07 (date)