

District I  
1625 N French Dr, Hobbs, NM 88240  
District II  
1301 W Grand Avenue, Artesia, NM 88210  
District III  
1000 Rio Brazos Road, Aztec, NM 87410  
District IV  
1220 S St Francis Dr, Santa Fe, NM 87505

State of New Mexico  
Energy Minerals and Natural Resources

Form C-101  
May 27, 2004

Oil Conservation Division  
1220 South St. Francis Dr.  
Santa Fe, NM 87505

Submit to appropriate District Office

☐ AMENDED REPORT

**APPLICATION FOR PERMIT TO DRILL, RE-ENTER, DEEPEN, PLUGBACK, OR ADD A ZONE**

|  |   |   |
|--|---|---|
| <sup>1</sup> Operator Name and Address<br>Yates Petroleum Corporation<br>105 S 4 <sup>th</sup> Street<br>Artesia, NM 88210 |   | <sup>2</sup> OGRID Number<br>025575     |
|  |   | <sup>3</sup> API Number<br>30-015-35098 |
| <sup>4</sup> Property Code<br>35939  | <sup>5</sup> Property Name<br>Mosley Canyon BIA State Com | <sup>6</sup> Well No<br>1               |
| <sup>9</sup> Proposed Pool 1<br>Wildcat, Wolfcamp  |   | <sup>10</sup> Proposed Pool 2           |

**<sup>7</sup> Surface Location**

|                   |              |                 |              |         |                      |                           |                      |                        |                |
|-------------------|--------------|-----------------|--------------|---------|----------------------|---------------------------|----------------------|------------------------|----------------|
| UL or lot no<br>A | Section<br>5 | Township<br>24S | Range<br>25E | Lot Idn | Feet from the<br>660 | North/South line<br>North | Feet from the<br>660 | East/West line<br>East | County<br>Eddy |
|-------------------|--------------|-----------------|--------------|---------|----------------------|---------------------------|----------------------|------------------------|----------------|

**<sup>8</sup> Proposed Bottom Hole Location If Different From Surface**

|              |         |          |       |         |               |                  |               |                |        |
|--------------|---------|----------|-------|---------|---------------|------------------|---------------|----------------|--------|
| UL or lot no | Section | Township | Range | Lot Idn | Feet from the | North/South line | Feet from the | East/West line | County |
|--------------|---------|----------|-------|---------|---------------|------------------|---------------|----------------|--------|

**Additional Well Information**

|  |                                     |  |                                    |   |
|--|-------------------------------------|--|------------------------------------|---|
| <sup>11</sup> Work Type Code<br>P                | <sup>12</sup> Well Type Code<br>G   | <sup>13</sup> Cable/Rotary<br>N/A      | <sup>14</sup> Lease Type Code<br>S | <sup>15</sup> Ground Level Elevation<br>3814'GR |
| <sup>16</sup> Multiple<br>N                      | <sup>17</sup> Proposed Depth<br>N/A | <sup>18</sup> Formation<br>Morrow      | <sup>19</sup> Contractor<br>N/A    | <sup>20</sup> Spud Date<br>ASAP                 |
| Depth to Groundwater                             |                                     | Distance from nearest fresh water well |                                    | Distance from nearest surface water             |
| <sup>21</sup> Proposed Casing and Cement Program |                                     |  |                                    |   |

Pit Liner Synthetic ☐ \_\_\_\_\_ mils thick Clay ☐ Pit Volume \_\_\_\_\_ bbls Drilling Method \_\_\_\_\_  
Closed-Loop System ☒ Fresh Water ☐ Brine ☐ Diesel/Oil-based ☐ Gas/Air ☐

**<sup>21</sup> Proposed Casing and Cement Program**

|           |             |                    |               |                 |               |
|-----------|-------------|--------------------|---------------|-----------------|---------------|
| Hole Size | Casing Size | Casing weight/foot | Setting Depth | Sacks of Cement | Estimated TOC |
|           |             |                    |               |                 |               |
|           |             |                    |               |                 |               |
|           |             |                    |               |                 |               |
|           |             |                    |               |                 |               |

IN PLACE

<sup>22</sup> Describe the proposed program. If this application is to DEEPEN or PLUG BACK, give the data on the present productive zone and proposed new productive zone. Describe the blowout prevention program, if any. Use additional sheets if necessary.

Yates Petroleum Corporation plans to plugback and recompleat this well as follows: Set a 7" CIBP at 9608' with 35' cement on top. Perforate Wolfcamp 9250'-9254' (5), 9282'-9290' (9), 9354'-9360' (7) and 9376'-9380' (5). Stimulate as needed.

<sup>23</sup> I hereby certify that the information given above is true and complete to the best of my knowledge and belief. I further certify that the drilling pit will be constructed according to NMOC guidelines ☐, a general permit ☐, or an (attached) alternative OCD-approved plan ☐.

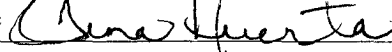
Signature 

Printed name Tina Huerta

Title Regulatory Compliance Supervisor

E-mail Address tina@ypcnm.com

Date October 26, 2007

Phone 505-748-4168

**OIL CONSERVATION DIVISION**

Approved by

**BRYAN G. ARRAnt**

**DISTRICT II GEOLOGIST**

Approval Date

**OCT 30 2007**

Expiration Date

**OCT 30 2008**

Conditions of Approval Attached ☐

# Yates Petroleum Corporation

## Typical 3,000 psi Pressure System Schematic

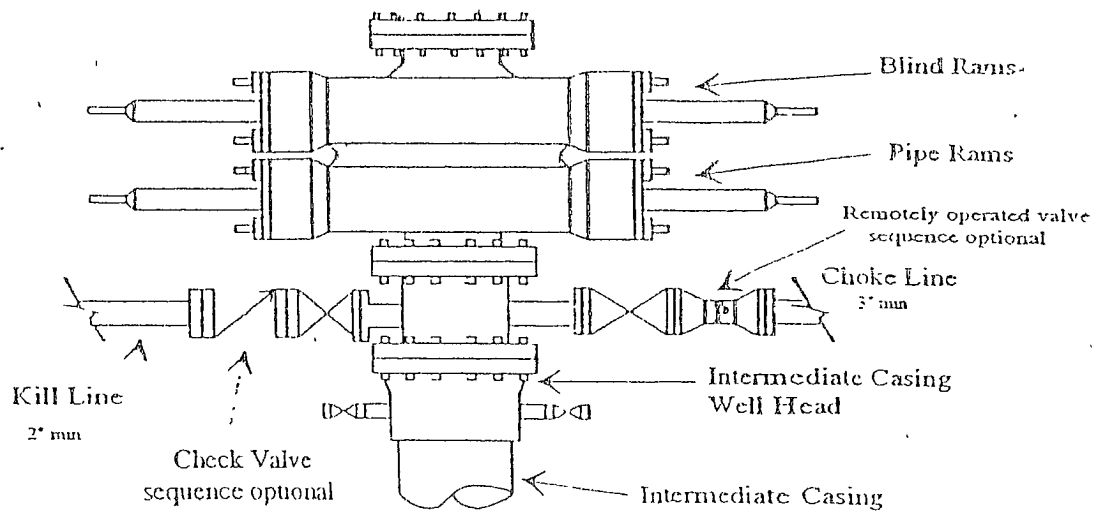

Typical 3,000 psi choke manifold assembly with at least these minimum features

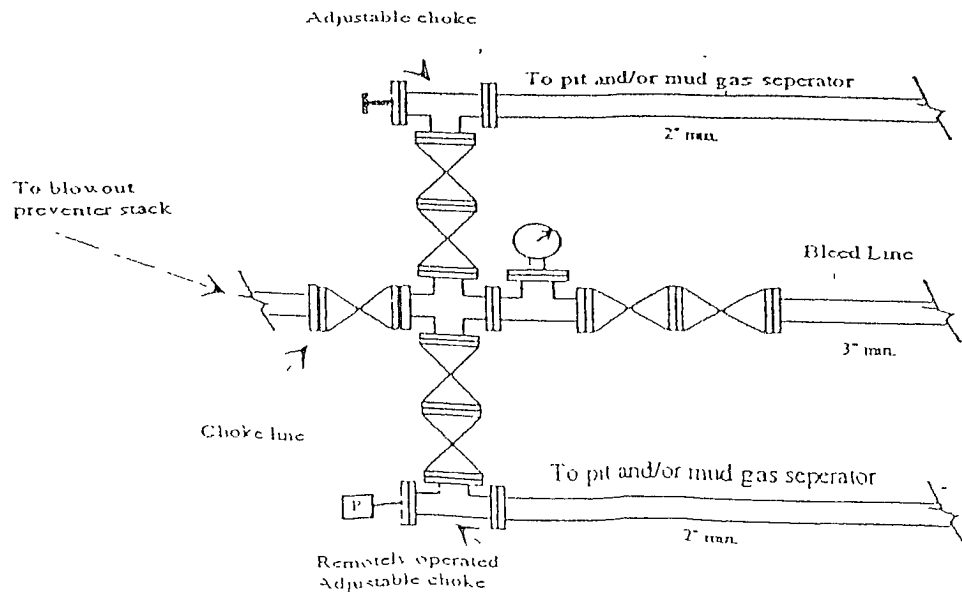

WELL NAME: Mosley Canyon BIA State Com #1

FIELD: Mosley Canyon

LOCATION: 660' FNL & 660' FEL Sec 5-24S-25E

Eddy County

GL: 3,814' ZERO: 17' KB: 3,831'

SPUD DATE: COMPLETION DATE:

COMMENTS: API No.: 30-015-35098

# CASING PROGRAM

|                          |        |
|--------------------------|--------|
| 13-3/8" 48# H40 ST&C     | 470'   |
| 9-5/8" 36#, 40# J55 ST&C | 2,603' |
| 7" 26# L80               | 2,141' |
| 7" 26# J55               | 4,668' |
| 7" 26# HCP110            | 4567'  |
|                          | 11,350 |

After

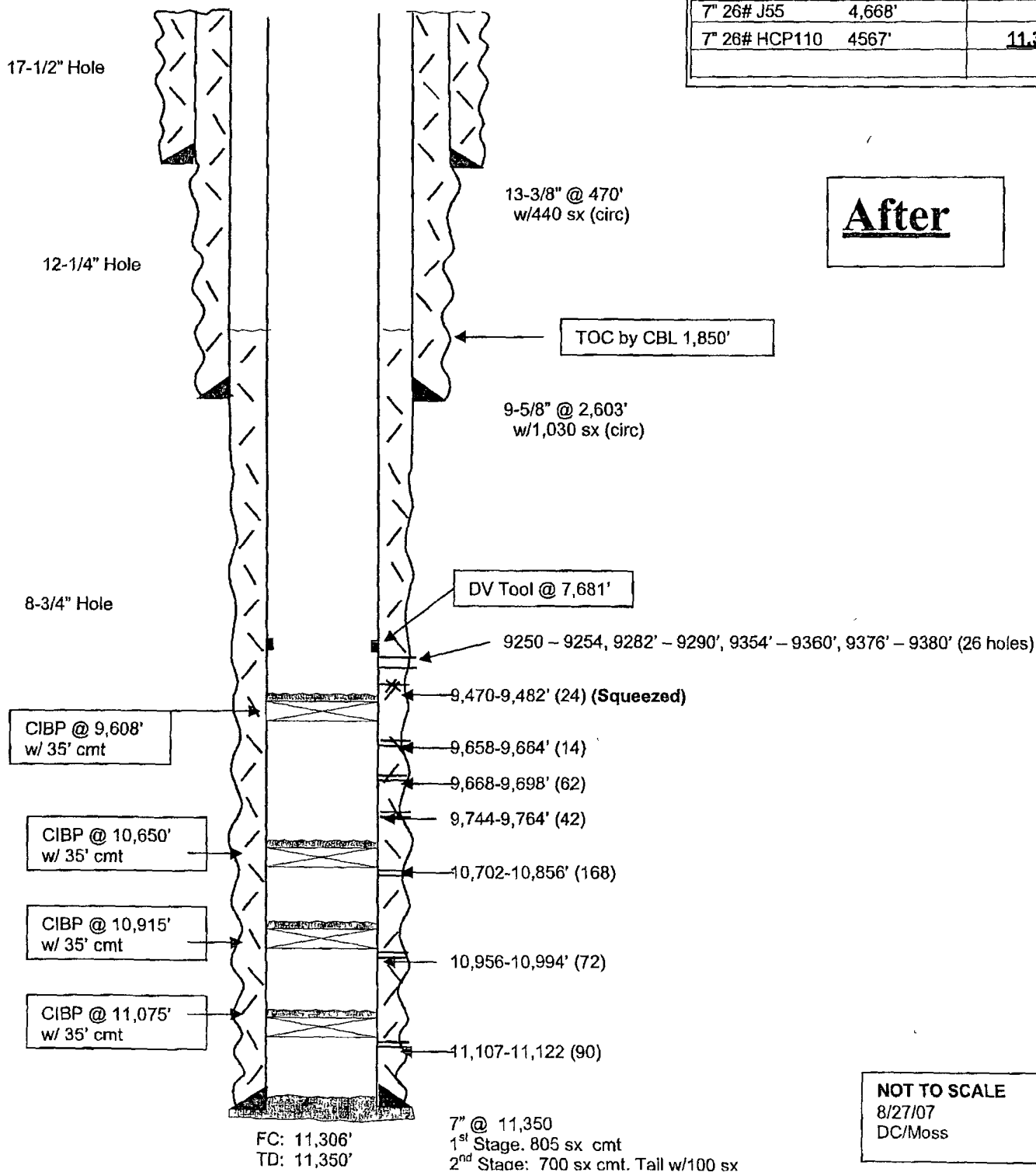

District I  
1625 N. French Dr., Hobbs, NM 88240  
District II  
1301 W. Grand Avenue, Artesia, NM 88210  
District III  
1000 Rio Brazos Rd., Aztec, NM 87410  
District IV  
1220 S. St. Francis Dr., Santa Fe, NM 87505

State of New Mexico  
Energy, Minerals & Natural Resources Department  
**OIL CONSERVATION DIVISION**  
1220 South St. Francis Dr.  
Santa Fe, NM 87505

Form C-102  
Revised October 12, 2005  
Submit to Appropriate District Office  
State Lease - 4 Copies  
Fee Lease - 3 Copies  
☐ AMENDED REPORT

**WELL LOCATION AND ACREAGE DEDICATION PLAT**

|  |  |  |
|--|--|--|
| <sup>1</sup> API Number<br><b>30-015-35098</b> | <sup>2</sup> Pool Code<br><b>97489</b>                           | <sup>3</sup> Pool Name<br><b>Wildcat; Wolfcamp</b> |
| <sup>4</sup> Property Code<br><b>35939</b>     | <sup>5</sup> Property Name<br><b>Mosley Canyon BIA State Com</b> |  |
| <sup>7</sup> OGRID No.<br><b>025575</b>        | <sup>8</sup> Operator Name<br><b>Yates Petroleum Corporation</b> |  |
|  |  | <sup>6</sup> Well Number<br><b>1</b>               |
|  |  | <sup>9</sup> Elevation<br><b>3814'GR</b>           |

<sup>10</sup> Surface Location

|                           |                     |                        |                     |         |                             |                                  |                             |                               |                       |
|---------------------------|---------------------|------------------------|---------------------|---------|-----------------------------|----------------------------------|-----------------------------|-------------------------------|-----------------------|
| UL or lot no.<br><b>A</b> | Section<br><b>5</b> | Township<br><b>24S</b> | Range<br><b>25E</b> | Lot Idn | Feet from the<br><b>660</b> | North/South line<br><b>North</b> | Feet from the<br><b>660</b> | East/West line<br><b>East</b> | County<br><b>Eddy</b> |
|---------------------------|---------------------|------------------------|---------------------|---------|-----------------------------|----------------------------------|-----------------------------|-------------------------------|-----------------------|

<sup>11</sup> Bottom Hole Location If Different From Surface

|               |         |          |       |         |               |                  |               |                |        |
|---------------|---------|----------|-------|---------|---------------|------------------|---------------|----------------|--------|
| UL or lot no. | Section | Township | Range | Lot Idn | Feet from the | North/South line | Feet from the | East/West line | County |
|---------------|---------|----------|-------|---------|---------------|------------------|---------------|----------------|--------|

|   |                               |                                  |                         |
|---|-------------------------------|----------------------------------|-------------------------|
| <sup>12</sup> Dedicated Acres<br><b>320</b> | <sup>13</sup> Joint or Infill | <sup>14</sup> Consolidation Code | <sup>15</sup> Order No. |
|---|-------------------------------|----------------------------------|-------------------------|

No allowable will be assigned to this completion until all interests have been consolidated or a non-standard unit has been approved by the division.

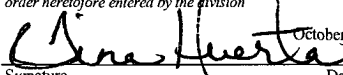
|               |  |  |  |  |   |
|---------------|--|--|--|--|---|
| <sup>16</sup> |  |  |  |  | <sup>17</sup> <b>OPERATOR CERTIFICATION</b><br><i>I hereby certify that the information contained herein is true and complete to the best of my knowledge and belief, and that this organization either owns a working interest or unleased mineral interest in the land including the proposed bottom hole location or has a right to drill this well at this location pursuant to a contract with an owner of such a mineral or working interest, or to a voluntary pooling agreement or a compulsory pooling order heretofore entered by the Division</i><br><br>Signature<br>October 26, 2007<br>Date<br><br>Tina Huerta<br>Printed Name |
|               |  |  |  |  |   |
|               |  |  |  |  |   |
|               |  |  |  |  | <sup>18</sup> <b>SURVEYOR CERTIFICATION</b><br><i>I hereby certify that the well location shown on this plat was plotted from field notes of actual surveys made by me or under my supervision, and that the same is true and correct to the best of my belief</i><br><br>Date of Survey<br>Signature and Seal of Professional Surveyor<br><br>Certificate Number   |

MARTIN YATES, III  
1912-1985

FRANK W. YATES  
1936-1986



105 SOUTH FOURTH STREET  
ARTESIA, NEW MEXICO 88210-2118  
TELEPHONE (505) 748-1471

S. P. YATES  
CHAIRMAN EMERITUS

JOHN A. YATES  
CHAIRMAN OF THE BOARD

PEYTON YATES  
PRESIDENT

FRANK YATES, JR.  
EXECUTIVE VICE PRESIDENT

JOHN A. YATES, JR.  
SENIOR VICE PRESIDENT

October 26, 2007

OCT 30 2007  
OCD-ARTESIA

Mr. Bryan Arrant  
Oil Conservation Division, District II Office  
1301 W. Grand Ave.  
Artesia, NM 88210

Re: Mosley Canyon BIA State Com #1  
Section 5-T24S-R25E  
Eddy County, New Mexico  
H2S Contingency Plan

Sources at Yates Petroleum Corporation have relayed information to me that they believe there will not be enough H2S anticipated from the surface to the Wolfcamp formation to even meet the OCD's minimum requirements for the submission of a contingency plan per Rule 118.

Thank you,

YATES PETROLEUM CORPORATION

Tina Huerta  
Regulatory Compliance Supervisor