

District I
1625 N. French Dr., Hobbs, NM 88240
District II
1301 W. Grand Avenue, Artesia, NM 88210
District III
1000 Rio Brazos Road, Aztec, NM 87410
District IV
1220 S. St Francis Dr., Santa Fe, NM 87505

State of New Mexico
Energy Minerals and Natural Resources



Form C-101
May 27, 2004

Oil Conservation Division
1220 South St. Francis Dr.
Santa Fe, NM 87505

Submit to appropriate District Office

☐ AMENDED REPORT

APPLICATION FOR PERMIT TO DRILL, RE-ENTER, DEEPEEN, PLUGBACK, OR ADD A ZONE

¹ Operator Name and Address Yates Petroleum Corporation 105 S. 4 th Street Artesia, NM 88210		² OGRID Number 025575
		³ API Number 30-015-33715
⁴ Property Code 34398	⁵ Property Name Hedgerow BFH State Com	⁶ Well No. 1
⁹ Proposed Pool 1 Saladar; Strawn		¹⁰ Proposed Pool 2

7 Surface Location

UL or lot no.	Section	Township	Range	Lot Idn	Feet from the	North/South line	Feet from the	East/West line	County
M	28	20S	28E		660	South	1219	West	Eddy

8 Proposed Bottom Hole Location If Different From Surface

UL or lot no.	Section	Township	Range	Lot Idn	Feet from the	North/South line	Feet from the	East/West line	County

Additional Well Information

¹¹ Work Type Code A	¹² Well Type Code G	¹³ Cable/Rotary N/A	¹⁴ Lease Type Code S	¹⁵ Ground Level Elevation 3212'GR
¹⁶ Multiple Y	¹⁷ Proposed Depth N/A	¹⁸ Formation Morrow	¹⁹ Contractor N/A	²⁰ Spud Date ASAP
Depth to Groundwater		Distance from nearest fresh water well		Distance from nearest surface water
Pit: Liner: Synthetic <input type="checkbox"/> _____ mils thick Clay <input type="checkbox"/> Pit Volume: _____ bbls Drilling Method: _____				
Closed-Loop System <input checked="" type="checkbox"/> Fresh Water <input type="checkbox"/> Brine <input type="checkbox"/> Diesel/Oil-based <input type="checkbox"/> Gas/Air <input type="checkbox"/>				

21 Proposed Casing and Cement Program

Hole Size	Casing Size	Casing weight/foot	Setting Depth	Sacks of Cement	Estimated TOC

IN PLACE

²² Describe the proposed program. If this application is to DEEPEEN or PLUG BACK, give the data on the present productive zone and proposed new productive zone. Describe the blowout prevention program, if any. Use additional sheets if necessary.

Yates Petroleum Corporation plans to plugback and recompleate this well as follows: Set an RBP at 10,800'. Perforate Strawn 10,574'-10,592' (109). Stimulate as needed. Consider turning the well over to the production department for testing. Snub out of the hole with tubing, packer and RBP. TIH with tubing with turned down and beveled collars, 7" Baker A5 dual completion packer, profile nipple and o/o tool. Set the Baker A5 packer at 10,474'. Place a blast joint across from the 10,574'-10,592' perforations.

²³ I hereby certify that the information given above is true and complete to the best of my knowledge and belief. I further certify that the drilling pit will be constructed according to NMOC guidelines ☐, a general permit ☐, or an (attached) alternative OCD-approved plan ☐.

Signature: *Tina Huerta*

Printed name: Tina Huerta

Title: Regulatory Compliance Supervisor

E-mail Address: tina@ypcnm.com

Date: December 19, 2007

Phone: 505-748-4168

OIL CONSERVATION DIVISION

Approved by:

BRYAN G. ARANT
DISTRICT II GEOLOGIST

Title:

Approval Date: **JAN 10 2008**

Expiration Date: **JAN 10 2010**

Conditions of Approval Attached ☐

Yates Petroleum Corporation

Typical 3,000 psi Pressure System
Schematic

DEC 26 2007
OCD-ARTESIA

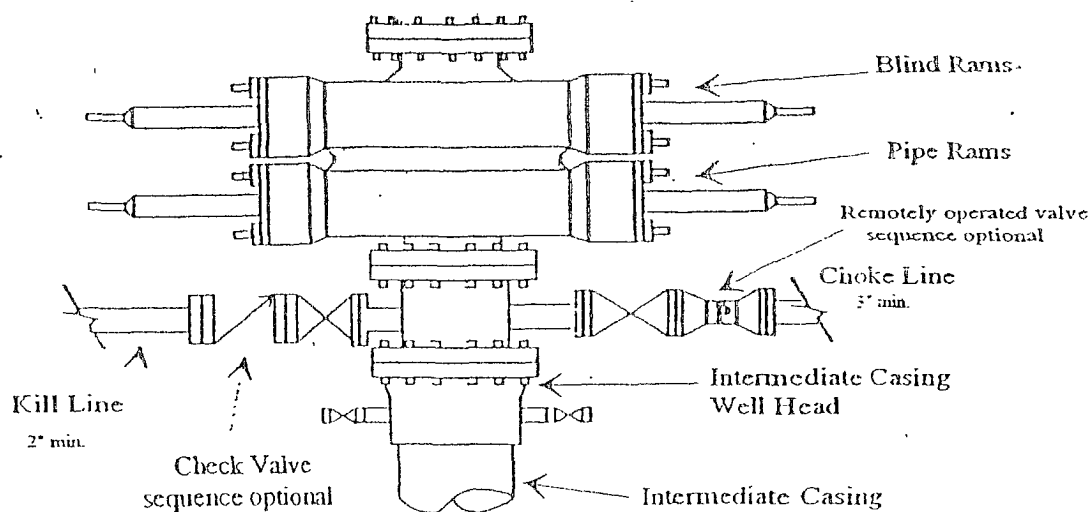

Typical 3,000 psi choke manifold assembly with at least these minimum features

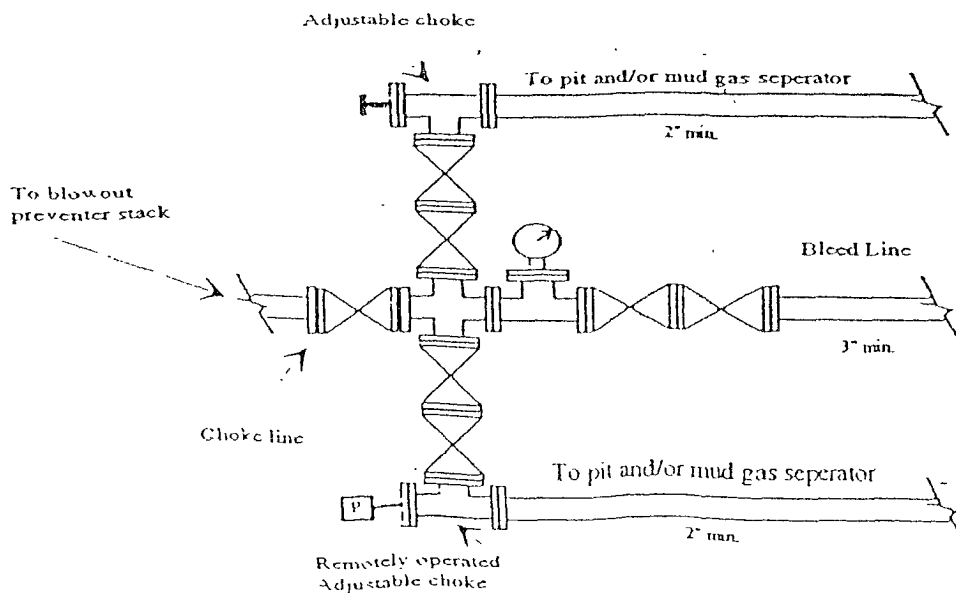



DEC 26 2007
OCD-ARTESIA

WELL NAME: Hedgerow BFH State Com #1

FIELD:

LOCATION: 660' FSL & 1,219' FWL of Section 28-20S-28E

Eddy Co., NM

GL: 3,217

ZERO:

KB:

SPUD DATE: 3/31/05

COMPLETION DATE:

COMMENTS: API No.: 30-015-33715

CASING PROGRAM

13-3/8" 48# H40	628'
9-5/8" 36# J55	2,625'
7" 26# P110 LTC 1,731'	
7" 26# L80 LTC 3,439'	
7" 26# J55 LTC 5,241'	
7" 26# P110 LTC 1,233'	11,644'

17-1/2"
Hole

13-3/8" @ 628' w/
550 sx (Circ)

Casing Patch @
1,232'

12-1/4" Hole

9-5/8" set @ 2,625' w/1,275 sx cmt (Circ)

Squeezed perms 30' above TOC
Squeezed with enough cement volume to circ.

8-3/4" Hole

DV Tool @ 8,320'

Baker A5 Duel
Comp Packer @
10,474'

Packer @ 10,757'

CIBP @ 11,065'
w/ 35' cmt

Strawn Perfs: 10,574-10,592' (109)

Atoka Perfs: 10,844-10,850' (37);
10,916-10,922' (37)

Morrow Perfs: 11,368-11,376' (49)

Morrow Perfs: 11,430-11,482' (171)

FC: 11,583'
TD: 11,630'

7" @ 10,585
1st Stage: 550 sx cmt (Circ)
2nd Stage: 1260 sx cmt (not circ)

After

TOPS

Strawn 10,166'
Atoka 10,624'

Not to Scale
1/17/07
DC/Hill

MARTIN YATES, III

1912-1985

FRANK W. YATES

1936-1986



105 SOUTH FOURTH STREET
ARTESIA, NEW MEXICO 88210-2118
TELEPHONE (575) 748-1471



S.P. YATES
CHAIRMAN EMERITUS

JOHN A. YATES
CHAIRMAN OF THE BOARD

FRANK YATES, JR.
PRESIDENT

PEYTON YATES
DIRECTOR

JOHN A. YATES, JR.
DIRECTOR

DEC 26 2007
OCD-ARTESIA

December 19, 2007

Mr. Bryan Arrant
Oil Conservation Division, District II Office
1301 W. Grand Ave.
Artesia, NM 88210

Re: Hedgerow BFH State Com #1
Section 28-T20S-R28E
Eddy County, New Mexico
H2S Contingency Plan

Sources at Yates Petroleum Corporation have relayed information to me that they believe there will not be enough H2S anticipated from the surface to the Strawn formation to even meet the OCD's minimum requirements for the submission of a contingency plan per Rule 118.

Thank you,

YATES PETROLEUM CORPORATION

Tina Huerta
Regulatory Compliance Supervisor

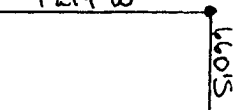
<div data-bbox="73 1019 306 1257" data-label="Text"><p>16</p></div>				<div data-bbox="1024 1019 1497 1257" data-label="Text"><p>17 OPERATOR CERTIFICATION <i>I hereby certify that the information contained herein is true and complete to the best of my knowledge and belief, and that this organization either owns a working interest or unleased mineral interest in the land including the proposed bottom hole location or has a right to drill this well at this location pursuant to a contract with an owner of such a mineral or working interest, or to a voluntary pooling agreement or a compulsory pooling order heretofore entered by the division</i></p></div>
				<div data-bbox="1024 1257 1497 1506" data-label="Text"><p> January 11, 2008 Signature Date Tina Huerta Printed Name</p></div>
<div data-bbox="73 1506 306 1993" data-label="Text"><p>1219'W</p></div>				<div data-bbox="1024 1506 1497 1993" data-label="Text"><p>18 SURVEYOR CERTIFICATION <i>I hereby certify that the well location shown on this plat was plotted from field notes of actual surveys made by me or under my supervision, and that the same is true and correct to the best of my belief.</i></p><p>Date of Survey</p><p>Signature and Seal of Professional Surveyor</p><p>Certificate Number</p></div>