

District I

1625 N French Dr., Hobbs, NM 88240

District II

1301 W. Grand Avenue, Artesia, NM 88210

District III

1000 Rio Brazos Road, Aztec, NM 87410

District IV

1220 S. St Francis Dr, Santa Fe, NM 87505

State of New Mexico
Energy Minerals and Natural ResourcesForm C-101
May 27, 2004

Oil Conservation Division

1220 South St. Francis Dr.

Santa Fe, NM 87505

Submit to appropriate District Office

MAR 14 2008

☐ AMENDED REPORT

OCD-ARTESIA

APPLICATION FOR PERMIT TO DRILL, RE-ENTER, DEEPEN, PLUGBACK, OR ADD A ZONE

¹ Operator Name and Address Yates Petroleum Corporation 105 S. 4 th Street Artesia, NM 88210		² OGRID Number 025575
³ Property Code 12789		⁴ API Number 30-015-26795
⁵ Property Name State CO Com		⁶ Well No 6
⁹ Proposed Pool 1 Canyon; Wolfcamp		¹⁰ Proposed Pool 2

⁷ Surface Location

UL or lot no	Section	Township	Range	Lot Idn	Feet from the	North/South line	Feet from the	East/West line	County
H	36	19S	24E		1980	North	660	East	Eddy

⁸ Proposed Bottom Hole Location If Different From Surface

UL or lot no.	Section	Township	Range	Lot Idn	Feet from the	North/South line	Feet from the	East/West line	County

Additional Well Information

¹¹ Work Type Code P	¹² Well Type Code O	¹³ Cable/Rotary N/A	¹⁴ Lease Type Code P	¹⁵ Ground Level Elevation 3582'GR
¹⁶ Multiple N	¹⁷ Proposed Depth N/A	¹⁸ Formation Canyon	¹⁹ Contractor N/A	²⁰ Spud Date ASAP
Depth to Groundwater		Distance from nearest fresh water well		Distance from nearest surface water
Pit: Liner: Synthetic <input type="checkbox"/> _____ mils thick Clay <input type="checkbox"/> Pit Volume: _____ bbls Drilling Method: _____ Closed-Loop System <input checked="" type="checkbox"/> Fresh Water <input type="checkbox"/> Brine <input type="checkbox"/> Diesel/Oil-based <input type="checkbox"/> Gas/Air <input type="checkbox"/>				

²¹ Proposed Casing and Cement Program

Hole Size	Casing Size	Casing weight/foot	Setting Depth	Sacks of Cement	Estimated TOC
		IN PLACE			

²² Describe the proposed program. If this application is to DEEPEN or PLUG BACK, give the data on the present productive zone and proposed new productive zone. Describe the blowout prevention program, if any. Use additional sheets if necessary.

Yates Petroleum Corporation plans to plugback and recompleat this well as follows: Set a 7" CIBP at 7654' with 35' cement on top. Perforate Wolfcamp 5730'-5740' (20) and 5760'-5774' (28). Stimulate as needed.

²³ I hereby certify that the information given above is true and complete to the best of my knowledge and belief. I further certify that the drilling pit will be constructed according to NM OCD guidelines ☐, a general permit ☐, or an (attached) alternative OCD-approved plan ☐.

Signature: *Tina Huerta*

Printed name Tina Huerta

Title: Regulatory Compliance Supervisor

E-mail Address: tina@ypcnm.com

Date: March 11, 2008

Phone: 575-748-4168

OIL CONSERVATION DIVISION

Approved by:

Title:

Approval Date: 3/26/08

Expiration Date: 3/26/10

Conditions of Approval Attached ☐

MARTIN YATES, III
1912-1985

FRANK W. YATES
1936-1986



105 SOUTH FOURTH STREET
ARTESIA, NEW MEXICO 88210-2118
TELEPHONE (575) 748-1471

S. P. YATES
CHAIRMAN EMERITUS

JOHN A. YATES
CHAIRMAN OF THE BOARD

FRANK YATES, JR.
PRESIDENT

PEYTON YATES
DIRECTOR

JOHN A. YATES, JR.
DIRECTOR

March 11, 2008

MAR 14 2008
OCD-ARTESIA

Oil Conservation Division, District II Office
1301 W. Grand Ave.
Artesia, NM 88210

Re: State CO Com #6
Section 36-T19S-R24E
Eddy County, New Mexico
H2S Contingency Plan

Sources at Yates Petroleum Corporation have relayed information to me that they believe there will not be enough H2S anticipated from the surface to the Wolfcamp formation to even meet the OCD's minimum requirements for the submission of a contingency plan per Rule 118.

Thank you,

YATES PETROLEUM CORPORATION

Tina Huerta
Regulatory Compliance Supervisor

Yates Petroleum Corporation

Typical 3,000 psi Pressure System Schematic

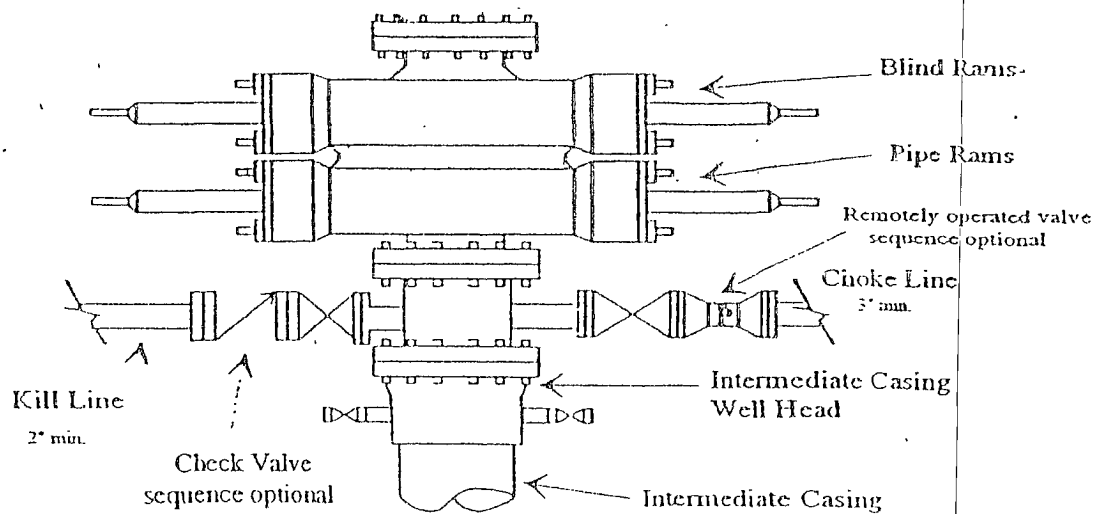

Typical 3,000 psi choke manifold assembly with at least these minimum features

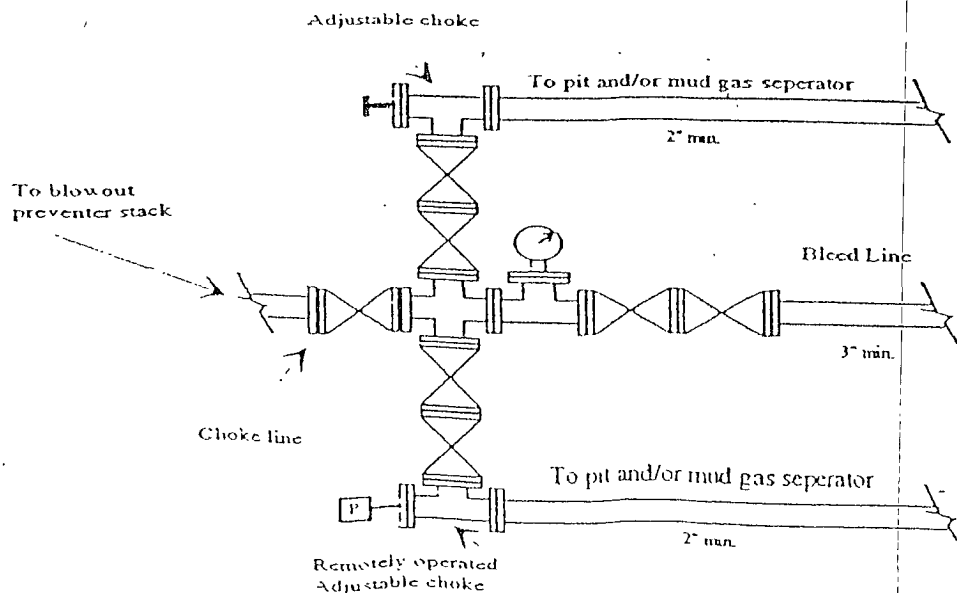

WELL NAME: State CO Com #6 **FIELD:** Dagger Draw
LOCATION: 1,980' FNL & 660' FEL of Section 36-17S-24E Eddy Co., NM
GL: 3,582 **ZERO:** 18' **KB:** _____
SPUD DATE: 11/28/04 **COMPLETION DATE:** _____
COMMENTS: _____

CASING PROGRAM

9-5/8" 36# J55 STC		1,090'
7" 26# J55 LTC	102'	
7" 23# N80 LTC	868'	
7" 23# J55 LTC	3,998'	
7" 26# J55 LTC	2,646'	
7" 26# N80 LTC	626'	8,240'
2-7/8 6.5# J55 EUE		

After

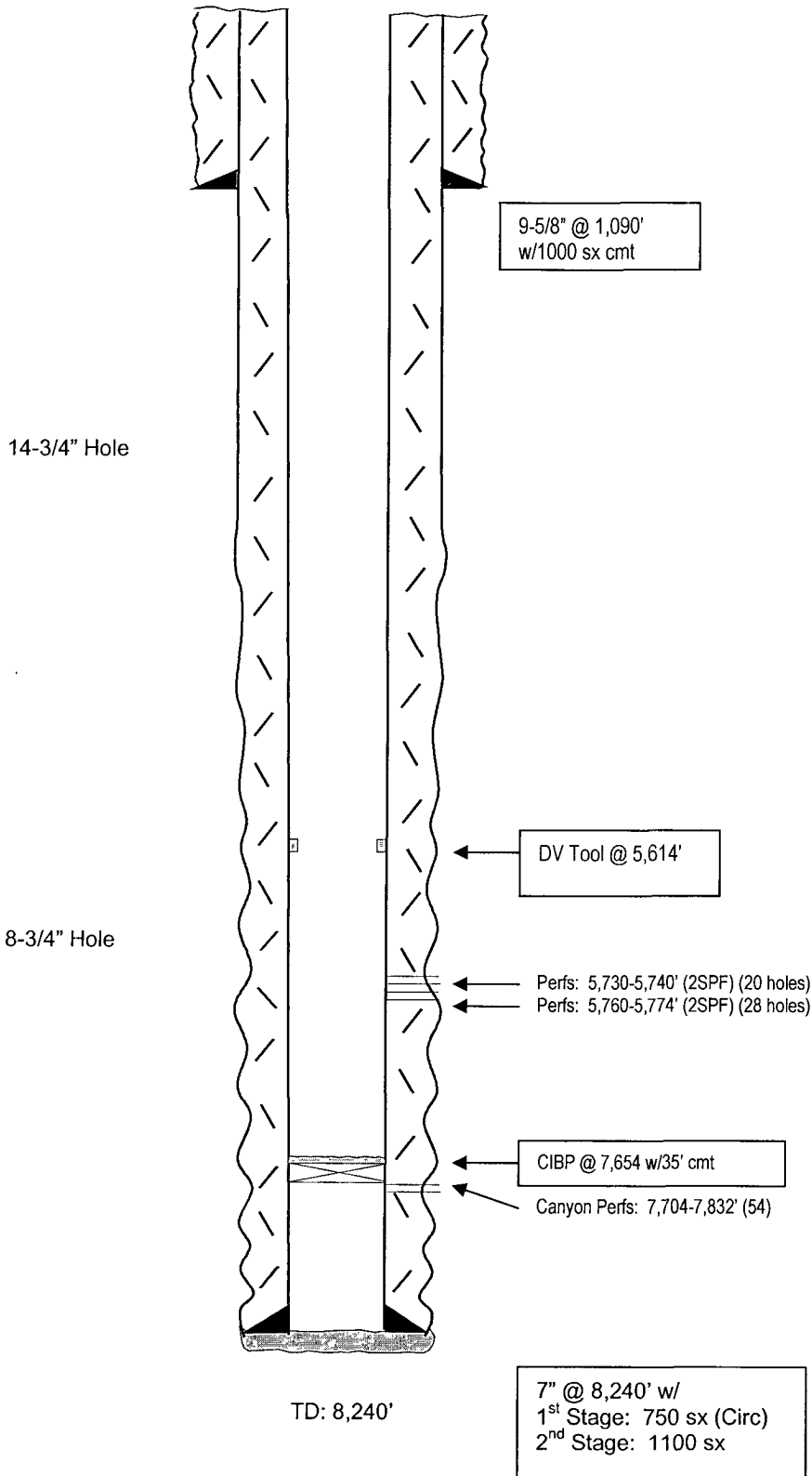

Not to Scale
 1/25/07
 DC/Moss

District I
1625 N. French Dr., Hobbs, NM 88240
District II
1301 W. Grand Avenue, Artesia, NM 88210
District III
1000 Rio Brazos Rd., Aztec, NM 87410
District IV
1220 S. St. Francis Dr., Santa Fe, NM 87505

State of New Mexico
Energy, Minerals & Natural Resources Department
OIL CONSERVATION DIVISION
1220 South St. Francis Dr.
Santa Fe, NM 87505

Form C-102
Revised October 12, 2005
Submit to Appropriate District Office
State Lease - 4 Copies
Fee Lease - 3 Copies

☐ AMENDED REPORT

WELL LOCATION AND ACREAGE DEDICATION PLAT

¹ API Number 30-015-26795	² Pool Code 08450	³ Pool Name Canyon; Wolfcamp
⁴ Property Code 12789	⁵ Property Name State CO Com	⁶ Well Number 6
⁷ OGRID No. 025575	⁸ Operator Name Yates Petroleum Corporation	⁹ Elevation 3582'GR

¹⁰ Surface Location

UL or lot no. H	Section 36	Township 19S	Range 24E	Lot Idn	Feet from the 1980	North/South line North	Feet from the 660	East/West line East	County Eddy
--------------------	---------------	-----------------	--------------	---------	-----------------------	---------------------------	----------------------	------------------------	----------------

¹¹ Bottom Hole Location If Different From Surface

UL or lot no.	Section	Township	Range	Lot Idn	Feet from the	North/South line	Feet from the	East/West line	County
---------------	---------	----------	-------	---------	---------------	------------------	---------------	----------------	--------

¹² Dedicated Acres 40	¹³ Joint or Infill	¹⁴ Consolidation Code	¹⁵ Order No.
-------------------------------------	-------------------------------	----------------------------------	-------------------------

No allowable will be assigned to this completion until all interests have been consolidated or a non-standard unit has been approved by the division.

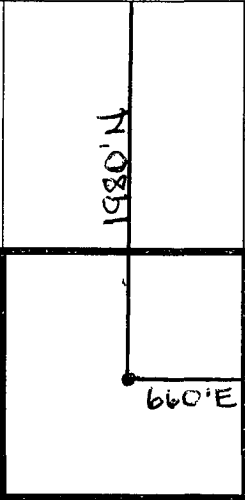
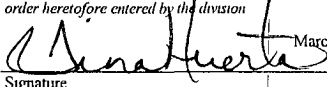
¹⁶						¹⁷ OPERATOR CERTIFICATION <i>I hereby certify that the information contained herein is true and complete to the best of my knowledge and belief, and that this organization either owns a working interest or unleased mineral interest in the land including the proposed bottom hole location or has a right to drill this well at this location pursuant to a contract with an owner of such a mineral or working interest, or to a voluntary pooling agreement or a compulsory pooling order heretofore entered by the division</i>  Signature March 11, 2008 Date	
						Tina Huerta Printed Name	
						¹⁸ SURVEYOR CERTIFICATION <i>I hereby certify that the well location shown on this plat was plotted from field notes of actual surveys made by me or under my supervision, and that the same is true and correct to the best of my belief</i>	
						Date of Survey Signature and Seal of Professional Surveyor	
						Certificate Number	