

Submit 3 Copies To Appropriate District Office  
District I  
1625 French Dr., Hobbs, NM 88240  
District II  
1301 W. Grand Ave., Artesia, NM 88210  
District III  
1000 Rio Brazos Rd., Aztec, NM 87410  
District IV  
1220 S. St. Francis Dr., Santa Fe, NM 87505

State of New Mexico  
Energy, Minerals and Natural Resources

Form C-103  
June 19, 2008

OIL CONSERVATION DIVISION  
1220 South St. Francis Dr.  
Santa Fe, NM 87505

WELL API NO. <u>30-015-22008</u>
5. Indicate Type of Lease STATE <input checked="" type="checkbox"/> FEE <input type="checkbox"/>
6. State Oil & Gas Lease No.
7. Lease Name or Unit Agreement Name <u>Qvail state</u>
8. Well Number <u>1</u>
9. OGRID Number <u>8853</u>
10. Pool name or Wildcat <u>yates Seven Rivers</u>
11. Elevation (Show whether DR, RKB, RT, GR, etc.) <u>3493</u>

SUNDRY NOTICES AND REPORTS ON WELLS (DO NOT USE THIS FORM FOR PROPOSALS TO DRILL OR TO DEEPEN OR PLUG BACK TO A DIFFERENT RESERVOIR. USE "APPLICATION FOR PERMIT" (FORM C-101) FOR SUCH PROPOSALS.)	
1. Type of Well: Oil Well <input checked="" type="checkbox"/> Gas Well <input type="checkbox"/> Other <input type="checkbox"/>	DEC 18 2008
2. Name of Operator <u>George Chase Jr</u>	OCD-ARTESIA
3. Address of Operator <u>P.O. box 1618 Artesia</u>	
4. Well Location Unit Letter <u>N</u> : <u>990</u> feet from the <u>South</u> line and <u>1650</u> feet from the <u>East</u> line Section <u>8</u> Township <u>17</u> Range <u>28</u> NMPM County <u>Eddy</u>	
11. Elevation (Show whether DR, RKB, RT, GR, etc.) <u>3493</u>	

12. Check Appropriate Box to Indicate Nature of Notice, Report or Other Data

NOTICE OF INTENTION TO:		SUBSEQUENT REPORT OF:	
PERFORM REMEDIAL WORK <input type="checkbox"/>	PLUG AND ABANDON <input type="checkbox"/>	REMEDIAL WORK <input type="checkbox"/>	ALTERING CASING <input checked="" type="checkbox"/>
TEMPORARILY ABANDON <input type="checkbox"/>	CHANGE PLANS <input type="checkbox"/>	COMMENCE DRILLING OPNS. <input type="checkbox"/>	P AND A <input type="checkbox"/>
PULL OR ALTER CASING <input type="checkbox"/>	MULTIPLE COMPL <input type="checkbox"/>	CASING/CEMENT JOB <input checked="" type="checkbox"/>	
DOWNHOLE COMMINGLE <input type="checkbox"/>			
OTHER: <input type="checkbox"/>		OTHER: <input type="checkbox"/>	

13. Describe proposed or completed operations. (Clearly state all pertinent details, and give pertinent dates, including estimated date of starting any proposed work). SEE RULE 1103. For Multiple Completions: Attach wellbore diagram of proposed completion or recompletion.

mud hole pump cement plug 25sx at 1520' tag at 1462'. rig up J.S.I. wire line free point 5 1/2 at 1000' pull 5 1/2, run tub. to 1030' pump 25 sx cement. tag at 963' pump 25 sx at 650' tag at 571' place on pump.

Spud Date:

Rig Release Date:

I hereby certify that the information above is true and complete to the best of my knowledge and belief.

SIGNATURE George A. Chase Jr TITLE Owner DATE 12-18-08

Type or print name George A. Chase Jr E-mail address: 3jchase@myway.com PHONE: 575 365 8702  
For State Use Only

APPROVED BY: Accepted for record TITLE DATE 12/19/08  
Conditions of Approval (if any): NMOCD

# Quail state #1

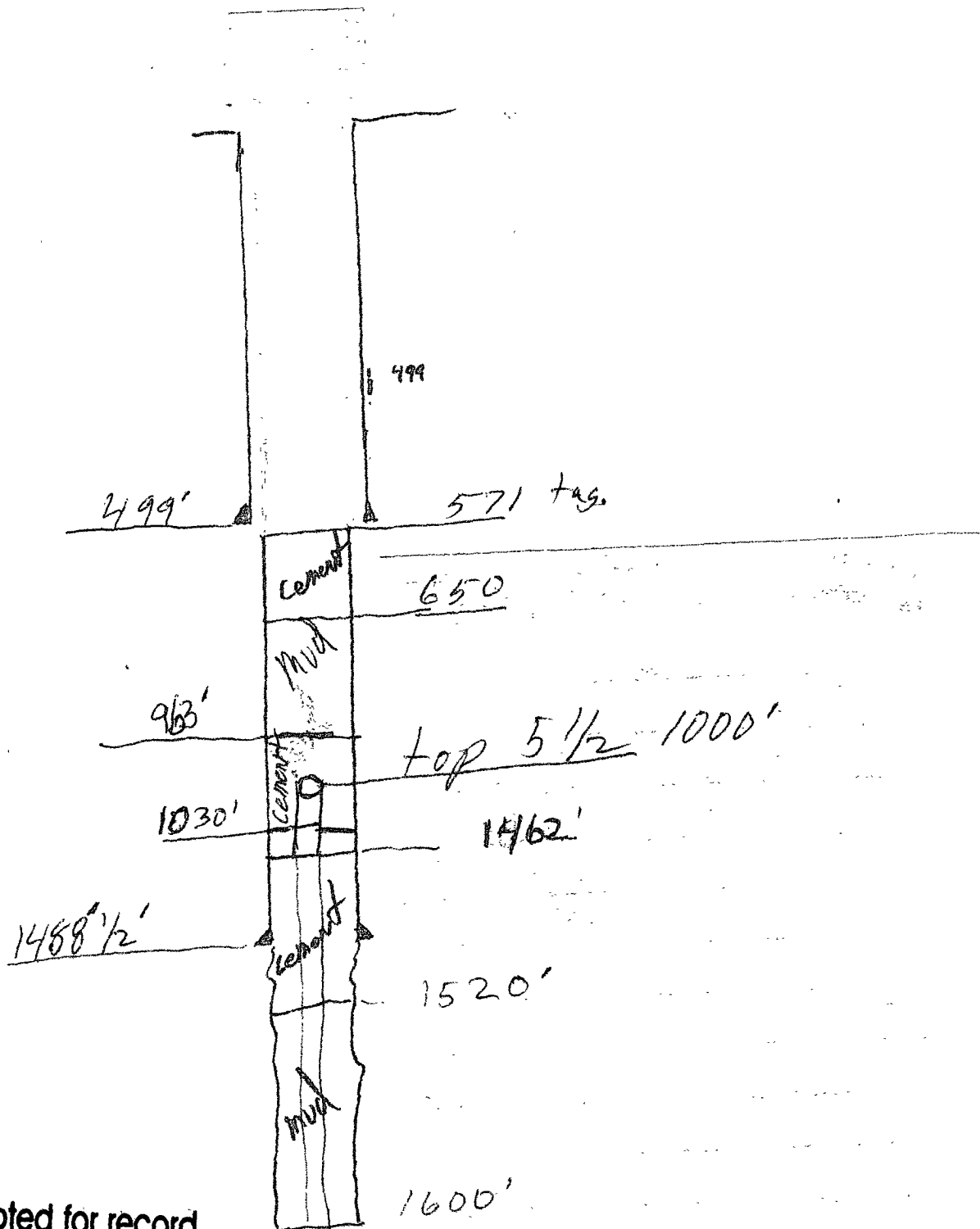

Accepted for record  
NMOCD