

FEB - 5 2009

fm

DISTRICT I
1625 N. French Dr., Hobbs, NM 88240

DISTRICT II
1501 W. Grand Avenue, Artesia, NM 88210

DISTRICT III
1000 Rio Brazos Rd., Aztec, NM 87410

DISTRICT IV
1220 S. St. Francis Dr., Santa Fe, NM 87505

State of New Mexico
Energy, Minerals and Natural Resources Department

OIL CONSERVATION DIVISION
1220 South St. Francis Dr.
Santa Fe, New Mexico 87505

Form C-102
Revised October 12, 2005

Submit to Appropriate District Office
State Lease - 4 Copies
Fee Lease - 3 Copies



WELL LOCATION AND ACREAGE DEDICATION PLAT

☐ AMENDED REPORT

API Number 30-015-3673	Pool Code 73280	Pool Name BURTON FLAT; MORROW
Property Code 302209	Property Name BURTON FLAT DEEP UNIT	Well Number 46
OGRID No. 6137	Operator Name DEVON ENERGY PRODUCTION COMPANY LP	Elevation 3201'

Surface Location

UL or lot No.	Section	Township	Range	Lot Idn	Feet from the	North/South line	Feet from the	East/West line	County
A	2	21 S	27 E		660	NORTH	700	EAST	EDDY

Bottom Hole Location If Different From Surface

UL or lot No.	Section	Township	Range	Lot Idn	Feet from the	North/South line	Feet from the	East/West line	County

Dedicated Acres	Joint or Infill	Consolidation Code	Order No.
274.62			

NO ALLOWABLE WILL BE ASSIGNED TO THIS COMPLETION UNTIL ALL INTERESTS HAVE BEEN CONSOLIDATED
OR A NON-STANDARD UNIT HAS BEEN APPROVED BY THE DIVISION

<p>SURFACE LOCATION Lat - N32°31'15.14" Long - W104°09'13.90" SPC- N.: 553270.1 E.: 596654.8 (NAD-83)</p>		<p>3201.3' 3205.1' 700' 3197.5' 3204.6'</p>	<p>OPERATOR CERTIFICATION I hereby certify that the information contained herein is true and complete to the best of my knowledge and belief, and that this organization either owns a working interest or unleased mineral interest in the land including the proposed bottom hole location pursuant to a contract with an owner of such a mineral or working interest, or to a voluntary pooling agreement or a compulsory pooling order heretofore entered by the division.</p> <p>Signature: <i>[Signature]</i> Date: 01/29/09 Printed Name: STEPHANIE A. YSASAGA</p>
<p>1/4 COR. 1/4 COR.</p>		<p>SURVEYOR CERTIFICATION I hereby certify that the well location shown on this plat was plotted from field notes of actual surveys made by me or under my supervision, and that the same is true and correct to the best of my belief.</p> <p>Date Surveyed: JANUARY 8 2009 Signature & Seal: <i>[Signature]</i> Professional Surveyor: W. L. JONES Certificate No. Gary L. Jones 7977</p>	
<p>1/4 COR. 1/4 COR.</p>		<p>BASIN SURVEYS</p>	

SECTION 2, TOWNSHIP 21 SOUTH, RANGE 27 EAST, N.M.P.M.,
EDDY COUNTY, NEW MEXICO.

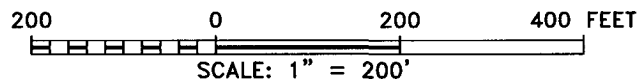
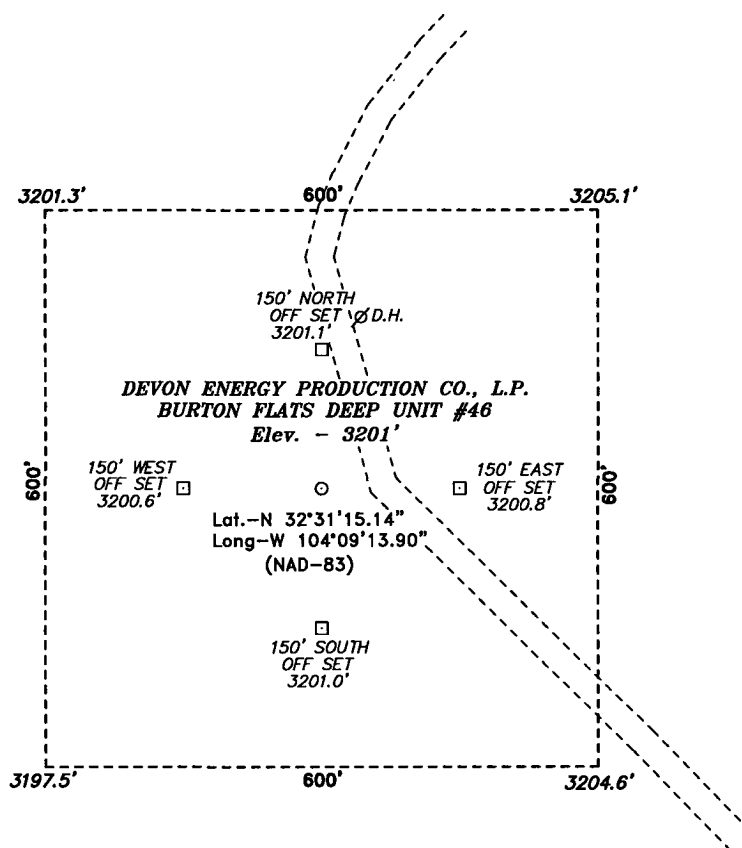

Directions to Location:

FROM THE JUNCTION OF RAINS AND ILLINOIS CAMP ROAD, GO EAST 2.2 MILES TO LEASE ROAD, ON LEASE ROAD GO NORTHEASTERLY 1.4 MILES TO LEASE ROAD, ON LEASE ROAD CONTINUE NORTHEASTERLY 1.2 MILES TO LEASE ROAD, ON LEASE ROAD GO NORTHWESTERLY 0.3 MILES TO PROPOSED LEASE ROAD.

DEVON ENERGY PROD. CO., L.P.

REF: BURTON FLATS DEEP UNIT #46 / WELL PAD TOPO

THE BURTON FLATS DEEP UNIT #46 LOCATED 660' FROM
THE NORTH LINE AND 700' FROM THE EAST LINE OF
SECTION 2, TOWNSHIP 21 SOUTH, RANGE 27 EAST,
N.M.P.M., EDDY COUNTY, NEW MEXICO.

BASIN SURVEYS P.O. BOX 1786 - HOBBS, NEW MEXICO

W.O. Number: 20975

Drawn By: J. M. SMALL

Date: 01-07-2009

Disk: 20975 JMS

Survey Date: 01-06-2009

Sheet 1 of 1 Sheets

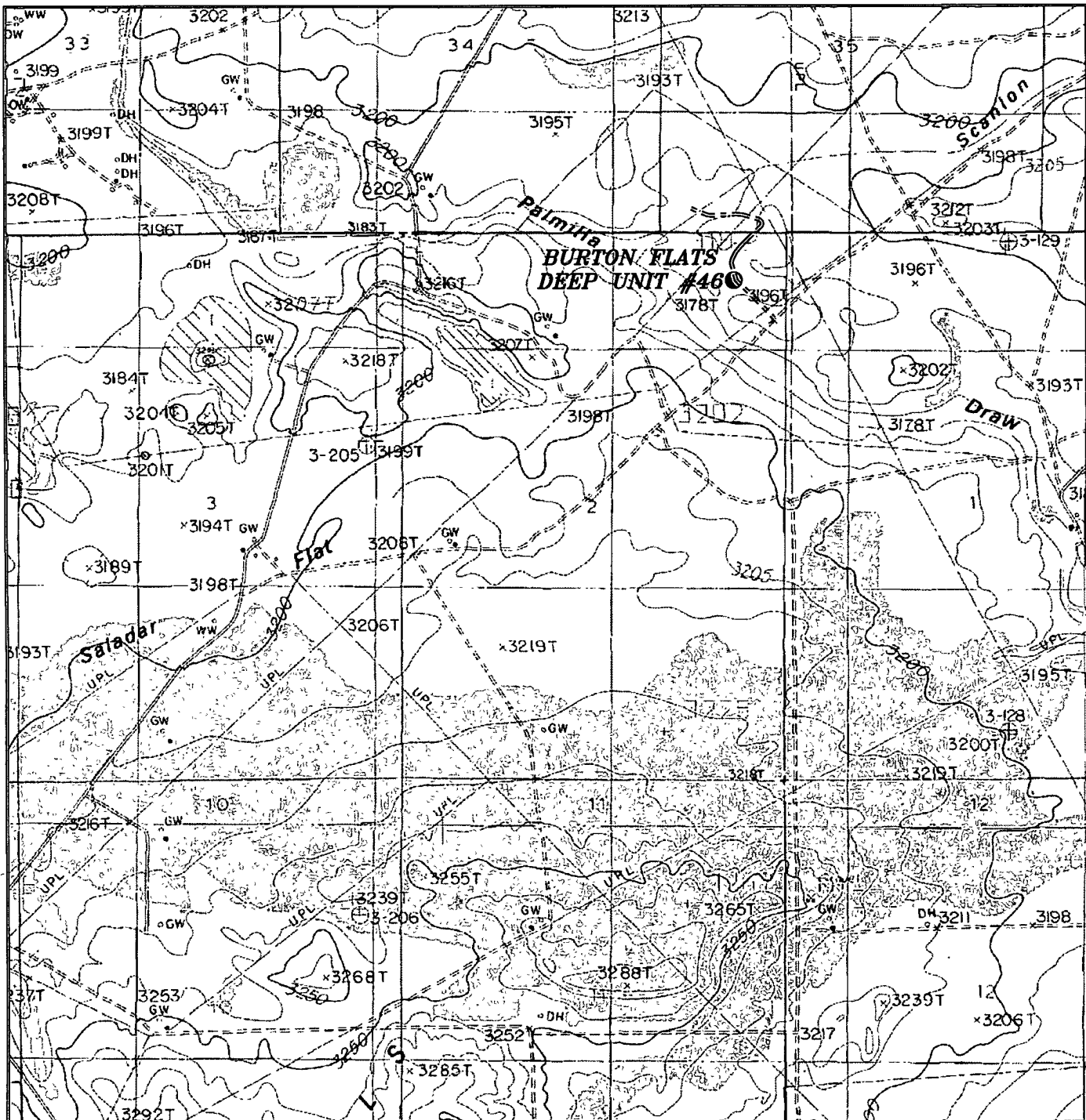

BURTON FLATS DEEP UNIT #46
 Located at 660' FNL AND 700' FEL
 Section 2, Township 21 South, Range 27 East,
 N.M.P.M., Eddy County, New Mexico.

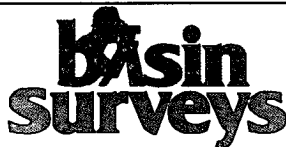

P.O. Box 1786
 1120 N. West County Rd.
 Hobbs, New Mexico 88241
 (575) 393-7316 - Office
 (575) 392-2206 - Fax
 basinsurveys.com

W.O. Number: JMS 20975

Survey Date: 01-06-2009

Scale: 1" = 2000'

Date: 01-07-2009

**DEVON ENERGY
 PROD. CO., L.P.**

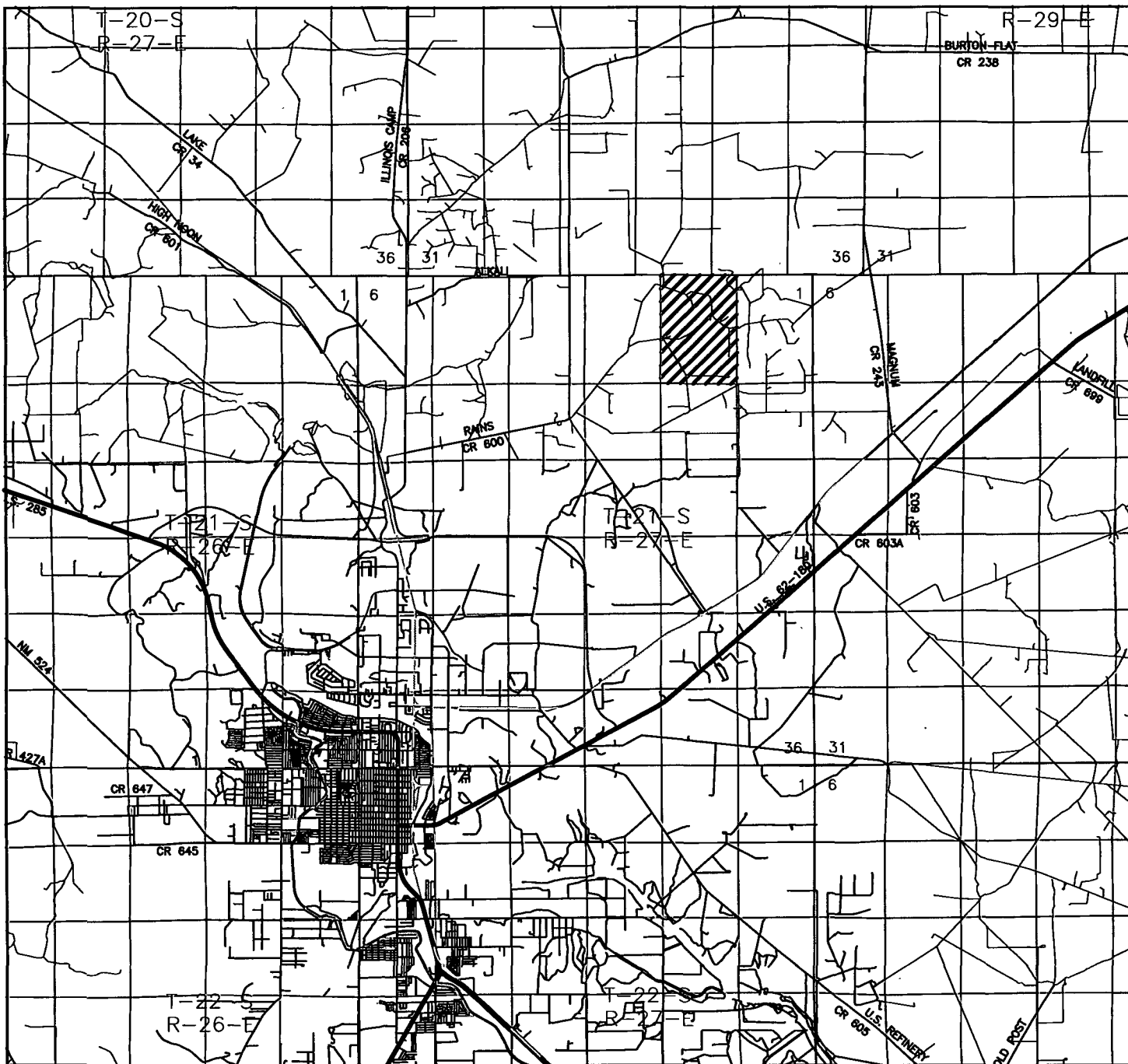

BURTON FLATS DEEP UNIT #46
 Located at 660' FNL AND 700' FEL
 Section 2, Township 21 South, Range 27 East,
 N.M.P.M., Eddy County, New Mexico.

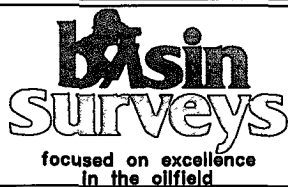

P.O. Box 1786
 1120 N. West County Rd.
 Hobbs, New Mexico 88241
 (575) 393-7316 - Office
 (575) 392-2206 - Fax
 basinsurveys.com

W.O. Number: JMS 20975

Survey Date: 01-06-2009

Scale: 1" = 2000'

Date: 01-07-2009

**DEVON ENERGY
 PROD. CO., L.P.**

Run File C:\STAR\DATA\12.29.04\3.14.05\DEV RIFLEMAN5#4.RUN

Method C:\star\method_extended_gas_scott.mth

Operator Vickie Sullivan

Analysis Date 8/30/2005

Station Rifleman 5 #4

Company Devon Energy

Effective Date

Pulled Data 8/29/05

Received Date 8/29/05

Composite/Spot

<u>Component</u>	<u>Mole %</u>	<u>BTU</u>	<u>GPM</u>
Methylcyclohexane	0.0107	0.56	0.0043
Toluene	0.0097	0.43	0.0032
n-Octane	0.0065	0.41	0.0033
Ethylbenzene	0.0132	0.69	0.0051
m&p xylene	0.0049	0.00	0.0000
o-Xylene	0.0014	0.07	0.0005
n-Nonane	0.0155	1.09	0.0087
n-Decane	0.0000	0.00	0.0000
Totals	100.0000	1,053.06	1.5192

Relative Density from Composition 0.5870

BTUs @ 14.65 Saturated 1,037

BTUs @ 14.65 Dry 1,055

Compressibility 0.99781

Nearby gas analysis for the BFDU #4/b

8/30/2005

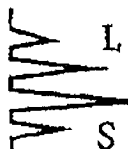
**Laboratory Services Inc.**

2609 West Marland

Hobbs, New Mexico 88240

(505)397-3713

Run File	C:\STAR\DATA\12.29.04\3.14.05\DEV RIFLEMAN5#4.RUN		
Method	C:\star\method_extended_gas_scott.mth		
Operator	Vickie Sullivan	Analysis Date	8/30/2005
Station	Rifleman 5 #4	Company	Devon Energy
Effective Date		Pulled Data	8/29/05
Received Date	8/29/05	Composite/Spot	

<u>Component</u>	<u>Mole %</u>	<u>BTU</u>	<u>GPM</u>
H2S			
Nitrogen	0.4300	0.00	0.0000
Methane	92.6880	938.32	0.0000
CO2	1.3762	0.00	0.0000
Ethane	4.0971	72.67	1.0958
Propane	0.9132	23.03	0.2516
i-Butane	0.1250	4.07	0.0409
n-Butane	0.1478	4.83	0.0466
i-Pentane	0.0487	1.95	0.0178
n-Pentane	0.0301	1.21	0.0109
Cyclopentane	0.0074	0.28	0.0022
2-Methylpentane	0.0099	0.47	0.0041
3-Methylpentane	0.0080	0.38	0.0033
n-Hexane	0.0149	0.71	0.0061
Methylcyclopentane	0.0058	0.26	0.0021
Benzene	0.0116	0.44	0.0033
Cyclohexane	0.0154	0.69	0.0052
n-Heptane	0.0089	0.49	0.0041

8/30/2005

ARTESIA, N.M.

AUG 08 2005

Wildcat Measurement Service
 P.O. Box 1836
 Artesia, New Mexico 88211-1836
 TollFree 1888-421-9453
 Office 505-746-3481
 "Quality and Service is our First Concern"

PDS 06/25/00

Run No. 250728-35
 Date Run 07/28/2005
 Date Sampled 07/27/2005

Analysis for: DEVON ENERGY PRODUCTION COMPANY

GPARGL.L60

Well Name: RIFLEMAN "5" FEDERAL #4

Field:

Sta. Number: 885-12-057

Purpose: SPOT-RFM

Sampling Temp: 82.2 DEG F

Volume/day: 1.8 MMCF/DAY

Pressure on Cylinder: 518.4 PSIG

Producer: DEVON ENERGY PRODUCTION

County: EDDY

State: NM

Sampled By: JACK PITTMAN

Atmos Temp: DEG F

Formation:

Line Pressure: 531.6 PSIA

GAS COMPONENT ANALYSIS

Pressure Base: 14.7300

	Mol %	GPN
Carbon Dioxide CO2	1.9215	
Nitrogen N2	0.5124	
Methane C1	92.1455	
Ethane C2	4.0539	1.0836
Propane C3	0.8552	0.2355
Iso-Butane IC4	0.1361	0.0445
Nor-Butane NC4	0.1278	0.0403
Iso-Pentane IC5	0.0496	0.0182
Nor-Pentane NC5	0.0345	0.0125
Hexanes Plus C6+	0.1635	0.0713
TOTAL	100.0000	1.5058

Real BTU Dry: 1049.11
 Real BTU Wet: 1030.85
 Real Calc. Specific Gravity: 0.6134
 Field Specific Gravity: 0.0000

Standard Pressure: 14.6960
 BTU Dry: 1044.28
 BTU Wet: 1026.11

Z Factor: 0.9977
 W Value: 1.3008
 Avg Mol Weight: 17.7347
 Avg CuFt/Gal: 57.9357
 26 Lb Product: 0.1630
 Methane+ GPN: 17.1241
 Ethane+ GPN: 1.5058
 Propane+ GPN: 0.4223
 Butane+ GPN: 0.1868
 Pentane+ GPN: 0.1020

REMARKS:
 SAMPLE TAKEN FOR RFM

Approved by: DON NORMAN

Thu Jul 28 20:40:45 2005

SEP-26-01 WED 11:46 Laboratory Services

**Laboratory Services, Inc.**4016 Fleeta Drive
Hobbs, New Mexico 88240

Telephone: (505) 397-9713

FOR: Devon Energy Production Co., LP
P. O. Box 750
Artesia, New Mexico 88211-0250

SAMPLE:
IDENTIFICATION: Rifleman 5 St. Com. #1
COMPANY: Devon Energy
LEASE:
PLANT:

SAMPLE DATA: DATE SAMPLED: 9/25/01
ANALYSIS DATE: 9/28/01
PRESSURE - PSIG 500
SAMPLE TEMP. °F 84
ATMOS. TEMP. °F
REMARKS: Sample taken @ the meter run.

GAS (XX) LIQUID ()
SAMPLED BY: G. Myers-Pro Well
ANALYSIS BY: Vickie Biggs

COMPONENT ANALYSIS

COMPONENT	MOL PERCENT	GPM
Hydrogen Sulfide (H2S)		
Nitrogen (N2)	0.401	
Carbon Dioxide (CO2)	0.907	
Methane (C1)	98.841	
Ethane (C2)	4.288	1.129
Propane (C3)	0.749	0.206
I-Butane (IC4)	0.181	0.048
N-Butane (NC4)	0.095	0.030
I-Pentane (IC5)	0.040	0.015
N-Pentane (NC5)	0.030	0.011
Hexane Plus (C6+)	0.074	0.082
	100.000	1.466
BTU/CU.FT. - DRY	1050	MOLECULAR WT. 17.3367
AT 14.850 DRY	1047	
AT 14.850 WET	1029	
AT 14.73 DRY	1053	
AT 14.73 WET	1084	
SPECIFIC GRAVITY -		
CALCULATED	0.589	
MEASURED		

HYDROGEN SULFIDE DRILLING OPERATIONS PLAN

1. All Company and Contract personnel admitted on location must be trained by a qualified H₂S safety instructor to the following:
 - a. Characteristics of H₂S
 - b. Physical effects and hazards
 - c. Proper use of safety equipment and life support systems.
 - d. Principle and operation of H₂S detectors, warning system and briefing areas
 - e. Evacuation procedures, routes and first aid.
 - f. Proper use of 30-minute pressure demand air pack.
2. H₂S Detection and Alarm System
 - a. H₂S detectors and audio alarm system to be located at bell nipple, end of blooie line (mud pit) and on derrick floor or doghouse.
3. Windsock and/or wind streamers
 - a. Windsock at mud pit area should be high enough to be visible
 - b. Windsock at briefing area should be high enough to be visible
 - c. There should be a windsock at entrance to location
4. Condition Flags and Signs
 - a. Warning Sign on access road to location
 - b. Flags to be displayed on sign at entrance to location. Green flag, normal safe condition. Yellow flag indicates potential pressure and danger. Red flag, danger, H₂S present in dangerous concentration. Only emergency personnel admitted to location.
5. Well Control Equipment
 - a. See Exhibit "E" & "E-1"
6. Communication
 - a. While working under masks chalkboards will be used for communication.
 - b. Hand signals will be used where chalk board is inappropriate
 - c. Two way radio will be used to communicate off location in case of emergency help is required. In most cases cellular telephones will be available at most drilling foreman's trailer or living quarters.
7. Drill stem Testing
 - a. Exhausts will be watered
 - b. Flare line will be equipped with an electric igniter or a propane pilot light in case gas reaches the surface.
 - c. If the location is near to a dwelling a closed DST will be performed.
8. Drilling contractor supervisor will be required to be familiar with the effects H₂S has on tubular goods and other mechanical equipment.

If H₂S is encountered, mud system will be altered if necessary to maintain control or formation. A mud gas separator will be brought into service along with H₂S scavengers if necessary.

Emergency Procedures

In the case of a release of gas containing H₂S, the first responder(s) must isolate the area and prevent entry by other persons into the 100 ppm ROE. Additionally the first responder(s) must evacuate any public places encompassed by the 100 ppm ROE. First responder(s) must take care not to injure themselves during this operation. Company and/or local officials must be contacted to aid in this operation. Evacuation of the public should be beyond the 100 ppm ROE.

All responders must have training in the detection of H₂S, measures for protection against the gas, equipment used for protection and emergency response. Additionally, responders must be equipped with H₂S monitors and air packs in order to control the release. Use the “buddy system” to ensure no injuries during the response.

Ignition of Gas Source

Should control of the well be considered lost and ignition considered, take care to protect against exposure to Sulfur Dioxide (SO₂). Intentional ignition must be coordinated with the NMOCD and local officials. Additionally the NM State Police may become involved. NM State Police shall be the Incident Command on scene of any major release. Take care to protect downwind whenever there is an ignition of the gas

Characteristics of H₂S and SO₂

Common Name	Chemical Formula	Specific Gravity	Threshold Limit	Hazardous Limit	Lethal Concentration
Hydrogen Sulfide	H ₂ S	1.189 Air = 1	10 ppm	100 ppm/hr	600 ppm
Sulfur Dioxide	SO ₂	2.21 Air = 1	2 ppm	N/A	1000 ppm

Contacting Authorities

Devon Energy Corp. personnel must liaison with local and state agencies to ensure a proper response to a major release. Additionally, the OCD must be notified of the release as soon as possible but no later than 4 hours. Agencies will ask for information such as type and volume of release, wind direction, location of release, etc. Be prepared with all information available. The following call list of essential and potential responders has been prepared for use during a release. Devon Energy Corp. Company response must be in coordination with the State of New Mexico’s ‘Hazardous Materials Emergency Response Plan’ (HMER)

Devon Energy Corp. Company Call List

<u>Artesia (575)</u>	<u>Cellular</u>	<u>Office</u>	<u>Home</u>
Foreman – BJ Cathey.....	390-5893	748-0176	887-6026
Asst. Foreman – Bobby Jones...	748-7447	748-0176	746-3194
Don Mayberry.....	748-7180	748-5235	746-4945
Montral Walker	(575) 390-5182	(575) 748-0193	
Linda Berryman	(575) 513-0534	(575) 748-0177	

Agency Call List

<u>Lea</u>	<u>Hobbs</u>	
<u>County</u>	State Police.....	392-5588
<u>(505)</u>	City Police.....	397-9265
	Sheriff's Office.....	393-2515
	Ambulance	911
	Fire Department	397-9308
	LEPC (Local Emergency Planning Committee).....	393-2870
	NMOCD.....	393-6161
	US Bureau of Land Management.....	393-3612

<u>Eddy</u>	<u>Carlsbad</u>	
<u>County</u>	State Police	885-3137
<u>(505)</u>	City Police	885-2111
	Sheriff's Office	887-7551
	Ambulance	911
	Fire Department.....	885-2111
	LEPC (Local Emergency Planning Committee).....	887-3798
	US Bureau of Land Management	887-6544
	New Mexico Emergency Response Commission (Santa Fe)....	(575) 476-9600
	24 HR	(575) 827-9126
	National Emergency Response Center (Washington, DC)	(800) 424-8802

Emergency Services

	Boots & Coots IWC	1-800-256-9688 or (281) 931-8884
	Cudd Pressure Control.....	(915) 699-0139 or (915) 563-3356
	Halliburton	(575) 746-2757
	B. J. Services.....	(575) 746-3569
<i>Give</i>	Flight For Life - Lubbock, TX	(806) 743-9911
<i>GPS</i>	Aerocare - Lubbock, TX	(806) 747-8923
<i>position:</i>	Med Flight Air Amb - Albuquerque, NM	(575) 842-4433
	Lifeguard Air Med Svc. Albuquerque, NM	(575) 272-3115