

UNITED STATES
DEPARTMENT OF THE INTERIOR
BUREAU OF LAND MANAGEMENT

OCD-ARTS

FORM APPROVED
OMB NO. 1004-0135
Expires July 31, 2010

Rm

SUNDRY NOTICES AND REPORTS ON WELLS SEP 23 2009
Do not use this form for proposals to drill or to re-enter an abandoned well. Use form 3160-3 (APD) for such proposals.

SUBMIT IN TRIPLICATE - Other instructions on reverse side.

1. Type of Well <input checked="" type="checkbox"/> Oil Well <input type="checkbox"/> Gas Well <input type="checkbox"/> Other		5. Lease Serial No. NMNM02862
2. Name of Operator CHESAPEAKE OPERATING, INC. Contact: LINDA GOOD E-Mail: linda.good@chk.com		6. If Indian, Allottee or Tribe Name
3a. Address OKLAHOMA CITY, OK 73154-0496	3b. Phone No (include area code) Ph: 405-935-4275	7. If Unit or CA/Agreement, Name and/or No NMNM71016X
4. Location of Well (Footage, Sec., T., R., M., or Survey Description) Sec 28 T24S R30E SESE 32.18248 N Lat, 103.88032 W Lon		8. Well Name and No PLU PIERCE CANYON 28 FEDERAL 1
		9. API Well No. 30-015-36830-00-S1
		10. Field and Pool, or Exploratory WILDCAT
		11. County or Parish, and State EDDY COUNTY, NM

12. CHECK APPROPRIATE BOX(ES) TO INDICATE NATURE OF NOTICE, REPORT, OR OTHER DATA

TYPE OF SUBMISSION	TYPE OF ACTION			
<input type="checkbox"/> Notice of Intent	<input type="checkbox"/> Acidize	<input type="checkbox"/> Deepen	<input type="checkbox"/> Production (Start/Resume)	<input type="checkbox"/> Water Shut-Off
<input checked="" type="checkbox"/> Subsequent Report	<input type="checkbox"/> Alter Casing	<input type="checkbox"/> Fracture Treat	<input type="checkbox"/> Reclamation	<input type="checkbox"/> Well Integrity
<input type="checkbox"/> Final Abandonment Notice	<input type="checkbox"/> Casing Repair	<input type="checkbox"/> New Construction	<input type="checkbox"/> Recomplete	<input checked="" type="checkbox"/> Other
	<input type="checkbox"/> Change Plans	<input type="checkbox"/> Plug and Abandon	<input type="checkbox"/> Temporarily Abandon	Site Facility Diagram/Security Plan
	<input type="checkbox"/> Convert to Injection	<input type="checkbox"/> Plug Back	<input type="checkbox"/> Water Disposal	

13. Describe Proposed or Completed Operation (clearly state all pertinent details, including estimated starting date of any proposed work and approximate duration thereof. If the proposal is to deepen directionally or recompleat horizontally, give subsurface locations and measured and true vertical depths of all pertinent markers and zones. Attach the Bond under which the work will be performed or provide the Bond No. on file with BLM/BIA. Required subsequent reports shall be filed within 30 days following completion of the involved operations. If the operation results in a multiple completion or recompleat in a new interval, a Form 3160-4 shall be filed once testing has been completed. Final Abandonment Notices shall be filed only after all requirements, including reclamation, have been completed, and the operator has determined that the site is ready for final inspection.)

PLEASE FIND THE ATTACHED DIAGRAM FOR THE PLU PIERCE CANYON 28 FEDERAL 1H.

(CHK PN 624840)

Accepted for Record Purposes.

Approval Subject to Onsite Inspections.

Date: 9-17-09

14. I hereby certify that the foregoing is true and correct. Electronic Submission #73909 verified by the BLM Well Information System For CHESAPEAKE OPERATING, INC., sent to the Carlsbad Committed to AFMSS for processing by KURT SIMMONS on 09/02/2009 (09KMS2140SE)	
Name (Printed/Typed) LINDA GOOD	Title SR. REGULATORY COMPLIANCE SPEC
Signature (Electronic Submission)	Date 09/02/2009

THIS SPACE FOR FEDERAL OR STATE OFFICE USE

Approved By ACCEPTED	DUNCAN WHITLOCK Title LEAD PETROLEUM ENGINEERING TECH	Date 09/17/2009
Conditions of approval, if any, are attached. Approval of this notice does not warrant or certify that the applicant holds legal or equitable title to those rights in the subject lease which would entitle the applicant to conduct operations thereon.		Office Carlsbad

Title 18 U.S.C. Section 1001 and Title 43 U.S.C. Section 1212, make it a crime for any person knowingly and willfully to make to any department or agency of the United States any false, fictitious or fraudulent statements or representations as to any matter within its jurisdiction.

**** BLM REVISED ** BLM REVISED ** BLM REVISED ** BLM REVISED ** BLM REVISED ****

CHESAPEAKE OPERATING, INC.

CHK Name & Number: PLU PIERCE CANYON 28 FED 1H
 API Number: 30-015-36830 624840
 County: EDDY
 State: NM
 Field: WILDCAT
 Qtr Qtr Calls: SESE
 Sec/Twnshp/Rng: 28-24S-30E
 Number of Acres: 160

Regulatory Agency: BLM
 Lease Sign Type: APD WELL
 CA#: 100% BLM LEASE
 APD Lease #: NMNM 2862
 Federal/Indian: FEDERAL
 Last Violation: UNKNOWN
 District: PERMIAN
 Field Office: HOBBS

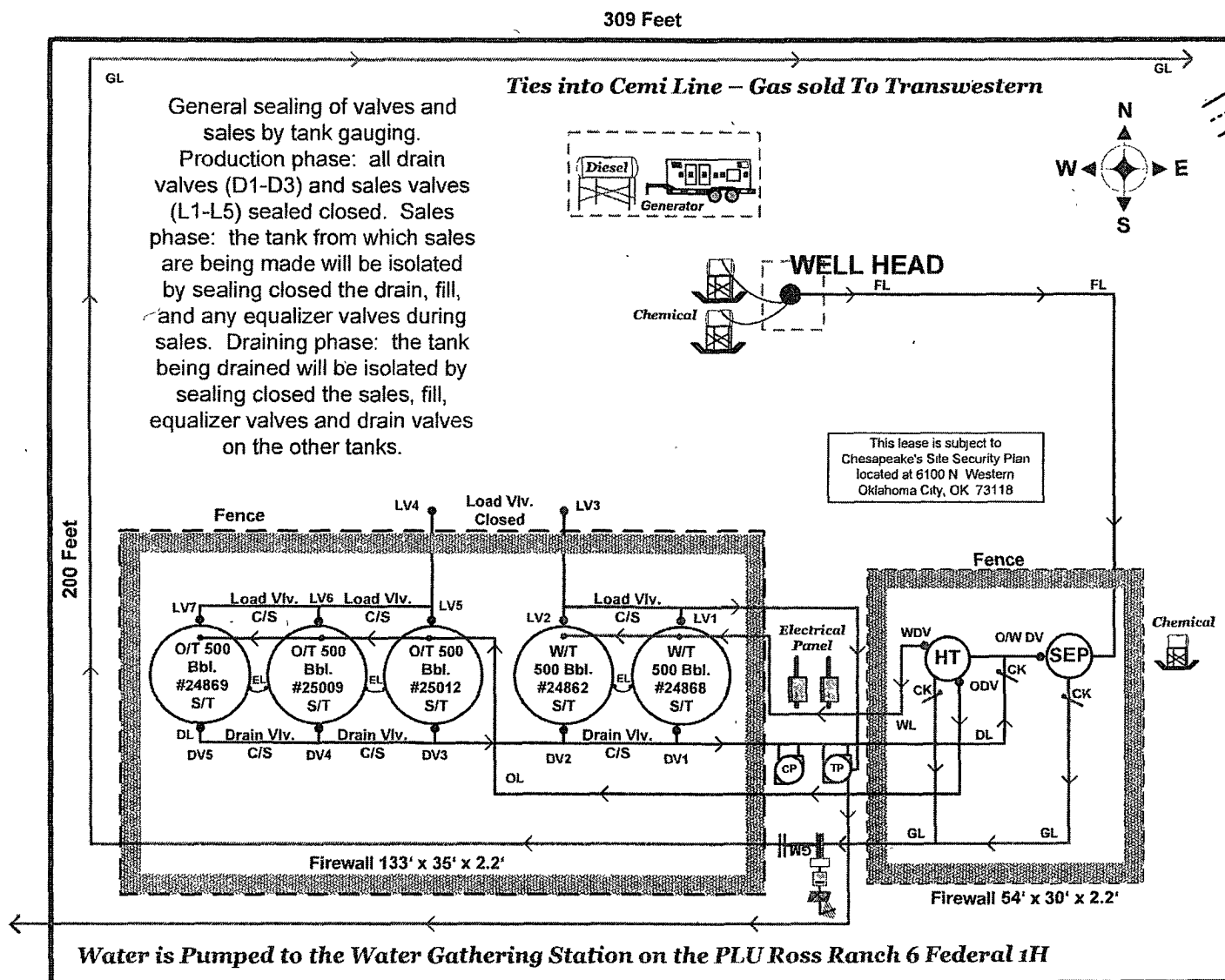

Direction of Flow off Site:
North

Prepared by: Jackie Reynolds
 Date: 8-13-2009

Approved by:
 Date: