

UNITED STATES
DEPARTMENT OF THE INTERIOR
BUREAU OF LAND MANAGEMENT

N.M. Oil Cons. Div-Dist. 2

1301 W. Grand Avenue

Artesia, NM 88210

FORM APPROVED
OMB NO. 1004-0137
Expires: November 30, 2000

WELL COMPLETION OR RECOMPLETION REPORT AND LOG

| | | | | | |
|---|--|--|---|--|--|
| 1a. Type of Well <input type="checkbox"/> Oil Well <input checked="" type="checkbox"/> Gas Well <input type="checkbox"/> Dry <input type="checkbox"/> Other | | | 5. Lease Serial No. LC 051102A | | |
| b. Type of Completion: <input type="checkbox"/> New Well <input type="checkbox"/> Work Over <input type="checkbox"/> Deepen <input checked="" type="checkbox"/> Plug Back <input type="checkbox"/> Diff. Resrv., Other | | | 6. If Indian, Allottee or Tribe Name | | |
| 2. Name of Operator EOG Resources Inc. | | | 7. Unit or CA Agreement Name and No. | | |
| 3. Address P.O. Box 2267 Midland TX 79702 | | | 8. Lease Name and Well No. Sand Tank 1 Fed Com No. 1 | | |
| 3a. Phone No. (include area code) 915 686 3689 | | | 9. API Well No. 30-015-29221 S2 | | |
| 4. Location of Well (Report location clearly and in accordance with Federal requirements) At surface 2155' FNL & 687' FEL, U/L-H At top prod. interval reported below At total depth | | | 10. Field No. P.M. Exploratory Sand Tank Strawn (Gas) | | |
| 14. Date Spudded 10/26/96 | | | 15. Date T.D. Reached 11/02/96 | | |
| 16. Date Completed <input type="checkbox"/> D & A <input checked="" type="checkbox"/> Ready to Prod. 10/26/02 | | | 17. Elevations (DF, RKB, RT, GL)* 3527 GL | | |
| 18. Total Depth: MD TVD 11645 | | | 19. Plug Back T.D.: MD TVD 10990 | | |
| 20. Depth Bridge Plug Set: MD TVD 11025 | | | 21. Type Electric & Other Mechanical Logs Run (Submit copy of each) | | |
| 22. Was well cored? <input checked="" type="checkbox"/> No <input type="checkbox"/> Yes (Submit analysis) Was DST run <input checked="" type="checkbox"/> No <input type="checkbox"/> Yes (Submit report) Directional Survey? <input type="checkbox"/> No <input checked="" type="checkbox"/> Yes (Submit copy) | | | | | |

| 23. Casing and Liner Record (Report all strings set in well) | | | | | | | | | |
|--|------------|------------|----------|-------------|--------------------|------------------------------|-------------------|-------------|---------------|
| Hole Size | Size/Grade | Wt. (#ft.) | Top (MD) | Bottom (MD) | Stage Cement Depth | No. of Sks. & Type of Cement | Slurry Vol. (BBL) | Cement Top* | Amount Pulled |
| 14 3/4 | 11 3/4 | 42 | | 662 | | 400 PP | | Surface | |
| 11 | 8 5/8 | 32 | | 3918 | | 1350 PP | | Surface | |
| 7 7/8 | 5 1/2 | 17 | | 11645 | | 1335 PP | | 3919 TS | |
| | | | | | | | | | |
| | | | | | | | | | |
| | | | | | | | | | |

| 24. Tubing Record | | | | | | | | | |
|-------------------------|----------------|-------------------|---------------------|----------------|------------------------|------------------|----------------|-------------------|--|
| Size | Depth Set (MD) | Packer Depth (MD) | Size | Depth Set (MD) | Packer Depth (MD) | Size | Depth Set (MD) | Packer Depth (MD) | |
| 2 7/8 | 10267 | | | | | | | | |
| 25. Producing Intervals | | | | | 26. Perforation Record | | | | |
| Formation | Top | Bottom | Perforated Interval | Size | No. Holes | Perf. Status | | | |
| A) Strawn | 10245 | | 10368-10472 | 4" | 120 | Producing | | | |
| B) Middle Morrow | 11007 | | 11087-11114 | | 163 | Inactive | | | |
| C) Lower Morrow | 11173 | | 11237-11286 | | 115 | Inactive | | | |
| D) Chester Lime | 11521 | | 11529-11533 | | 17 | Inactive | | | |

| 27. Acid, Fracture, Treatment, Cement Squeeze, Etc. | | | | | | | | | |
|---|--|--|--|--|--|--|--|--|--|
| Depth Interval | | | Amount and Type of Material | | | | | | |
| 10368-10472 | | | Spot 250 gal 20% NEFE. Reverse 10 bbls 2% KCL water. | | | | | | |
| | | | Spot 250 gal 20% NEFE acid, followed w/ 4000 gal 20% NEFE acid. | | | | | | |
| | | | | | | | | | |

| 28. Production - Interval A | | | | | | | | | |
|-----------------------------|----------------------|--------------|-----------------|-----------|------------|-----------|----------------|-------------|-------------------|
| Date First Produced | Test Date | Hours Tested | Test Production | Oil BBL | Gas MCF | Water BBL | Oil Gravity | Gas Gravity | Production Method |
| 10/26/02 | 11/9/02 | 24 | → | 80 | 601 | 0 | 60.0 | | |
| Choke Size | Tbg. Press. Flwg. SI | Csg. Press. | 24 Hr. | Oil BBL | Gas MCF | Water BBL | Gas: Oil Ratio | Well Status | |
| 20/64 | 300 | | → | 80 | 601 | 0 | 7513 | FGW | |

| 28a. Production-Interval B | | | | | | | | | |
|----------------------------|----------------------|--------------|-----------------|---------|---------|-----------|----------------|-------------|-------------------|
| Date First Produced | Test Date | Hours Tested | Test Production | Oil BBL | Gas MCF | Water BBL | Oil Gravity | Gas Gravity | Production Method |
| | | | → | | | | | | |
| Choke Size | Tbg. Press. Flwg. SI | Csg. Press. | 24 Hr. | Oil BBL | Gas MCF | Water BBL | Gas: Oil Ratio | Well Status | |
| | | | → | | | | | | TA |

ACCEPTED FOR RECORD

DEC 2 2002
FlowingALEXIS C. SWOBODA
PETROLEUM ENGINEER

28b. Production - Interval C

| Date First Produced | Test Date | Hours Tested | Test Production → | Oil BBL | Gas MCF | Water BBL | Oil Gravity | Gas Gravity | Production Method |
|---------------------|----------------------|--------------|-------------------|---------|---------|-----------|----------------|-------------|-------------------|
| Choke Size | Tbg. Press. Flwg. SI | Csg. Press. | 24 Hr. → | Oil BBL | Gas MCF | Water BBL | Gas: Oil Ratio | Well Status | TA |

28c. Production-Interval D

| Date First Produced | Test Date | Hours Tested | Test Production → | Oil BBL | Gas MCF | Water BBL | Oil Gravity | Gas Gravity | Production Method |
|---------------------|----------------------|--------------|-------------------|---------|---------|-----------|----------------|-------------|-------------------|
| Choke Size | Tbg. Press. Flwg. SI | Csg. Press. | 24 Hr. → | Oil BBL | Gas MCF | Water BBL | Gas: Oil Ratio | Well Status | TA |

29. Disposition of Gas (Sold, used for fuel, vented, etc.)

Sold

30. Summary of Porous Zones (Include Aquifers):

Show all important zones of porosity and contents thereof: Cored intervals and all drill-stem tests, including depth interval tested, cushion used, time tool open, flowing and shut-in pressures and recoveries

31. Formation (Log) Markers

| Formation | Top | Bottom | Descriptions, Contents, etc. | Name | Top |
|-----------|-----|--------|------------------------------|-----------------|-------------|
| | | | | | Meas. Depth |
| | | | | Grayburg | 2867 |
| | | | | San Andres | 3139 |
| | | | | Bone Spring | 4328 |
| | | | | 1st Bone Spring | 6373 |
| | | | | 2nd Bone Spring | 7116 |
| | | | | 3rd Bone Spring | 8097 |
| | | | | Wolfcamp | 8177 |
| | | | | Strawn | 10245 |
| | | | | Atoka | 10484 |
| | | | | Middle Morrow | 11007 |
| | | | | Lower Morrow | 11173 |
| | | | | Mississippian | 11521 |
| | | | | (Chester Lime) | |

32. Additional remarks (include plugging procedure):

33. Circle enclosed attachments:

1. Electrical/Mechanical Logs (1 full set req'd) 2. Geologic Report 3. DST Report 4. Directional Survey
5. Sundry Notice for plugging and cement verification 6. Core Analysis 7. Other

34. I hereby certify that the foregoing and attached information is complete and correct as determined from all available records (see attached instructions)*

Name (please print) Stan WagnerTitle Regulatory AnalystSignature Stan WagnerDate 11/25/02

District I
PO Box 1980, Hobbs, NM 88241-1980

District II
PO Drawer DD, Artesia, NM 88211-0719

District III
1000 Rio Brazos Rd., Artesia, NM 87410

District IV
PO Box 2088, Santa Fe, NM 87504-2088

State of New Mexico

Energy, Minerals & Natural Resources Department

OIL CONSERVATION DIVISION
PO Box 2088
Santa Fe, NM 87504-2088

Form C-102

Revised February 21, 1994

Instructions on back

Submit to Appropriate District Office

State Lease - 4 Copies

Fee Lease - 3 Copies

☐ AMENDED REPORT

WELL LOCATION AND ACREAGE DEDICATION PLAT

| | | |
|-----------------------------|---|---------------------------------------|
| 'API Number 30-025-29221 | 'Pool Code 84874 | 'Pool Name Sand Tank; Strawn (Gas) |
| 'Property Code | 'Property Name SAND TANK "1" FEDERAL COM | 'Well Number 1 |
| 'OGRID No. 7377 | 'Operator Name EOG RESOURCES INC. / | 'Elevation 3527 |

¹⁰ Surface Location

| UL or lot no. | Section | Township | Range | Lot Idn | Feet from the | North/South line | Feet from the | East/West line | County |
|---------------|---------|----------|-------|---------|---------------|------------------|---------------|----------------|--------|
| H | 1 | 18-S | 29-E | | 2155 | NORTH | 687 | EAST | EDDY |

¹¹ Bottom Hole Location If Different From Surface

| UL or lot no. | Section | Township | Range | Lot Idn | Feet from the | North/South line | Feet from the | East/West line | County |
|---------------|---------|----------|-------|---------|---------------|------------------|---------------|----------------|--------|
| | | | | | | | | | |

| | | | |
|-------------------------|------------------|---------------------|------------|
| "Dedicated Acres 320 | "Joint or Infill | "Consolidation Code | "Order No. |
|-------------------------|------------------|---------------------|------------|

NO ALLOWABLE WILL BE ASSIGNED TO THIS COMPLETION UNTIL ALL INTERESTS HAVE BEEN CONSOLIDATED
OR A NON-STANDARD UNIT HAS BEEN APPROVED BY THE DIVISION

| | |
|---------------|--|
| <div>16</div> | <div>17 OPERATOR CERTIFICATION</div> <p>I hereby certify that the information contained herein is true and complete to the best of my knowledge and belief.</p> <p><i>Stan Wagner</i> Signature Stan Wagner Printed Name Regulatory Analyst Title 1/29/03 Date</p> |
| | <div>18 SURVEYOR CERTIFICATION</div> <p>I hereby certify that the well location shown on this plat was plotted from field notes of actual surveys made by me or under my supervision, and that the same is true and correct to best of my belief.</p> <p>November 15, 2002 Date of Survey Signature and Seal of Professional Surveyor: <i>James E. Tompkins</i> Certificate Number 14729</p> |

HOLLAND & HART^{LLP}
ATTORNEYS AT LAW

DENVER • ASPEN
BOULDER • COLORADO SPRINGS
DENVER TECH CENTER
BILLINGS • BOISE
CHEYENNE • JACKSON HOLE
SALT LAKE CITY • SANTA FE
WASHINGTON, D.C.

P.O. BOX 2208
SANTA FE, NEW MEXICO 87504-2208
110 NORTH GUADALUPE, SUITE 1
SANTA FE, NEW MEXICO 87501-6526

TELEPHONE (505) 988-4421
FACSIMILE (505) 983-6043

William F. Carr

wcarr@hollandhart.com

May 14, 2003

HAND-DELIVERED

Lori Wrotenbery, Director
Oil Conservation Division
New Mexico Department of Energy,
Minerals and Natural Resources
1220 South Saint Francis Drive
Santa Fe, New Mexico 87505

Re: Application of EOG Resources, Inc. for administrative approval of an unorthodox well location for its Sand Tank "1" Federal Com Well No. 1, (API No. 30-015-29221) located 2155 feet from the North line and 687 feet from the East line of Section 1, Township 18 South, Range 29 East, N.M.P.M., Eddy County, New Mexico.

Dear Ms. Wrotenbery:

EOG Resources, Inc. hereby seeks administrative approval pursuant to the provisions of Division Rule 104 F (2)-(4) adopted on August 12, 1999, of an unorthodox well location in the Strawn formation for its Sand Tank "1" Federal Com Well No. 1 located 2155 feet from the North line and 687 feet from the East line of Section 1, Township 18 South, Range 29 East, N.M.P.M., Eddy County, New Mexico. This well was drilled to the to test the Morrow formation in the fall of 1996 and completed in the Sand Tank-Morrow Gas Pool. A standard 320-acre spacing and proration unit comprised of the E/2 of Section 1 was dedicated to the well in the Morrow formation. At that time and the location was standard for a deep gas well drilled on this 320-acre spacing unit. EOG originally proposed the well to the Strawn formation, Undesignated Sand Tank Strawn Pool, as well as to the Morrow formation but the well was not completed in the Strawn at that time.

This well location in the Strawn formation is now unorthodox because it is governed by the Division's statewide rules which were amended after the well was drilled and now provide for deep gas wells on 320-spacing units to be located no closer than 660 feet to the outer boundary of the quarter section on which the well is located and no closer than

Administrative application for unorthodox well location
Sand Tank "1" Federal Com Well No. 1
May 14 2003
Page 2

10 feet to any quarter-quarter section line or subdivision inner boundary. The proposed unorthodox well location is unorthodox because it is 485 feet from the outer boundary of a quarter section on which it is located.

Attached hereto as Exhibit 1 is a plat which shows the subject area, the 320-acre spacing unit comprised of all of the E/2 of Section 1 and the proposed unorthodox location. Since this well location only encroaches on the SE/4 of the Section and this acreage will be dedicated to the well, the ownership in this tract and the drill tract is identical and there are no "affected parties" to whom notice of this application is required pursuant to Division Rule 1207.

Your attention to this application is appreciated.

Very truly yours,

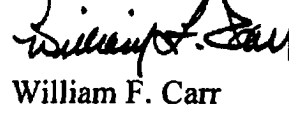

William F. Carr
Attorney for EOG Resources, Inc.

Enclosures

cc: Patrick J. Tower, Project Landman
EOG Resources, Inc.
Post Office Box 2267
Midland, Texas 79702

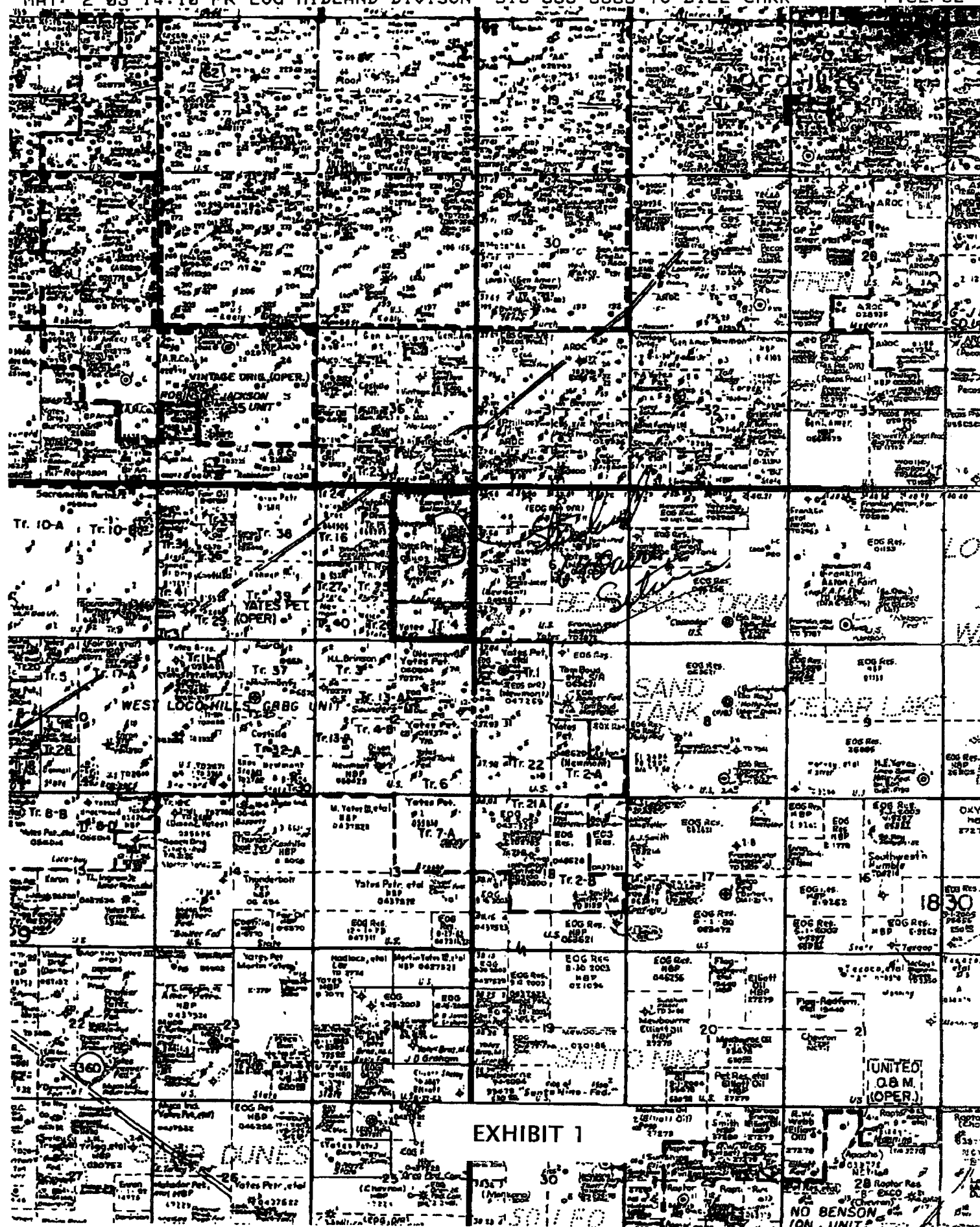

County Eddy Pool Bear Grass Draw - Strawn

TOWNSHIP 18 South Range 29 East NMPM

| | | | | | | |
|----|----|----|----|----|----|--|
| | | | | | | |
| 6 | 5 | 4 | 3 | 2 | 1 | |
| | | | | | | |
| 7 | 8 | 9 | 10 | 11 | 12 | |
| | | | | | | |
| 18 | 17 | 16 | 15 | 14 | 13 | |
| | | | | | | |
| 19 | 20 | 21 | 22 | 23 | 24 | |
| | | | | | | |
| 30 | 29 | 28 | 27 | 26 | 25 | |
| | | | | | | |
| 31 | 32 | 33 | 34 | 35 | 36 | |
| | | | | | | |

Description: N¹/₄ Sec. 1 (A-11952, 4-30-05)