

DISTRICT I  
1625 N. French Dr., Hobbs, NM 88240  
DISTRICT II  
1801 W. Grand Avenue, Artesia, NM 88210  
DISTRICT III  
1000 Rio Bravos Rd., Aztec, NM 87410  
DISTRICT IV  
1220 S. St. Francis Dr., Santa Fe, NM 87505

State of New Mexico  
Energy, Minerals and Natural Resources Department

OIL CONSERVATION DIVISION  
1220 South St. Francis Dr.  
Santa Fe, New Mexico 87505

S

Form C-102  
Revised October 12, 2005

Submit to Appropriate District Office  
State Lease - 4 Copies  
Fee Lease - 3 Copies

SEP - 2 2008

OCD-ARTESIA

☐ AMENDED REPORT

WELL LOCATION AND ACREAGE DEDICATION PLAT

API Number <b>30-015-36577</b>	Pool Code	Pool Name <b>BONE SPRING, GAS</b>
Property Code	Property Name <b>GUARDIAN "25" STATE COM</b>	Well Number <b>1</b>
OGRD No. <b>6137</b>	Operator Name <b>DEVON ENERGY PRODUCTION COMPANY LP</b>	Elevation <b>3484'</b>

Surface Location

UL or lot No.	Section	Township	Range	Lot Idn	Feet from the	North/South line	Feet from the	East/West line	County
F	25	19 S	27 E		1980	NORTH	1980	WEST	EDDY

Bottom Hole Location If Different From Surface

UL or lot No.	Section	Township	Range	Lot Idn	Feet from the	North/South line	Feet from the	East/West line	County
Dedicated Acres <b>160</b>		Joint or Infill	Consolidation Code		Order No.				

NO ALLOWABLE WILL BE ASSIGNED TO THIS COMPLETION UNTIL ALL INTERESTS HAVE BEEN CONSOLIDATED  
OR A NON-STANDARD UNIT HAS BEEN APPROVED BY THE DIVISION

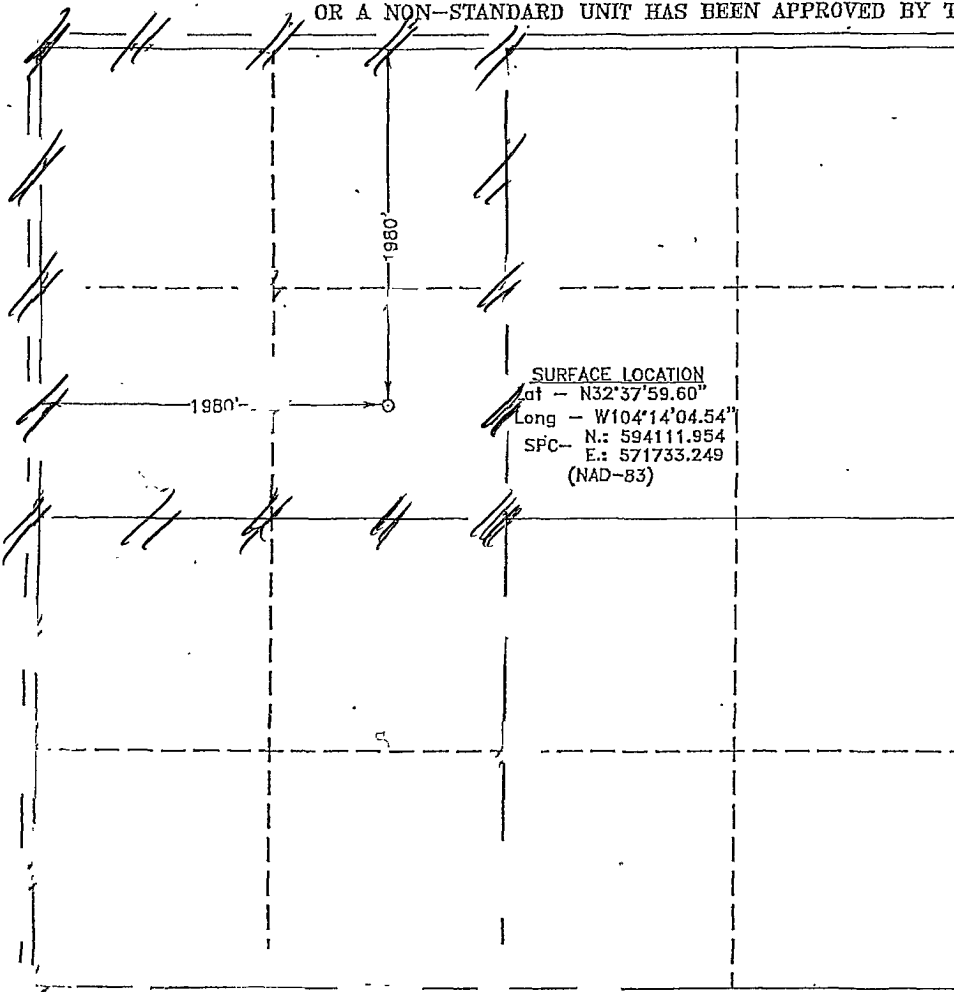

OPERATOR CERTIFICATION

I hereby certify that the information contained herein is true and complete to the best of my knowledge and belief, and that this organization either owns a working interest or unleased mineral interest in the land including the proposed bottom hole location pursuant to a contract with an owner of such a mineral or working interest, or to a voluntary pooling agreement or a compulsory pooling order heretofore entered by the division.

Signature *[Signature]* Date **08/29/08**  
Printed Name **STEPHANIE A. YSASAGA**

SURVEYOR CERTIFICATION

I hereby certify that the well location shown on this plat was plotted from field notes of actual surveys made by me or under my supervision, and that the same is true and correct to the best of my belief.

Date Surveyed **AUGUST 11, 2008**  
Signature *[Signature]*  
Professional Surveyor  
W.O. **7977**  
Certificate No. Gary L. Jones **7977**

BASIN SURVEYS