

DISTRICT I
1625 N. FRENCH DR., HOBBS, NM 88240

DISTRICT II
6601 W. GRAND AVENUE, ARTESIA, NM 88210

DISTRICT III
1000 RIO BRAZOS RD., AZTEC, NM 87410

DISTRICT IV
11885 S. ST. FRANCIS DR., SANTA FE, NM 87505

State of New Mexico
Energy, Minerals and Natural Resources Department

OIL CONSERVATION DIVISION
11885 SOUTH ST. FRANCIS DR.
Santa Fe, New Mexico 87505

Form C-102

Revised October 12, 2005
Submit to Appropriate District Office
State Lease - 4 Copies
Fee Lease - 3 Copies

WELL LOCATION AND ACREAGE DEDICATION PLAT

☐ AMENDED REPORT

API Number 30-015-38517	Pool Code 28509	Pool Name GRAYBURG JACKSON; SR-Q-G-SA
Property Code 308036	Property Name BURCH KEELY UNIT	Well Number 616
OGRID No. 229137	Operator Name COG OPERATING, LLC	Elevation 3598'

Surface Location

UL or lot No. D	Section 24	Township 17-S	Range 29-E	Lot Idn	Feet from the 532	North/South line NORTH	Feet from the 660	East/West line WEST	County EDDY
--------------------	---------------	------------------	---------------	---------	----------------------	---------------------------	----------------------	------------------------	----------------

Bottom Hole Location If Different From Surface

UL or lot No.	Section	Township	Range	Lot Idn	Feet from the	North/South line	Feet from the	East/West line	County
Dedicated Acres 40	Joint or Infill	Consolidation Code	Order No.						

NO ALLOWABLE WILL BE ASSIGNED TO THIS COMPLETION UNTIL ALL INTERESTS HAVE BEEN CONSOLIDATED
OR A NON-STANDARD UNIT HAS BEEN APPROVED BY THE DIVISION

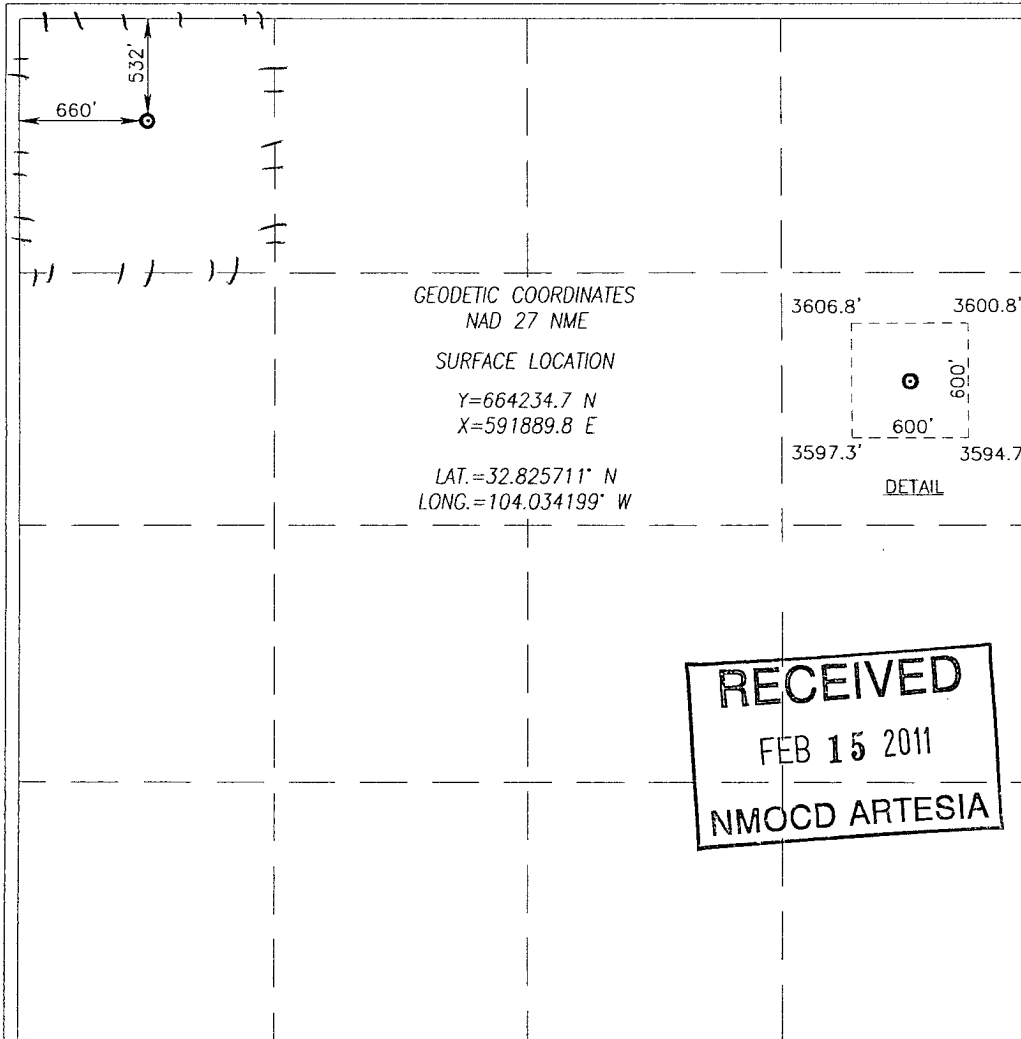

OPERATOR CERTIFICATION

I hereby certify that the information herein is true and complete to the best of my knowledge and belief, and that this organization either owns a working interest or unleased mineral interest in the land including the proposed bottom hole location or has a right to drill this well at this location pursuant to a contract with an owner of such mineral or working interest, or to a voluntary pooling agreement or a compulsory pooling order heretofore entered by the division.

Signature: Robyn Odom
Date: 10/14/2010

Printed Name: Robyn Odom

SURVEYOR CERTIFICATION

I hereby certify that the well location shown on this plat was plotted from field notes of actual surveys made by me or under my supervision, and that the same is true and correct to the best of my belief.

Date Surveyed: OCTOBER 14, 2010
Signature & Seal of Professional Surveyor: RONALD J. EIDSON
Certificate No.: 12641

Professional Surveyor: RONALD J. EIDSON
12641
10.11.1439
Certificate No.: 12661
RONALD J. EIDSON
3239

RECEIVED
FEB 15 2011
NMOCD ARTESIA