

**District I**  
1625 N. French Dr., Hobbs, NM 88240  
**District II**  
1301 W. Grand Avenue, Artesia, NM 88210  
**District III**  
1000 Rio Brazos Rd., Aztec, NM 87410  
**District IV**  
1220 S. St. Francis Dr., Santa Fe, NM 87505

State of New Mexico  
Energy, Minerals & Natural Resources Department  
**OIL CONSERVATION DIVISION**  
1220 South St. Francis Dr.  
Santa Fe, NM 87505

Form C-102  
Revised October 12, 2005  
Submit to Appropriate District Office  
State Lease - 4 Copies  
Fee Lease - 3 Copies

AMENDED REPORT

**WELL LOCATION AND ACREAGE DEDICATION PLAT**

<sup>1</sup> API Number 30-015-38562		<sup>2</sup> Pool Code 24750		<sup>3</sup> Pool Name Forty Niner Ridge; Delaware	
<sup>4</sup> Property Code 28510 ✓		<sup>5</sup> Property Name Forty Niner Ridge Unit ✓			<sup>6</sup> Well Number 13H ✓
<sup>7</sup> OGRID No. 2712 ✓		<sup>8</sup> Operator Name Strata Production Co. ✓			<sup>9</sup> Elevation 3141

<sup>10</sup> Surface Location

UL or lot no.	Section	Township	Range	Lot Idn	Feet from the	North/South line	Feet from the	East/West line	County
N	10	23 S	30 E		330	SOUTH	2555	WEST	Eddy ✓

<sup>11</sup> Bottom Hole Location If Different From Surface

UL or lot no.	Section	Township	Range	Lot Idn	Feet from the	North/South line	Feet from the	East/West line	County
M	15	23 S	30 E		1010	SOUTH	1253	WEST	Eddy

<sup>12</sup> Dedicated Acres	<sup>13</sup> Joint or Infill	<sup>14</sup> Consolidation Code	<sup>15</sup> Order No.

No allowable will be assigned to this completion until all interests have been consolidated or a non-standard unit has been approved by the division.

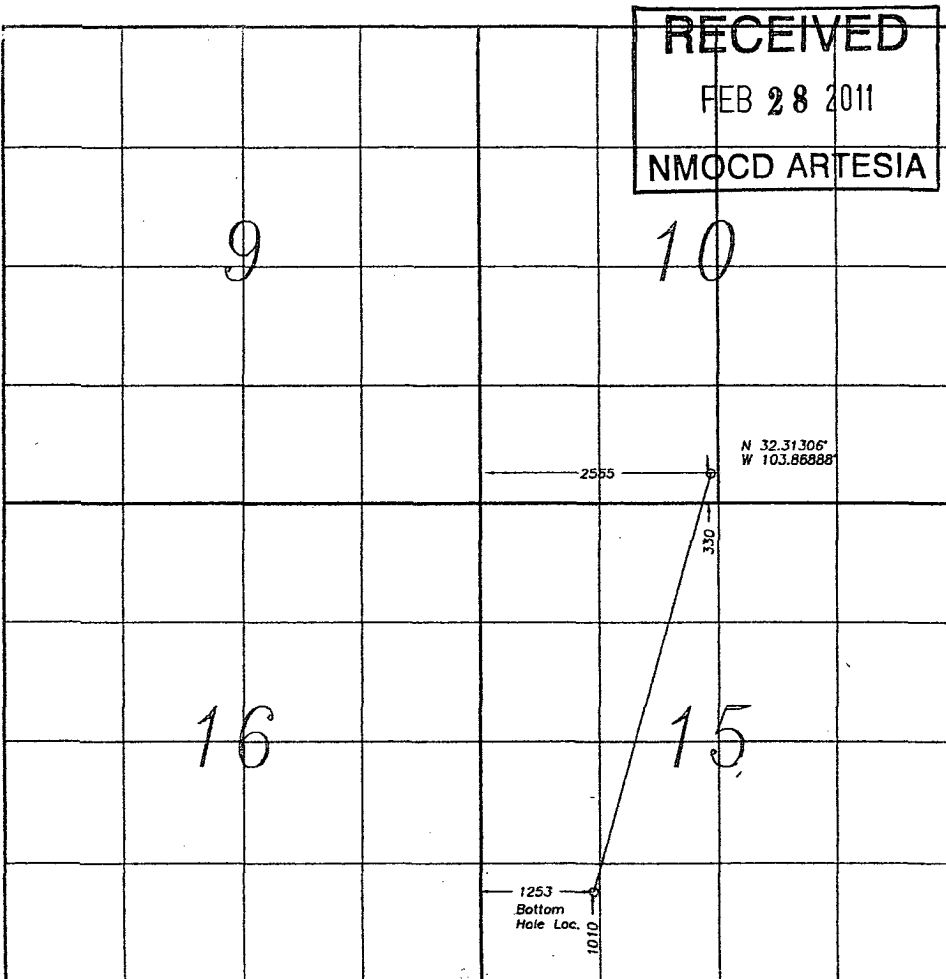

<sup>17</sup> **OPERATOR CERTIFICATION**  
I hereby certify that the information contained herein is true and complete to the best of my knowledge and belief, and that this organization either owns a working interest or unleased mineral interest in the land including the proposed bottom hole location or has a right to drill this well at this location pursuant to a contract with an owner of such a mineral or working interest, or to a voluntary pooling agreement or a compulsory pooling order heretofore entered by the division.

*Frank S. Morgan* 09/10/10  
Signature Date

**FRANK S. MORGAN**  
Printed Name

---

<sup>18</sup> **SURVEYOR CERTIFICATION**  
I hereby certify that the well location shown on this plat was plotted from field notes of actual surveys made by me or under my supervision, and that the same is true and correct to the best of my belief.

August 10, 2010  
Date of Survey

Signature and Seal of Professional Surveyor

**P. R. PATTON**  
REGISTERED PROFESSIONAL LAND SURVEYOR

Certificate Number 8112

PROJECT AREA??

Wg