

NUMBER OF COPIES RECEIVED	
DISTRIBUTION	
1	6
J.S.C.S.	
LAND OFFICE	
TRANSPORTER	OIL GAS
PRORATION OFFICE	
OPERATOR	

NEW MEXICO OIL CONSERVATION COMMISSION  
Santa Fe, New Mexico

Form C-101  
Revised (12/1/55)

NOTICE OF INTENTION TO DRILL 30-005-10071

Notice must be given to the District Office of the Oil Conservation Commission and approval obtained before drilling or recompletion begins. If changes in the proposed plan are considered advisable, a copy of this notice showing such changes will be returned to the sender. Submit this notice in QUINTUPPLICATE. One copy will be returned following approval. See additional instructions in Rules and Regulations of the Commission. If State Land submit 6 Copies Attach Form C-128 in triplicate to first 3 copies of form C-101

Roswell, New Mexico

(Place)

December 28, 1963

(Date)

OIL CONSERVATION COMMISSION  
SANTA FE, NEW MEXICO

Gentlemen:

You are hereby notified that it is our intention to commence the Drilling of a well to be known as

Dr. Sam G. Dunn 1312 Main St., Lubbock, Texas.

(Company, or Operator)

Sturgeon

(Lease)

Well No. 2

in F

(Unit)

The well is

located 2310 feet from the North line and 2329.0 feet from the West line of Section 33, T. 6 South, R. 26 E., NMPM.

(GIVE LOCATION FROM SECTION LINE)

Linda San Andres

Pool, Chaves

County

If State Land the Oil and Gas Lease is No.

If patented land the owner is Sturgeon Beckford

Address Roswell, New Mexico

We propose to drill well with drilling equipment as follows: Rotary

The status of plugging bond is 10,000 Blanket RECEIVED

Drilling Contractor H. E. Barnes

DEC 31 1963

Roswell, New Mexico

O. C. O.  
ARTESIA, OFFICE

We intend to complete this well in the San Andres

formation at an approximate depth of 1100 feet.

CASING PROGRAM

We propose to use the following strings of Casing and to cement them as indicated:

Size of Hole	Size of Casing	Weight per Foot	New or Second Hand	Depth	Sacks Cement
11"	8 5/8	32#	Used	100 ft.	Circulate
6 3/4	4 1/2	9 1/2	New	1100 ft.	50 Sacks

If changes in the above plans become advisable we will notify you immediately.

ADDITIONAL INFORMATION (If recompletion give full details of proposed plan of work.)

Approved 12/30/63, 19.....  
Except as follows:

OIL CONSERVATION COMMISSION

By M. Armstrong

Sincerely yours,

Dr. Sam G. Dunn

(Company or Operator)

By H. E. Barnes

Position Representative

Send Communications regarding well to

Name Dr. Sam G. Dunn

Address 1312 Main St., Lubbock, Texas.

**NEW MEXICO OIL CONSERVATION COMMISSION  
WELL LOCATION AND ACREAGE DEDICATION PLAT**

FORM C-128  
Revised 5/1/57

**SEE INSTRUCTIONS FOR COMPLETING THIS FORM ON THE REVERSE SIDE**

**SECTION A**

Operator <b>DR. SAM DUNN</b>		Lease <b>STURGEON</b>		Well No. <b>3</b>
Unit Letter <b>F</b>	Section <b>33</b>	Township <b>6 SOUTH</b>	Range <b>26 EAST</b>	County <b>CHAVES</b>
Actual Footage Location of Well: <b>2310</b> feet from the <b>NORTH</b> line and <b>2329.0</b> feet from the <b>WEST</b> line				
Ground Level Elev.	Producing Formation <b>San Andres</b>	Pool <b>Linda San Andres</b>	Dedicated Acreage: <b>40</b> Acres	

1. Is the Operator the only owner in the dedicated acreage outlined on the plat below? YES **XX** NO \_\_\_\_ . ("Owner" means the person who has the right to drill into and to produce from any pool and to appropriate the production either for himself or for himself and another. (65-3-29 (e) NMSA 1935 Comp.)
2. If the answer to question one is "no," have the interests of all the owners been consolidated by communitization agreement or otherwise? YES \_\_\_\_ NO \_\_\_\_ . If answer is "yes," Type of Consolidation \_\_\_\_\_
3. If the answer to question two is "no," list all the owners and their respective interests below:

Owner	Land Description
	RESERVE
	1963

**SECTION B**

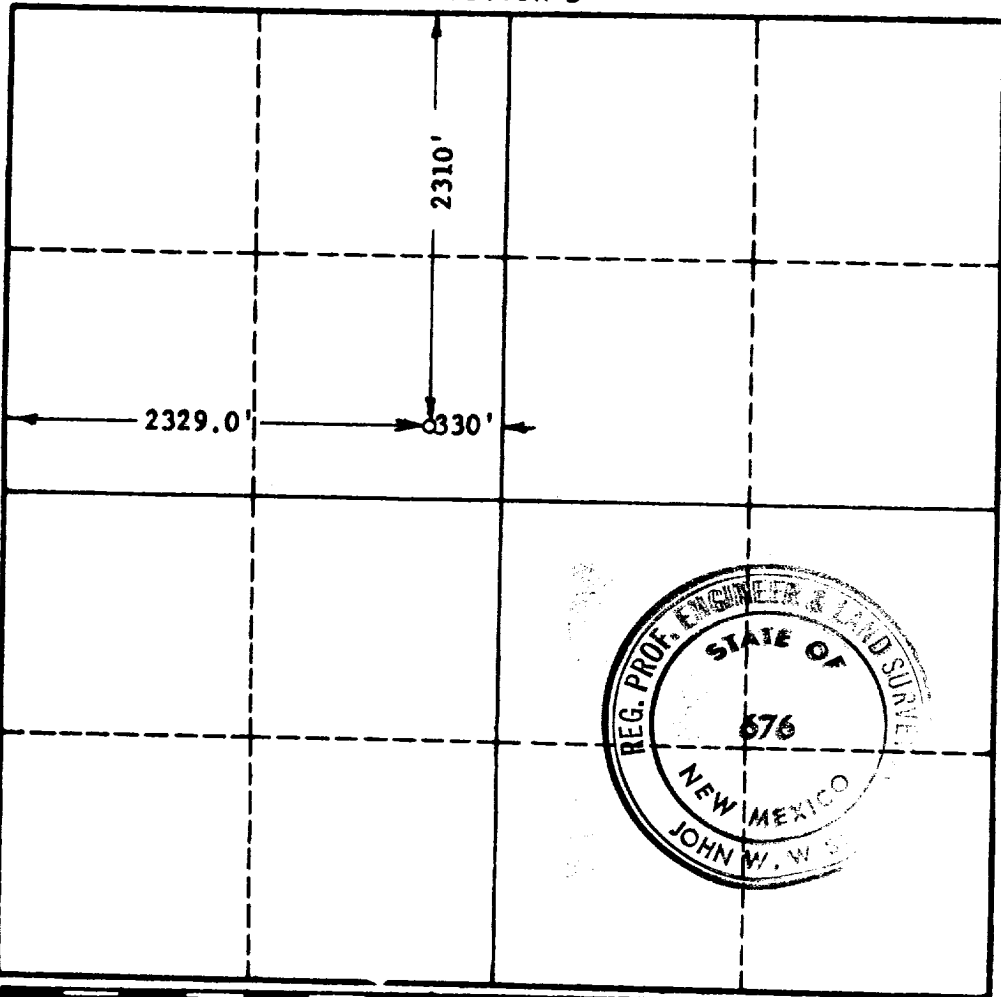

**CERTIFICATION OFFICE**

I hereby certify that the information in SECTION A above is true and complete to the best of my knowledge and belief.

Name <i>J. C. Barman</i>
Position <b>Representative</b>
Company <b>Dr. Sam G. Dunn</b>
Date <b>12-28-63</b>

I hereby certify that the well location shown on the plat in SECTION B was plotted from field notes of actual surveys made by me or under my supervision, and that the same is true and correct to the best of my knowledge and belief.

Date Surveyed <b>DEC. 27, 1963</b>
Registered Professional Engineer and/or Land Surveyor, <b>JOHN W. WEST</b>
<i>John W. West</i>
Certificate No. <b>N. M. - P. E. &amp; L. S. NO. 676</b>

