

UNITED STATES
DEPARTMENT OF THE INTERIOR
GEOLOGICAL SURVEY

APPLICATION FOR PERMIT TO DRILL, DEEPEN, OR PLUG BACK

1a. TYPE OF WORK
DRILL ☒ DEEPEN ☐ PLUG BACK ☐

b. TYPE OF WELL
OIL WELL ☒ GAS WELL ☐ OTHER ☐ SINGLE ZONE ☒ MULTIPLE ZONE ☐

2. NAME OF OPERATOR
McCLELLAN OIL CORPORATION

3. ADDRESS OF OPERATOR
Box 848, Roswell, New Mexico 88201

4. LOCATION OF WELL (Report location clearly and in accordance with any State requirements.)*
At surface 1980' FSL & 660' FEL
At proposed prod. zone

5. LEASE DESIGNATION AND SERIAL NO.
NM-0324243

6. IF INDIAN, ALLOTTEE OR TRIBE NAME

7. UNIT AGREEMENT NAME
NORTH KING CAMP UNIT

8. FARM OR LEASE NAME

9. WELL NO.
8

10. FIELD AND POOL, OR WILDCAT
WILDCAT

11. SEC., T., R., M., OR BLK. AND SURVEY OR AREA
Sec. 27, T13S, R29E

12. COUNTY OR PARISH
CHAVES

13. STATE
NEW MEXICO

14. DISTANCE IN MILES AND DIRECTION FROM NEAREST TOWN OR POST OFFICE*
25 MILES NORTH OF LOCO HILLS

15. DISTANCE FROM PROPOSED* LOCATION TO NEAREST PROPERTY OR LEASE LINE, FT. (Also to nearest drlg. unit line, if any)
660'

16. NO. OF ACRES IN LEASE
2360

17. NO. OF ACRES ASSIGNED TO THIS WELL
40

18. DISTANCE FROM PROPOSED LOCATION* TO NEAREST WELL, DRILLING, COMPLETED, OR APPLIED FOR, ON THIS LEASE, FT.
2000'

19. PROPOSED DEPTH
2000'

20. ROTARY OR CABLE TOOLS
CABLE TOOLS

21. ELEVATIONS (Show whether DF, RT, GR, etc.)
3783' GL

22. APPROX. DATE WORK WILL START*
JANUARY 25, 1973

PROPOSED CASING AND CEMENTING PROGRAM

SIZE OF HOLE	SIZE OF CASING	WEIGHT PER FOOT	SETTING DEPTH	QUANTITY OF CEMENT
12 1/4"	8 5/8"	20 LB.	300'	100 SX CIRCULATED
8"	5 1/2"	15 LB.	2000'	100 SX

PROPOSE TO DRILL TO APPROXIMATELY 2000' TO TEST THE QUEEN SAND.
IF PRODUCTION IS INDICATED, WILL RUN CASING AND ATTEMPT COMPLETION.

CORTEZ DRILLING CO. Box 848, Roswell, N.M. WILL BE THE DRILLING CONTRACTOR.

RECEIVED
JAN 22 1973
U. S. GEOLOGICAL SURVEY
ARTESIA, NEW MEXICO

IN ABOVE SPACE DESCRIBE PROPOSED PROGRAM: If proposal is to deepen or plug back, give data on present productive zone and proposed new productive zone. If proposal is to drill or deepen directionally, give pertinent data on subsurface locations and measured and true vertical depths. Give blowout preventer program, if any.

24. SIGNED Joe L. McClellan TITLE OPERATOR DATE JAN. 20, 1973
(This space for Federal or State office use)
PERMIT NO. _____ APPROVAL DATE _____

APPROVED
JAN 24 1973
H. L. BECKMAN
ACTING DISTRICT ENGINEER

THIS APPROVAL IS VALID IF OPERATIONS
ARE NOT COMMENCED WITHIN 3 MONTHS
EXPIRES APR 24 1973

*See Instructions On Reverse Side

MEXICO OIL CONSERVATION COMMISSION
WELL LOCATION AND ACREAGE DEDICATION PLAT

Form C-102
Supersedes C-128
Effective 1-1-65

All distances must be from the outer boundaries of the Section.

Operator McCLELLAN OIL CORP.			Lease North King Camp Unit		Well No. 8
Unit Letter I	Section 27	Township 13 South	Range 29 East	County Chaves	
Actual Footage Location of Well: 1980 feet from the south line and 660 feet from the east line					
Ground Level Elev. 3783	Producing Formation QUEEN DAND		Pool WILDCAT	Dedicated Acreage: 40 Acres	

- Outline the acreage dedicated to the subject well by colored pencil or hachure marks on the plat below.
- If more than one lease is dedicated to the well, outline each and identify the ownership thereof (both as to working interest and royalty).
- If more than one lease of different ownership is dedicated to the well, have the interests of all owners been consolidated by communitization, unitization, force-pooling, etc?

☐ Yes ☐ No If answer is "yes," type of consolidation _____

If answer is "no," list the owners and tract descriptions which have actually been consolidated. (Use reverse side of this form if necessary.) _____

No allowable will be assigned to the well until all interests have been consolidated (by communitization, unitization, forced-pooling, or otherwise) or until a non-standard unit, eliminating such interests, has been approved by the Commission.

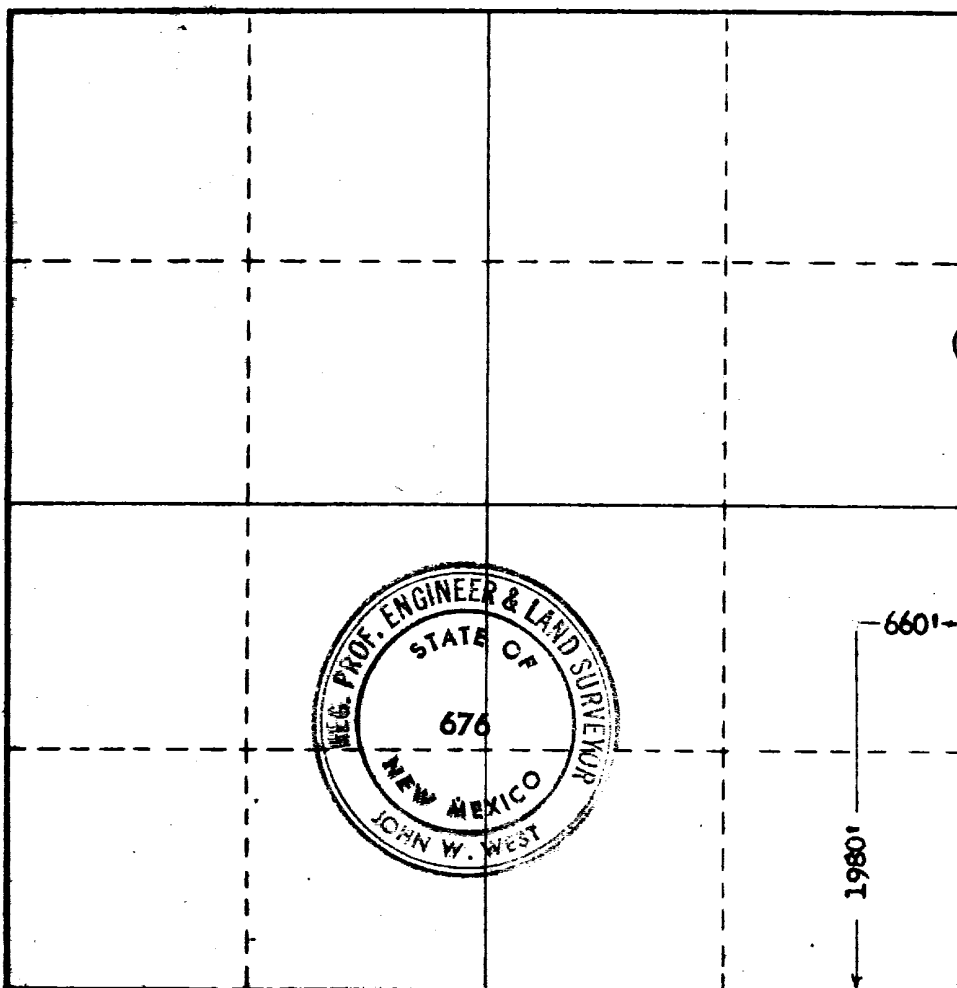

CERTIFICATION

I hereby certify that the information contained herein is true and complete to the best of my knowledge and belief.

Name
John W. West
Position
PRESIDENT
Company
McCLELLAN OIL CORP.

Date
JAN. 20, 1973

I hereby certify that the well location shown on this plat was plotted in the field notes of actual surveys made by me under **ARTESIA** and that the same is true and correct to the best of my knowledge and belief.

Date Surveyed
Jan 18, 1973

Registered Professional Engineer and/or Land Surveyor

John W. West
Certificate No.
676

0 330 660 990 1320 1650 1980 2310 2640 2970 3300 3630 3960 4290 4620 4950 5280 5610 5940 6270 6600



McCLELLAN OIL CORPORATION
Box 848
ROSWELL, NEW MEXICO 88201

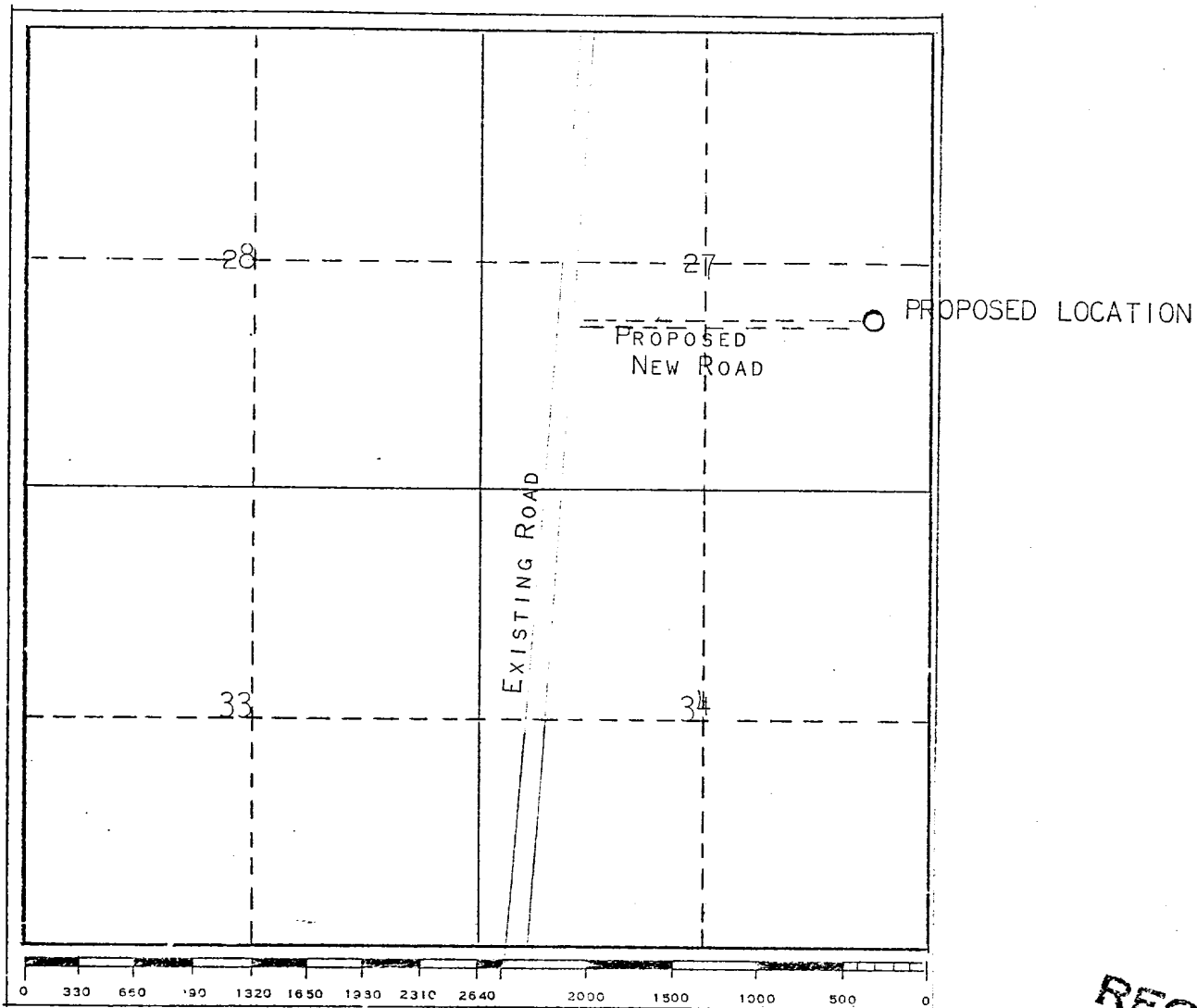

Propose to use existing roads, oilfield and ranch, and to construct approximately 2100' of new road to location. No water exists in this area and will be trucked in to location. Combustable material will be burned, non-combustable material will be buried with pit filling. After completion or abandonment, the pit will be filled and the location cleaned.

RECEIVED
JAN 22 1973
U. S. GEOLOGICAL SURVEY
ARTESIA, NEW MEXICO

