

DISTRICT I
1625 N. French Dr., Hobbs, NM 88240

DISTRICT II
811 South First, Artesia, NM 88210

DISTRICT III
1000 Rio Brazos Rd., Aztec, NM 87410

DISTRICT IV
2040 South Pacheco, Santa Re, NM 8750:

State of New Mexico
Energy, Minerals and Natural Resources Department

OIL CONSERVATION DIVISION
PO BOX 2088
Santa Fe, NM 87504-2088

Form C-101
Revised March 17, 1999
Instructions on back
Submit to appropriate District Office
State Lease - 6 Copies
Fee Lease - 5 Copies

☐ AMENDED REPORT

APPLICATION FOR PERMIT TO DRILL, RE-ENTER, DEEPEN, PLUGBACK, OR ADD A ZONE

¹ Operator Name and Address Yates Petroleum Corporation 105 South Fourth Street Artesia, New Mexico 88210		² OGRID Number 025575
		³ API Number 30 30-005-60266
⁴ Property Code 29682	⁵ Property Name Buried Canyon "AZN" State	⁶ Well No. 1

⁷ Surface Location

UL or lot no.	Section	Township	Range	Lot Idn	Feet from the	North/South Line	Feet from the	East/West Line	County
J	19	5S	26E		2093	South	2128	East	Chaves

⁸ Proposed Bottom Hole Location If Different From Surface

UL or lot no.	Section	Township	Range	Lot Idn	Feet from the	North/South Line	Feet from the	East/West Line	County
⁹ Proposed Pool 1 Wildcat Mississippi					¹⁰ Proposed Pool 2				

¹¹ Work Type Code E	¹² Well Type Code G	¹³ Cable/Rotary R	¹⁴ Lease Type Code S	¹⁵ Ground Level Elevation 3758'
¹⁶ Multiple No	¹⁷ Proposed Depth 5914'	¹⁸ Formation Mississippian	¹⁹ Contractor Not Determined	²⁰ Spud Date ASAP

²¹ Proposed Casing and Cement Program

Hole Size	Casing Size	Casing weight/feet	Setting Depth	Sacks of Cement	Estimated TOC
20"	13 3/8	48#	40'-in place	2 yds redi-mix	Circulate
12 1/4"	8 5/8"	32#	1203'-in place	540 sx	Circulate
7 7/8"	5 1/2"	15.5#	5914'	500 sx	TOC-3000'

²² Describe the proposed program. If this application is to DEEPEN or PLUG BACK give the data on the present productive zone and proposed new productivity. Describe the blowout prevention program, if any. Use additional sheets if necessary.

See Attached Sheets for additional information.

An application for an administrative approval of a non-standard location is being applied for.

23 I hereby certify that the information given above is true and complete to the best of

my knowledge and belief.

Signature:

Clifton R. May

Printed name: Clifton R. May

Title: Regulatory Agent

Date:

01/18/02

Phone:

(505) 748-1471

OIL CONSERVATION DIVISION

Approved by:

**ORIGINAL SIGNED BY TIM W. GUM
DISTRICT II SUPERVISOR**

Title:

Approval Date:

APR 02 2002

Expiration Date:

APR 02 2003

Conditions of Approval

Attached ☐

YATES PETROLEUM CORPORATION

Buried Canyon "AZN" State #1 Re-entry

2093' FSL & 2128' FEL

Section 19-T5S-R26E

Chaves County, New Mexico

Lease #VA-2482

Drilling Plans: This well was originally drilled by L. R. French, Jr. as the Buried Canyon State #1. It was plugged and abandoned in July 1973. Yates Petroleum Corporation plans to re-enter this well bore using a pulling unit and a reverse unit to drill out the cement plugs in the 8 5/8" casing and the 7 7/8" open hole to the old total depth of 5914'. A new suite of open hole logs will be ran. After circulating the hole clean a string of 5 1/2" will be ran to the total depth and cemented with enough cement to bring the top of cement to approximately 3,000'. The mud program to be used will be 9.5-9.7 ppg brine water with a 55-70 viscosity. A 3,000# BOPE will be installed on the 8 5/8" casing.

The well will be completed using a pulling unit. The well will be completed and tested in the Mississippian, and/or Penn, and/or the Wolfcamp.

WELLNAME: Bullied Canyon Slatc 1 (1 R. 1. 1. 1.) FIELD: Wildcat
 LOCATION: 2093' 15' 4" 2128' 15" 19-55-26E Chaves County
 GL: 3,758' ZERO: _____ AGL: _____ KB: 3,769.7'
 SPUD DATE: _____ COMPLETION DATE: _____
 COMMENTS: PdA 7/24/73

CASING PROGRAM	
SIZE/WT/GR/CONN	DEPTH SET
13 3/8" 48#	40'
8 5/8" 32# J-55, STJL	1203'

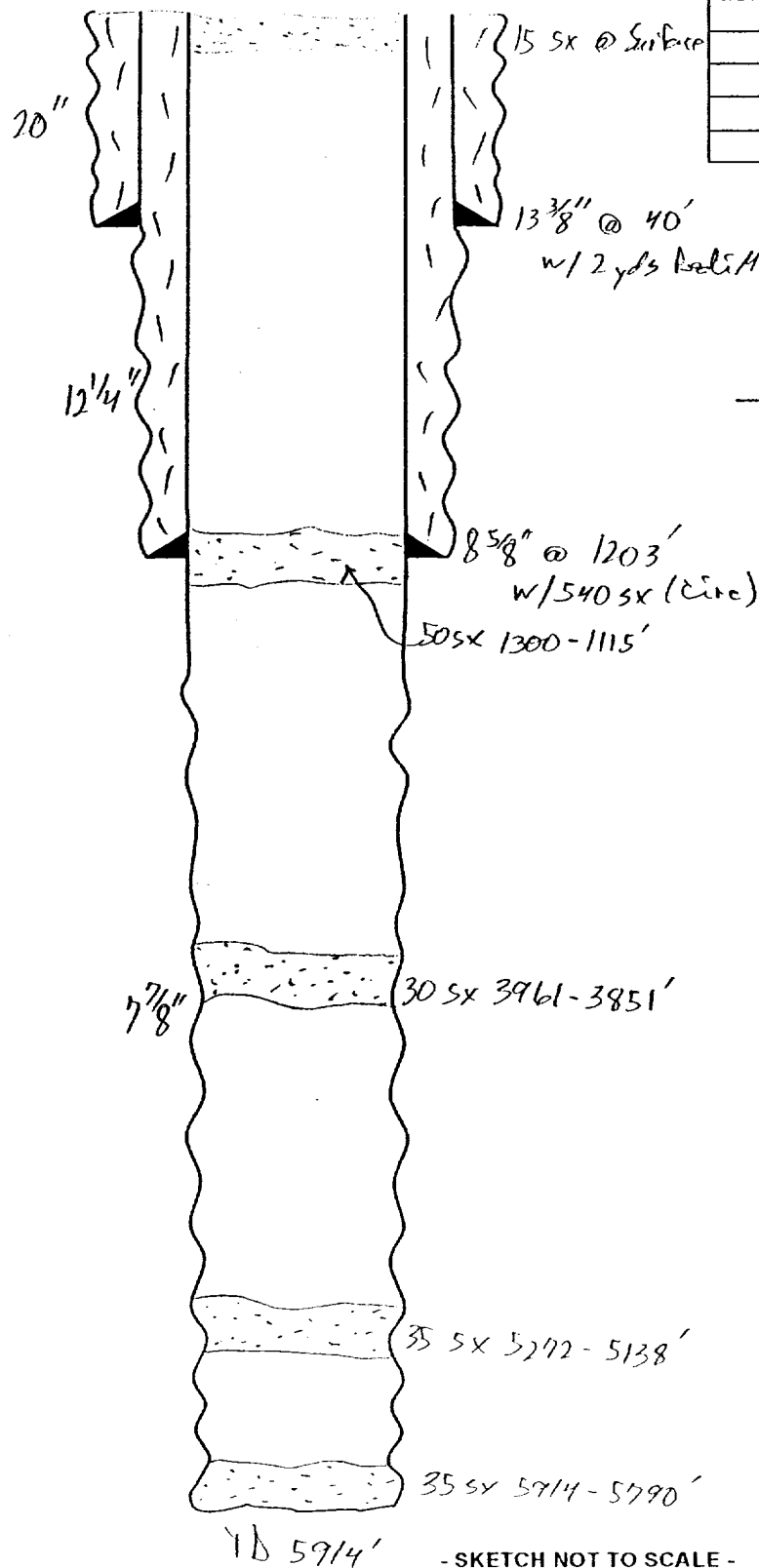

before

Tops: Yates 80'
 7Rus 160'
 Queen 300'
 San Andres 765'
 Glorieta 1870'
 Tubb 3294'
 Abo 3958'
 Wolfcamp 4660'
 Penn 5292'
 Miss 5700'
 Montoya 5806'
 Granite 5834'

- SKETCH NOT TO SCALE -

DATE: 5-31-01 SD

WELLNAME: Buried Canyon "AZN" 'tate #1 FIELD: Wildcat
 LOCATION: 2093' TSL4 - 2128' FEL 19-55-26E Chaves County
 GL: 3,758' ZERO: _____ AGL: _____ KB: 3,769.7'
 SPUD DATE: _____ COMPLETION DATE: _____
 COMMENTS: P&A 7/24/73

CASING PROGRAM	
SIZE/WT/GR/CONN	DEPTH SET
13 3/8" 48#	40'
8 5/8" 32# J-55, ST&C	1203'
5 1/2" 15.50 #14 J-55, LT&C	5,914'

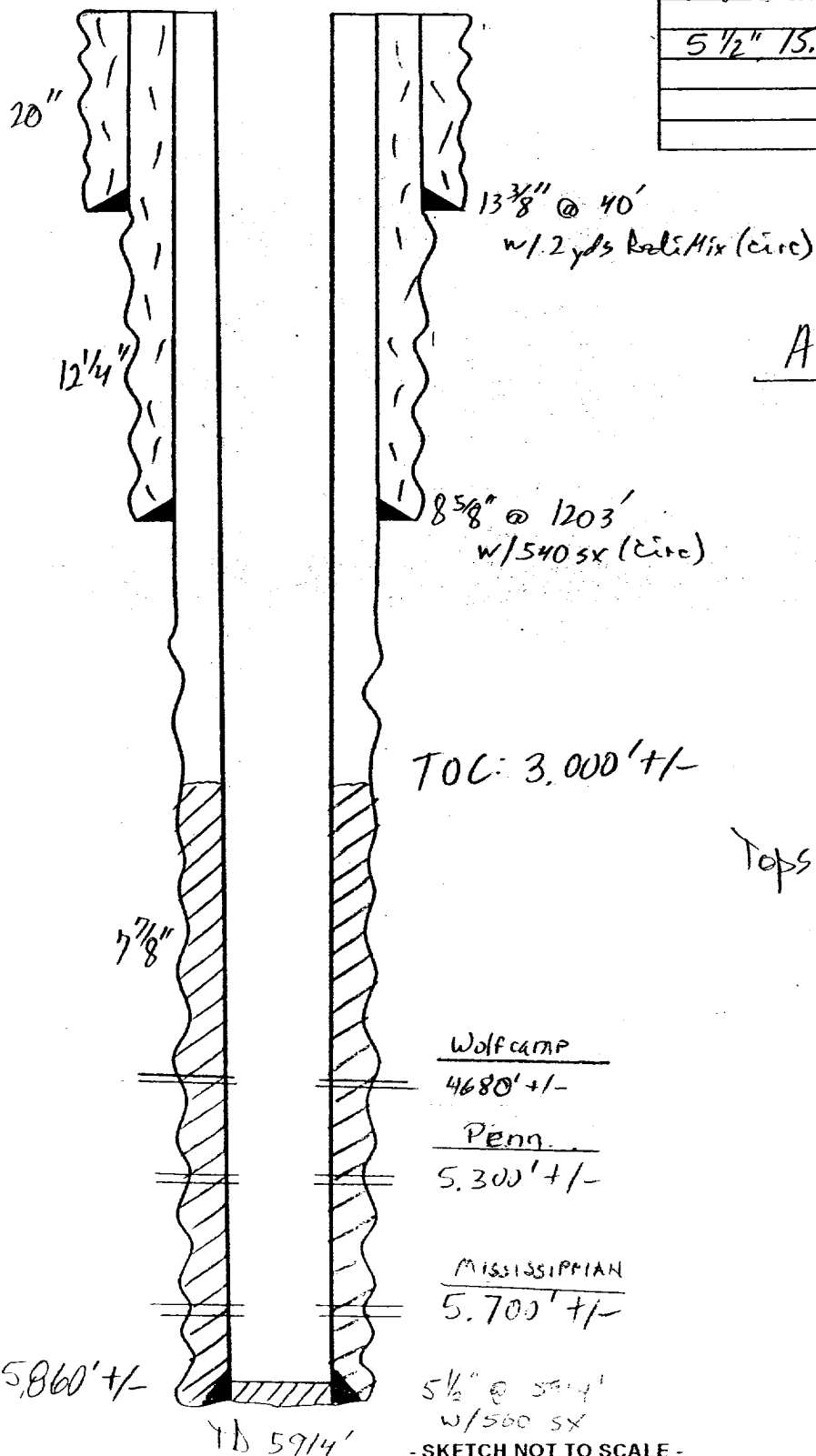

After

Tops: Yates	80'
7 Runs	160'
Queen	300'
San Andres	765'
Glorieta	1820'
Tubb	3294'
Abo	3958'
Wolfcamp	4660'
Penn	5222'
Miss	5700'
Montoya	5806'
Granite	5834'

DATE: 5-31-01 SD
6/4/01 JUP

DISTRICT I
1625 N. French Dr., Hobbs, NM 88240

DISTRICT II
811 South First, Artesia, NM 88210

DISTRICT III
1000 Rio Brazos Rd., Aztec, NM 87410

DISTRICT IV
2040 South Pacheco, Santa Fe, NM 87506

State of New Mexico
Energy, Minerals and Natural Resources Department

Form C-102
Revised March 17, 1999
Instruction on back
Submit to Appropriate District Office
State Lease - 4 Copies
Fee Lease - 3 Copies

OIL CONSERVATION DIVISION
P.O. Box 2088
Santa Fe, New Mexico 87504-2088

☐ AMENDED REPORT

WELL LOCATION AND ACREAGE DEDICATION PLAT

API Number	Pool Code	Pool Name Wildcat Mississippian
Property Code	Property Name Buried Canyon "AZN" State	Well Number 1
OCRD No. 025575	Operator Name YATES PETROLEUM CORPORATION	Elevation 3758'

Surface Location

UL or lot No.	Section	Township	Range	Lot Idn	Feet from the	North/South line	Feet from the	East/West line	County
J	19	5S	26E		2093	South	2128	East	Chaves

Bottom Hole Location If Different From Surface

UL or lot No.	Section	Township	Range	Lot Idn	Feet from the	North/South line	Feet from the	East/West line	County
Dedicated Acres 319.88	Joint or Infill	Consolidation Code	Order No.						

NO ALLOWABLE WILL BE ASSIGNED TO THIS COMPLETION UNTIL ALL INTERESTS HAVE BEEN CONSOLIDATED
OR A NON-STANDARD UNIT HAS BEEN APPROVED BY THE DIVISION

				<p>OPERATOR CERTIFICATION</p> <p><i>I hereby certify the the information contained herein is true and complete to the best of my knowledge and belief.</i></p> <p><u>Clifton R. May</u> Signature Clifton R. May Printed Name Regulatory Agent Title January 18, 2002 Date</p>
	VA-2482			<p>SURVEYOR CERTIFICATION</p> <p><i>I hereby certify that the well location shown on this plat was plotted from field notes of actual surveys made by me or under my supervision, and that the same is true and correct to the best of my belief.</i></p> <p>Refer to Original Plat</p> <p>Date Surveyed</p> <p>Signature & Seal of Professional Surveyor</p> <p>Certificate No. Herschel L. Jones RLS 3640</p> <p>GENERAL SURVEYING COMPANY</p>

New Mexico Oil Conservation Division
C-102 Instructions

IF THIS IS AN AMENDED REPORT, CHECK THE BOX LABELED
"AMENDED REPORT" AT THE TOP OF THIS DOCUMENT.

Surveyors shall use the latest United States government survey or dependent resurvey. Well locations will be in reference to the New Mexico Principal Meridian. If the land is not surveyed contact the appropriate OCD district office. Independent subdivision surveys will not be acceptable.

1. The OCD assigned API number for this well
 2. The pool code for this (proposed) completion
 3. The pool name for this (proposed) completion
 4. The property code for this (proposed) completion
 5. The property name (well name) for this (proposed) completion
 6. The well number for this (proposed) completion
 7. Operator's OGRID number
 8. The operator's name
 9. The ground level elevation of this well
 10. The surveyed surface location of this well measured from the section lines. NOTE: If the United States government survey designates a Lot Number for this location use that number in the "UL or lot no." box. Otherwise use the OCD unit letter.
 11. Proposed bottom hole location. If this is a horizontal hole indicate the location of the end of the hole.
 12. The calculated acreage dedicated to this completion to the nearest hundredth of an acre
- Put a Y if more than one completion will be sharing this same acreage or N if this is the only completion on this acreage
- If more than one lease of different ownership has been dedicated to the well show the consolidation code from the following table:
- | | |
|---|-----------------------|
| C | Communitization |
| U | Unitization |
| F | Forced pooling |
| O | Other |
| P | Consolidation pending |

ALLOWABLE WILL BE ASSIGNED TO THIS COMPLETION UNTIL
INTERESTS HAVE BEEN CONSOLIDATED OR A NON-
STANDARD UNIT HAS BEEN APPROVED BY THE DIVISION

Write in the OCD order(s) approving a non-standard
location, non-standard spacing, or directional or horizontal
drilling

16. This grid represents a standard section. You may superimpose a non-standard section over this grid. Outline the dedicated acreage and the separate leases within that dedicated acreage. Show the well surface location and bottom hole location, if it is directionally drilled, with the dimensions from the section lines in the cardinal directions. (Note: A legal location is determined from the perpendicular distance to the edge of the tract.) If this is a high angle or horizontal hole show that portion of the well bore that is open within this pool.

Show all lots, lot numbers, and their respective acreage.

If more than one lease has been dedicated to this completion, outline each one and identify the ownership as to both working interest and royalty.

17. The signature, printed name, and title of the person authorized to make this report, and the date this document was signed.
18. The registered surveyors certification. This section does not have to be completed if this form has been previously accepted by the OCD and is being filed for a change of pool or dedicated acreage.

NE EXICO OIL CONSERVATION COMMISSK
WELL LOCATION AND ACREAGE DEDICATION PLAT

Form C-102
Supersedes C-128
Effective 1-1-65

All distances must be from the outer boundaries of the Section.

Operator L. R. French, Jr.		Lease Buried Canyon State		Well No. 1
Unit Letter J	Section 19	Township 5 South	Range 26 East	County Chaves
Actual Footage Location of Well:				
2093.0 feet from the south line and		2128.0 feet from the east line		
Ground Level Elev: 3758'	Producing Formation Devonian	Pool Wildcat	Dedicated Acreage: 40 Acres	

1. Outline the acreage dedicated to the subject well by colored pencil or hachure marks on the plat below.
2. If more than one lease is dedicated to the well, outline each and identify the ownership thereof (both as to working interest and royalty).
3. If more than one lease of different ownership is dedicated to the well, have the interests of all owners been consolidated by communitization, unitization, force-pooling, etc?

☐ Yes ☐ No If answer is "yes," type of consolidation **Not applicable**

If answer is "no," list the owners and tract descriptions which have actually been consolidated. (Use reverse side of this form if necessary.)

No allowable will be assigned to the well until all interests have been consolidated (by communitization, unitization, forced-pooling, or otherwise) or until a non-standard unit, eliminating such interests, has been approved by the Commission.

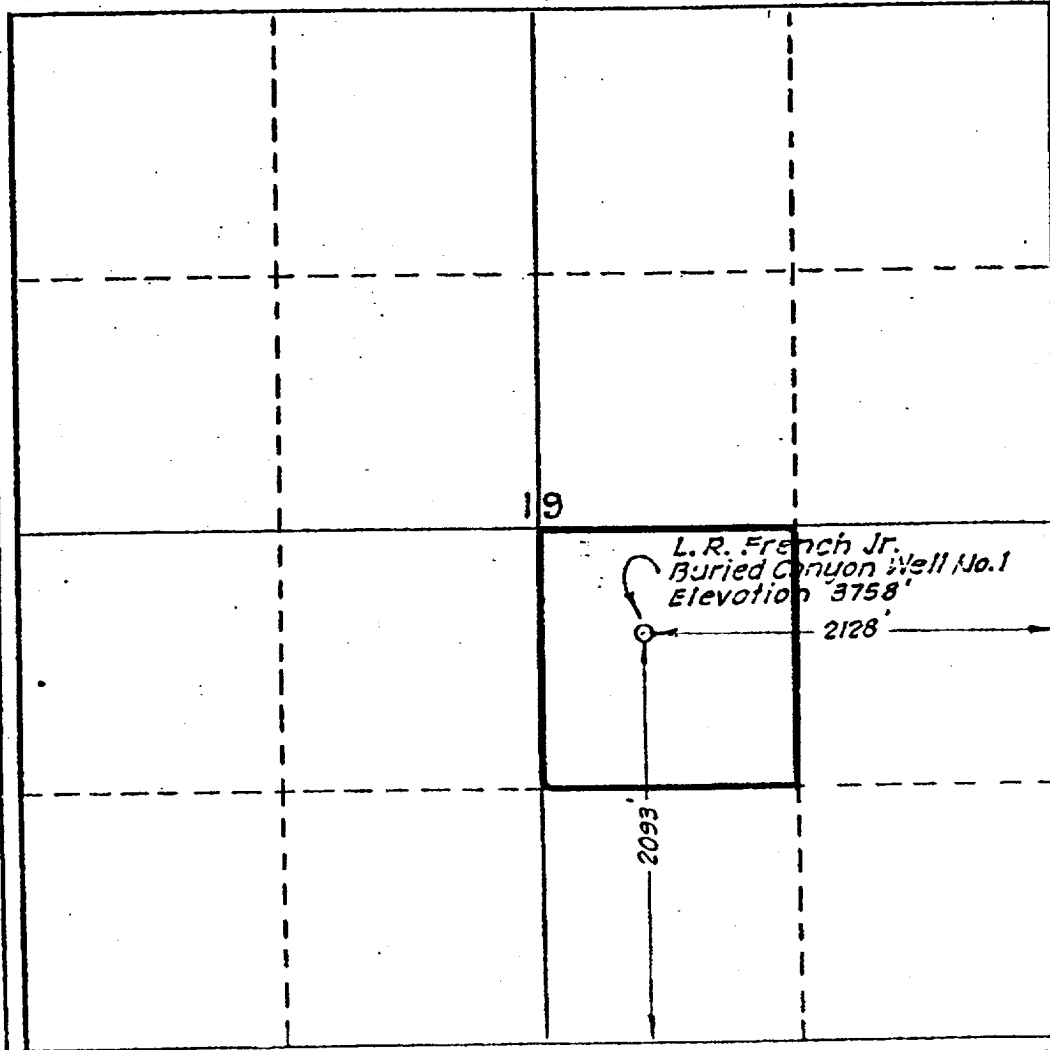

CERTIFICATION

I hereby certify that the information contained herein is true and complete to the best of my knowledge and belief.

David H. Donaldson

Name

David H. Donaldson

Position

Engineer

Company

L. R. FRENCH, JR.

Date

6-6-73

I hereby certify that the well location shown on this plat was plotted from field notes of actual surveys made by me or under my supervision, and that the same is true and correct to the best of my knowledge and belief.

June 4, 1973

Date Surveyed

Registered Professional Engineer and/or Land Surveyor

SW Howell

Certificate No.

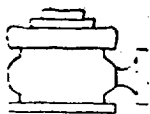

Yates Petroleum Corporation

BOP-3

Typical 3,000 psi Pressure System Schematic Annular with Double Ram Preventer Stack

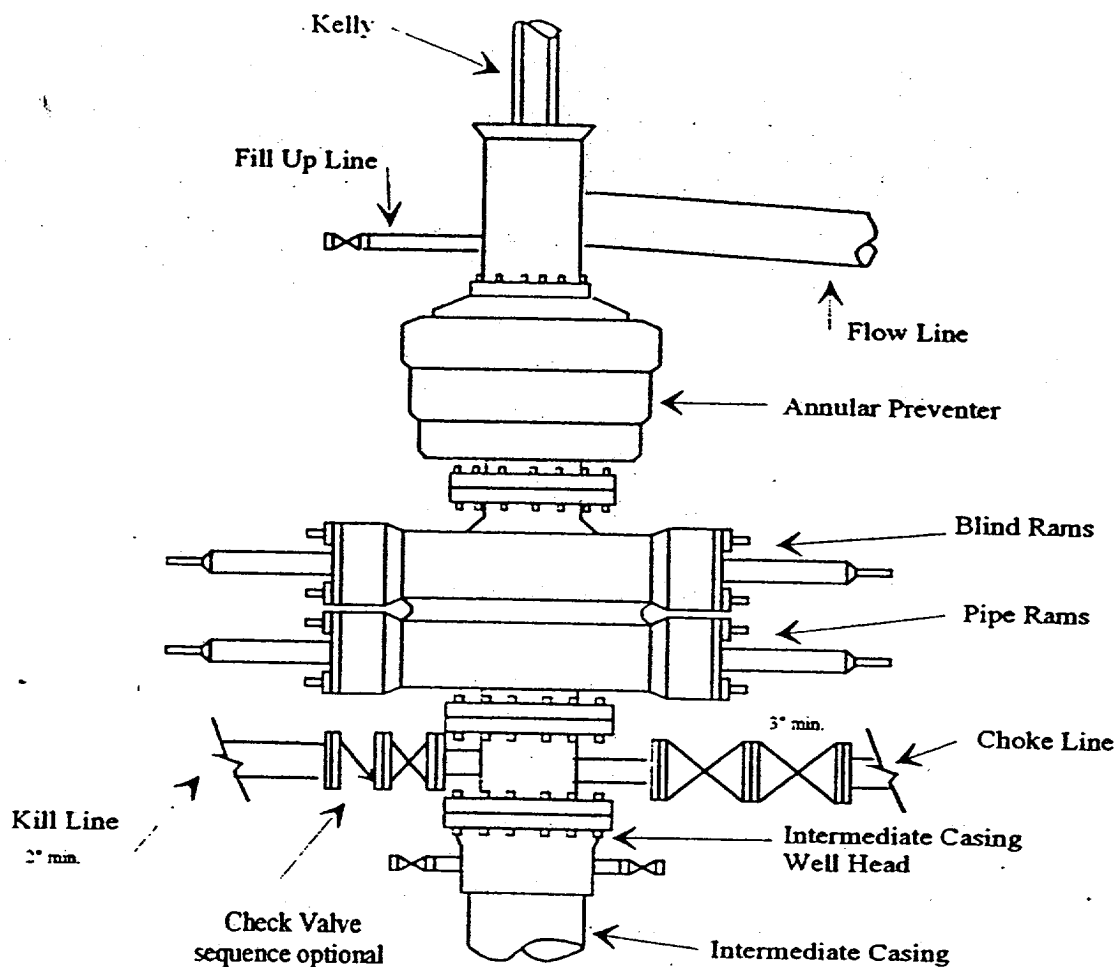

Typical 3,000 psi choke manifold assembly with at least these minimum features

