

N. M. O. C. G. COPY
UNITED STATES
DEPARTMENT OF THE INTERIOR
GEOLOGICAL SURVEY

SUBMIT IN TRIPLICATE*
(Other instructions on
reverse side)

Form approved.
Budget Bureau No. 42-R1425.

30-105-20060276

APPLICATION FOR PERMIT TO DRILL, DEEPEN, OR PLUG BACK

1a. TYPE OF WORK
DRILL ☒ DEEPEN ☐ PLUG BACK ☐

b. TYPE OF WELL
OIL WELL ☒ GAS WELL ☐ OTHER ☐ SINGLE ZONE ☐ MULTIPLE ZONE ☐

2. NAME OF OPERATOR
McCLELLAN OIL CORPORATION

3. ADDRESS OF OPERATOR
P. O. Box 848, ROSWELL, NEW MEXICO 88201

4. LOCATION OF WELL (Report location clearly and in accordance with any State requirements.)
At surface 1980 FWL & 660 FNL
At proposed prod. zone

14. DISTANCE IN MILES AND DIRECTION FROM NEAREST TOWN OR POST OFFICE*
25 MILES N. LOCO HILLS

15. DISTANCE FROM PROPOSED* LOCATION TO NEAREST PROPERTY OR LEASE LINE, FT. (Also to nearest drlg. unit line, if any) 660'

18. DISTANCE FROM PROPOSED LOCATION* TO NEAREST WELL, DRILLING COMPLETED, OR APPLIED FOR, ON THIS LEASE, FT.

21. ELEVATIONS (Show whether DF, RT, GR, etc.)

5. LEASE DESIGNATION AND SERIAL NO.

NM 2824

6. IF INDIAN, ALLOTTEE OR TRIBE NAME

7. UNIT AGREEMENT NAME

NORTH KING CAMP UNIT

8. FARM OR LEASE NAME

9. WELL NO.

9

10. FIELD AND POOL, OR WILDCAT

WILDCAT

11. SEC., T., R., M., OR BLK. AND SURVEY OR AREA

Sec. 27, T13S, R29E

12. COUNTY OR PARISH 13. STATE

CHAVES NEW MEXICO

16. NO. OF ACRES IN LEASE

1200

17. NO. OF ACRES ASSIGNED

40

19. PROPOSED DEPTH

1800'

20. ROTARY OR CABLE TOOLS

CABLE TOOL

22. APPROX. DATE WORK WILL START*

Aug 25, 1973

23. PROPOSED CASING AND CEMENTING PROGRAM

SIZE OF HOLE	SIZE OF CASING	WEIGHT PER FOOT	SETTING DEPTH	QUANTITY OF CEMENT
10 1/4"	8-5/8"	20 LB.	350'	100 SX. CIRC.
8"	4 1/2"	9 1/2 LB.	1800'	150 SX.

PROPOSED TO DRILL QUEEN SAND TEST. IF PRODUCTION IS INDICATED
WILL RUN CASING AND ATTEMPT COMPLETION.
CORTEZ DRILLING COMPANY ROSWELL, NEW MEXICO WILL BE THE
DRILLING CONTRACTOR.

RECEIVED
AUG 21 1973
U. S. GEOLOGICAL SURVEY
ARTESIA, NEW MEXICO

RECEIVED
MAY 11 1973
U. S. GEOLOGICAL SURVEY
ARTESIA, NEW MEXICO

IN ABOVE SPACE DESCRIBE PROPOSED PROGRAM: If proposal is to deepen or plug back, give data on present productive zone and proposed new productive zone. If proposal is to drill or deepen directionally, give pertinent data on subsurface locations and measured and true-vertical depths. Give blowout preventer program, if any.

24. SIGNED Joe L. McClellan TITLE PRESIDENT DATE 8/20/73

(This space for Federal or State office use)

APPROVED BY Joe L. McClellan TITLE DISTRICT ENGINEER DATE AUG 28 1973

CONDITIONS OF APPROVAL, IF ANY:

*See Instructions On Reverse Side

**NEW MEXICO OIL CONSERVATION COMMISSION
WELL LOCATION AND ACREAGE DEDICATION PLAT**

Form O-112
Supersedes O-112R
Effective 1-1-65

All distances must be from the outer boundaries of the Section

Operator MCCLELLAN OIL CORPORATION			Lease NORTH KING CAMP		Well No. 9
Well Letter C	Section 27	Township 13 SOUTH	Range 29 EAST	County CHAVES	
Actual Footage Location of Well: 1980 feet from the WEST 660 feet from the NORTH					
Ground Level Elev. 3791.7	Producing Formation QUEEN SANDS		Pool WILDCAT	Dedicated Acreage NE 1/4 NW 1/4 40	

1. Outline the acreage dedicated to the subject well by colored pencil or hachure marks on the plat below.
2. If more than one lease is dedicated to the well, outline each and identify the ownership thereof (both as to working interest and royalty).
3. If more than one lease of different ownership is dedicated to the well, have the interests of all owners been consolidated by communitization, unitization, force-pooling, etc?

☐ Yes ☐ No If answer is "yes," type of consolidation _____

If answer is "no," list the owners and tract descriptions which have actually been consolidated. (Use reverse side of this form if necessary.) _____

No allowable will be assigned to the well until all interests have been consolidated (by communitization, unitization, forced-pooling, or otherwise) or until a non-standard unit, eliminating such interests, has been approved by the Commission.

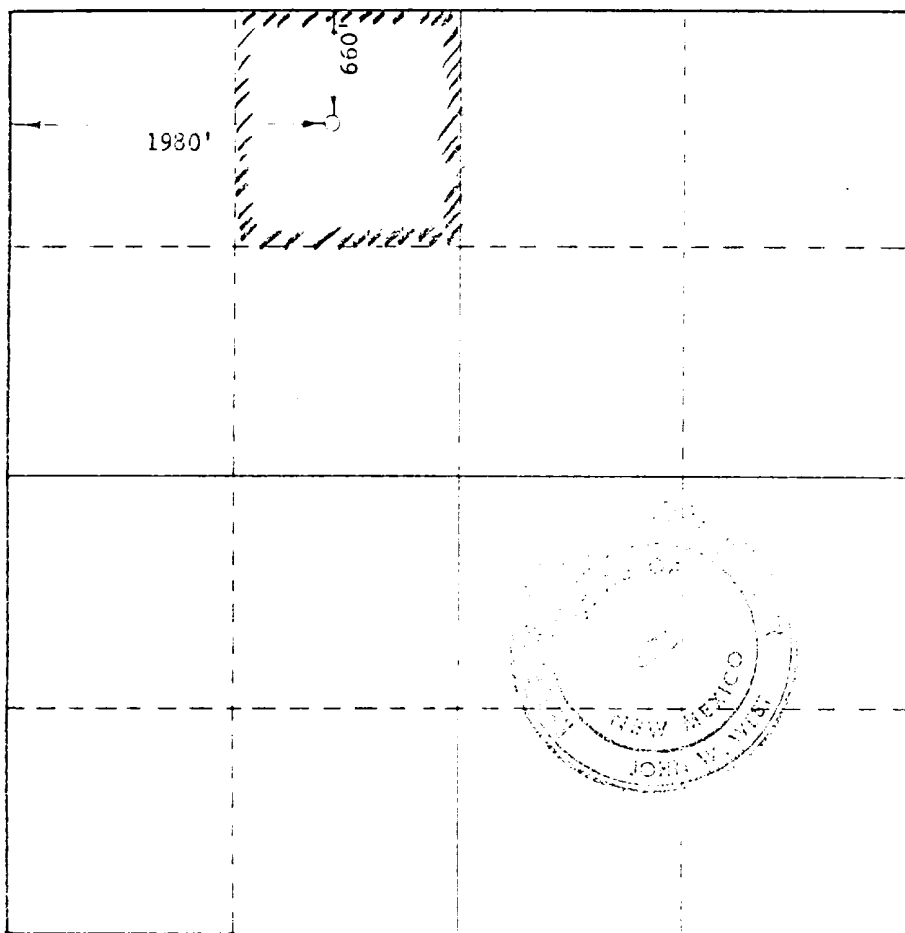

RECEIVED

I hereby certify that the information contained herein is true and complete to the best of my knowledge and belief.
AUG 21 1973
U.S. GEOLOGICAL SURVEY
ARTESIA, NEW MEXICO

By *John W. West*
AGENT

For
MCCLELLAN OIL COMPANY

Date
MAY 10, 1973

I hereby certify that the well location shown on this plat is in the field notes of a survey made by me or under my supervision, and the same is true to the best of my knowledge and belief.
MAY 14 1973
U.S. GEOLOGICAL SURVEY
ARTESIA, NEW MEXICO

Date Received
MAY 10, 1973

Registered Professional Landman and Oil and Gas Surveyor
John W. West
Certification No. **676**

JME

5. COPY
 MCCLELLAN OIL CORPORATION
 Box 849
 ROSWELL, NEW MEXICO 88201

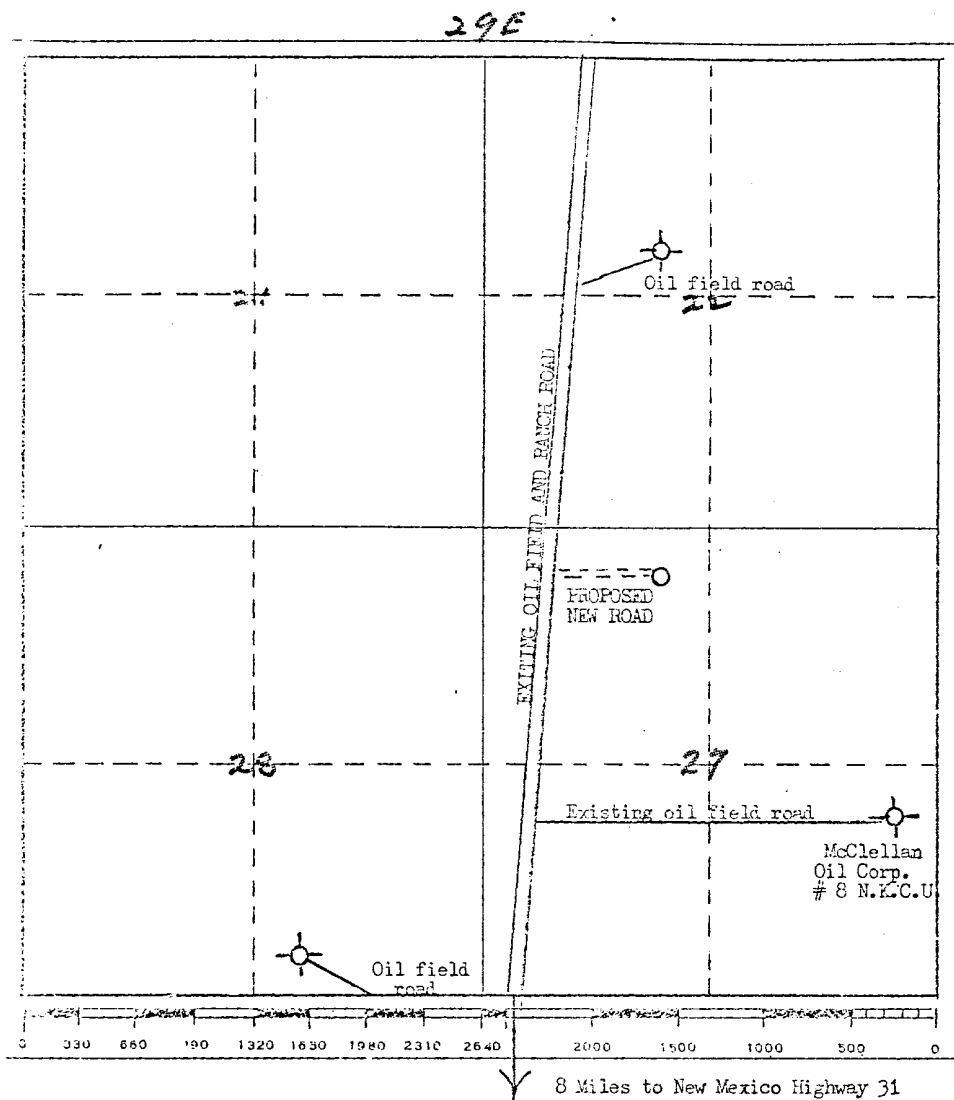

13S

Propose to use exiting roads, oilfield and ranch, and to construct approximately 900' of new road to location. No water exists in this area and will have to be trucked in to location. Combustable material will be burned, noncombustible material will be buried with pit filling.

After completion or abandonment, the pit will be filled, the location cleaned, and the area restored, as much as possible, to it's original state.

RECEIVED
 AUG 21 1973
 U. S. GEOLOGICAL SURVEY
 ARTESIA, NEW MEXICO

RECEIVED
 MAY 11 1973
 U. S. GEOLOGICAL SURVEY
 ARTESIA, NEW MEXICO

