

NO. OF COPIES RECEIVED	
DISTRIBUTION	
SANTA FE	
FILE	<input checked="" type="checkbox"/>
U.S.G.S.	
LAND OFFICE	
OPERATOR	

NEW MEXICO OIL CONSERVATION COMMISSION

RECEIVED

30-005-60308

Form C-101
Revised 1-1-65

JUN 3 1974

O. C. C.

ARTESIA OFFICE

APPLICATION FOR PERMIT TO DRILL, DEEPEN, OR PLUG BACK

1a. Type of Work DRILL <input checked="" type="checkbox"/> DEEPEN <input type="checkbox"/> PLUG BACK <input type="checkbox"/>		5A. Indicate Type of Lease STATE <input checked="" type="checkbox"/> FEE <input type="checkbox"/>
b. Type of Well OIL WELL <input type="checkbox"/> GAS WELL <input checked="" type="checkbox"/> OTHER <input type="checkbox"/> SINGLE ZONE <input checked="" type="checkbox"/> MULTIPLE ZONE <input type="checkbox"/>		5. State Oil & Gas Lease No. L-95
2. Name of Operator Fossil Fuel Company		7. Unit Agreement Name
3. Address of Operator c/o Oil Reports & Gas Services, Inc., Box 763, Hobbs, N.M. 88240		8. Farm or Lease Name Cappetro State #8
4. Location of Well UNIT LETTER A LOCATED 660 FEET FROM THE North LINE AND 666 FEET FROM THE East LINE OF SEC. 28 TWP. 14S RGE. 28E NMPM		9. Well No. 1
		10. Field and Pool, or Wildcat Sam's Ranch
		12. County Chaves
		19. Proposed Depth 2000
		19A. Formation San Andres
		20. Rotary or C.T. Comb.
21. Elevations (Show whether DF, RT, etc.) 3568 GR	21A. Kind & Status Plug. Bond One Well Bond	21B. Drilling Contractor Carol Reed
		22. Approx. Date Work will start 6/1/74

23.

PROPOSED CASING AND CEMENT PROGRAM

SIZE OF HOLE	SIZE OF CASING	WEIGHT PER FOOT	SETTING DEPTH	SACKS OF CEMENT	EST. TOP
12 1/4	8 5/8	24#	250	100	Circ
7 7/8	4 1/2	11.5#	2000	300	1000

APPROVAL VALID
FOR 90 DAYS UNLESS
DRILLING COMMENCED,

EXPIRES **6-4-74**

IN ABOVE SPACE DESCRIBE PROPOSED PROGRAM: IF PROPOSAL IS TO DEEPEN OR PLUG BACK, GIVE DATA ON PRESENT PRODUCTIVE ZONE AND PROPOSED NEW PRODUCTIVE ZONE. GIVE BLOWOUT PREVENTER PROGRAM, IF ANY.

I hereby certify that the information above is true and complete to the best of my knowledge and belief.

Signed *W. A. Gessett* Title Agent Date 5/29/74

(This space for State Use)

APPROVED BY *W. A. Gessett* TITLE OIL AND GAS INSPECTOR DATE JUN 4 1974

CONDITIONS OF APPROVAL, IF ANY:

N MEXICO OIL CONSERVATION COMMISSION
WELL LOCATION AND ACREAGE DEDICATION PLAT

Form O-112
 Supersedes O-128
 Effective 1-1-65

All distances must be from the outer boundaries of the Section

Operator FOSSIL FUEL COMPANY			Section 28		Twp 14 SOUTH		Range 28 EAST		County CHAVES		
Unit Letter A			Section 28		Twp 14 SOUTH		Range 28 EAST		County CHAVES		
Actual Surface Location of Well:											
660			feet from the			NORTH			660		
									feet from the		
									EAST		
Ground Level Elev 3568			Producing Formation San Andres			Well Location Sam's Ranch			Section 160		

1. Outline the acreage dedicated to the subject well by colored pencil or hatchure marks on the plat below
2. If more than one lease is dedicated to the well, outline each and identify the ownership thereof (both as to working interest and royalty)
3. If more than one lease of different ownership is dedicated to the well, have the interests of all owners been consolidated by communitization, unitization, force-pooling, etc?

RECEIVED

JUN 3 1974

☐ Yes ☐ No If answer is "yes," type of consolidation _____ **O.C.C.**
ARTESIA, OFFICE

If answer is "no," list the owners and tract descriptions which have actually been consolidated (if so reverse side of this form if necessary.) _____

No allowable will be assigned to the well until all interests have been consolidated (by communitization, unitization, forced-pooling, or otherwise) or until a non-standard unit, eliminating such interests, has been approved by the Commission.

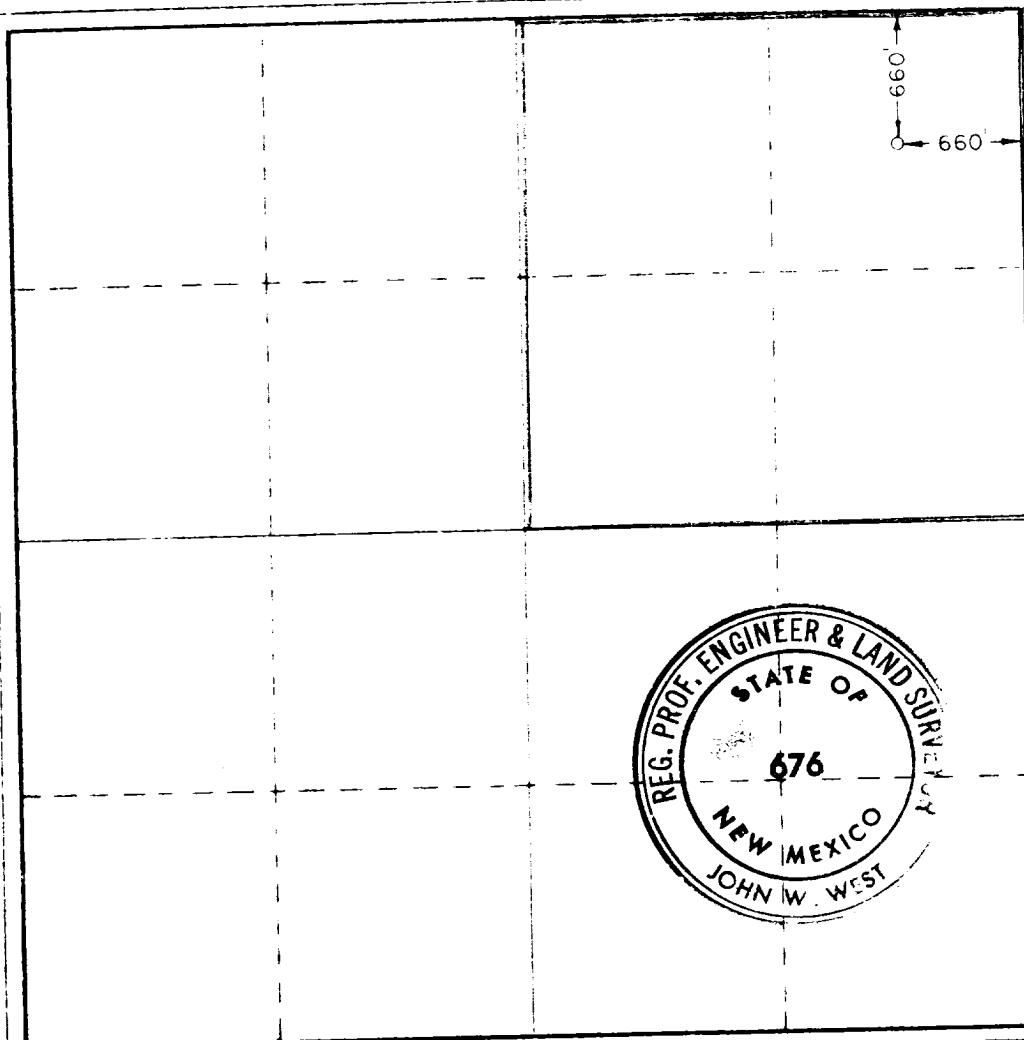

CERTIFICATION

I hereby certify that the information contained herein is true and complete to the best of my knowledge and belief.

Donna Keller
 Agent

Agent

Fossil Fuel Co.

May 29, 1974

I hereby certify that the well location shown on this plat was plotted from field notes of actual surveys made by me or under my supervision, and that the same is true and correct to the best of my knowledge and belief.

Date Surveyed
5-25-1974

Registered Professional Engineer
 and Land Surveyor

Certificate No.

676

John W. West