

UNITED STATES
DEPARTMENT OF THE INTERIOR
GEOLOGICAL SURVEY

APPLICATION FOR PERMIT TO DRILL, DEEPEN, OR PLUG BACK

1a. TYPE OF WORK

DRILL ☒

DEEPEN ☐

PLUG BACK ☐

b. TYPE OF WELL

OIL WELL ☒

GAS WELL ☐

OTHER

SINGLE ZONE ☒

MULTIPLE ZONE ☐

2. NAME OF OPERATOR

Franklin, Aston & Fair, Inc.

3. ADDRESS OF OPERATOR

P. O. Box 1090, Roswell, New Mexico 88201

4. LOCATION OF WELL (Report location clearly and in accordance with any State requirements.)

At surface 660' FSL & 660' FEL, Section 35-13S-29E

At proposed prod. zone

14. DISTANCE IN MILES AND DIRECTION FROM NEAREST TOWN OR POST OFFICE*

19 miles East of Hagerman

15. DISTANCE FROM PROPOSED*

LOCATION TO NEAREST PROPERTY OR LEASE LINE, FT.
(Also to nearest drlg. unit line, if any)

18. DISTANCE FROM PROPOSED LOCATION* TO NEAREST WELL, DRILLING, COMPLETED, OR APPLIED FOR, ON THIS LEASE, FT.

21. ELEVATIONS (Show whether DF, RT, GR, etc.)

3742 GR

23.

PROPOSED CASING AND CEMENTING PROGRAM

SIZE OF HOLE	SIZE OF CASING	WEIGHT PER FOOT	SETTING DEPTH	QUANTITY OF CEMENT
12 1/4	13 3/8	48#	275'	
7 7/8	8 5/8	24#	2,350' *	2,000 sacks cement
	5 1/2	17#	10,500'	300 sacks cement

One or about September 21, 1974, we plan to begin this well. 13 3/8" casing will be set at 300'. A 12 1/4 inch hole will be drilled to 2,350 feet or to the top of the San Andres formation. 8 5/8 inch 24# casing will be set in the top of the San Andres and cement circulated to surface. A 7 7/8 inch hole will be drilled to 10,500 feet or sufficient to test the Devonian formation. If production is indicated 5 1/2 inch casing will be run and cemented for completion attempt.

RECEIVED
AUG 26 1974
U. S. GEOLOGICAL SURVEY
ARTESIA, NEW MEXICO

IN ABOVE SPACE DESCRIBE PROPOSED PROGRAM: If proposal is to deepen or plug back, give data on present productive zone and proposed new productive zone. If proposal is to drill or deepen directionally, give pertinent data on subsurface locations and measured and true vertical depths. Give blowout preventer program, if any.

24.

SIGNED

Grant M. Smith

TITLE Geologist

DATE August 23, 1974

(This space for Federal or State office use)

SUBJECT TO ATTACHED DEEP WELL CONTROL

REQUIREMENTS DATED JUN 22 1973

APPROVED BY

CONDITIONS OF APPROVAL, IF ANY:

L. BECKWITH
ACTING DISTRICT ENGINEER

TITLE

DATE 2500'

THIS APPROVAL IS RESCINDED IF OPERATIONS ARE NOT COMMENCED WITHIN 3 MONTHS.
EXPIRES DEC 11 1974 *See Instructions On Reverse Side

Subject to 2500' 8 5/8" log

NEW MEXICO OIL CONSERVATION COMMISSION
WELL LOCATION AND ACREAGE DEDICATION PLAT

Form O-10
Supersedes O-10b
Effective 1-1-66

All distances must be from the outer boundaries of the Section

Franklin Aston & Fair Inc.				Lease NORTH KING CAMP UNIT		Well No. 11
Section P	Section 35	Township 13 SOUTH	Range 29 EAST	County CHAVES		

Actual Well Location of Well:

660 feet from the SOUTH line and 660 feet from the EAST	Producing Formation <i>Permian</i>	Pool <i>WC</i>	Dedicated Acreage 40
Ground S. Pre. Elev. 3742.6			

- Outline the acreage dedicated to the subject well by colored pencil or hatchure marks on the plat below.
- If more than one lease is dedicated to the well, outline each and identify the ownership thereof (both as to working interest and royalty).
- If more than one lease of different ownership is dedicated to the well, have the interests of all owners been consolidated by communitization, unitization, force-pooling, etc?

☐ Yes ☐ No If answer is "yes," type of consolidation _____

If answer is "no," list the owners and tract descriptions which have actually been consolidated. (Use reverse side of this form if necessary.) _____

No allowable will be assigned to the well until all interests have been consolidated (by communitization, unitization, forced-pooling, or otherwise) or until a non-standard unit, eliminating such interests, has been approved by the Commission.

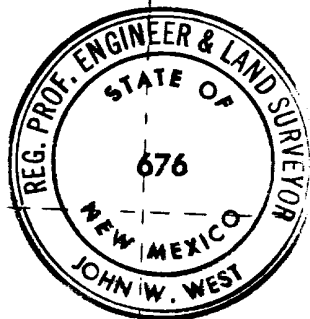

CERTIFICATION

I hereby certify that the information contained herein is true and complete to the best of my knowledge and belief.

Name *Grant M. Smith*
Position
Geologist

Company
Franklin, Aston & Fair, Inc.

Date
August 23, 1974

I hereby certify that the well location shown on this plat was located in the field notes of actual surveys made by me under my supervision and that the same is true and correct to the best of my knowledge and belief.

RECEIVED
AUG 28 1974
U.S. GEOLOGICAL SURVEY
ARTESIA, NEW MEXICO

Date Surveyed
AUGUST 20, 1974

Registered Professional Engineer and/or Land Surveyor

John W. West
Certificate No.

676

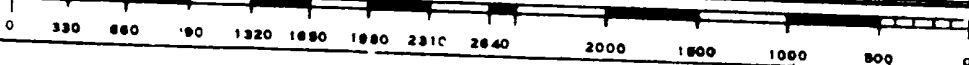
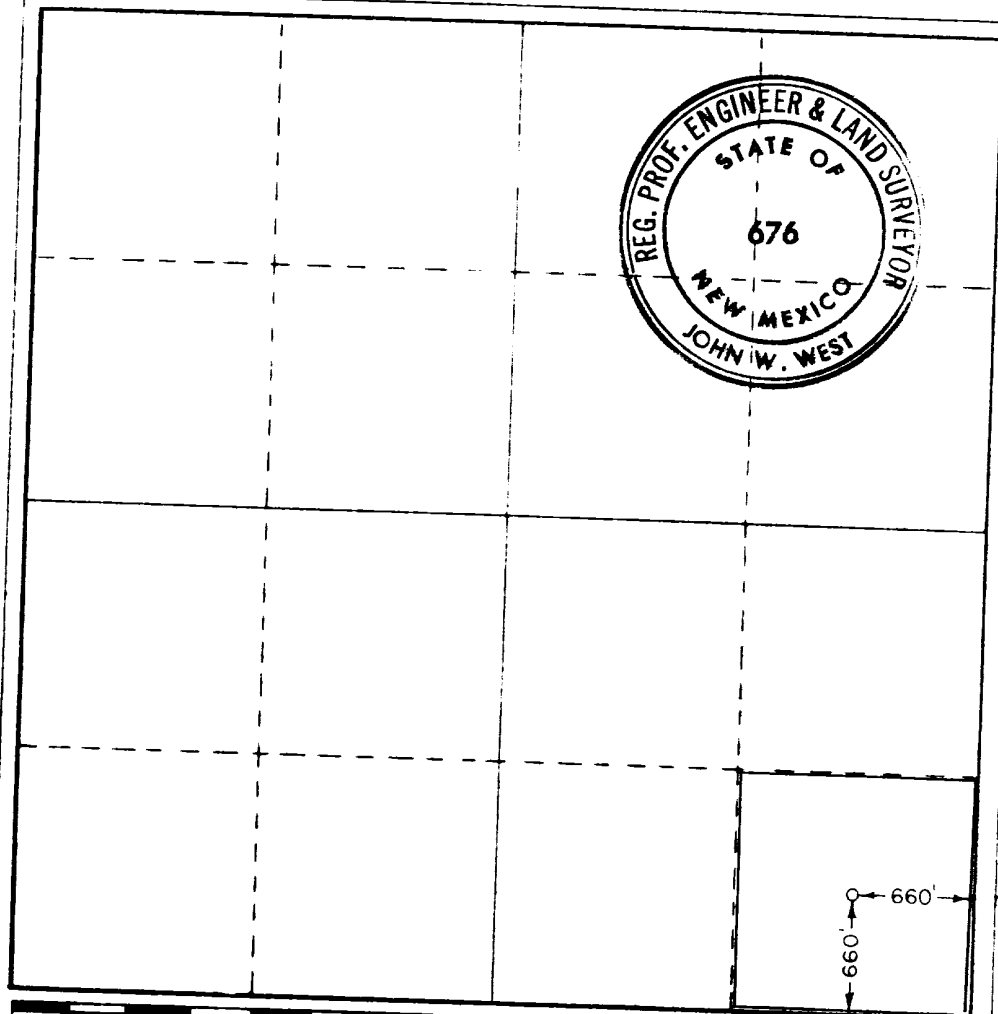

Points 6-12 of 12-Point Plan

Development Plan

Franklin, Aston & Fair, Inc.

North King Camp Unit #11

660' FSL & 660' FEL

Section 35-13S-29E

Chaves County, New Mexico

Topography includes sand dunes
with desert type vegetation.

Improvements are lease roads.

Highways and black top roads.

Waste material from rig will be
buried in slush pit.

No camp will be built.

Produced salt water will be dis-
posed of according to State
requirements.

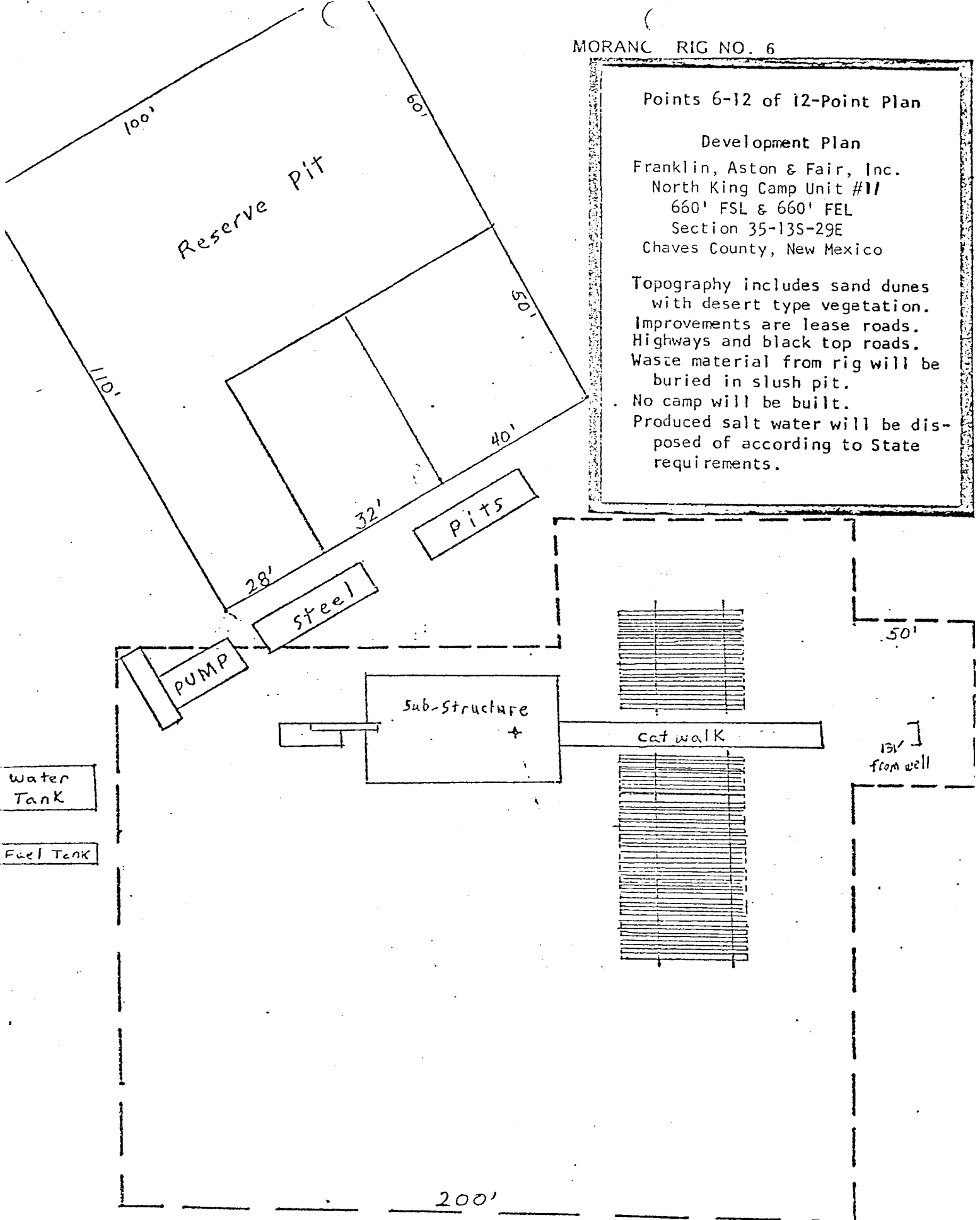

MODEL "F"
CAMERON

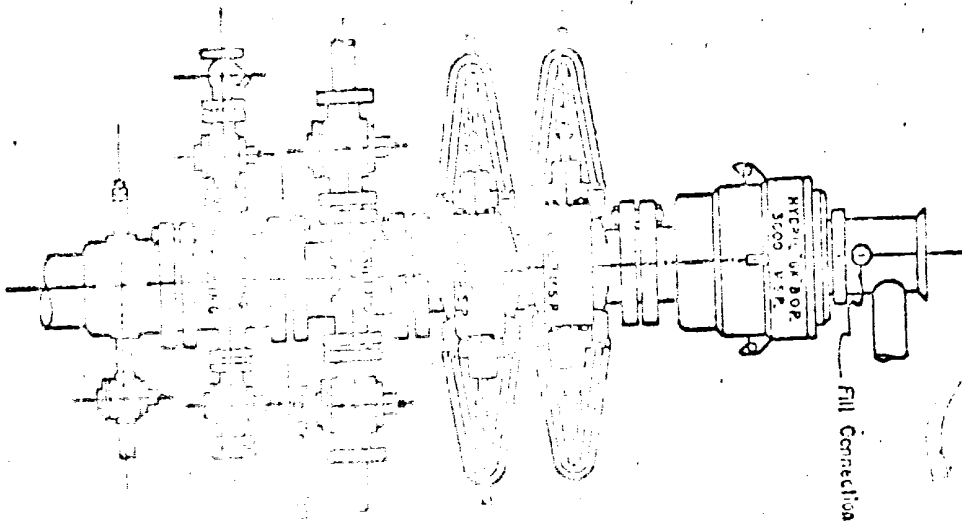

3,000 PSI WORKING PRESSURE
BLOWOUT PREVENTER HOOD - UP

Series 900 Flanges, or Better

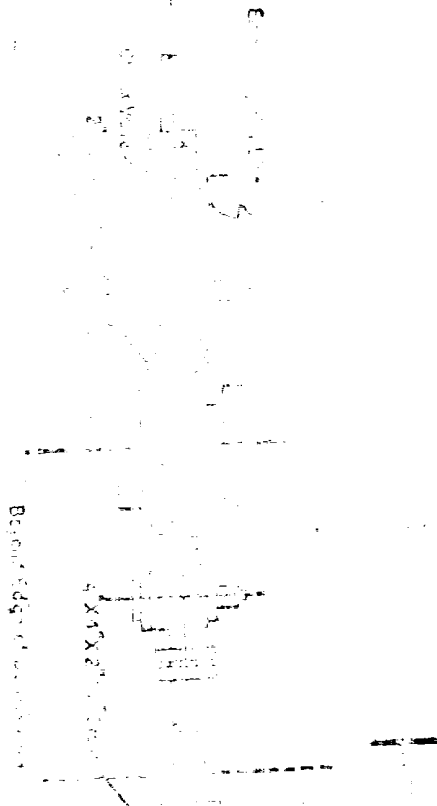

Points 1-5 of 12-Point Plan
Development Plan for Surface Use
Application for Permit to Drill

Franklin, Aston & Fair, Inc.
North King Camp Unit #1/
660' FSL & 660' FEL
Section 35-13S-29E
Chaves County, New Mexico

TANK BATTERY WILL BE AT WELL SITE

Existing roads are black top or compacted
caliche, no new roads are planned
except as shown in red.

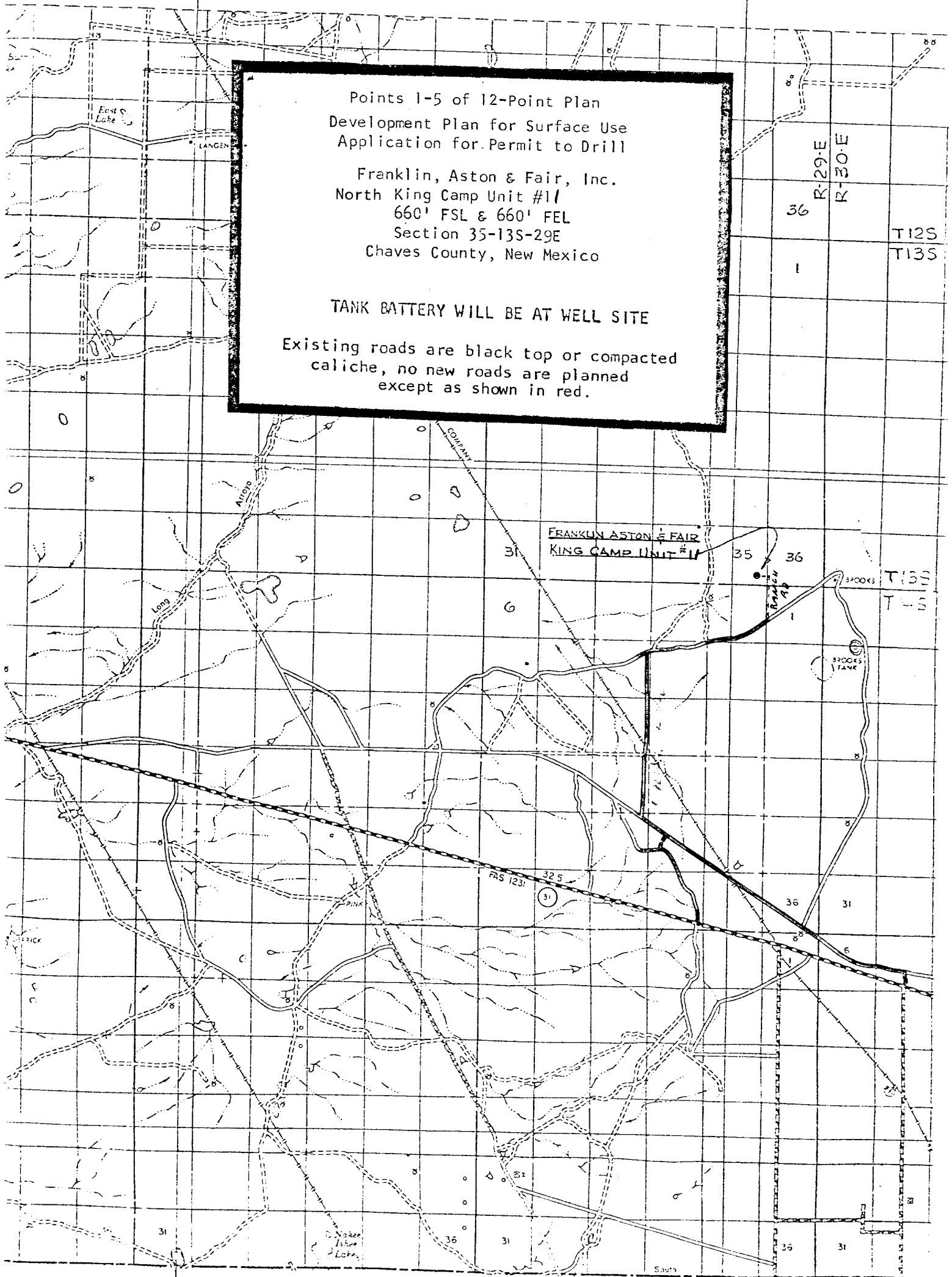

R.28 E.

R.29 E.