

UNITED STATES
DEPARTMENT OF THE INTERIOR

GEOLOGICAL SURVEY

APPLICATION FOR PERMIT TO DRILL, DEEPEN, OR PLUG BACK

1a. TYPE OF WORK DRILL <input checked="" type="checkbox"/> DEEPEN <input type="checkbox"/> PLUG BACK <input type="checkbox"/>		5. LEASE DESIGNATION AND SERIAL NO. NM 0402600-A	
b. TYPE OF WELL OIL WELL <input checked="" type="checkbox"/> GAS WELL <input type="checkbox"/> OTHER <input type="checkbox"/>		6. IF INDIAN, ALLOTTEE OR TRIBE NAME	
2. NAME OF OPERATOR McClellan Oil Corporation		7. UNIT AGREEMENT NAME	
3. ADDRESS OF OPERATOR Post Office Box 848, Roswell, New Mexico 88201		8. FARM OR LEASE NAME Butter Springs Federal	
4. LOCATION OF WELL (Report location clearly and in accordance with any State regulations.) At surface 330' FNL & 990' FEL		9. WELL NO. 2	
14. DISTANCE IN MILES AND DIRECTION FROM NEAREST TOWN OR POST OFFICE* 17 miles East of Hagerman		10. FIELD AND POOL, OR WILDCAT Wildcat	
15. DISTANCE FROM PROPOSED* LOCATION TO NEAREST PROPERTY OR LEASE LINE, FT. (Also to nearest drlg. unit line, if any)		11. SEC., T., R., M., OR BLK. AND SURVEY OR AREA Sec. 23-T14S-R28E	
16. NO. OF ACRES ASSIGNED TO THIS WELL 40		12. COUNTY OR PARISH Chaves	
17. PROPOSED DEPTH 1950		13. STATE N. M.	
18. DISTANCE FROM PROPOSED LOCATION* TO NEAREST WELL, DRILLING, COMPLETED, OR APPLIED FOR, ON THIS LEASE, FT.		20. ROTARY OR CABLE TOOLS Cable Tools	
21. ELEVATIONS (Show whether DF, RT, GR, etc.) 3618.8' GR		22. APPROX. DATE WORK WILL START* May 22, 1975	

PROPOSED CASING AND CEMENTING PROGRAM

SIZE OF HOLE	SIZE OF CASING	WEIGHT PER FOOT	SETTING DEPTH	QUANTITY OF CEMENT
10 1/2"	8-5/8"	20#	350'	*Set
8"	4-1/2"	9 1/2#	1950'	100 sx

Will drill to approximately 1950' to test the Premier Sd. If production is indicated, will set casing and attempt completion.

Cortez Drilling Company will be the Contractor.

RECEIVED

MAY 20 1975

U. S. GEOLOGICAL SURVEY
ARTESIA, NEW MEXICO

IN ABOVE SPACE DESCRIBE PROPOSED PROGRAM: If proposal is to deepen or plug back, give data on present productive zone and proposed new productive zone. If proposal is to drill or deepen directionally, give pertinent data on subsurface locations and measured and true vertical depths. Give blowout prevention program, if any.

24. SIGNED James L. McClellan TITLE President DATE 5/19/75

(This space for Federal or State office use)

PERMIT NO. _____ APPROVAL DATE _____

TITLE _____ DATE _____

APPROVED
MAY 20 1975
H. L. BEEKWOLD
ACTING DISTRICT ENGINEER

*See Instructions On Reverse Side

NEW MEXICO OIL CONSERVATION COMMISSION
WELL LOCATION AND ACREAGE DEDICATION PLAT

Form C-102
Supersedes C-128
Effective 1-1-65

All distances must be from the outer boundaries of the Section

Operator McCELLAN OIL CORPORATION			Lease Butter Springs Federal		Well No. 2
Section A	Section 23	Township 14 South	Range 28 East	County Chaves	
Actual Well Location of Well: 990 feet from the east line and 330 feet from the north line					
Ground Level Elev. 3618.8	Producing Formation Premier Sand	For Lease or Dedication to the Public Wildcat		Dedicated Acreage: 40 Acres	

1. Outline the acreage dedicated to the subject well by colored pencil or hachure marks on the plat below.
2. If more than one lease is dedicated to the well, outline each and identify the ownership thereof (both as to working interest and royalty).
3. If more than one lease of different ownership is dedicated to the well, have the interests of all owners been consolidated by communitization, unitization, force-pooling, etc?

☐ Yes ☐ No If answer is "yes," type of consolidation _____

If answer is "no," list the owners and tract descriptions which have actually been consolidated. (Use reverse side of this form if necessary.) _____

No allowable will be assigned to the well until all interests have been consolidated (by communitization, unitization, forced-pooling, or otherwise) or until a non-standard unit, eliminating such interests, has been approved by the Commission.

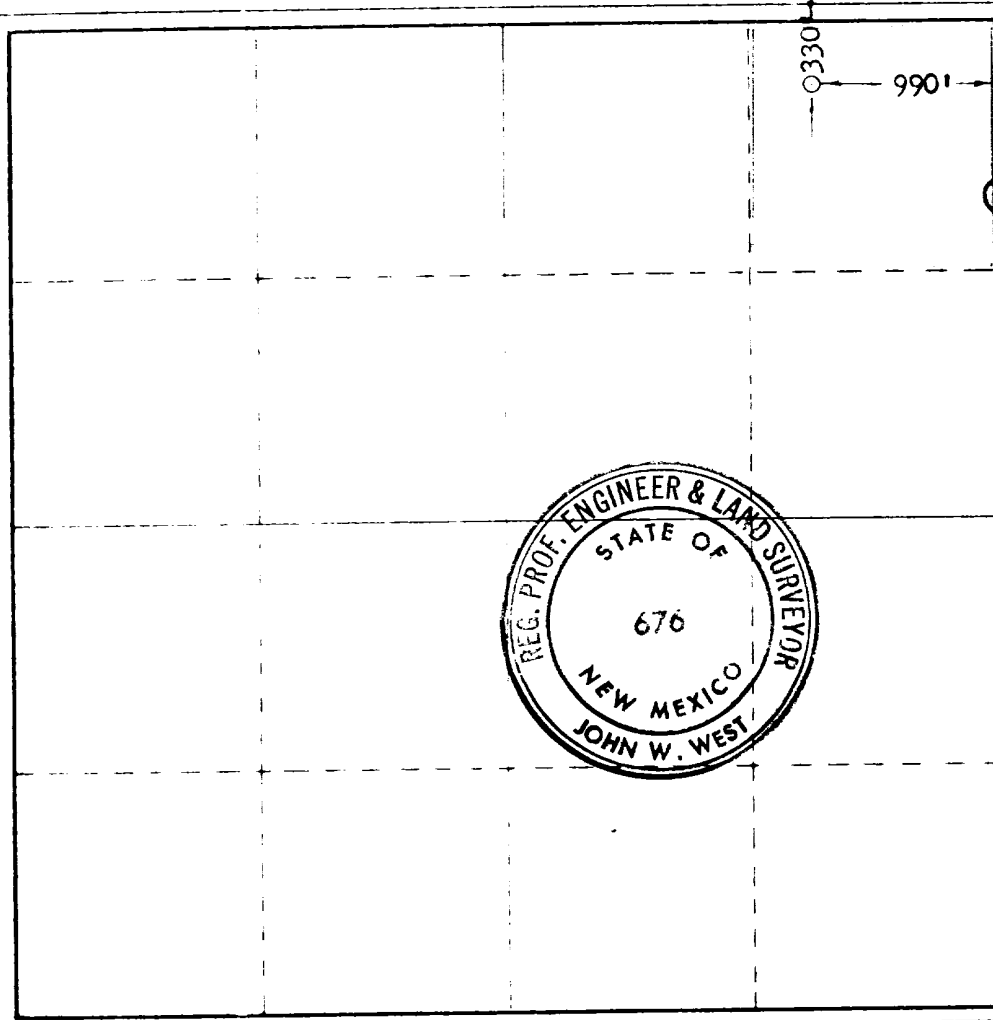

CERTIFICATION

I hereby certify that the information contained herein is true and complete to the best of my knowledge and belief.

Name
Jack L. McClellan

Position
President

Company
McClellan Oil Corporation

Date
May 19, 1975

RECEIVED
I hereby certify that the well location shown on this plat was plotted from field notes of actual surveys made by me or U.S. GEOLOGICAL SURVEY and that the same is true and correct to the best of my knowledge and belief.
MAY 20 1975
ARTESIA, NEW MEXICO

Date Surveyed

May 17, 1975

Registered Professional Engineer and/or Land Surveyor

John W. West
Certificate No. **676**

0 130 660 90 1320 1650 1980 2310 2640 2000 1500 1000 500 0

JME

MCLELLAN OIL CORPORATION

Box 849

ROSWELL, NEW MEXICO 88201

McClallen Oil Corp. No. 2 Bottom Springs
Chaves County, New Mexico

T-14-S

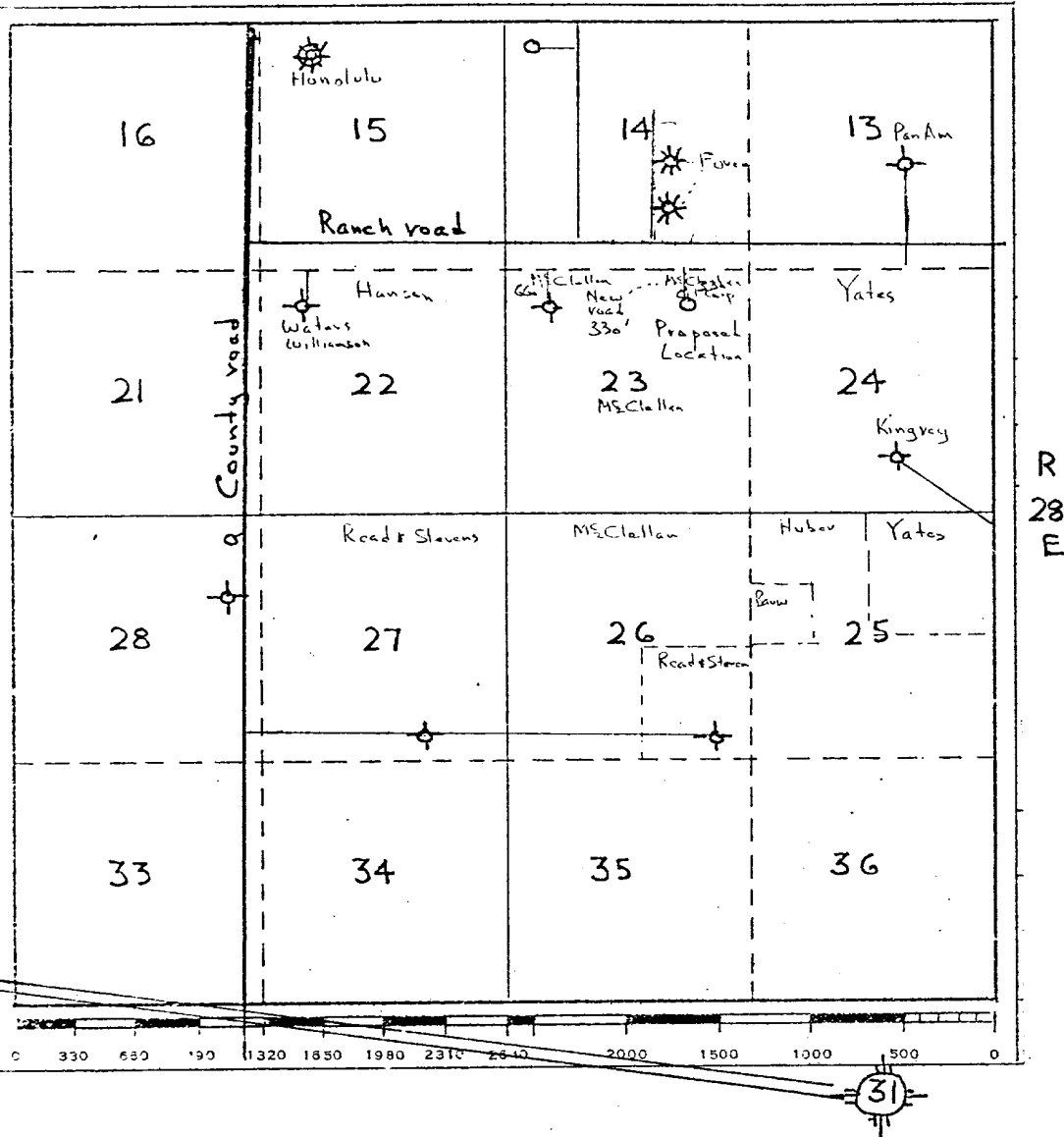

RECEIVED
MAY 20 1975
U. S. GEOLOGICAL SURVEY
ARTESIA, NEW MEXICO

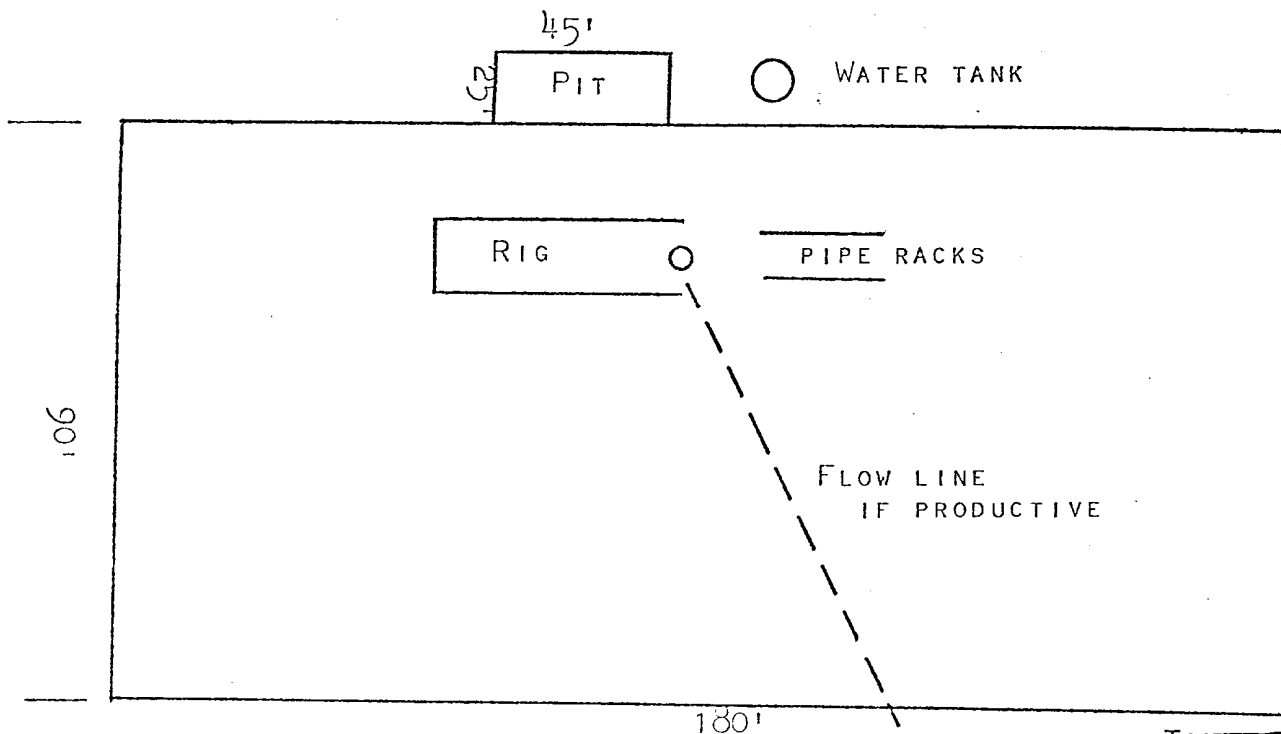

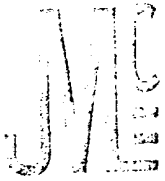

McClellan Oil Corporation

Re: McClellan Oil Corporation
Butter Springs Federal #2
330' FNL & 990' FEL Section
23-T14S-R28E, Chaves
County, New Mexico

The following is a Plan of Development for Surface Use required to drill the proposed well attached to this application:

1. State Highway 31 is approximately $3\frac{1}{2}$ miles South of the main County road bisecting Sections 33 and 34.
2. The proposed road will be the only road into the proposed drillsite.
3. It is possible that other roads will be necessary to the North and South if this test is successful.
4. The production, if achieved, will be pumped into a tank battery located South of the test.
5. Drilling water will have to be trucked in as there is no source of fresh water in this area.
6. After completion of drilling operations all waste will be buried in a separate pit or hauled away.
7. Any produced brine water will be removed by truck in order to prevent contamination of any possible fresh water bearing sands in this area.
8. Casinghead gas, if any, will await a pipeline as other shutin gas wells in this area.
9. Negotiations for a connection will be made immediately upon completion.
10. An attached development plat indicates location layout, rig plan, etc.
11. In the event a dry hole is achieved, all pits will be filled and the location resotred, as near as possible, to its original condition.
12. If production is achieved, pad and roads will remain in effect however pits will be filled and restored, as near as possible, to their original condition.