

NO. OF COPIES RECEIVED	6
DISTRIBUTION	
SANTA FE	
FILE	
U.S.G.S.	
LAND OFFICE	
OPERATOR	

NEW MEXICO OIL CONSERVATION COMMISSION

RECEIVED

AUG 18 1975

30-005-60353
Form C-101
Revised 1-1-65

APPLICATION FOR PERMIT TO DRILL, DEEPEN, OR PLUG BACK		5A. Indicate Type of Lease STATE <input checked="" type="checkbox"/> FEE <input type="checkbox"/>	
		5. State Oil & Gas Lease No. L-5029	
1a. Type of Work DRILL <input type="checkbox"/> DEEPEN <input type="checkbox"/> PLUG BACK <input type="checkbox"/>		7. Unit Agreement Name	
b. Type of Well OIL WELL <input checked="" type="checkbox"/> GAS WELL <input type="checkbox"/> OTHER <input type="checkbox"/> SINGLE ZONE <input checked="" type="checkbox"/> MULTIPLE ZONE <input type="checkbox"/>		8. Farm or Lease Name State 27	
2. Name of Operator Marathon Oil Company ✓		9. Well No. 1	
3. Address of Operator P. O. Box 2409, Hobbs, New Mexico 88240		10. Field and Pool, or Wildcat Wildcat	
4. Location of Well UNIT LETTER M LOCATED 660 FEET FROM THE South LINE AND 660 FEET FROM THE West LINE OF SEC. 27 TWP. 4S RGE. 27E NMPM		12. County Chavez	
		19. Proposed Depth 7200'	
		19A. Formation Montoya	
		20. Rotary or C.T. Rotary	
21. Elevations (Show whether DF, RT, etc.) GL 3936' Est.		21A. Kind & Status Plug. Bond Current	
		21B. Drilling Contractor Perlap, Inc.	
		22. Approx. Date Work will start August 20, 1975	

23. PROPOSED CASING AND CEMENT PROGRAM					
SIZE OF HOLE	SIZE OF CASING	WEIGHT PER FOOT	SETTING DEPTH	SACKS OF CEMENT	EST. TOP
12 1/2" & 11"	8 5/8"	24#	1250'	500 sx	Circulate
7 7/8"	5 1/2"	15.50# & 17#	7200'	330 sx	5000'

1. Drill to approximate depth of 7200'.
2. Cement and test all casing by approved methods.
3. While drilling, well is to be equipped with Series 900 Cameron BOP or equivalent. BOP to be equipped with pipe rams and blank rams. Remote controls will be located on derrick floor with closing unit located a minimum of 75' from the wellhead.
4. During completion, well will be equipped with 900 Cameron BOP or equivalent. BOP to be equipped with pipe and blank rams.

APPROVAL VALID
FOR 90 DAYS UNLESS
DRILLING COMMENCED,

EXPIRES 11-19-75

IN ABOVE SPACE DESCRIBE PROPOSED PROGRAM: IF PROPOSAL IS TO DEEPEN OR PLUG BACK, GIVE DATA ON PRESENT PRODUCTIVE ZONE AND PROPOSED NEW PRODUCTIVE ZONE. GIVE BLOWOUT PREVENTER PROGRAM, IF ANY.

I hereby certify that the information above is true and complete to the best of my knowledge and belief.

Signed ML Johnson Title Petroleum Engineer Date August 18, 1975

(This space for State Use)

APPROVED BY W. A. Gressett TITLE SUPERVISOR, DISTRICT II DATE AUG 19 1975

CONDITIONS OF APPROVAL, IF ANY:

XC: COPL RPS JCH File

**NE EXICO OIL CONSERVATION COMMISSION
WELL LOCATION AND ACREAGE DEDICATION PLAT**

Form C-102
Supersedes C-128
Effective 1-1-65

All distances must be from the outer boundaries of the Section

Lease Marathon Oil Company			State State 27		Well No. 1
Section M	Section 27	Township 4 South	Range 27 East	County Chaves	
A. True North Location of Well: <div style="display: flex; justify-content: space-between; align-items: center;"> 660 feet from the South line and 660 feet from the West line </div>					
Well Depth (feet) 3935.7	Producing Formation Montoya	Pool Wildcat		Dedicated Acreage: 40 Acres	

1. Outline the acreage dedicated to the subject well by colored pencil or hachure marks on the plat below.
2. If more than one lease is dedicated to the well, outline each and identify the ownership thereof (both as to working interest and royalty).
3. If more than one lease of different ownership is dedicated to the well, have the interests of all owners been consolidated by communitization, unitization, force-pooling, etc?

☐ Yes ☐ No If answer is "yes," type of consolidation _____

If answer is "no," list the owners and tract descriptions which have actually been consolidated. (Use reverse side of this form if necessary.) _____

No allowable will be assigned to the well until all interests have been consolidated (by communitization, unitization, forced-pooling, or otherwise) or until a non-standard unit, eliminating such interests, has been approved by the Commission.

R-27E

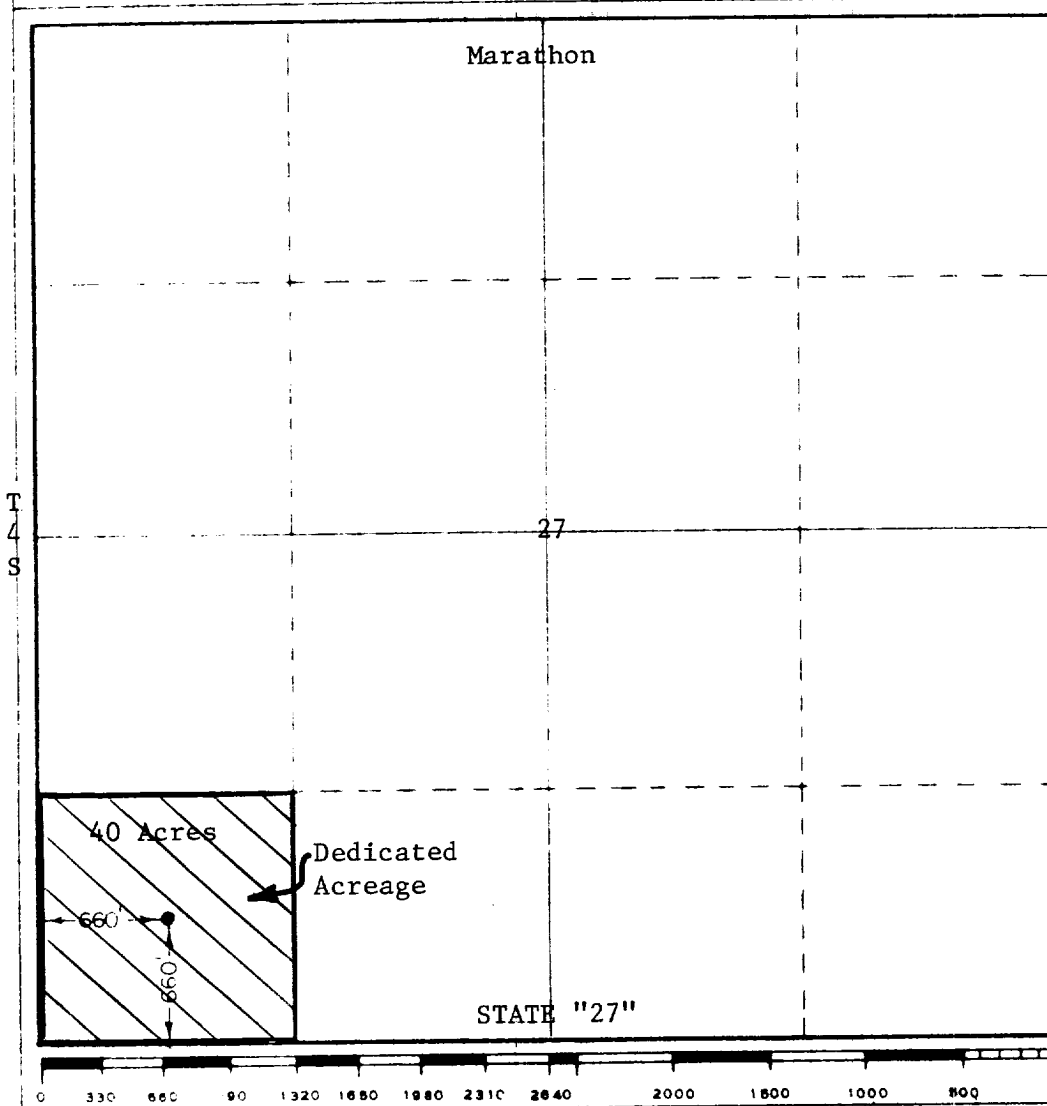

CERTIFICATION

I hereby certify that the information contained herein is true and complete to the best of my knowledge and belief.

M. L. Johnston

Name
M. L. Johnston

Profession
Petroleum Engineer

Company
Marathon Oil Company

Date
August 18, 1975

I hereby certify that the well location shown on this plat was plotted from field notes of actual surveys made by me or under my supervision, and that the same is true and correct to the best of my knowledge and belief.

