

NO. OF COPIES RECEIVED 6

DISTRIBUTION

SANTA FE 1

FILE 1 ✓

U.S.G.S. 1

LAND OFFICE 1

OPERATOR 1

NEW MEXICO OIL CONSERVATION COMMISSION

RECEIVED

SEP 25 1975

30-005-60356

Form C-101  
Revised 1-1-65

5A. Indicate Type of Lease  
STATE ☒ FEE ☐

5. State Oil & Gas Lease No.  
8 5435

7. Unit Agreement Name

8. Farm or Lease Name  
State 9

9. Well No.  
1

10. Field and Pool, or Wildcat  
Wildcat

12. County  
Chaves

19. Proposed Depth  
2000'

19A. Formation  
Top San Andres

20. Rotary or C.T.  
Rotary

21. Elevations (Show whether DF, RT, etc.)  
3855.6 Ground

21A. Kind & Status Plug. Bond  
Dldr. \$5000.00

21B. Drilling Contractor  
Williams Bros.

22. Approx. Date Work will start  
Sept. 29, 1975

APPLICATION FOR PERMIT TO DRILL, DEEPEN, OR PLUG BACK

1a. Type of Work  
DRILL ☒ DEEPEN ☐ PLUG BACK ☐

b. Type of Well  
OIL WELL ☒ GAS WELL ☐ OTHER ☐

2. Name of Operator  
Garner-Murphy Oil Co.

3. Address of Operator  
3101 No. Encanto Dr., Roswell, New Mexico 88201

4. Location of Well  
UNIT LETTER P LOCATED 330 FEET FROM THE South LINE  
AND 330 FEET FROM THE East LINE OF SEC. 9 TWP. 10-S. RGE. 27-S. NMPM

19. Proposed Depth  
2000'

19A. Formation  
Top San Andres

20. Rotary or C.T.  
Rotary

21. Elevations (Show whether DF, RT, etc.)  
3855.6 Ground

21A. Kind & Status Plug. Bond  
Dldr. \$5000.00

21B. Drilling Contractor  
Williams Bros.

22. Approx. Date Work will start  
Sept. 29, 1975

PROPOSED CASING AND CEMENT PROGRAM

SIZE OF HOLE	SIZE OF CASING	WEIGHT PER FOOT	SETTING DEPTH	SACKS OF CEMENT	EST. TOP
<u>12 1/4"</u>	<u>8 5/8"</u>	<u>24 Lb.</u>	<u>300'</u>	<u>200</u>	<u>300' to 0</u>
<u>7 7/8"</u>	<u>4 1/2"</u>	<u>10 Lb.</u>	<u>1950'</u>	<u>150</u>	<u>1200'</u>

Drill 12 1/4" hole to 300'. Set 8 5/8" casing and cement to surface with 200 sacks of cement, wait 24 hrs. Drill out with 7 7/8" bit and carry same size hole to bottom. Run elect log and side wall sample all shows, if samples check out productive, run a string of 4 1/2" new 10 lb. casing. Cement from bottom up to 1200' with 150 sacks of cement, after 24 hrs. run perforate to complete.

APPROVAL VALID  
FOR 90 DAYS UNLESS  
DRILLING COMMENCED,

EXPIRES 12-26-75

IN ABOVE SPACE DESCRIBE PROPOSED PROGRAM: IF PROPOSAL IS TO DEEPEN OR PLUG BACK, GIVE DATA ON PRESENT PRODUCTIVE ZONE AND PROPOSED NEW PRODUCTIVE ZONE. GIVE BLOWOUT PREVENTER PROGRAM, IF ANY.

I hereby certify that the information above is true and complete to the best of my knowledge and belief.

Signed Lyle R. Garner Title Sr. Date Sept. 25, 1975

(This space for State Use)

APPROVED BY W.A. Grasset TITLE SUPERVISOR, DISTRICT II DATE SEP 26 1975

CONDITIONS OF APPROVAL, IF ANY:

NEW MEXICO OIL CONSERVATION COMMISSION  
WELL LOCATION AND ACREAGE DEDICATION PLAT

Form C-102  
Supersedes C-128  
Effective 1-1-65

All distances must be from the outer boundaries of the Section.

Operator <b>Garner-Murphy Oil Co.</b>			Lease <b>State 9</b>		Well No. <b># 1</b>
Unit Letter <b>5</b>	Section <b>9</b>	Township <b>10-S</b>	Range <b>27-E</b>	County <b>CHAVES</b>	
Actual Footage Location of Well: <b>330</b> feet from the <b>SOUTH</b> line and <b>330</b> feet from the <b>EAST</b> line					
Ground Level Elev: <b>3855.6</b>	Producing Formation <b>Ganitan</b>	Pool <b>Wilbeat</b>	Dedicated Acreage: <b>40</b> Acres		

1. Outline the acreage dedicated to the subject well by colored pencil or hachure marks on the plat below.
2. If more than one lease is dedicated to the well, outline each and identify the ownership thereof (both as to working interest and royalty).
3. If more than one lease of different ownership is dedicated to the well, have the interests of all owners been consolidated by communitization, unitization, force-pooling, etc?

☐ Yes ☒ No If answer is "yes," type of consolidation \_\_\_\_\_

If answer is "no," list the owners and tract descriptions which have actually been consolidated. (Use reverse side of this form if necessary.) State Of New Mexico Lease

No allowable will be assigned to the well until all interests have been consolidated (by communitization, unitization, forced-pooling, or otherwise) or until a non-standard unit, eliminating such interests, has been approved by the Commission.

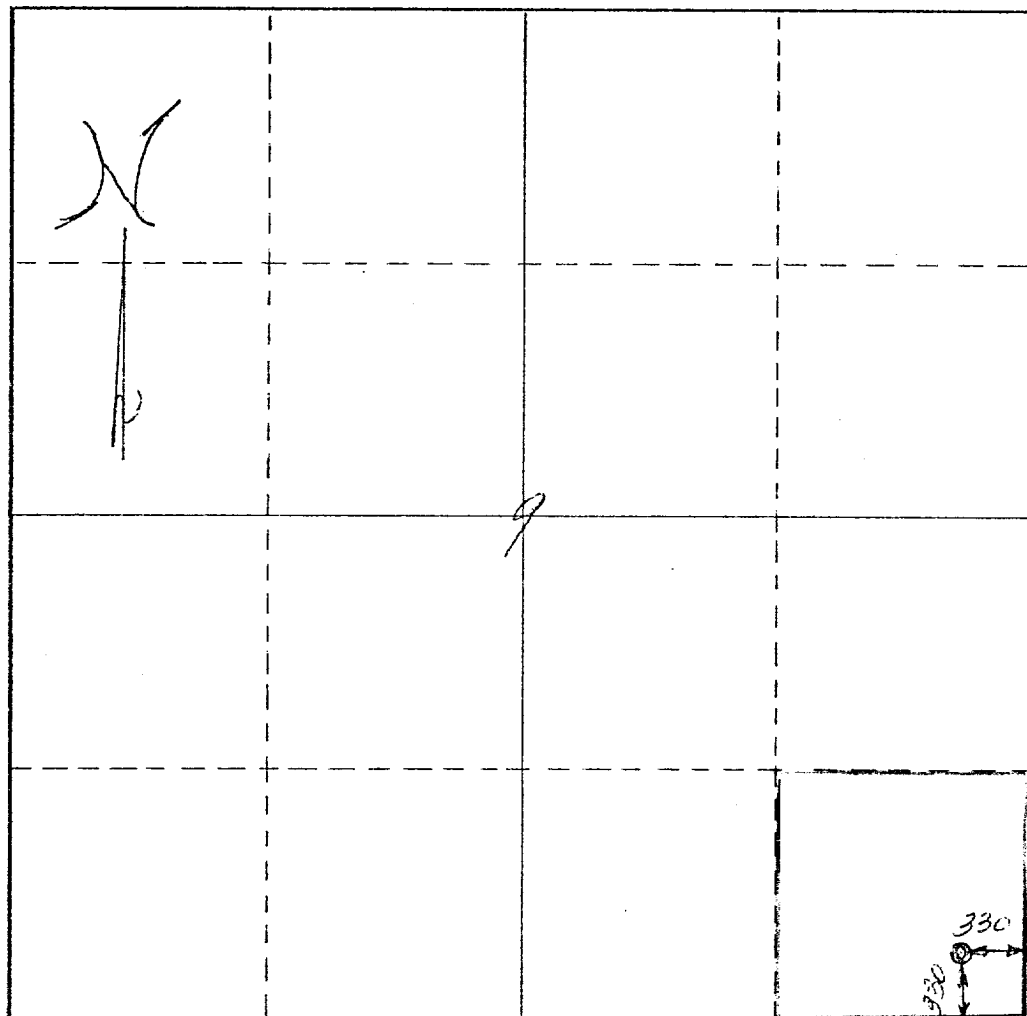

CERTIFICATION

I hereby certify that the information contained herein is true and complete to the best of my knowledge and belief.

Lyle L. Garner  
Name

Owner-Mgr.

Position

Company

Garner-Murphy Oil Co.

Date

Sept. 25, 1975

I hereby certify that the well location shown on this plat was plotted from field notes of actual surveys made by me or under my supervision, and that the same is true and correct to the best of my knowledge and belief.

Date Surveyed

Sept 23, 1975

Registered Professional Engineer and/or Land Surveyor

J. L. Spaulding

Certificate No.

4574