

NO. OF COPIES RECEIVED	6
DISTRIBUTION	
SANTA FE	1
FILE	1
U.S.G.S.	1
LAND OFFICE	1
OPERATOR	1

RECEIVED
RECEIVED
 NEW MEXICO OIL CONSERVATION COMMISSION
JUL 6 1976
JUL 9 1976
O.C.C.
O.C.C. ARTESIA, OFFICE
ARTESIA, OFFICE

30-CCS-60388

Form C-101
 Revised 1-1-65

5A. Indicate Type of Lease STATE <input checked="" type="checkbox"/> FEE <input type="checkbox"/>
5. State Oil & Gas Lease No. L168

APPLICATION FOR PERMIT TO DRILL, DEEPEN, OR PLUG BACK

1a. Type of Work DRILL <input checked="" type="checkbox"/> DEEPEN <input type="checkbox"/> PLUG BACK <input type="checkbox"/>			7. Unit Agreement Name Kent Shannon
b. Type of Well OIL WELL <input checked="" type="checkbox"/> GAS WELL <input type="checkbox"/> OTHER <input type="checkbox"/> SINGLE ZONE <input checked="" type="checkbox"/> MULTIPLE ZONE <input type="checkbox"/>			8. Farm or Lease Name E1 Pase
2. Name of Operator Kent Shannon			9. Well No. No. 1
3. Address of Operator Box 633 Roswell, N.M.			10. Field and Pool, or Wildcat Wildcat
4. Location of Well UNIT LETTER No. 1 M LOCATED 990 FEET FROM THE West LINE AND 660 FEET FROM THE South LINE OF SEC. 36 TWP. 10S RGE. 26E NMPM			
			12. County Chaves
19. Proposed Depth 2000			19A. Formation San Andres
			20. Rotary or C.T. C.T.
21. Elevations (Show whether DE, RT, etc.) 3739.2	21A. Kind & Status Plug. Bond Blanket (Current)	21B. Drilling Contractor Llano	22. Approx. Date Work will start July 17, 1976

PROPOSED CASING AND CEMENT PROGRAM

SIZE OF HOLE	SIZE OF CASING	WEIGHT PER FOOT	SETTING DEPTH	SACKS OF CEMENT	EST. TOP
10"	8 5/8	24#	350	50	Circ.
7"	4 1/2	10 1/2#	2000	100	"

IN ABOVE SPACE DESCRIBE PROPOSED PROGRAM: IF PROPOSAL IS TO DEEPEN OR PLUG BACK, GIVE DATA ON PRESENT PRODUCTIVE ZONE AND PROPOSED NEW PRODUCTIVE ZONE. GIVE BLOWOUT PREVENTER PROGRAM, IF ANY.

I hereby certify that the information above is true and complete to the best of my knowledge and belief.

Signed *[Signature]* Title *Owner* Date *2 July, 1976*

(This space for State Use)

APPROVED BY *[Signature]* TITLE *OIL AND GAS INSPECTION* DATE *JUL 9 1976*

CONDITIONS OF APPROVAL, IF ANY:

Cement must be circulated to

surface below 8 5/8 casing

**APPROVAL VALID
 FOR 90 DAYS UNLESS
 DRILLING COMMENCED,**

EXPIRES 10-9-76

**NEW MEXICO OIL CONSERVATION COMMISSION
WELL LOCATION AND ACREAGE DEDICATION PLAT**

Form C-102
Supersedes C-128
Effective 1-1-65

All distances must be from the outer boundaries of the Section.

Operator Kent Shannon			Lease El Paso		Well No. 1
Unit Letter M	Section 36	Township 10-S	Range 26-E	County CHAVES	
Actual Footage Location of Well: 660 feet from the SOUTH line and 990 feet from the WEST line					
Ground Level Elev. 3739.2	Producing Formation San Andres		Pool Wildcat	Dedicated Acreage: 40 Acres	

1. Outline the acreage dedicated to the subject well by colored pencil or hachure marks on the plat below.
2. If more than one lease is dedicated to the well, outline each and identify the ownership thereof (both as to working interest and royalty).
3. If more than one lease of different ownership is dedicated to the well, have the interests of all owners been consolidated by communitization, unitization, force-pooling, etc?

☐ Yes ☒ No If answer is "yes," type of consolidation _____

If answer is "no," list the owners and tract descriptions which have actually been consolidated. (Use reverse side of this form if necessary.) ~~Kent Shannon~~

No allowable will be assigned to the well until all interests have been consolidated (by communitization, unitization, forced-pooling, or otherwise) or until a non-standard unit, eliminating such interests, has been approved by the Commission.

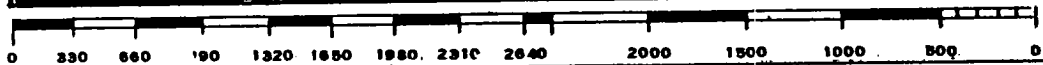
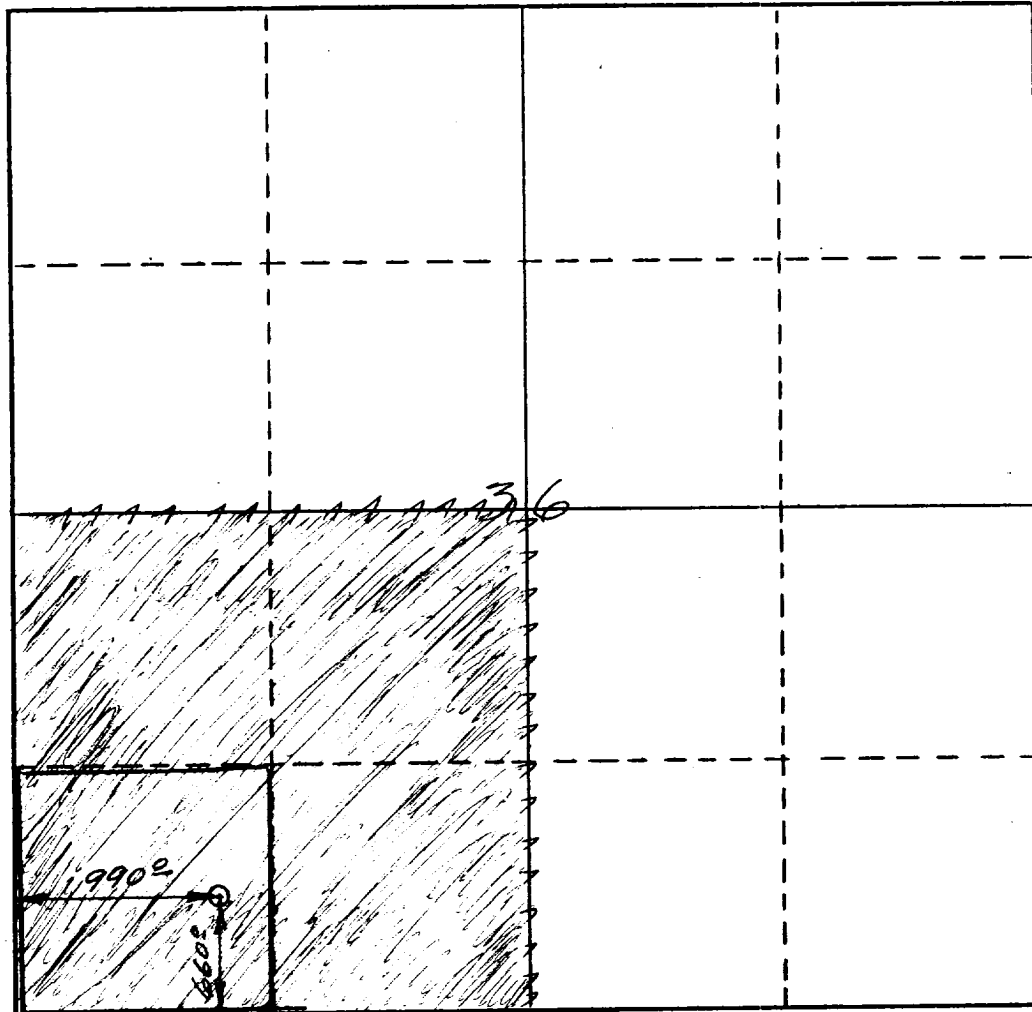

CERTIFICATION

I hereby certify that the information contained herein is true and complete to the best of my knowledge and belief.

[Signature]

Name
Kent Shannon

Position
Owner

Company
Kent Shannon

Date
July 2, 1976

I hereby certify that the well location shown on this plat was plotted from field notes of actual surveys made by me or under my supervision, and that the same is true and correct to the best of my knowledge and belief.

Date Surveyed
April 16, 1976

Registered Professional Engineer and/or Land Surveyor
J.C. Shouse

Certificate No.
4524