

UNITED STATES
DEPARTMENT OF THE INTERIOR
GEOLOGICAL SURVEY

30-005-60391

APPLICATION FOR PERMIT TO DRILL, DEEPEN, OR PLUG BACK

1a. TYPE OF WORK

DRILL ☐DEEPEN ☒PLUG BACK ☐

b. TYPE OF WELL

OIL
WELL ☒GAS
WELL ☐

OTHER

SINGLE
ZONE ☒ RECEIVED
MULTIPLE
ZONES ☐

2. NAME OF OPERATOR

C. E. LaRue and B. N. Muncy, Jr.

NOV 27 1978

3. ADDRESS OF OPERATOR

PO Box 196

Artesia, NM 88210

4. LOCATION OF WELL (Report location clearly and in accordance with any State requirements.)

At surface

660' FNL and 1980' FWL of Section 20, T14S, R28E

At proposed prod. zone

14. DISTANCE IN MILES AND DIRECTION FROM NEAREST TOWN OR POST OFFICE*

12 miles East of Hagerman, NM

15. DISTANCE FROM PROPOSED*

LOCATION TO NEAREST
PROPERTY OR LEASE LINE, FT.
(Also to nearest drig. unit line, if any)

660'

16. NO. OF ACRES IN LEASE

2200

17. NO. OF ACRES ASSIGNED
TO THIS WELL

40

18. DISTANCE FROM PROPOSED LOCATION*

TO NEAREST WELL, DRILLING, COMPLETED,
OR APPLIED FOR, ON THIS LEASE, FT.

5280'

19. PROPOSED DEPTH

2050'

20. ROTARY OR CABLE TOOLS

Rotary

21. ELEVATIONS (Show whether DF, RT, GR, etc.)

3550 GL

22. APPROX. DATE WORK WILL START*

August 25, 1978

23.

PROPOSED CASING AND CEMENTING PROGRAM

SIZE OF HOLE	SIZE OF CASING	WEIGHT PER FOOT	SETTING DEPTH	QUANTITY OF CEMENT
11"	8-5/8"	29#	204'	150 Sacks Circulated
7-7/8"	5-1/2"	15-1/2#	1584'	150 Sacks

Casing is already in place, propose to drill out plugs and deepen well to 2050' to test the San Andres. Actual well depth is 1619' which is top of San Andres with no gas show in premier zone now producing in area. If producing oil well, it will be completed open hole in San Andres. Reagan 8" BOP will be used. Only Pressures or unusual conditions in area is the Premier section which has been drilled with no gas show. Only surface change will to reopen pits, and blade location and access road which have been ripped.

IN ABOVE SPACE DESCRIBE PROPOSED PROGRAM: If proposal is to deepen or plug back, give data on present productive zone and proposed new productive zone. If proposal is to drill or deepen directionally, give pertinent data on subsurface locations and measured and true vertical depths. Give blowout preventer program, if any.

24.

SIGNED

TITLE

Operator

DATE

8/14/78

(This space for Federal or State office use)

PERMIT NO.

APPROVAL DATE

APPROVED BY

CONDITIONS OF APPROVAL, IF ANY:

TITLE

ACTING DISTRICT ENGINEER

DATE

NOV 22 1978

NEW MEXICO OIL CONSERVATION COMMISSION
WELL LOCATION AND ACREAGE DEDICATION PLAT

Form C-102
Supersedes C-128
Effective 1-1-65

All distances must be from the outer boundaries of the Section

Operator C. E. LaRue and B. N. Muncy, Jr.			Lease Lillie Federal		Well No. 4
Unit Letter C	Section 20	Township 14 S	Range 28 E	County Chaves	
Actual Footage Location of Well: 660 feet from the North line and 1980 feet from the West line					
Ground Level Elev. 3550	Producing Formation Gilberg		Pool San Juan	Dedicated Acreage 40 Acres	

- Outline the acreage dedicated to the subject well by colored pencil or hachure marks on the plat below.
- If more than one lease is dedicated to the well, outline each and identify the ownership thereof (both as to working interest and royalty).
- If more than one lease of different ownership is dedicated to the well, have the interest of all owners been consolidated by communitization, unitization, force-pooling, etc?

☐ Yes ☐ No If answer is "yes," type of consolidation _____

If answer is "no," list the owners and tract descriptions which have actually been consolidated. _____ reverse side of this form if necessary.)

No allowable will be assigned to the well until all interests have been consolidated (by communitization, unitization, forced-pooling, or otherwise) or until a non-standard unit, eliminating such interests, has been approved by the Commission.

RECEIVED
AUG 16 1978
U.S. GEOLOGICAL SURVEY
ARTESIA, NEW MEXICO

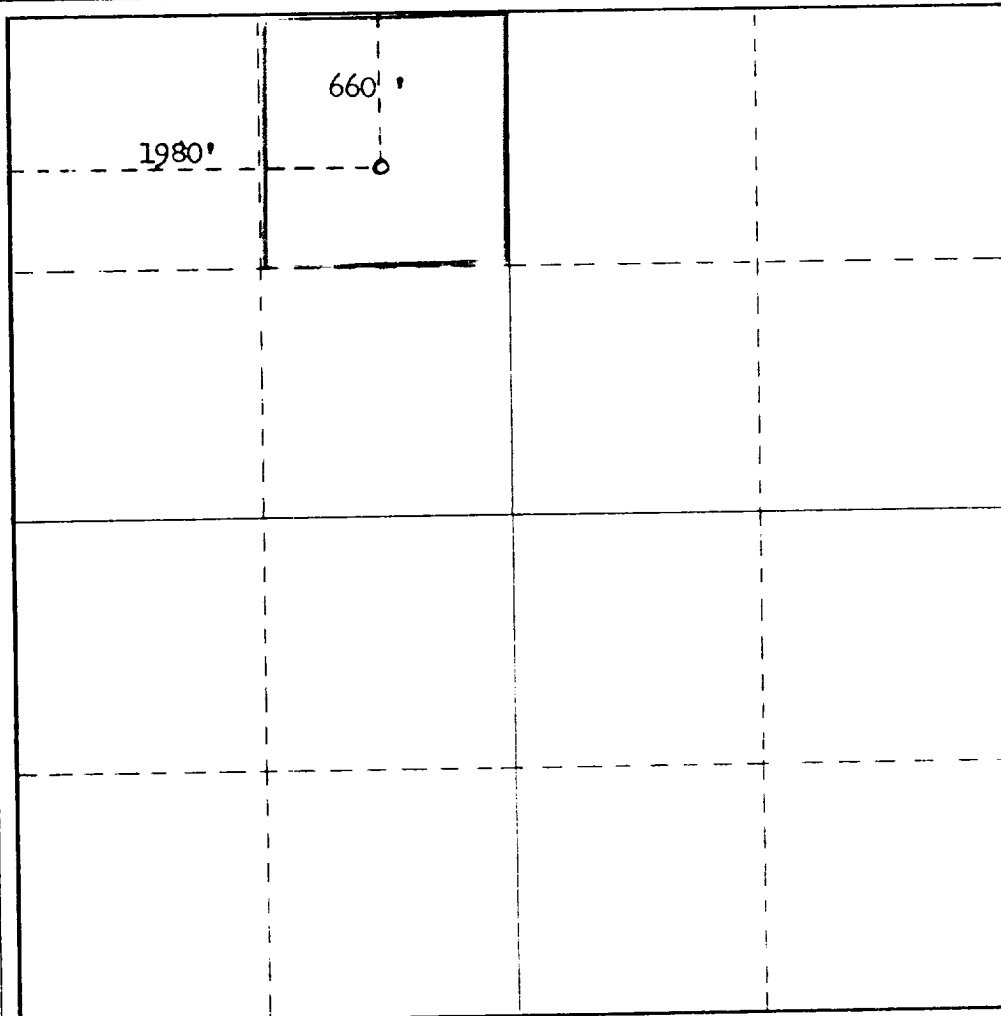

CERTIFICATION

I hereby certify that the information contained herein is true and complete to the best of my knowledge and belief.

[Signature]
Operator

Position
C. E. LaRue & B. N. Muncy, Jr.

Company
August 14, 1978

Date

I hereby certify that the well location shown on this plat was plotted from field notes of actual surveys made by me or under my supervision, and that the same is true and correct to the best of my knowledge and belief.

See original Survey of

Date Surveyed
May 29, 1976

Registered Professional Engineer
and/or Land Surveyor

Certificate No.

