

NMOCG. COPY

SUBMIT IN TI (CATE*
(Other instructions on
reverse side)Form approved.
Budget Bureau No. 42-R1425.UNITED STATES
DEPARTMENT OF THE INTERIOR
GEOLOGICAL SURVEY

30-005-60447

APPLICATION FOR PERMIT TO DRILL, DEEPEN, OR PLUG BACK

1a. TYPE OF WORK DRILL <input checked="" type="checkbox"/> DEEPEN <input type="checkbox"/> PLUG BACK <input type="checkbox"/>		5. LEASE DESIGNATION AND SERIAL NO. NM-3282
b. TYPE OF WELL OIL WELL <input checked="" type="checkbox"/> GAS WELL <input type="checkbox"/> OTHER <input type="checkbox"/>		6. IF INDIAN, ALLOTTEE OR TRIBE NAME
2. NAME OF OPERATOR Flag-Redfern Oil Company		7. UNIT AGREEMENT NAME
3. ADDRESS OF OPERATOR P. O. Box 23, Midland, Texas 79702		8. FARM OR LEASE NAME Federal "35"
4. LOCATION OF WELL (Report location clearly and in accordance with any State regulations.) At surface 660' FNL & 660' FEL At proposed prod. zone Same		9. WELL NO. 1
14. DISTANCE IN MILES AND DIRECTION FROM NEAREST TOWN OR POST OFFICE* 5 1/2 miles northeast of Dexter		10. FIELD AND POOL OR WILDCAT Calumet Dexter Field
10. DISTANCE FROM PROPOSED* LOCATION TO NEAREST PROPERTY OR LEASE LINE, FT. (Also to nearest drlg. unit line, if any) 660'		11. SEC., T., R., M., OR BLK. AND SURVEY OR AREA Sec. 35, T-12-S, R-26-E
18. DISTANCE FROM PROPOSED* LOCATION TO NEAREST WELL, DRILLING, COMPLETED, OR APPLIED FOR, ON THIS LEASE, FT. None		12. COUNTY OR PARISH Chaves
16. NO. OF ACRES IN LEASE 360		13. STATE New Mexico
19. PROPOSED DEPTH 1400'		17. NO. OF ACRES ASSIGNED TO THIS WELL 40
20. ROTARY OR CABLE TOOLS Rotary		21. APPROX. DATE WORK WILL START* September 15, 1977
21. ELEVATIONS (Show whether DF, RT, GR, etc.) 3536' GL		

23. PROPOSED CASING AND CEMENTING PROGRAM

SIZE OF HOLE	SIZE OF CASING	WEIGHT PER FOOT	SETTING DEPTH	QUANTITY OF CEMENT
12-1/4"	8-5/8"	24# K	950'	600 sx
7-7/8"	4-1/2"	10.5# J	1400'	170 sx

Drill 12-1/4" hole to approximately 950'. Run 8-5/8" casing & cement w/600 sx Class "C". Drill 7-7/8" hole to approximately 1400'. Run open hole logs. Run 4 1/2" casing & cement with 170 sx Class "C". Run correlation logs. Perforate. Swab to test.

Mud Program: 0- 950' Native mud
950-1400' No mud (this interval to be cable tool)

IN ABOVE SPACE DESCRIBE PROPOSED PROGRAM: If proposal is to deepen or plug back, give data on present productive zone and proposed new productive zone. If proposal is to drill or deepen directionally, give pertinent data on subsurface locations and measured and true vertical depths. Give blowout preventer program, if any.

24.

SIGNED

John A. Swandig

TITLE

Petroleum Engineer

DATE

August 17, 1977

(This space for Federal or State office use)

PERMIT NO.

APPROVAL DATE

APPROVED
SEP 6 - 1977
R. L. DEERMAN
ACTING DISTRICT ENGINEER

THIS APPROVAL IS REVOKED IF OPERATIONS
ARE NOT COMMENCED WITHIN 3 MONTHS.
EXPIRES DEC 6 1977

DATE

*See Instructions On Reverse Side

RECEIVED
AUG 19 1977
U.S. GEOLOGICAL SURVEY
ARTESIA, NEW MEXICO

**NEW MEXICO OIL CONSERVATION COMMISSION
WELL LOCATION AND ACREAGE DEDICATION PLAT**

Form C-102
Supersedes C-128
Effective 1-1-65

All distances must be from the outer boundaries of the Section.

Operator Flag-Redfern Oil Company			Lease Federal "35"		Well No. 1
Unit Letter A	Section 35	Township 12S	Range 26E	County Chaves	
Actual Footage Location of Well: 660 feet from the North line and 660 feet from the East line					
Ground Level Elev: 3536	Producing Formation San Andres		Pool <i>Calumet San Andres</i> Dexter	Dedicated Acreage: 40 Acres	

1. Outline the acreage dedicated to the subject well by colored pencil or hachure marks on the plat.
2. If more than one lease is dedicated to the well, outline each and identify the owner thereof (both as to working interest and royalty).
3. If more than one lease of different ownership is dedicated to the well, have the interests of all owners be consolidated by communitization, unitization, force-pooling, etc?

☐ Yes ☐ No If answer is "yes," type of consolidation _____

If answer is "no," list the owners and tract descriptions which have actually been consolidated. (Use reverse side of this form if necessary.) _____

No allowable will be assigned to the well until all interests have been consolidated (by communitization, unitization, forced-pooling, or otherwise) or until a non-standard unit, eliminating such interests, has been approved by the Commission.

**RECEIVED
AUG 19 1977
U.S. GEOLOGICAL SURVEY
ARTESIA, NEW MEXICO**

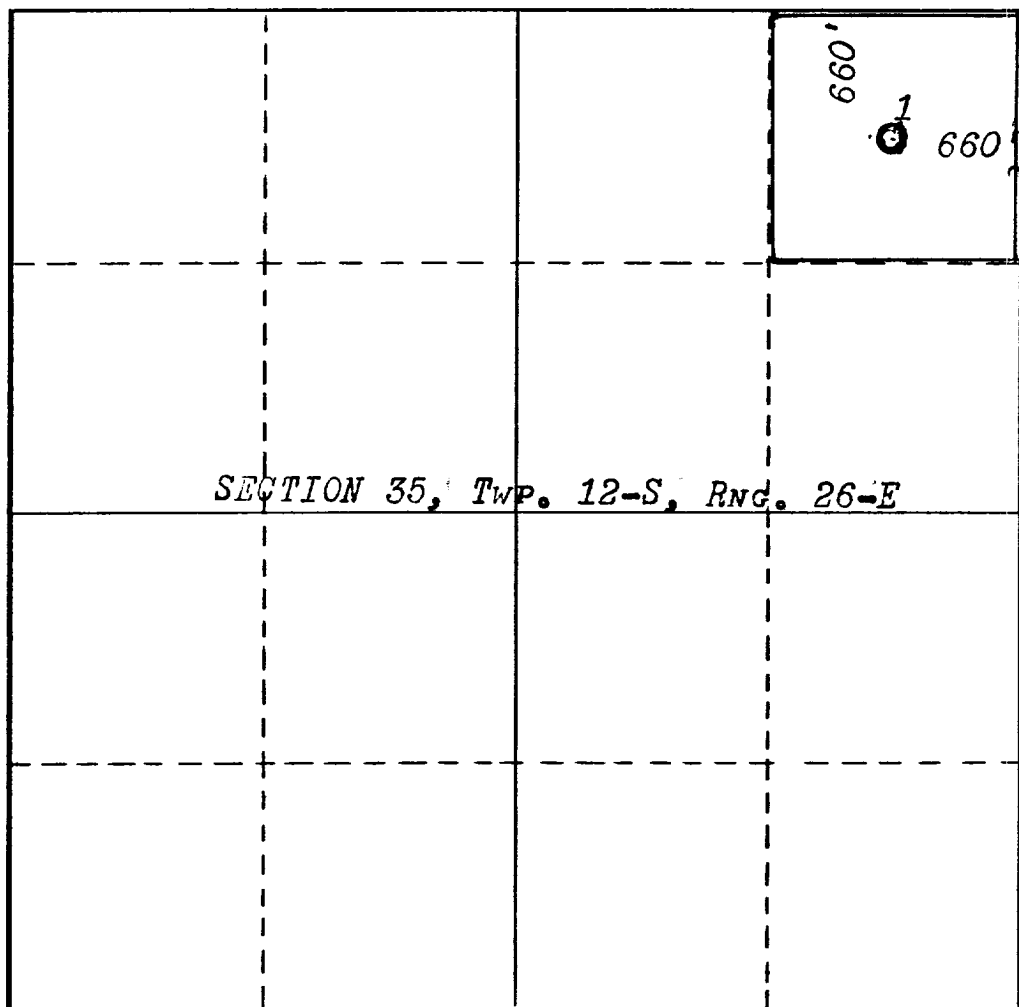

SECTION 35, Twp. 12-S, Rng. 26-E

CERTIFICATION

I hereby certify that the information contained herein is true and complete to the best of my knowledge and belief.

Name *John A. Sanchez*
Position
Petroleum Engineer
Company
Flag-Redfern Oil Company
Date
August 17, 1977

I hereby certify that the well location shown on this plat was plotted from field notes of actual surveys made by me or under my supervision, and that the same is true and correct to the best of my knowledge and belief.

Date Surveyed **Aug. 5, 1977**
Registered Professional Engineer and/or Land Surveyor
[Signature]
Certificate No. **754**

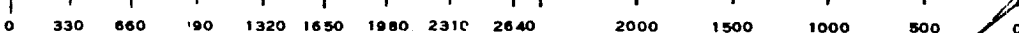

Surface Use and Operation Plan

Flag-Redfern Oil Company
Federal "35" No. 1
Section 35, T-12-S, R-26-E
Chaves County, New Mexico

1. Existing Roads

- A. Attached is a portion of a U.S.G.S. topographic map showing existing roads in the vicinity of the proposed location.
- B. Attached is a plat showing existing roads in the area of the proposed location.
- C. There are no plans for improving the existing roads.

2. Access Roads

- A. Planned access roads are shown on the attached plat.
- B. The road will be constructed of caliche and will be 10' wide.

3. Location of Existing Wells

- A. Existing wells are shown on the attached plat.

4. Location of Tank Batteries, etc.

- A. No tank batteries or production facilities exist within one mile of the proposed location owned or controlled by Flag-Redfern Oil Company.
- B. In the event the proposed well is productive, the production facilities will be located in the southwest portion of the drillsite. The facility will consist of 2 - 200 barrel stock tanks and a heater treater.
- C. The reserve pits will be back filled and leveled and the surface returned to its original contours.

5. Location and Type of Water Supply

- A. There is no known surface water in the area.
- B. A windmill is located approximately 3500' northeast of the proposed location.

Surface Use and Operation Plan

Page Two

- C. All water used in drilling operations will be trucked to the drillsite from commercial sources.

6. Source of Construction Materials

- A. Construction material will be caliche, which will be purchased by the dirt contractor.

7. Methods for Handling Waste Disposal

- A. Well cuttings will be disposed in the reserve pit. All waste and trash will be either burned or buried in a separate pit.
- B. After completion any produced water will be collected in tanks and trucked to an approved disposal system.
- C. During testing operations, all produced fluids will be collected in tanks and trucked from the well site.

8. Ancillary Facilities

- A. None anticipated.

9. Well Site Layout

- A. Attached is a plat of the well site and rig layout.

10. Plans for Restoration of the Surface

- A. As soon as practical upon completion of the well, the pits will be back filled and leveled and the surface returned to its original contours.

11. Other Information

- A. See attached topographic map for terrain of the general area.
- B. The soil is a thin, sandy alluvium underlain by a caliche hardpan.
- C. Vegetation is mesquite and sparse semi-desert grass and weeds.

Surface Use and Operation Plan
Page Three

12. Operator's Representative

John H. Swendig
P. O. Box 23
Midland, Texas 79702

Office Phone: 915-683-5184
Home Phone: 915-697-1628

13. Certification

I hereby certify that I, or persons under my direct supervision, have inspected the proposed drillsite and access route; that I am familiar with the conditions which presently exist; that the statements made in this plan are, to the best of my knowledge, true and correct; and, that the work associated with the operations proposed herein will be performed by Flag-Redfern Oil Company and its contractors and sub-contractors in conformity with this plan and the terms and conditions under which it is approved.

Date 8-17-77

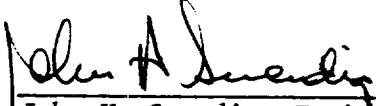

John H. Swendig, Engineer

R-26-E

T
12
S

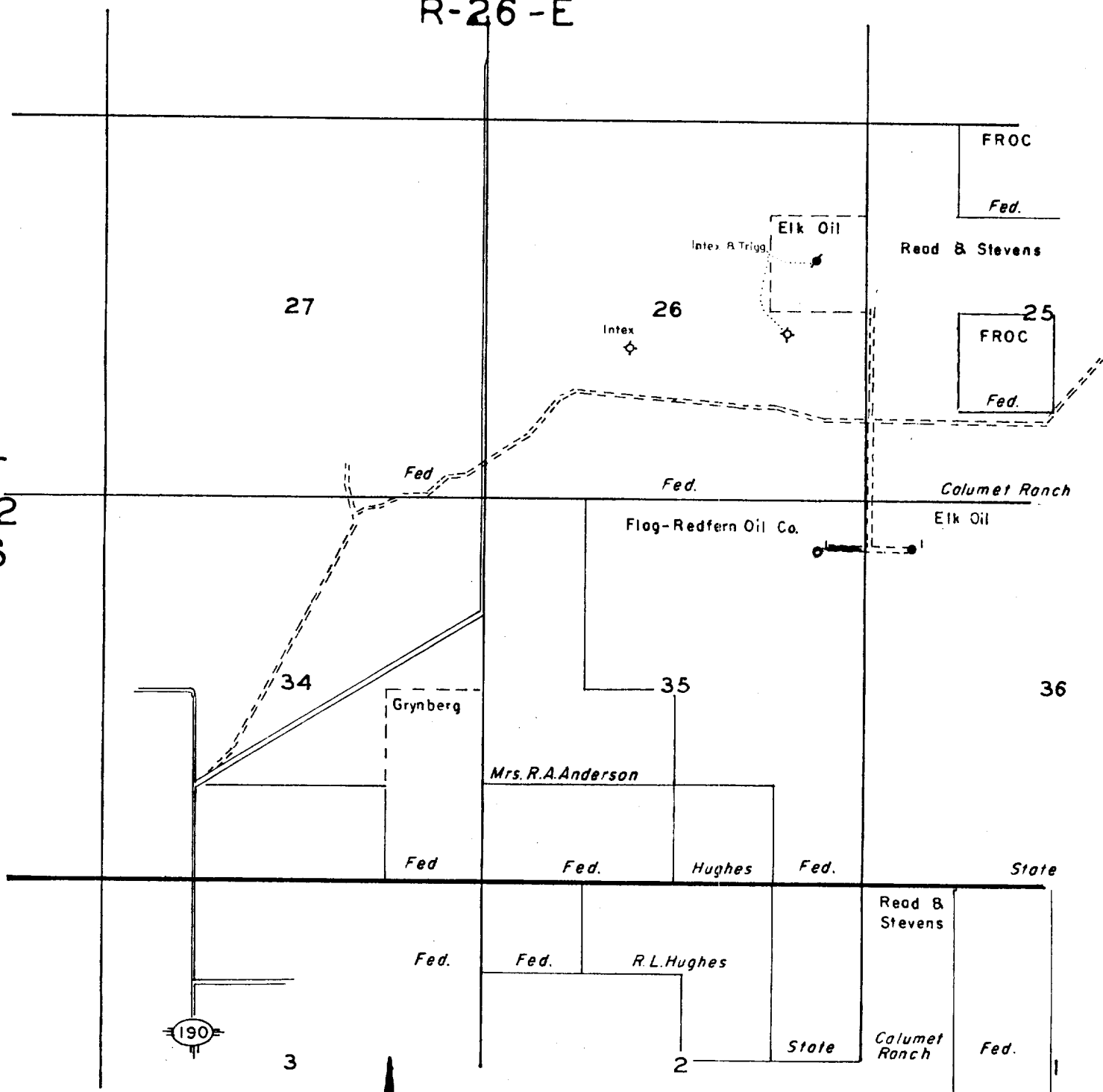

Flag-Redfern Oil Company

1200 WALL TOWERS WEST • MIDLAND, TEXAS 79702

P. O. BOX 23 • PHONE (915) 683-5184

AREA PLAT

Well No. 1-35 Fed

660' FN & EL, Sec. 35, T-12-S, R-26-E
Chaves County, New Mex.

Scale: 1"=2000'

8-17-77

RECEIVED

AUG 31 1977

**U.S. GEOLOGICAL SURVEY
ARTESIA, NEW MEXICO**

UNITED STATES
DEPARTMENT OF THE ARMY
CORPS OF ENGINEERS

(BOTTOMLESS LAKES)

17'30"

R 26 E R 2

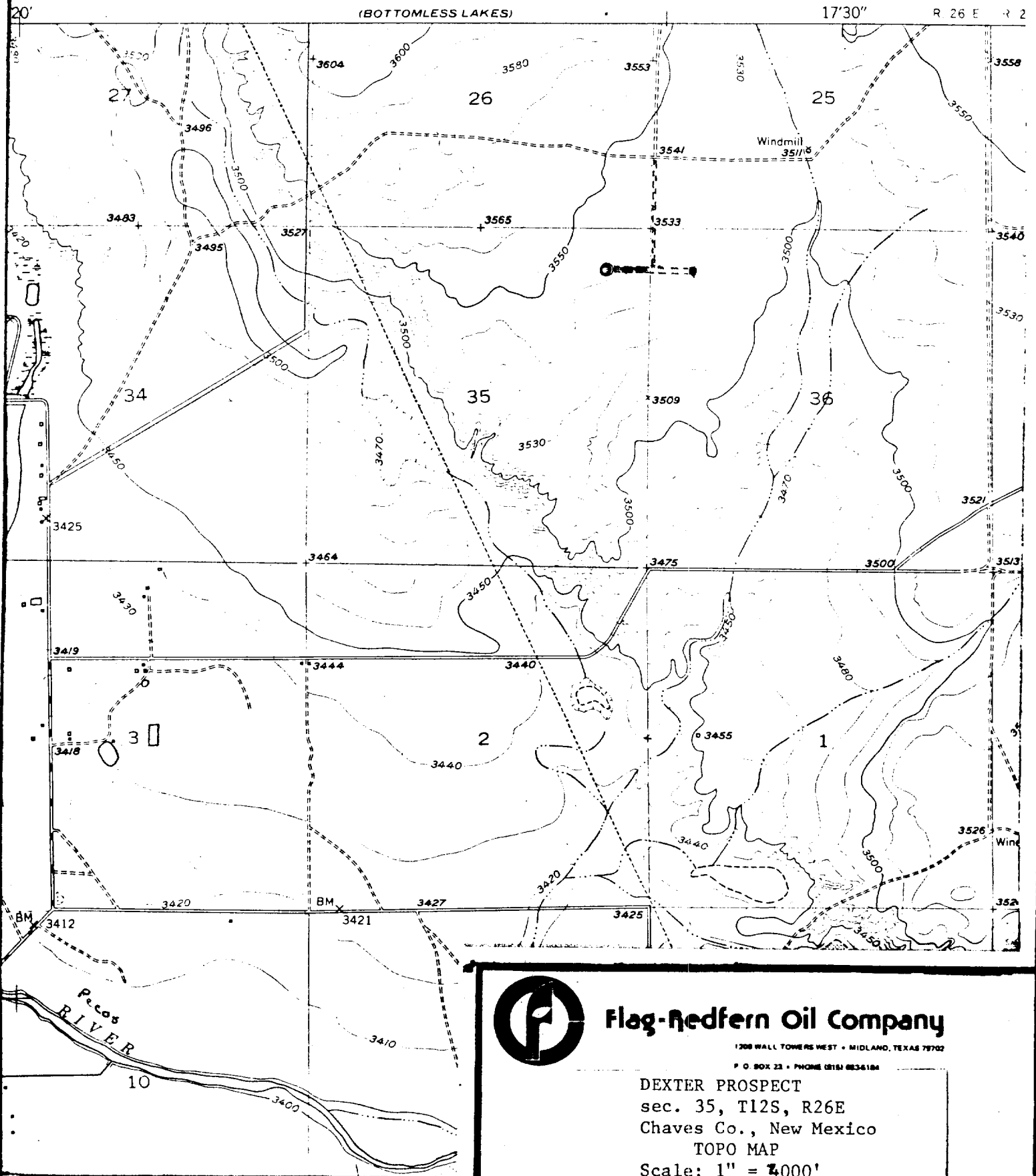

Flag-Redfern Oil Company

1208 WALL TOWERS WEST • MIDLAND, TEXAS 79702

P. O. BOX 22 • PHONE (817) 8536184

DEXTER PROSPECT
sec. 35, T12S, R26E
Chaves Co., New Mexico
TOPO MAP
Scale: 1" = 4000'

RECEIVED

AUG 31 1977

**U.S. GEOLOGICAL SURVEY
ARTESIA, NEW MEXICO**

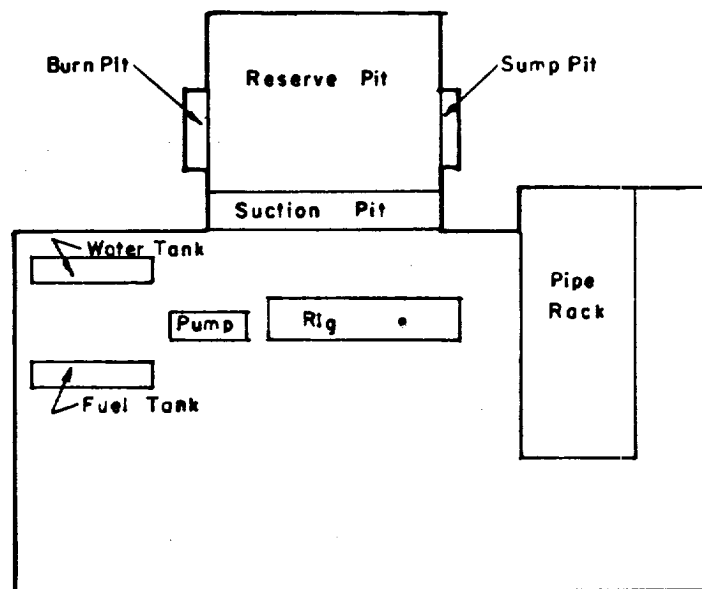

FLAG-REDFERN OIL CO.
MIDLAND, TEXAS

WELL SITE LAYOUT

Well No. 1 - 35 Fed.
660' FN & EL, Sec. 35, T-12-S, R-26-E
Chaves County, New Mexico

Scale: 1" = 50'

8-17-77