

DISTRIBUTION	5	
SANTA FE	/	
FILE	/	✓
U.S.G.S.	2	
LAND OFFICE		
OPERATOR	/	

NEW MEXICO OIL CONSERVATION COMMISSION

30-005-60485

Form C-101  
Revised 1-1-65

5A. Indicate Type of Lease  
STATE ☐ FEE ☒

5. State Oil & Gas Lease No.

APPLICATION FOR PERMIT TO DRILL, DEEPEN, OR PLUG BACK

1a. Type of Work		7. Unit Agreement Name	
b. Type of Well DRILL <input checked="" type="checkbox"/> DEEPEN <input type="checkbox"/> PLUG BACK <input type="checkbox"/> OIL WELL <input checked="" type="checkbox"/> GAS WELL <input type="checkbox"/> OTHER <input type="checkbox"/> SINGLE ZONE <input type="checkbox"/> MULTIPLE ZONE <input type="checkbox"/>		8. Firm or Lease Name <b>Sunshine</b>	
2. Name of Operator <b>Fred Pool, Jr.</b>		9. Well No. <b>1</b>	
3. Address of Operator <b>7 La Paloma, Roswell, N.M. 88201</b>		10. Field and Pool, or Wildcat <b>X Und. E. Chisum, S.A.</b>	
4. Location of Well UNIT LETTER <b>M-2</b> LOCATED <b>330 2310</b> FEET FROM THE <b># 5</b> LINE <b>2310 330</b> FEET FROM THE <b>S W</b> LINE OF SEC. <b>10</b> TWP. <b>11S</b> RGE. <b>28E</b> NMPM		12. County <b>Chaves</b>	
19. Proposed Depth <b>2300 ft.</b>		19A. Formation <b>S.A.</b>	20. Rotary or C.T. <b>C.T.</b>
21. Elevations (Show whether DT, RT, etc.) <b>3730.67</b>	21A. Kind & Status Plug. Bond <b>Blanket</b>	21B. Drilling Contractor <b>Fred Pool, Jr.</b>	22. Approx. Date Work will start <b>2-13-78</b>

23. PROPOSED CASING AND CEMENT PROGRAM

SIZE OF HOLE	SIZE OF CASING	WEIGHT PER FOOT	SETTING DEPTH	SACKS OF CEMENT	EST. TOP
10 1/2	8 5/8	23 #	300	125	circulated
8 "	4 1/2	9.5 #	2300	200	1500 ft.

Control head will be used for drilling in.

RECEIVED

APPROVAL VALID  
FOR 90 DAYS UNLESS  
DRILLING COMMENCED,

EXPIRES **5-8-78**

FEB 3 1978

O. C. C.  
ARTESIA, OFFICE

IN ABOVE SPACE DESCRIBE PROPOSED PROGRAM; IF PROPOSAL IS TO DEEPEN OR PLUG BACK, GIVE DATA ON PRESENT PRODUCTIVE ZONE AND PROPOSED NEW PRODUCTIVE ZONE. GIVE BLOWOUT PREVENTER PROGRAM, IF ANY.

I hereby certify that the information above is true and complete to the best of my knowledge and belief.

Signed *Fred Pool* Title Secretary Date 1-30-78

(This space for State Use)

APPROVED BY *W. A. Gressett* TITLE SUPERVISOR, DISTRICT II DATE FEB 8 1978

CONDITIONS OF APPROVAL, IF ANY:

## WELL LOCATION AND ACREAGE DEDICATION PLAT

Supersedes G-126  
Effective 1-1-65

All distances must be from the outer boundaries of the Section.

Operator <b>Fred Pool Drlg. Co.</b>		Lease <b>Sunshine</b>		Well No. <b>1</b>
Unit Letter <b>2</b>	Section <b>10</b>	Township <b>11 S</b>	Range <b>28 E</b>	County <b>Chaves</b>
Actual Footage Location of Well: <b>330</b> feet from the <b>west</b> line and <b>2310</b> feet from the <b>south</b> line				
Ground Level Elev. <b>3730.67</b>	Producing Formation <b>S.A.</b>	Pool <b>E.Chisum, Und.</b>	Dedicated Acreage: <b>40</b> Acres	

1. Outline the acreage dedicated to the subject well by colored pencil or hatchure marks on the plat below.
2. If more than one lease is dedicated to the well, outline each and identify the ownership thereof (both as to working interest and royalty).
3. If more than one lease of different ownership is dedicated to the well, have the interests of all owners been consolidated by communitization, unitization, force-pooling, etc?

☐ Yes ☐ No If answer is "yes," type of consolidation \_\_\_\_\_

If answer is "no," list the owners and tract descriptions which have actually been consolidated. (Use reverse side of this form if necessary.) \_\_\_\_\_

No allowable will be assigned to the well until all interests have been consolidated (by communitization, unitization, forced-pooling, or otherwise) or until a non-standard unit, eliminating such interests, has been approved by the Commission.

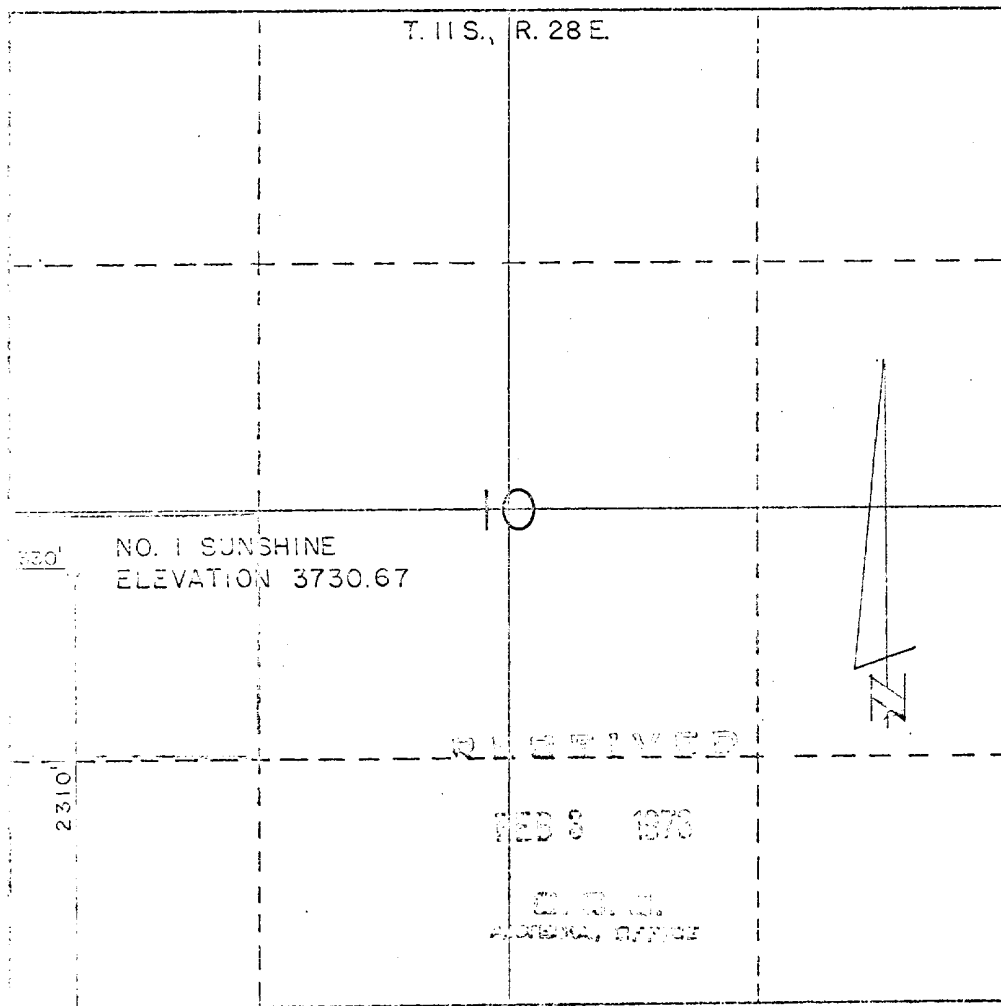

## CERTIFICATION

I hereby certify that the information contained herein is true and complete to the best of my knowledge and belief.

**Fred Pool, Jr.**  
**Fred Pool Drlg. Co.**

Name

Owner

Position

**Fred Pool Drlg. Co.**

Company

**1-30-78**

Date

I hereby certify that the well location shown on this plat was plotted from field notes of actual surveys made by me or under my supervision, and that the same is true and correct to the best of my knowledge and belief.

Date Surveyed

**1-6-78**

Registered Professional Engineer  
and/or Land Surveyor

**Thomas T. Mann, P.E.**

Certificate No.

**N.M. No. 277**