

NO. OF COPIES RECEIVED	6
DISTRIBUTION	
SANTA FE	1
FILE	1
U.S.G.S.	2
LAND OFFICE	1
OPERATOR	1

**RECEIVED**  
NEW MEXICO OIL CONSERVATION COMMISSION  
**APR 18 1978**

**O. C. C.**  
**ARTESIA, OFFICE**

30-005-60501

Form C-101  
Revised 1-1-65

5A. Indicate Type of Lease
STATE <input checked="" type="checkbox"/> FEE <input type="checkbox"/>
5. State Oil & Gas Lease No.
L-5259

**APPLICATION FOR PERMIT TO DRILL, DEEPEN, OR PLUG BACK**

1a. Type of Work			7. Unit Agreement Name		
b. Type of Well DRILL <input checked="" type="checkbox"/> DEEPEN <input type="checkbox"/> PLUG BACK <input type="checkbox"/> OIL WELL <input type="checkbox"/> GAS WELL <input checked="" type="checkbox"/> OTHER <input type="checkbox"/> SINGLE ZONE <input type="checkbox"/> MULTIPLE ZONE <input type="checkbox"/>			8. Farm or Lease Name		
2. Name of Operator			Sams-State Comm.		
3. Address of Operator			9. Well No.		
1100 Wall Towers West, Midland, TX 79701			2		
4. Location of Well			10. Field and Section		
UNIT LETTER D LOCATED 660 FEET FROM THE north LINE			Undesignated		
AND 660 FEET FROM THE west LINE OF SEC. 16 TWP. 14-S RGE. 28-E NMDM			Sams Ranch (Grayburg)		
11. Proposed Depth			19A. Formation		20. Rotary or C.T.
1800			Premier Sand		Rotary
21. Elevations (Show whether DR, RT, etc.)		21A. Kind & Status Plug. Bond	21B. Drilling Contractor		22. Approx. Date Work will start
3571.3' GR		Blanket	Artesia Fishing Tool (LaRue & Muncy)		5-10-78

23.

**PROPOSED CASING AND CEMENT PROGRAM**

SIZE OF HOLE	SIZE OF CASING	WEIGHT PER FOOT	SETTING DEPTH	SACKS OF CEMENT	EST. TOP
11"	8 5/8"	24#	250	150	Circ.
7 7/8"	5 1/2"	14#	1700	270	Circ.

Set 8 5/8" csg. @ 250'. Circ. cement. Install shaffer, Type F ser. 900 manually operated double BOP with blank and pipe rams. Drill 7 7/8" hole to 1700' or to immediately above top of Premier Sand. Set 5 1/2" csg, circ. cement. Install BOP and rotating head. Go in hole w/bit on 2 3/8" tbq. Drill 4 3/4" hole to 1800', complete well open hole 1700-1800'.

Drilling Contractor: Artesia Fishing Tool Co. (LaRue & Muncy)  
Artesia, NM

APPROVAL VALID  
FOR 90 DAYS UNLESS  
DRILLING COMMENCED,

Gas is not dedicated.

EXPIRES 7-19-78

IN ABOVE SPACE DESCRIBE PROPOSED PROGRAM: IF PROPOSAL IS TO DEEPEN OR PLUG BACK, GIVE DATA ON PRESENT PRODUCTIVE ZONE AND PROPOSED NEW PRODUCTIVE ZONE. GIVE BLOWOUT PREVENTER PROGRAM, IF ANY.

I hereby certify that the information above is true and complete to the best of my knowledge and belief.

Signed C. Harvey Carr Title District Engineer Date April 17, 1978

(This space for State Use)

APPROVED BY W. R. Gressett TITLE SUPERVISOR, DISTRICT II DATE APR 18 1978

CONDITIONS OF APPROVAL, IF ANY:

N' MEXICO OIL CONSERVATION COMMISSION  
WELL LOCATION AND ACREAGE DEDICATION PLAT

Form C-102  
Supersedes C-128  
Effective 1-1-65

All distances must be from the outer boundaries of the Section.

Operator <b>Southland Royalty Co.</b>			Lease <b>Sam State Com.</b>		Well No. <b>2</b>
Unit Letter <b>D</b>	Section <b>16</b>	Township <b>14 South</b>	Range <b>28 East</b>	County <b>Chaves</b>	
Actual Footage Location of Well: <b>660</b> feet from the <b>North</b> line and <b>660</b> feet from the <b>West</b> line					
Ground Level Elev. <b>3571.3</b>	Producing Formation <b>Premier Sand</b>		Pool <b>Undesignated (Sams Ranch-Grayburg)</b>	Dedicated Acreage: <b>160</b> Acres	

1. Outline the acreage dedicated to the subject well by colored pencil or hatchure marks on the plat below.
2. If more than one lease is dedicated to the well, outline each and identify the ownership thereof (both as to working interest and royalty).
3. If more than one lease of different ownership is dedicated to the well, have the interests of all owners been consolidated by communitization, unitization, force-pooling, etc?

☒ Yes ☐ No If answer is "yes," type of consolidation Communitized

If answer is "no," list the owners and tract descriptions which have actually been consolidated. (Use reverse side of this form if necessary.)

No allowable will be assigned to the well until all interests have been consolidated (by communitization, unitization, forced-pooling, or otherwise) or until a non-standard unit, eliminating such interests, has been approved by the Commission.

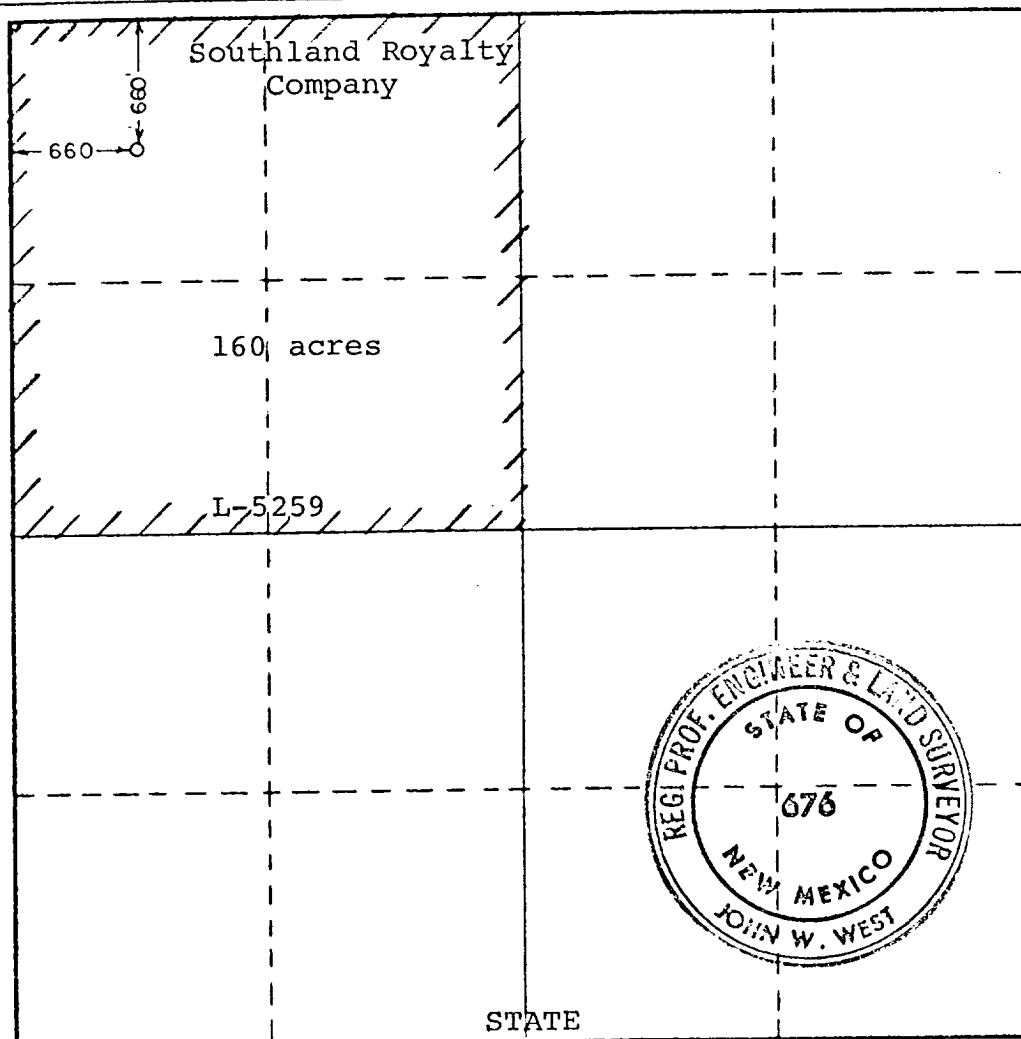

CERTIFICATION

I hereby certify that the information contained herein is true and complete to the best of my knowledge and belief.

Name  
*C. Harvey Carr*  
Position  
**District Engineer**  
Company  
**Southland Royalty Co.**  
Date  
**April 17, 1978**

I hereby certify that the well location shown on this plat was plotted from field notes of actual surveys made by me or under my supervision, and that the same is true and correct to the best of my knowledge and belief.

**4/5/78**

Date Surveyed  
Registered Professional Engineer and/or Land Surveyor

*John W. West*  
Certificate No. **John W. West 676**

**Ronald J. Eidson 3239**

