

MOCC COPY
UNITED STATES
DEPARTMENT OF THE INTERIOR
GEOLOGICAL SURVEYSUBMIT IN TRIPLICATE*
(Other instructions on reverse side)Form approved.
Budget Bureau No. 42-R1425.

30-005-60506

APPLICATION FOR PERMIT TO DRILL, DEEPEN, OR PLUG BACK

1a. TYPE OF WORK

DRILL ☒DEEPEN ☐PLUG BACK ☐

b. TYPE OF WELL

OIL WELL ☐GAS WELL ☒OTHER ☐MULTIPLE ZONE ☐

2. NAME OF OPERATOR

McClellan Oil Corporation

3. ADDRESS OF OPERATOR

P.O. Box 848, Roswell, NM 88201

4. LOCATION OF WELL (Report location clearly and in accordance with any State requirements.)
At surface

At proposed prod. zone

660' FSL & 1980' FWL

JUN - 2 1978

14. DISTANCE IN MILES AND DIRECTION FROM NEAREST TOWN OR POST OFFICE*

14 miles east of Hagerman, N.M.

O.C.C.

10. DISTANCE FROM PROPOSED*

LOCATION TO NEAREST
PROPERTY OR LEASE LINE, FT.
(Also to nearest drg. unit line, if any)

660'

16. NO. OF ACRES ASSIGNED TO THIS WELL

1200

18. DISTANCE FROM PROPOSED LOCATION*
TO NEAREST WELL, DRILLING, COMPLETED,
OR APPLIED FOR, ON THIS LEASE, FT.

1320'

19. PROPOSED DEPTH

1850'

20. ROTARY OR CABLE TOOLS

Cable Tools

21. ELEVATIONS (Show whether DF, RT, GR, etc.)

3594' G.L.

22. APPROX. DATE WORK WILL START*

23. PROPOSED CASING AND CEMENTING PROGRAM

SIZE OF HOLE	SIZE OF CASING	WEIGHT PER FOOT	SETTING DEPTH	QUANTITY OF CEMENT
10-3/4"	8-5/8"	24 lb.	550'	100 sx.
8"	4 1/2"	9 1/2 lb.	1850'	100 sx.

Propose to drill to a T.D. of 1850' to test the Premier sand of the Grayburg formation. If production is indicated, will set casing and attempt completion. Cable tools will be used. Cortez Drilling Company of Roswell, New Mexico is the contractor.

Gas not dedicated!

IN ABOVE SPACE DESCRIBE PROPOSED PROGRAM: If proposal is to deepen or plug back, give data on present productive zone and proposed new productive zone. If proposal is to drill or deepen directionally, give pertinent data on subsurface locations and measured and true vertical depths. Give blowout preventer program, if any.

24.

SIGNED

J. J. McClane

TITLE

Operator

DATE

5/1/78

(This space for Federal or State office use)

PERMIT NO.

APPROVAL DATE

JUN 1 - 1978

APPROVED BY

J. J. Lara

TITLE

ACTING DISTRICT ENGINEER

DATE

JUN 1 - 1978

CONDITIONS OF APPROVAL, IF ANY:

THIS APPROVAL IS RESCINDED IF OPERATIONS
ARE NOT COMMENCED WITHIN 3 MONTHS.

EXPIRES SEP. 1 - 1978

*See Instructions On Reverse Side

N MEXICO OIL CONSERVATION COMMISS
WELL LOCATION AND ACREAGE DEDICATION PLAT

Form C-128
Supersedes C-128
Effective 1-1-65

All distances must be from the outer boundaries of the Section

Operator McClellan Oil Corp.			Lease McClellan Federal		Well No. 11
Unit Letter N	Section 11	Township 14 South	Range 28 East	County Chaves	
Actual Footage Location of Well: 660 feet from the South line and 1980 feet from the West line					
Ground Level Elev. 3594.1	Producing Formation Premier (Grayburg)		Pool Same Ranch Bl. Undesignated	Dedicated Acreage 160 Acres	

1. Outline the acreage dedicated to the subject well by colored pencil or hachure marks on the plat below.
2. If more than one lease is dedicated to the well, outline each and identify the ownership thereof (both as to working interest and royalty).
3. If more than one lease of different ownership is dedicated to the well, have the interests of all owners be consolidated by communitization, unitization, force-pooling, etc?

☐ Yes ☐ No If answer is "yes," type of consolidation _____

If answer is "no," list the owners and tract descriptions which have actually been consolidated. (Use reverse side of this form if necessary.) _____

No allowable will be assigned to the well until all interests have been consolidated (by communitization, unitization, forced-pooling, or otherwise) or until a non-standard unit, eliminating such interests, has been approved by the Commission.

RECEIVED
MAY 4 1978
U.S. GEOLOGICAL SURVEY
ARTESIA, NEW MEXICO

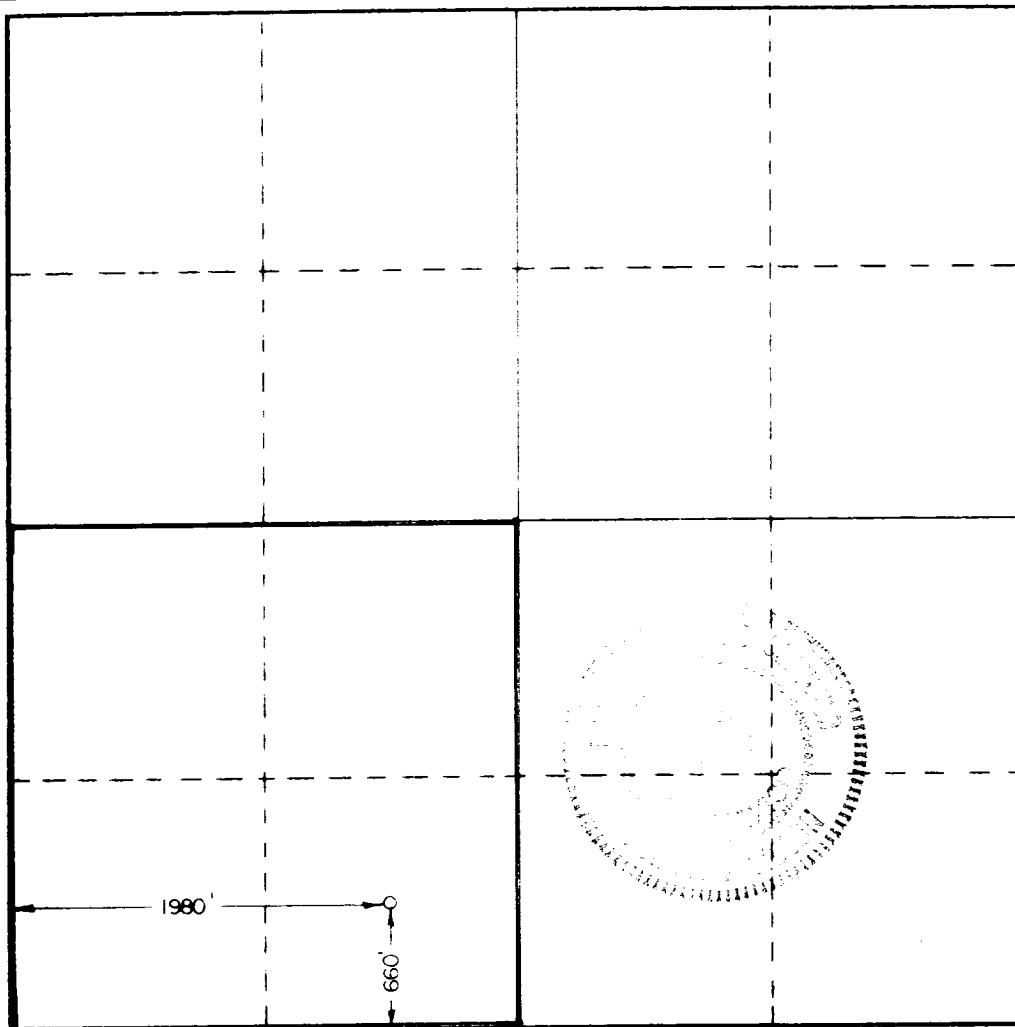

CERTIFICATION

I hereby certify that the information contained herein is true and complete to the best of my knowledge and belief.

Jack L. McClellan
Name
Jack L. McClellan
Position
President
Company
McClellan Oil Corporation

Date
May 1, 1978

I hereby certify that the well location shown on this plat was plotted from field notes of actual surveys made by me or under my supervision, and that the same is true and correct to the best of my knowledge and belief.

Date Surveyed
4/1/78

Registered Professional Engineer and/or Land Surveyor

Ronald J. Eidson
Certificate No. **John W. West 676**
Ronald J. Eidson 3239

SURFACE USE PLAN

RECEIVED

MAY 4 1978

U.S. GEOLOGICAL SURVEY
ARTESIA, NEW MEXICO

SURFACE USE PLAN

McClellan Oil Corporation McClellan Federal No. 14
660' FSL & 1980' FWL Section 11-T14S-R28E
Chaves County, New Mexico
Federal Lease NM 2581

1. Existing Roads
Exhibit "A" is a portion of the Chaves County road map of the New Mexico State Highway Department, showing the proposed well site in relation to nearby highways and ranch-oil field roads. State Highway 31 will be used for 13 miles from Hagerman to the ranch road. This highway is maintained by the State of New Mexico. The oil field-ranch road will be used for approximately $3\frac{1}{2}$ miles. This road is constructed of caliche, is approximately 12' to 25' in width and is maintained by ranchers and oil operators who utilize this road. All roads and highways to be used are marked in yellow and the proposed well site and nearby towns are marked in red.
2. Planned Access Road
Exhibit "B" shows the ranch and oil field roads. The new road to be constructed is marked in red and is approximately 100' in length. This road will be 12' wide and caliched, as the ground is sandy. Existing gates and cattleguards will be utilized. All existing fences will be left intact.
3. Location of Existing Wells
Exhibit "C" shows all of the producing wells within 2 miles of the proposed test with ownership of various tracts.
4. Location of Tank Battery, Production Facilities & Production Gathering & Service Lines
If gas production is achieved the location of the line will be determined by the purchaser laying in the gathering system to his existing gas lines. The approximate location of the Phillips gas line is depicted on Exhibit "D".
5. Location and Type of Water Supply
There is no useable water in this area. All water needed for drilling, testing, and completion will be trucked in by a commercial transport on existing roads as shown on Exhibit "A".
6. Source of Construction Materials
This will be a cable tool drilling operation and it will be necessary to construct roads and location with caliche topping. Caliche will be obtained from the pit to be used in the drilling operation as indicated on Exhibit "B" and marked in red.
7. Handling of Waste Disposal
All waste material remaining after the drilling of this well will be placed in mud pit as shown on Exhibit "D". Any combustible or biochemically degradable material will be placed in the "burn and trash pit".

8. Ancillary Facilities
No ancillary facilities are planned.

9. Well Site Layout
This information is shown on Exhibit "D". The pits will not be lined, as this is a cable tool operation and only cuttings will be dumped in the pit.

10. Plan for Restoration of Surface
All pits will be filled in and levelled. Deadmen will be removed. The access road and location will be restored as near as possible to its natural state following instructions from appropriate governmental agency, if well is abandoned, otherwise the location will be cleared and maintained in an orderly manner.

11. Other Information
The well site is in a developing gas producing area. No unusual topography exists on this proposed well site and roads and is offset by either producing gas wells or dry holes.

12. Operator Representatives

C. V. Miller	1106 Yates, Artesia, N.M. 88210 Mobile Unit 236 (Dial 748-1366)	746-3668
--------------	--	----------

Cleo Brown	1808 Booker, Artesia, N.M. 88210 Mobile Unit 235 (Dial 748-1366)	748-2228
------------	---	----------

Jack L. McClellan	3106 North Montana, Roswell, N.M. 88201	622-3200 or 622-4076
-------------------	---	----------------------

13. Certification
I certify that I, or persons under my direct supervision, have inspected the proposed dirll site and access route; that I am familiar with the conditions which presently exist; that the statements made in this plan are, to the best of my knowledge, true and correct; and that the work associated with the operations proposed herein will be performed by McClellan Oil Corporation and its contractors and subcontractors in conformity with this plan and the terms and conditions under which it is approved.

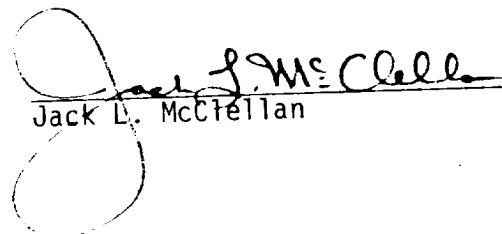

Jack L. McClellan

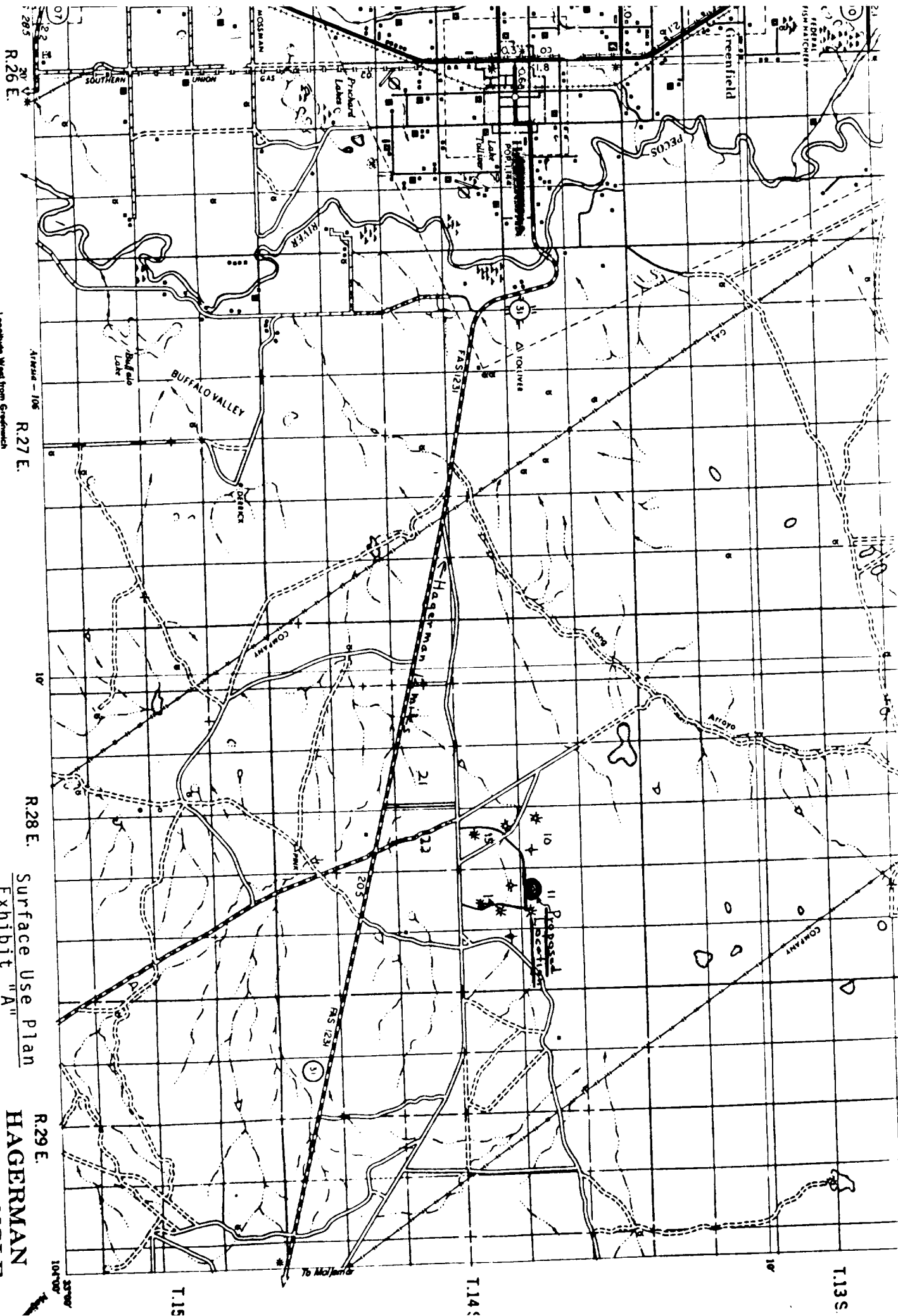

Longitudes West from Greenwich

Scale 1 inch = 2 Miles



1966

Surface Use Plan
Exhibit "A"

McClellan Oil Corp.
McClellan Fed. No. 71
Section 11, T14S, R28E
Chaves Co. New Mexico

HAGERMAN
QUADRANGLE
94

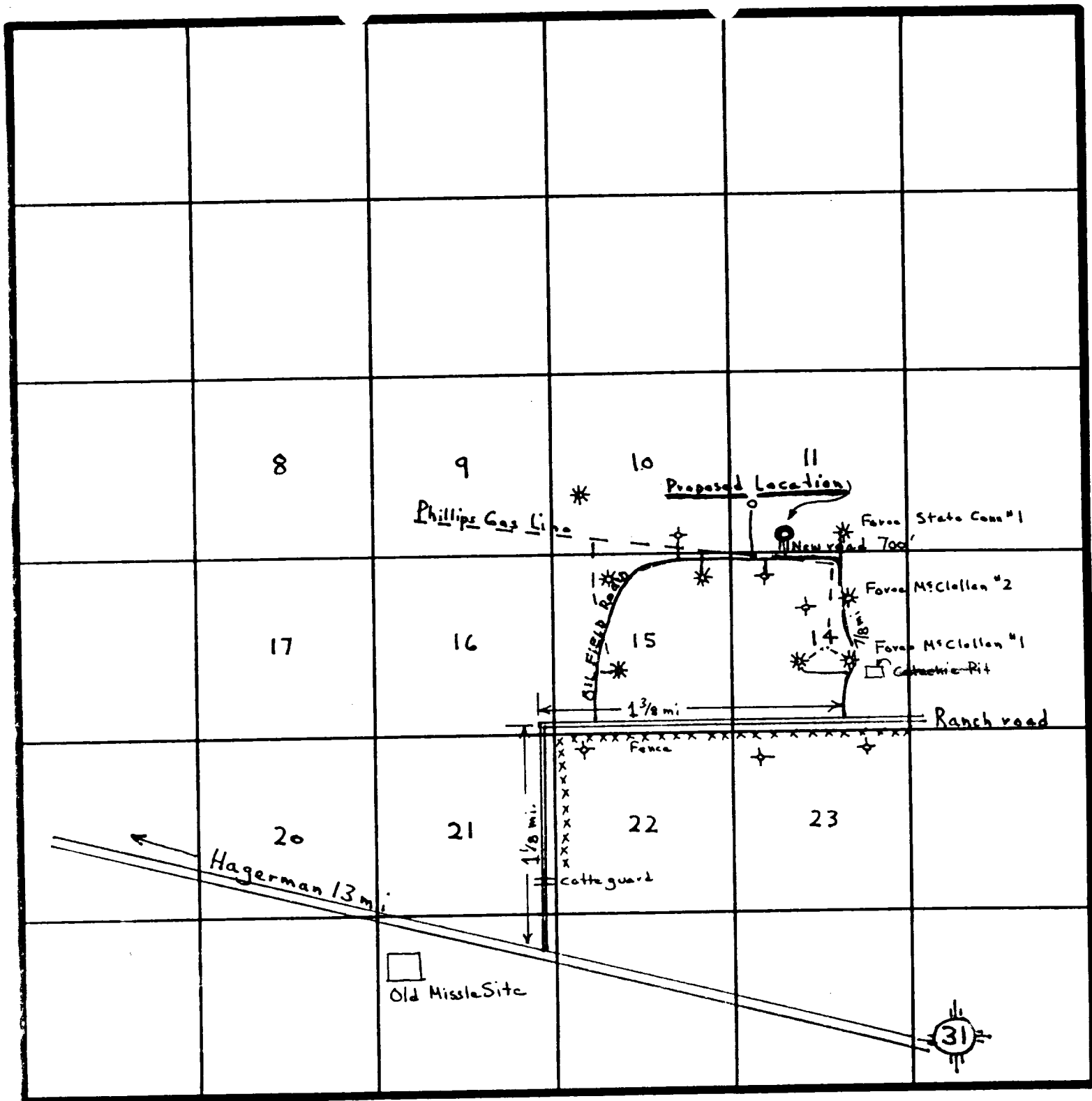

County Chaves State New Mexico

Section 11 Township 14-S Range 28-E

Remarks:

Surface Use Plan-Exhibit "B"
 McClellan Oil Corp.
 McClellan Fed.No. 71
 Chaves Co. New Mexico

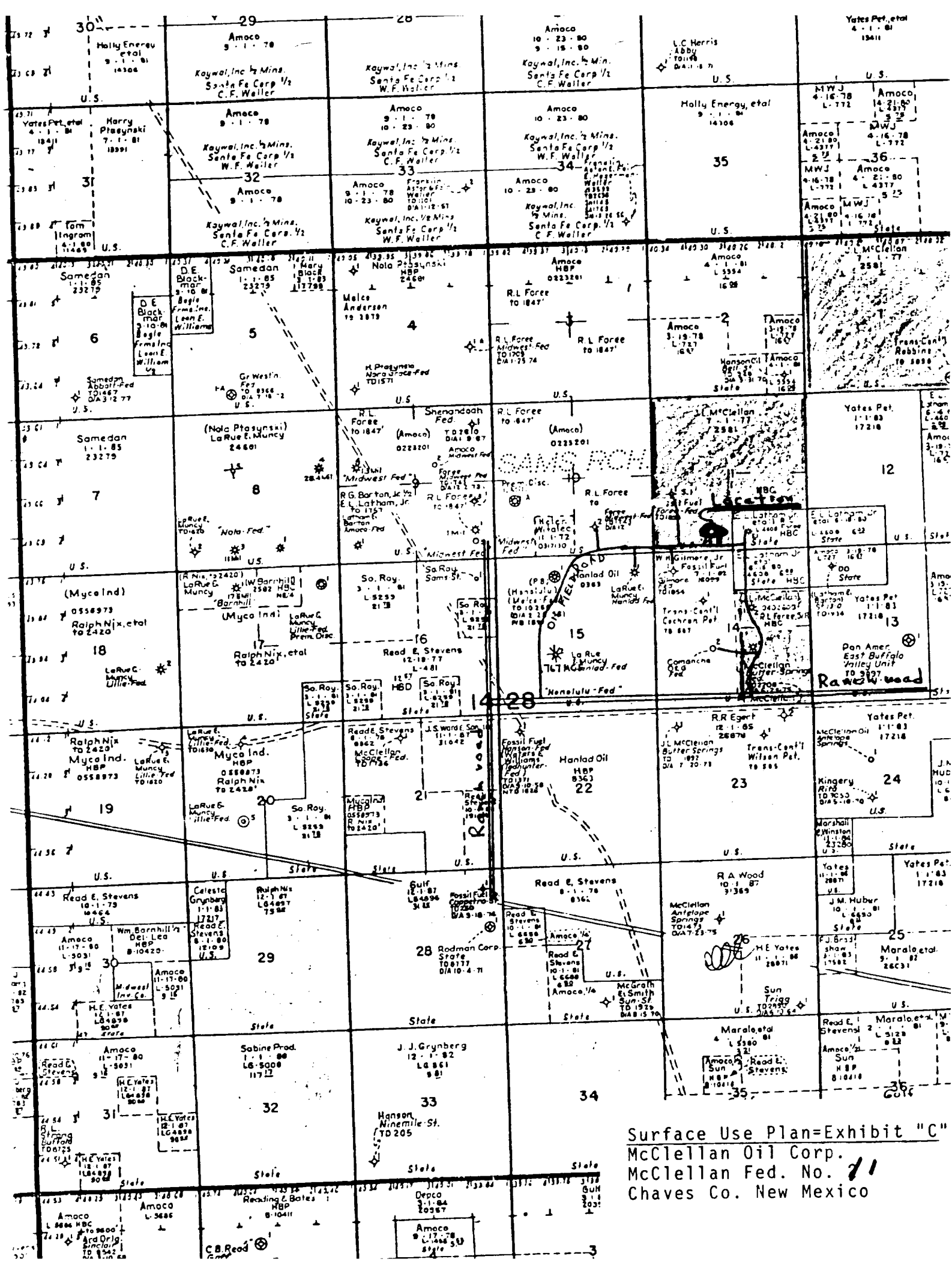



McClellan Oil Corporation

Box 848

Roswell, New Mexico 88201

WELL McClellan Fed. No. 1
LOCATION 660'FS & 1980'FW

N

Surface Use Plan-Exhibit "D"
McClellan Oil Corp.
McClellan Fed. No.2
Chaves Co. New Mexico

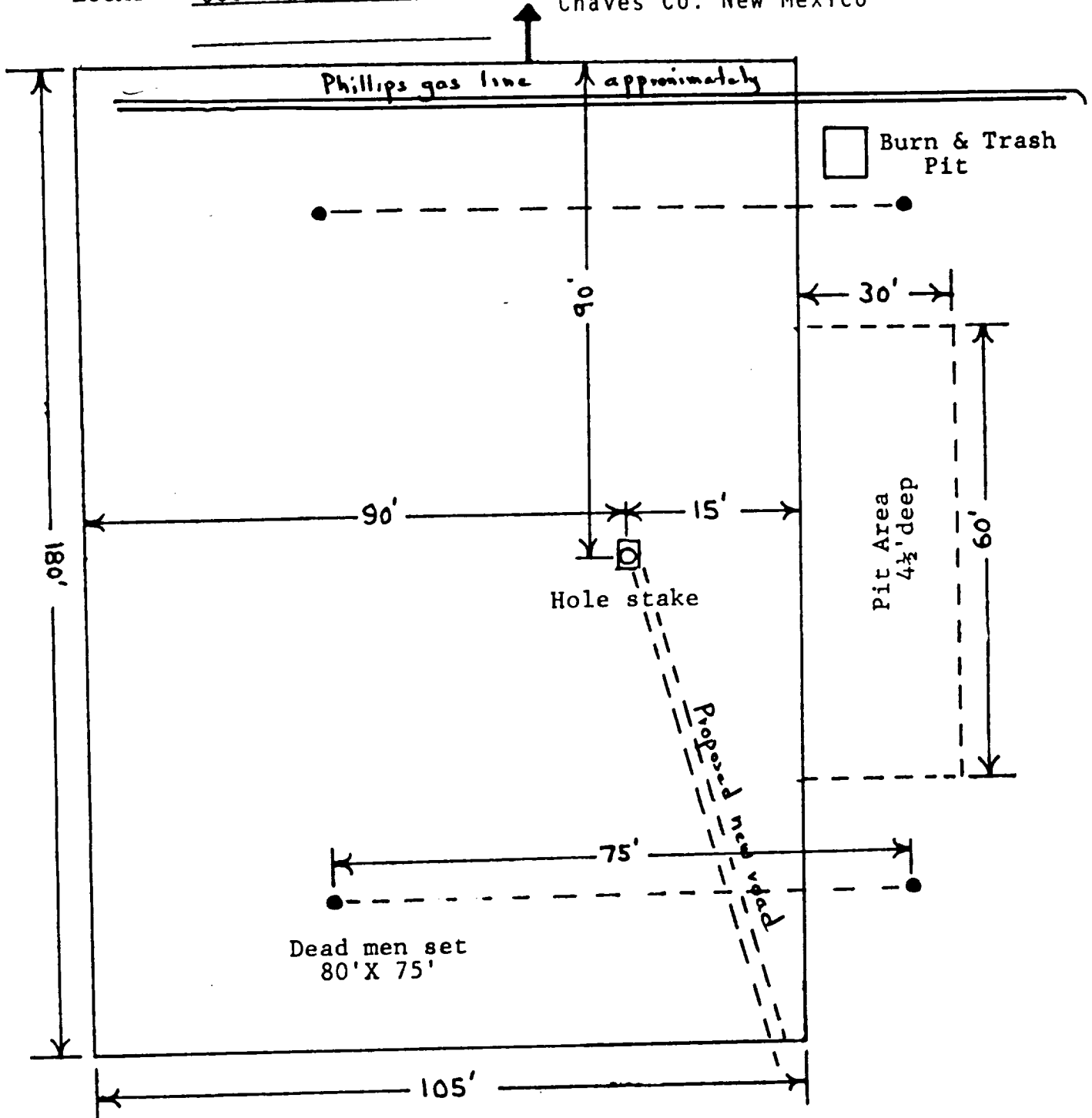

CABLE TOOL LOCATION PLAT