

NO. OF COPIES RECEIVED	6
DISTRIBUTION	
SANTA FE	1
FILE	1
U.S.G.S.	2
LAND OFFICE	1
OPERATOR	1

NEW MEXICO OIL CONSERVATION COMMISSION

RECEIVED

30-005-60533
Form C-101
Revised 1-1-65

DEC - 1 1978

O. C. C.
ARTESIA, OFFICE

5A. Indicate Type of Lease

STATE ☒ FEE ☐

5. State Oil & Gas Lease No.

K-2803

APPLICATION FOR PERMIT TO DRILL, DEEPEN, OR PLUG BACK

1a. Type of Work DRILL <input checked="" type="checkbox"/> DEEPEN <input type="checkbox"/> PLUG BACK <input type="checkbox"/>		7. Unit Agreement Name
b. Type of Well OIL WELL <input checked="" type="checkbox"/> GAS WELL <input type="checkbox"/> OTHER <input type="checkbox"/> SINGLE ZONE <input checked="" type="checkbox"/> MULTIPLE ZONE <input type="checkbox"/>		8. Farm or Lease Name Citgo-State
2. Name of Operator Stevens Oil Company		9. Well No. 5
3. Address of Operator P. O. Box 2203 - Roswell, New Mexico 88201		10. Field and Pool, or Wildcat Twin Lakes-San Andres
4. Location of Well UNIT LETTER I LOCATED 1650 FEET FROM THE South LINE AND 990 FEET FROM THE East LINE OF SEC. 36 TWP. 8-S RGE. 28-E NMPM		12. County Chaves
19. Proposed Depth 2700'		19A. Formation San Andres
20. Rotary or C.T. Rotary		
21. Elevations (Show whether DF, RT, etc.) 3956.4 GR, 3962.4 KB	21A. Kind & Status Plug. Bond Statewide	21B. Drilling Contractor Fred Pool
22. Approx. Date Work will start 12-6-78		

23.

PROPOSED CASING AND CEMENT PROGRAM

SIZE OF HOLE	SIZE OF CASING	WEIGHT PER FOOT	SETTING DEPTH	SACKS OF CEMENT	EST. TOP
12-1/2"	8-5/8"	28#	40'	2 yards	Circ.
7-7/8"	4-1/2"	9.5#	2700'	200 sax	1900'

Will drill with water & mud to T.D., log, and if indicated productive, case to T.D., & perforate in producing interval.

Adequate blowout preventers will be used.

APPROVAL VALID
FOR 90 DAYS UNLESS
DRILLING COMMENCED,
EXPIRES 3-4-79

IN ABOVE SPACE DESCRIBE PROPOSED PROGRAM; IF PROPOSAL IS TO DEEPEN OR PLUG BACK, GIVE DATA ON PRESENT PRODUCTIVE ZONE AND PROPOSED NEW PRODUCTIVE ZONE. GIVE BLOWOUT PREVENTER PROGRAM, IF ANY.

I hereby certify that the information above is true and complete to the best of my knowledge and belief.

Signed Donald G. Steen Title Owner Date 11-30-78

(This space for State Use)

APPROVED BY W. A. Gressitt TITLE SUPERVISOR, DISTRICT II DATE DEC - 4 1978

CONDITIONS OF APPROVAL, IF ANY:

**NEW MEXICO OIL CONSERVATION COMMISSION
WELL LOCATION AND ACREAGE DEDICATION PLAT**

Form C-102
Supersedes C-128
Effective 1-1-65

All distances must be from the outer boundaries of the Section

Operator Stevens Oil Co.			Lease Citgo State		Well No. 5
Tract Letter 1	Section 36	Township 8 South	Range 28 East	County Chaves	
Actual Portage Location of Well: 1650 feet from the South line and 990 feet from the East line					
Ground Level Elev. 3956.4	Producing Formation San Andres	Pool Twin Lakes	Dedicated Acreage: 40 Acres		

1. Outline the acreage dedicated to the subject well by colored pencil or hachure marks on the plat below.
2. If more than one lease is dedicated to the well, outline each and identify the ownership thereof (both as to working interest and royalty).
3. If more than one lease of different ownership is dedicated to the well, have the interests of all owners been consolidated by communitization, unitization, force-pooling, etc?

☐ Yes ☐ No If answer is "yes," type of consolidation _____

If answer is "no," list the owners and tract descriptions which have actually been consolidated. (Use reverse side of this form if necessary.) _____

No allowable will be assigned to the well until all interests have been consolidated (by communitization, unitization, forced-pooling, or otherwise) or until a non-standard unit, eliminating such interests, has been approved by the Commission.

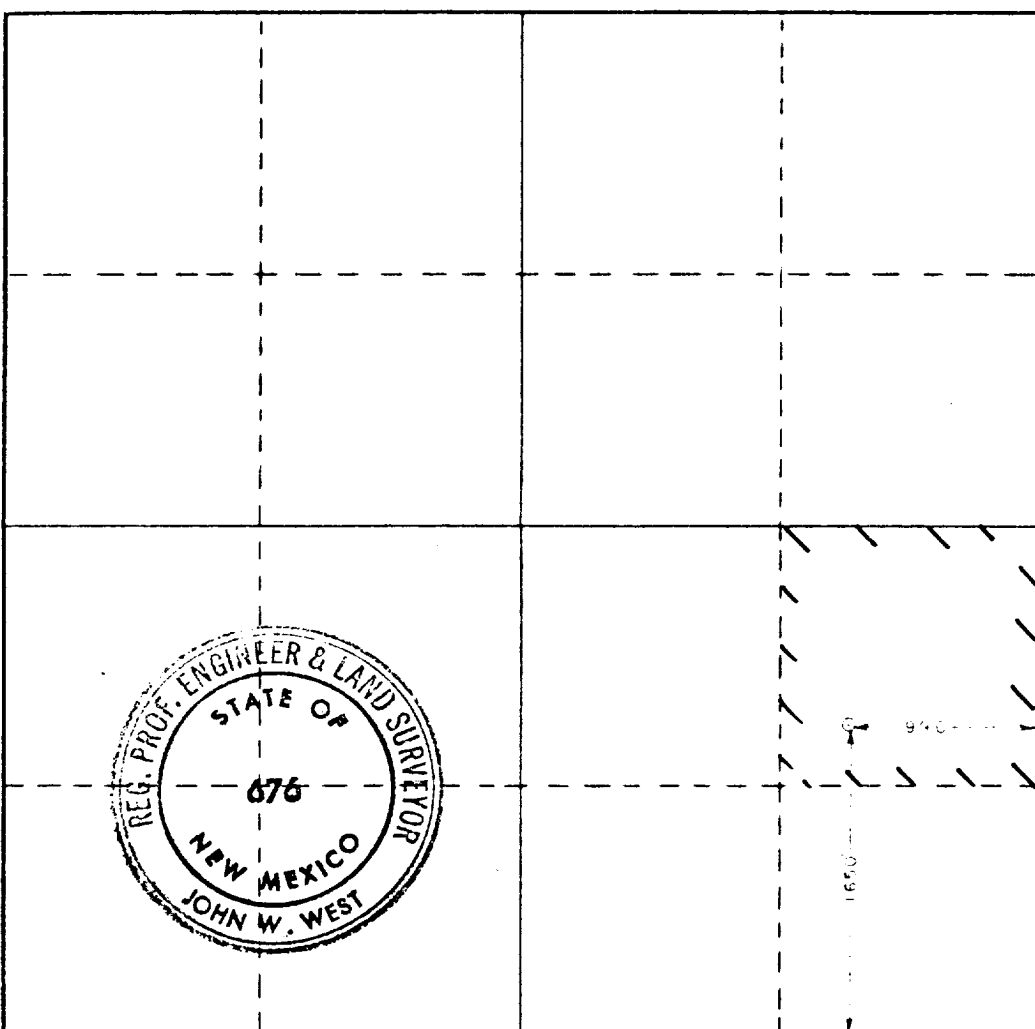

CERTIFICATION

I hereby certify that the information contained herein is true and complete to the best of my knowledge and belief.

Name Donald G. Steen
 Position Owner
 Company Stevens Oil Company
 Date 11-30-78

I hereby certify that the well location shown on this plat was plotted from field notes of actual surveys made by me or under my supervision, and that the same is true and correct to the best of my knowledge and belief.

Date Surveyed November 9, 1978
 Registered Professional Engineer and/or Land Surveyor

John W. West
 Certificate No. John W. West 676
Ronald J. Eidson 3239

