

NO. OF COPIES RECEIVED	6
DISTRIBUTION	
SANTA FE	1
FILE	1
U.S.G.S.	2
LAND OFFICE	1
OPERATOR	1

RECEIVED
 NEW MEXICO OIL CONSERVATION COMMISSION
 DEC 15 1978
O. C. C.
 ARTESIA, OFFICE

30-005-60534

Form C-101
 Revised 1-1-65

5A. Indicate Type of Lease	
STATE <input checked="" type="checkbox"/>	FEE <input type="checkbox"/>
5. State Oil & Gas Lease No.	
LG-1442	

APPLICATION FOR PERMIT TO DRILL, DEEPEN, OR PLUG BACK

1a. Type of Work				7. Unit Agreement Name	
b. Type of Well DRILL <input checked="" type="checkbox"/> DEEPEN <input type="checkbox"/> PLUG BACK <input type="checkbox"/> OIL WELL <input checked="" type="checkbox"/> GAS WELL <input type="checkbox"/> OTHER <input type="checkbox"/> SINGLE ZONE <input type="checkbox"/> MULTIPLE ZONE <input type="checkbox"/>				8. Farm or Lease Name	
2. Name of Operator McClellan Oil Corporation ✓				9. Well No. 1	
3. Address of Operator P. O. Box 848, Roswell, New Mexico 88201				10. Field and Pool, or Wildcat Undes. Double L Queen	
4. Location of Well UNIT LETTER <u>N</u> LOCATED <u>330</u> FEET FROM THE <u>South</u> LINE AND <u>1980</u> FEET FROM THE <u>West</u> LINE OF SEC. <u>13</u> TWP. <u>14-S</u> RGE. <u>29-E</u> NMPM				12. County Chaves	
21. Elevations (Show whether DF, RT, etc.)				22. Approx. Date Work will start	
21A. Kind & Status Plug. Bond Statewide		21B. Drilling Contractor Cortez Drilling Co.		Dec. 18, 1978	

PROPOSED CASING AND CEMENT PROGRAM

SIZE OF HOLE	SIZE OF CASING	WEIGHT PER FOOT	SETTING DEPTH	SACKS OF CEMENT	EST. TOP
10"	8 5/8"	20 lbs.	400'	275 sx	Circ.
8"	4 1/2"	9 1/2 lbs.	1950'	200 sx	1200'

Propose to drill to a depth of 1950' to test the Queen Sand.
 If production is indicated, will run casing & attempt completion.

Cortez Drilling Company, P. O. Box 848, Roswell, NM 88201
 will be the drilling contractor.

APPROVAL VALID
 FOR 90 DAYS UNLESS
 DRILLING COMMENCED,

EXPIRES 3-18-79

IN ABOVE SPACE DESCRIBE PROPOSED PROGRAM: IF PROPOSAL IS TO DEEPEN OR PLUG BACK, GIVE DATA ON PRESENT PRODUCTIVE ZONE AND PROPOSED NEW PRODUCTIVE ZONE. GIVE BLOWOUT PREVENTER PROGRAM, IF ANY.

I hereby certify that the information above is true and complete to the best of my knowledge and belief.

Signed James J. McClellan Title Operator Date 12/15/78

(This space for State Use)

APPROVED BY W. A. Gressett TITLE SUPERVISOR, DISTRICT II DATE DEC 18 1978

CONDITIONS OF APPROVAL, IF ANY:

NEW MEXICO OIL CONSERVATION COMMISSION
WELL LOCATION AND ACREAGE DEDICATION PLAT

Form 7-72
Supersedes C-128
Effective 1-1-65

All distances must be from the outer boundaries of the Section

Mc Clellan Oil Corp.			Marlisue "A"		Well No. 1
N	13	14 South	29 East	Chaves	

330	feet from the	South	line and	1980	feet from the	West	line
Ground Level Elev.	Producing Formation		Pool		Dedicated Acreage		
	Queen Sand		Undesq. Double L Queen Assoc.		40		

1. Outline the acreage dedicated to the subject well by colored pencil or hatchure marks on the plat below.
2. If more than one lease is dedicated to the well, outline each and identify the ownership thereof (both as to working interest and royalty).
3. If more than one lease of different ownership is dedicated to the well, have the interests of all owners been consolidated by communitization, unitization, force-pooling, etc?

☐ Yes ☐ No If answer is "yes," type of consolidation _____

If answer is "no," list the owners and tract descriptions which have actually been consolidated. (Use reverse side of this form if necessary.) _____

No allowable will be assigned to the well until all interests have been consolidated (by communitization, unitization, forced-pooling, or otherwise) or until a non-standard unit, eliminating such interests, has been approved by the Commission.

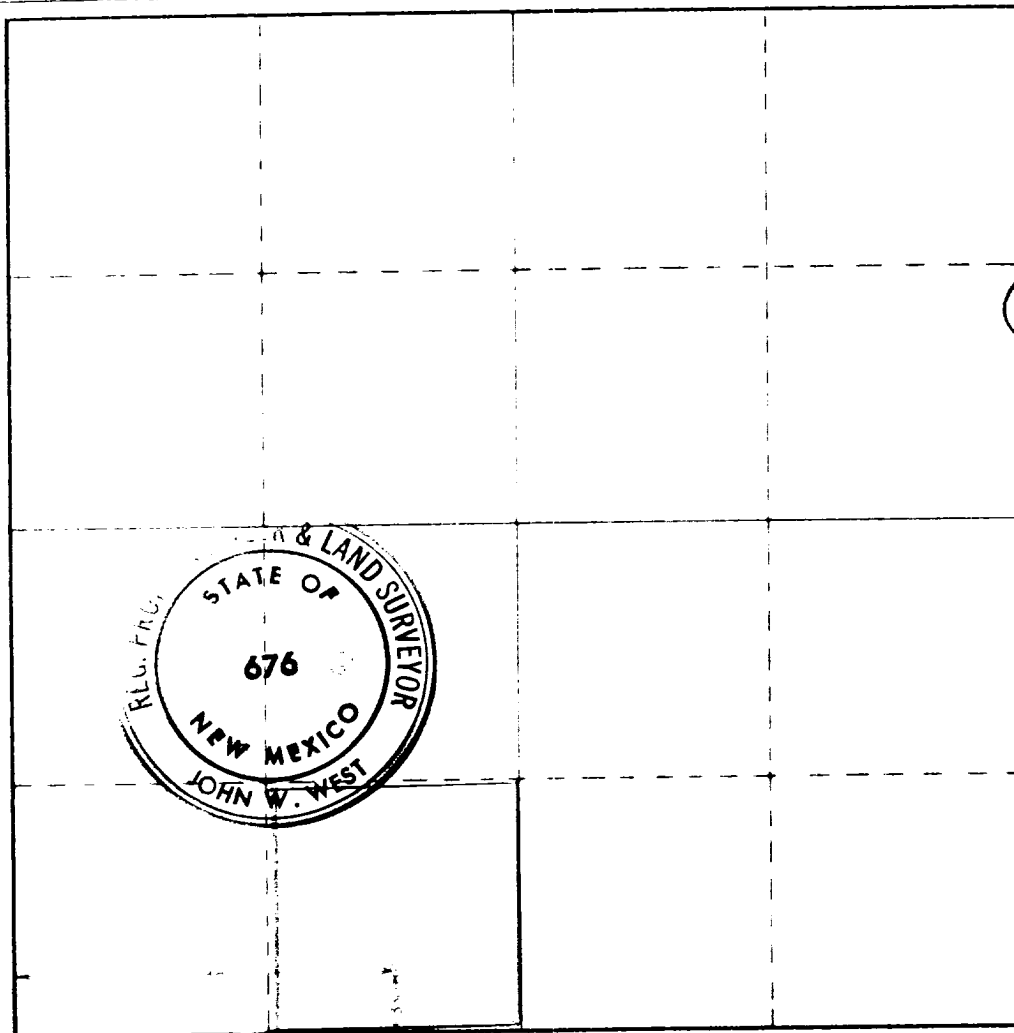

CERTIFICATION

I hereby certify that the information contained herein is true and complete to the best of my knowledge and belief

Jack L. McClellan
Name
Jack L. McClellan
Position
President

Company
McClellan Oil Corporation

Date
December 15, 1978

I hereby certify that the well location shown on this plat was plotted from field notes of actual surveys made by me or under my supervision, and that the same is true and correct to the best of my knowledge and belief.

Date Surveyed
December 15, 1978

Registered Professional Engineer and/or Land Surveyor

Ronald J. Eidson
Certificate No. **John W. West 676**
Ronald J. Eidson 3239

