

NO. OF COPIES RECEIVED	5
DISTRIBUTION	
SANTA FE	1
FILE	1
U.S.G.S.	2
LAND OFFICE	
OPERATOR	1

NEW MEXICO OIL CONSERVATION COMMISSION RECEIVED

DEC 27 1978

Form C-101
Revised 1-1-65

5A. Indicate Type of Lease	
STATE <input type="checkbox"/>	FEC <input checked="" type="checkbox"/>

5. State Oil & Gas Lease No.

O. C. C.
ARTESIA, OFFICE

APPLICATION FOR PERMIT TO DRILL, DEEPEN, OR PLUG BACK

1a. Type of Work		7. Unit Agreement Name	
b. Type of Well DRILL <input checked="" type="checkbox"/> DEEPEN <input type="checkbox"/> PLUG BACK <input type="checkbox"/> OIL WELL <input checked="" type="checkbox"/> GAS WELL <input type="checkbox"/> OTHER <input type="checkbox"/> SINGLE ZONE <input checked="" type="checkbox"/> MULTIPLE ZONE <input type="checkbox"/>		8. Farm or Lease Name J.P. White A	
2. Name of Operator CORONADO EXPLORATION CORP. ✓		9. Well No. 1	
3. Address of Operator 1007 MARQUETTE N.W. ALBUQUERQUE, NM 87102		10. Field and Pool, or Wildcat + Unit Face 31.1 - Wildcat SA	
4. Location of Well UNIT LETTER D LOCATED 660 FEET FROM THE north LINE AND 660 FEET FROM THE west LINE OF SEC. 19 TWP. 10S RGE. 28E MP. 1		12. County Chaves	
21. Elevations (Show whether LL, RT, etc.) 3763.1 Gr		22. Approx. Date Work will start December 27, 1978	
21A. Kind & Status Plug Bond Statewide		21B. Drilling Contractor Fred Pool	
21C. Expected Depth 2500 ft.		21D. Formation San Andres	
21E. Rotary or C.T. Rotary			

PROPOSED CASING AND CEMENT PROGRAM

SIZE OF HOLE	SIZE OF CASING	WEIGHT PER FOOT	SETTING DEPTH	SACKS OF CEMENT	EST. TOP
12-1/4"	8-5/8"	24 lb.	300 ft.	330	Circ.
7-7/8"	4-1/2"	25 24 lb.	2400 ft.	175	

We propose to:

Set 8-5/8" casing at 300 ft; circulate cement to the surface; WOC 12 hrs. Test casing to 500 psi for 30 minutes before drilling out. Drill 7-7/8" hole to 2500 feet, reduce water loss to below 10cc before drilling San Andres. Run DLL with Microlateralog, GR-CNL-D. Set 4-1/2" casing, to either TD or above P1 zone depending on outcome of logs. In latter case open hole completion will be attempted, in former case, casing will be perforated.

APPROVAL VAL
FOR 60 DAYS UNIT
DATE 12.28.78 COMMENTED

EXPIRES 12.28.78

IN ABOVE SPACE DESCRIBE PROPOSED PROGRAM; IF PROPOSAL IS TO DEEPEN OR PLUG BACK, GIVE DATA ON PRESENT PRODUCTIVE ZONE AND PROPOSED NEW PRODUCTIVE ZONE. GIVE BLOWOUT PREVENTER PROGRAM, IF ANY.

I hereby certify that the information above is true and complete to the best of my knowledge and belief.

CORONADO EXPLORATION CORP.

Signed by: Kentley Ballar Title: Prod. Mgr. Date: December 7, 1978

(This space for State Use)

APPROVED BY: W.A. Gressett TITLE: SUPERVISOR, DISTRICT II DATE: DEC 28 1978

CONDITIONS OF APPROVAL, IF ANY:

Minimum WOC time: 12 hrs. per report to state, not to be less than 12

MEXICO OIL CONSERVATION COMMISSION
WELL LOCATION AND ACREAGE DEDICATION PLAT

Form C-122
 Supersedes C-128
 Effective 1-1-65

All distances must be from the outer boundaries of the Section

Operator Coronado Exploration Corp.			Lease J. P. White A		Well No. 1
Tract Letter D	Section 19	Township 10 South	Range 28 East	County Chaves	
Actual Location of Well: 660 feet from the North line and 660 feet from the West line					
Ground Level Elev. 3763.1	Producing Formation San Andres		Pool Name Pool Race Jack - SA Wildcat		Dedicated Acreage 40.07

1. Outline the acreage dedicated to the subject well by colored pencil or hatchure marks on the plat below.
2. If more than one lease is dedicated to the well, outline each and identify the ownership thereof (both as to working interest and royalty).
3. If more than one lease of different ownership is dedicated to the well, have the interests of all owners been consolidated by communitization, unitization, force-pooling, etc?

☒ Yes ☐ No If answer is "yes," type of consolidation (see back)

If answer is "no," list the owners and tract descriptions which have actually been consolidated. (Use reverse side of this form if necessary.) _____

No allowable will be assigned to the well until all interests have been consolidated (by communitization, unitization, forced-pooling, or otherwise) or until a non-standard unit, eliminating such interests, has been approved by the Commission.

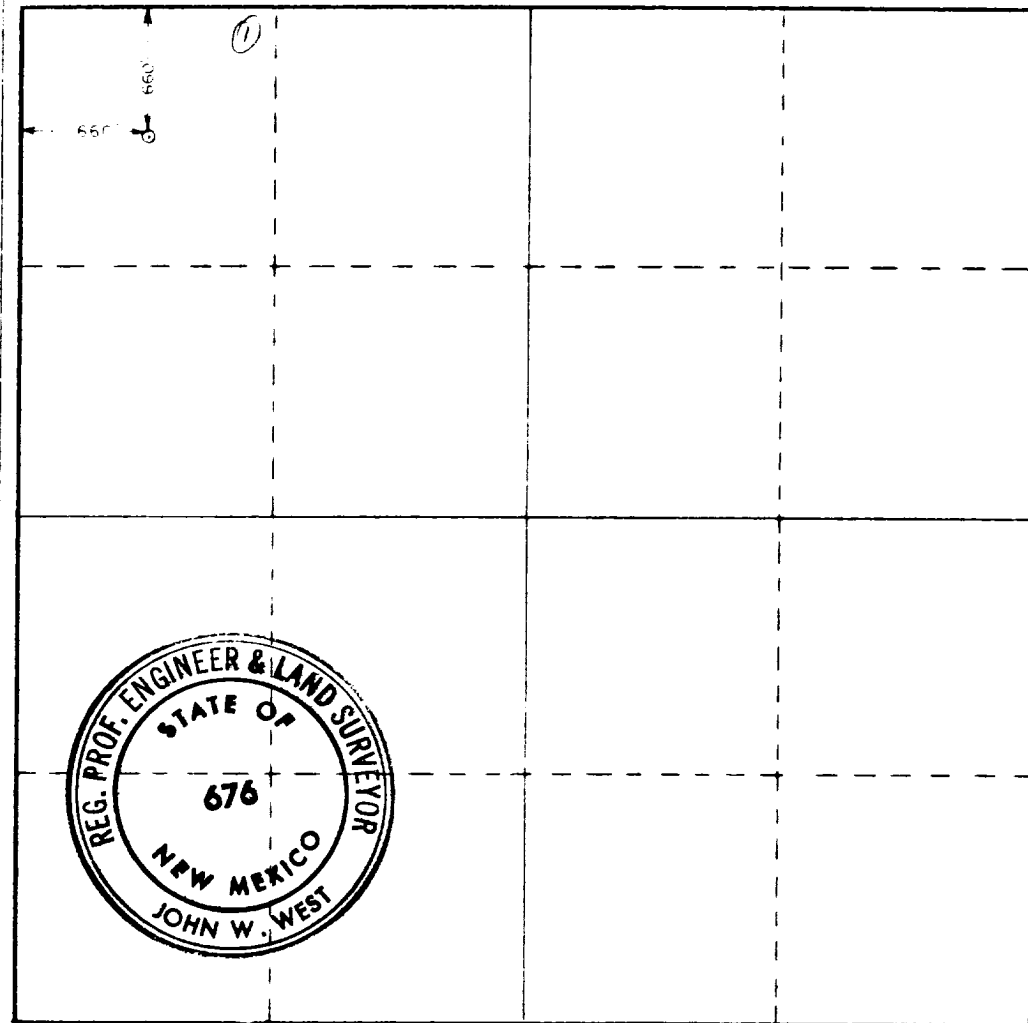

CERTIFICATION

I hereby certify that the information contained herein is true and complete to the best of my knowledge and belief.

Name Kathy Ballard
 Position Prod. Mgr.
 Company Coronado Expl. Corp.
 Date Nov 7, 1978

I hereby certify that the well location shown on this plat was plotted from field notes of actual surveys made by me or under my supervision, and that the same is true and correct to the best of my knowledge and belief.

Date Surveyed November 11, 1978
 Registered Professional Engineer and/or Land Surveyor

John W. West
 Certificate No. John W. West 676
Ronald J. Eidson 3239



3. Communitization is by force pooling. All leases are held by operator and participating parties except less than 1% interest owned by the Selma Andrews trust which is being force pooled.

CORONADO EXPLORATION CORPORATION

1005 MARQUETTE N.W.
ALBUQUERQUE, NEW MEXICO 87102
TELEPHONE (505) 242-2050
(505) 843-6762

WHEN REPLYING

PLEASE REFER TO: _____

December 26, 1978

RECEIVED

DEC 27 1978

D. C. C.
ARTESIA, OFFICE

NMOCC
attn: W.A. Gressett
Drawer DD
Artesia, NM 88210

Dear Mr. Gressett:

Enclosed please find the application to drill and the well location and acreage dedication plat for the J.P. White A#1 well. We would appreciate your reviewing this at your earliest convenience and if there are any problems to please call us at the 242-2050 number.

Sincerely,

Kathy Ballard
Kathy Ballard
Production

kb
encl.