

NO. OF COPIES RECEIVED	5
DISTRIBUTION	
SANTA FE	1
FILE	1
U.S.G.S.	2
LAND OFFICE	
OPERATOR	1

NEW MEXICO OIL CONSERVATION COMMISSION

RECEIVED

OCT 4 1979

30-005-60596

Form C-101
Revised 1-1-65

5A. Indicate Type of Lease	
STATE <input type="checkbox"/>	FEE <input checked="" type="checkbox"/>
5. State Oil & Gas Lease No.	

APPLICATION FOR PERMIT TO DRILL, DEEPEN, OR PLUG BACK

1a. Type of Work				7. Unit Agreement Name	
b. Type of Well DRILL <input checked="" type="checkbox"/> DEEPEN <input type="checkbox"/> PLUG BACK <input type="checkbox"/> OIL WELL <input checked="" type="checkbox"/> GAS WELL <input type="checkbox"/> OTHER <input type="checkbox"/> SINGLE ZONE <input type="checkbox"/> MULTIPLE ZONE <input type="checkbox"/>				8. Farm or Lease Name O'Brien "K"	
2. Name of Operator STEVENS OIL COMPANY				9. Well No. 3	
3. Address of Operator P. O. Box 2203 - Roswell, New Mexico 88201				10. Field and Pool, or Wildcat ASSOC Twin Lakes-San Andre	
4. Location of Well UNIT LETTER K LOCATED 1650 FEET FROM THE South LINE AND 1650 FEET FROM THE West LINE OF SEC. 30 TWP. 8-S RGE. 29-E NMPM				12. County Chaves	
19. Proposed Depth 2900'		19A. Formation San Andres		20. Rotary or C.T. Rotary	
21. Elevations (Show whether DF, RT, etc.) 3948.8' Gr., 3954.8' K.B. Statewide		21B. Drilling Contractor Fred Pool		22. Approx. Date Work will start 10-23-79	

PROPOSED CASING AND CEMENT PROGRAM

SIZE OF HOLE	SIZE OF CASING	WEIGHT PER FOOT	SETTING DEPTH	SACKS OF CEMENT	EST. TOP
12-1/2"	8-5/8"	20#	120'	75 sx.	
7-7/8"	4-1/2"	9.5#	2900'	225 sx.	

Will drill with water & mud to T.D., log, and if indicated productive, case to T.D. & perforate in producing interval.

Adequate blowout preventers will be used.

APPROVAL VALID
FOR 90 DAYS UNLESS
DRILLING COMMENCEL

EXPIRES 1-5-80

IN ABOVE SPACE DESCRIBE PROPOSED PROGRAM: IF PROPOSAL IS TO DEEPEN OR PLUG BACK, GIVE DATA ON PRESENT PRODUCTIVE ZONE AND PROPOSED NEW PRODUCTIVE ZONE. GIVE BLOWOUT PREVENTER PROGRAM, IF ANY.

I hereby certify that the information above is true and complete to the best of my knowledge and belief.

Signed Donald E. Steen Title Owner Date 10-3-79

(This space for State Use)

APPROVED BY W. A. Gressett TITLE SUPERVISOR, DISTRICT II DATE OCT 5 1979

CONDITIONS OF APPROVAL, IF ANY:

NEW MEXICO OIL CONSERVATION COMMISSION
WELL LOCATION AND ACREAGE DEDICATION PLAT

Form O-102
Supersedes O-128
Effective 12-65

All distances must be from the outer boundaries of the Section

Operator Stevens Oil Co.		Lessee O'Brien "K"		Well No. 3
Well Letter K	Section 30	Township 8 South	Range 29 East	County Chaves
Actual Forfeiture Location of Well: 1650 feet from the South line and 1650 feet from the West line				
Ground Level Elev. 3940.8	Producing Formation San Andres	Pool Twin Lakes Assoc.	Dedicated Acreage: 40 Acres	

1. Outline the acreage dedicated to the subject well by colored pencil or hatchure marks on the plat below.
2. If more than one lease is dedicated to the well, outline each and identify the ownership thereof (both as to working interest and royalty).
3. If more than one lease of different ownership is dedicated to the well, have the interests of all owners been consolidated by communitization, unitization, force-pooling, etc?

RECEIVED

OCT 4 1979

☐ Yes ☐ No If answer is "yes," type of consolidation **B. O. O.**

ARTESIA, OFFICE

If answer is "no," list the owners and tract descriptions which have actually been consolidated. (Use reverse side of this form if necessary.) _____

No allowable will be assigned to the well until all interests have been consolidated (by communitization, unitization, forced-pooling, or otherwise) or until a non-standard unit, eliminating such interests, has been approved by the Commission.

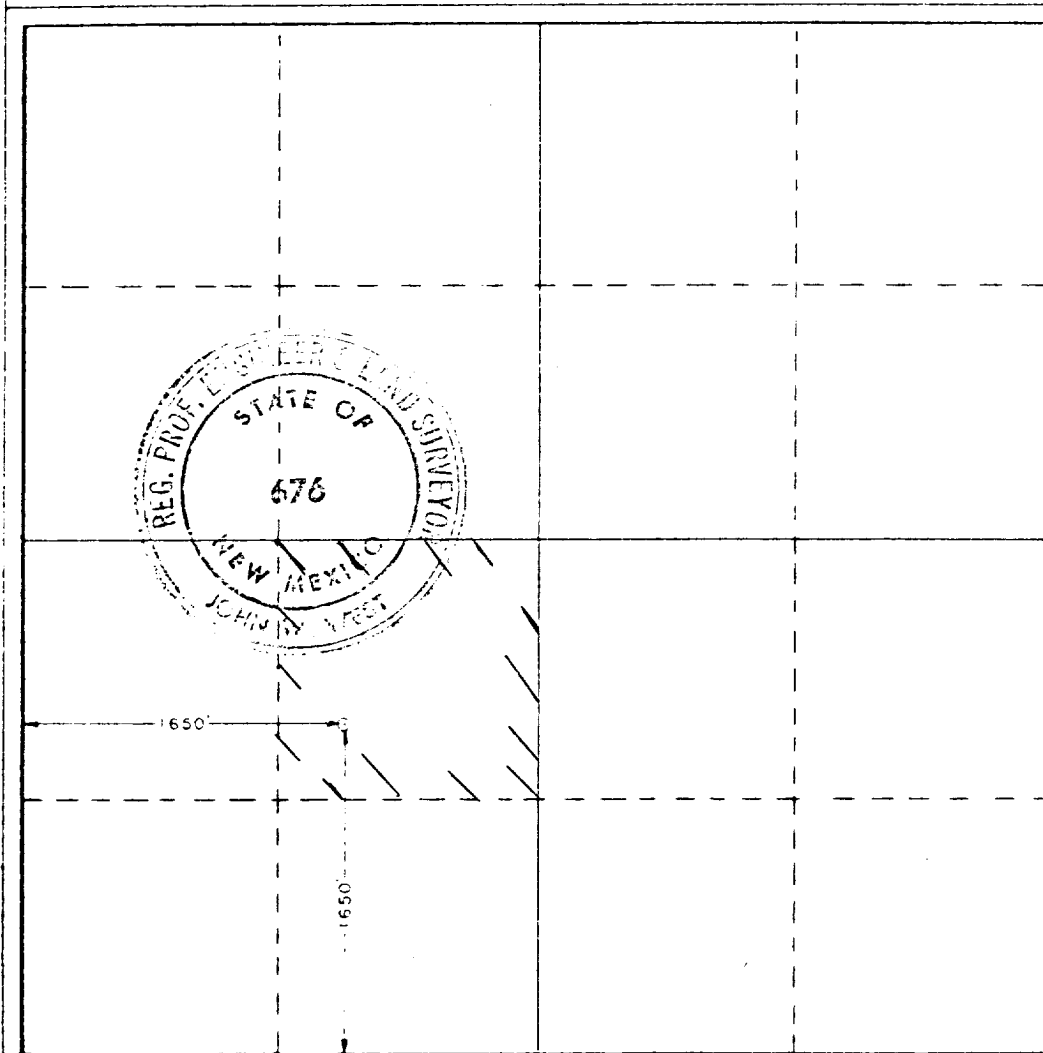

CERTIFICATION

I hereby certify that the information contained herein is true and complete to the best of my knowledge and belief.

Name *Donald J. Eidson*
Position
Owner
Company
Stevens Oil Company
Date
10-3-79

I hereby certify that the well location shown on this plat was plotted from field notes of actual surveys made by me or under my supervision, and that the same is true and correct to the best of my knowledge and belief.

Date Surveyed
June 12, 1979
Registered Professional Engineer and or Land Surveyor

John W. West
Certificate No. **John W. West 676**
Ronald J. Eidson 3239

0 330 660 990 1320 1650 1980 2310 2640 2970 3300 3630 3960 4290 4620 4950 5280 5610 5940 6270 6600