

NO. OF COPIES RECEIVED	6
DISTRIBUTION	
SANTA FE	1
FILE	1
U.S.G.S.	1
LAND OFFICE	1
OPERATOR	1

NEW MEXICO OIL CONSERVATION COMMISSION

OCT 23 1979

O. C. C.
ARTESIA, OFFICE

30-005-60607

Form C-101
Revised 1-1-65

5A. Indicate Type of Lease	STATE <input checked="" type="checkbox"/> FEE <input type="checkbox"/>
5. State Oil & Gas Lease No.	L-4317

APPLICATION FOR PERMIT TO DRILL, DEEPEN, OR PLUG BACK

1a. Type of Work	7. Unit Agreement Name
b. Type of Well DRILL <input checked="" type="checkbox"/> DEEPEN <input type="checkbox"/> PLUG BACK <input type="checkbox"/> OIL WELL <input type="checkbox"/> GAS WELL <input checked="" type="checkbox"/> OTHER <input type="checkbox"/> SINGLE ZONE <input checked="" type="checkbox"/> MULTIPLE ZONE <input type="checkbox"/>	8. Farm or Lease Name Crockett State
2. Name of Operator Mesa Petroleum Co. ✓	9. Well No. 1
3. Address of Operator 1000 Vaughn Building / Midland, Texas 79701	10. Field and Pool or Wildcat Undesignated
4. Location of Well UNIT LETTER 0 LOCATED 990 FEET FROM THE South LINE AND 1980 FEET FROM THE East LINE OF SEC. 36 TWP. 5S RGE. 25E NMPM	12. County Chaves
19. Proposed Depth 4800	19A. Formation Wolfcamp
20. Rotary or C.T. Rotary	
21. Elevations (Show whether DT, RT, etc.) 3765.1 GR	21A. Kind & Status Plug. Bond Blanket
21B. Drilling Contractor WEK	22. Approx. Date Work will start November 1, 1979

PROPOSED CASING AND CEMENT PROGRAM

SIZE OF HOLE	SIZE OF CASING	WEIGHT PER FOOT	SETTING DEPTH	SACKS OF CEMENT	EST. TOP
11"	8-5/8"	24#	1500' RKB	265sx LtWt/200	"C" Circulate to surface
7-7/8"	4-1/2"	10.5#	4800' RKB	600sx LtWt/200 sx 50/50 Poz	Circulate to Surface

Plan to set one joint of 13-3/8" casing at surface and cement with redimix. Will then drill 11" hole to 1500' without BOPs using fresh water with lost circulation material added as needed. Set 8-5/8" casing and circulate cement to surface. Nipple up 10" API 3000 psi double BOPs and test to 600 psi. Drill 7-7/8" hole to TD, using fresh water, caustic soda (for pH 9.0 - 9.5) and corrosion inhibitors as required to 3700'. Then will mud up with starch and soda ash, maintaining mud weight at less than 10 ppg and adding 3% KCL to the water gel mud. 4-1/2" production casing will be run and cement raised to the surface.

APPROVAL VALID
FOR 90 DAYS UNLESS
DRILLING COMMENCED,

EXPIRES 1-25-80

IN ABOVE SPACE DESCRIBE PROPOSED PROGRAM: IF PROPOSAL IS TO DEEPEN OR PLUG BACK, GIVE DATA ON PRESENT PRODUCTIVE ZONE AND PROPOSED NEW PRODUCTIVE ZONE. GIVE BLOWOUT PREVENTER PROGRAM, IF ANY.

I hereby certify that the information above is true and complete to the best of my knowledge and belief.

Signed R. P. Martin Title Regulatory Coordinator Date 10-18-79

(This space for State Use)

APPROVED BY W. A. Gussis TITLE SUPERVISOR, DISTRICT II DATE OCT 25 1979

CONDITIONS OF APPROVAL, IF ANY:

XC: TLS, JBH, MEC, JWH, NMOC ARTESIA (6), FILE

Cement must be circulated to

surface behind 13 7/8" casing

0 200 400 600 800 1000 1200 1400 1600 1800 2000 2200 2400 2600 2800 3000 3200 3400 3600 3800 4000 4200 4400 4600 4800 5000 5200 5400 5600 5800 6000 6200 6400 6600 6800 7000 7200 7400 7600 7800 8000 8200 8400 8600 8800 9000 9200 9400 9600 9800 10000

Ronald J. Eidson 3239

**MEXICO OIL CONSERVATION COMMISSION
WELL LOCATION AND ACREAGE DEDICATION PLAT**

Form C-102
Supersedes C-128
Effective 1-1-65

All distances must be from the outer boundaries of the Section

Operator Mesa Petroleum Co.			Lease Crockett State		Well No. 1
Unit Letter O	Section 36	Township 5 South	Range 25 East	County Chaves	
Actual Footage Location of Well: 990 feet from the South line and 1980 feet from the East line					
Ground Level Elev. 3765.1	Producing Formation Wolfcamp	Pool <i>Wildcat</i> Undesignated		Dedicated Acreage: S/2 320 Acres	

1. Outline the acreage dedicated to the subject well by colored pencil or hachure marks on the plat below.
2. If more than one lease is dedicated to the well, outline each and identify the ownership thereof (both as to working interest and royalty).
3. If more than one lease of different ownership is dedicated to the well, have the interests of all owners been consolidated by communitization, unitization, force-pooling, etc?

☐ Yes ☐ No If answer is "yes," type of consolidation _____

If answer is "no," list the owners and tract descriptions which have actually been consolidated. (Use reverse side of this form if necessary.) _____

No allowable will be assigned to the well until all interests have been consolidated (by communitization, unitization, forced-pooling, or otherwise) or until a non-standard unit, eliminating such interests, has been approved by the Commission.

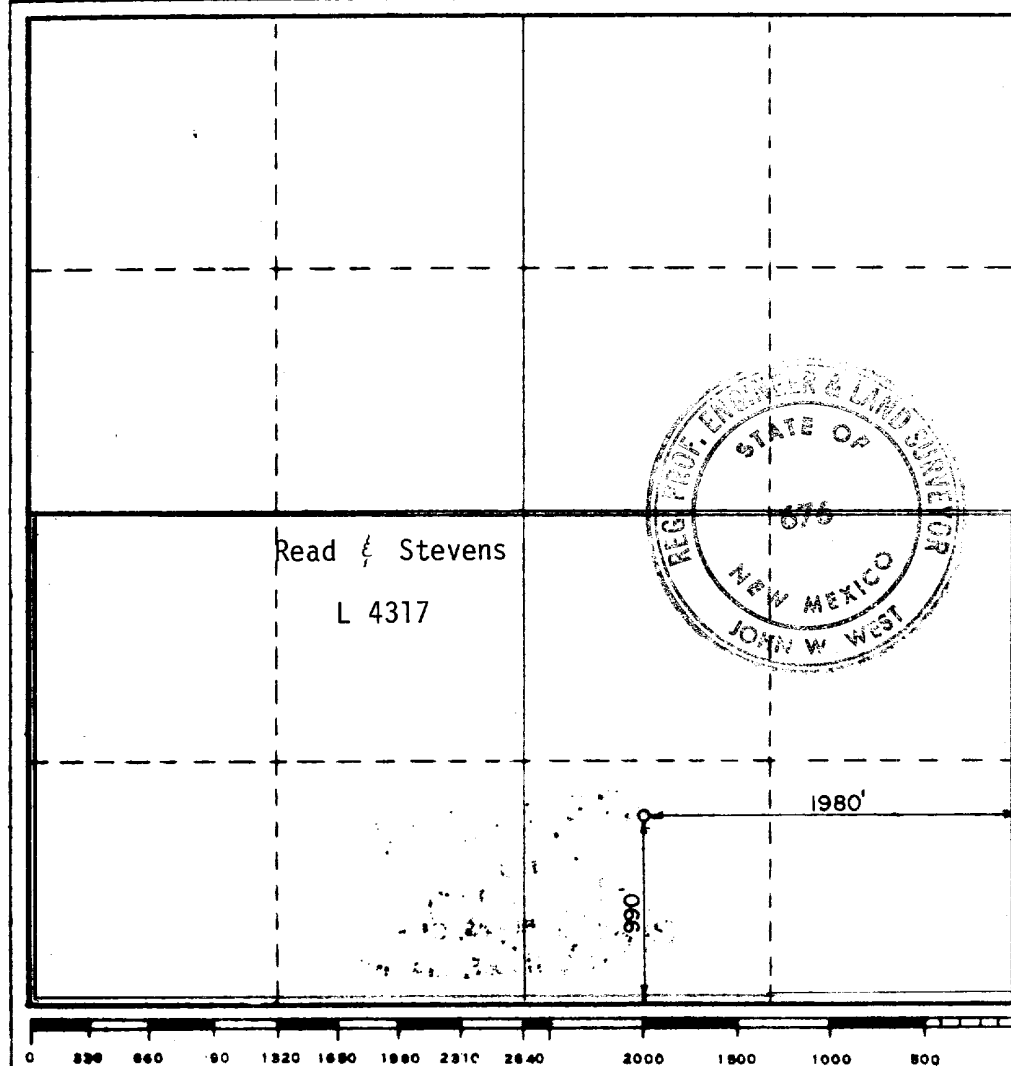

CERTIFICATION

I hereby certify that the information contained herein is true and complete to the best of my knowledge and belief

R. E. Mathis

Name

R. E. Mathis

Position

Regulatory Coordinator

Company

Mesa Petroleum Co.

Date

October 18, 1979

I hereby certify that the well location shown on this plat was plotted from field notes of actual surveys made by me or under my supervision, and that the same is true and correct to the best of my knowledge and belief

Date Surveyed

October 12, 1979

Registered Professional Engineer and/or Land Surveyor

John W. West

Certificate No. **John W. West**

676

Ronald J. Eidson

3239

2:00 PM. 3-10-80

spot 255x. 1600-1700
" 355x 1350-1450
" 355x 250-350

surface plug w/ marker.

To R + A.

13 $\frac{3}{8}$ " 300-circ. 8 $\frac{3}{8}$ " 1499-circ.

7" liner 1400-1800 circ.

f 1670-80

spot 255x 1600-1700 + tag
" 355x 1350-1450
" 355x 250-350

surface plug w/ marker
