

UNITED STATES
DEPARTMENT OF THE INTERIOR

GEOLOGICAL SURVEY

APPLICATION FOR PERMIT TO DRILL, DEEPEN, OR PLUG BACK

1a. TYPE OF WORK

DRILL ☒NOV 9 1979 DEEPEN ☐PLUG BACK ☐

b. TYPE OF WELL

OIL
WELL ☐GAS
WELL ☒OTHER ☐ O. C. C.SINGLE
ZONE ☐MULTI
ZONE ☐

2. NAME OF OPERATOR

Yates Petroleum Corporation

ARTESIA, OFFICE

OCT 15 1979

3. ADDRESS OF OPERATOR

207 So. 4th Street, Artesia, N.M. 88210

4. LOCATION OF WELL (Report location clearly and in accordance with any lease agreement.)

At surface

1980' FSL & 660' FWL

At proposed prod. zone

Same

14. DISTANCE IN MILES AND DIRECTION FROM NEAREST TOWN OR POST OFFICE*

31 miles north & 14 miles east of Roswell, N.M.

15. DISTANCE FROM PROPOSED*

LOCATION TO NEAREST
PROPERTY OR LEASE LINE, FT.
(Also to nearest drlg. unit line, if any)

660'

16. NO. OF ACRES IN LEASE

4640

17. NO. OF ACRES ASSIGNED
TO THIS WELL

320

18. DISTANCE FROM PROPOSED LOCATION*
TO NEAREST WELL, DRILLING, COMPLETED,
OR APPLIED FOR, ON THIS LEASE, FT.

19. PROPOSED DEPTH

5100'

20. ROTARY OR CABLE TOOLS

Rotary

21. ELEVATIONS (Show whether DF, RT, GR, etc.)

3855.9

22. APPROX. DATE WORK WILL START*

ASAP

23.

PROPOSED CASING AND CEMENTING PROGRAM

SIZE OF HOLE	SIZE OF CASING	WEIGHT PER FOOT	SETTING DEPTH	QUANTITY OF CEMENT
17½"	13-3/8"	48# J-55	approx 350	350 sx circulated
12½"	8-5/8"	24# J-55	approx 1500	800 sx circulated
8-3/4 or 7-7/8"	5½ or 4½"	15.5 or 10.5#	TD	250 SX

We propose to drill and test the Penn and intermediate formations. Approximately 350' of surface casing will be set and cement circulated to shut off gravel, and caving. Casing will be set and cement circulated to shut off gravel and caving. Casing will be set 100' below the water zone. If commercial will run production casing and cement with adequate cover, perforate, and stimulate as needed for production.

Mud Program: FW gel and LCM to 1500' - Brine KCL to 3200' - KCL drispak & Starch to 4350' flosal drispak KCL to TD. MW 10-10.2, Vis 34-39, WL 14-7

BOP Program: BOP's will be installed in 8-5/8" casing and tested daily.

Gas Not Dedicated.

IN ABOVE SPACE DESCRIBE PROPOSED PROGRAM: If proposal is to deepen or plug back, give data on present productive zone and proposed new productive zone. If proposal is to drill or deepen directionally, give pertinent data on subsurface locations and measured and true vertical depths. Give blowout preventer program, if any.

24.

SIGNED

Glenn R. Rodriguez

TITLE

Geographer

DATE

10-11-79

(This space for Federal or State office use)

PERMIT NO.

APPROVAL DATE

11-7-79

APPROVED BY

TITLE

DATE

CONDITIONS OF APPROVAL, IF ANY:

NEW MEXICO OIL CONSERVATION COMMISSION
WELL LOCATION AND ACREAGE DEDICATION PLAT

Form C-102
Supersedes C-128
Effective 1-1-65

All distances must be from the outer boundaries of the Section.

Operator YATES PETROLEUM CORPORATION			Lease McClellan MB Federal			Well No. 1		
Unit Letter L	Section 31	Township 5 South	Range 25 East	County Chaves				
Actual Footage Location of Well: 1980 feet from the South line and 660 feet from the West line								
Ground Level Elev. 3855.9	Producing Formation PERM		Pool UNDESIGNATED WILDCAT PERM			Dedicated Acreage: 320.80 Acres		

1. Outline the acreage dedicated to the subject well by colored pencil or hatchure marks on the plat below.
2. If more than one lease is dedicated to the well, outline each and identify the ownership thereof (both as to working interest and royalty).
3. If more than one lease of different ownership is dedicated to the well, have the interests of all owners been consolidated by communitization, unitization, force-pooling, etc?

RECEIVED

NOV 9 1979

O.C.C.
ARTESIA, OFFICE

☐ Yes ☐ No If answer is "yes," type of consolidation _____

If answer is "no," list the owners and tract descriptions which have actually been consolidated. (Use reverse side of this form if necessary.) _____

No allowable will be assigned to the well until all interests have been consolidated (by communitization, unitization, forced-pooling, or otherwise) or until a non-standard unit, eliminating such interests, has been approved by the Commission.

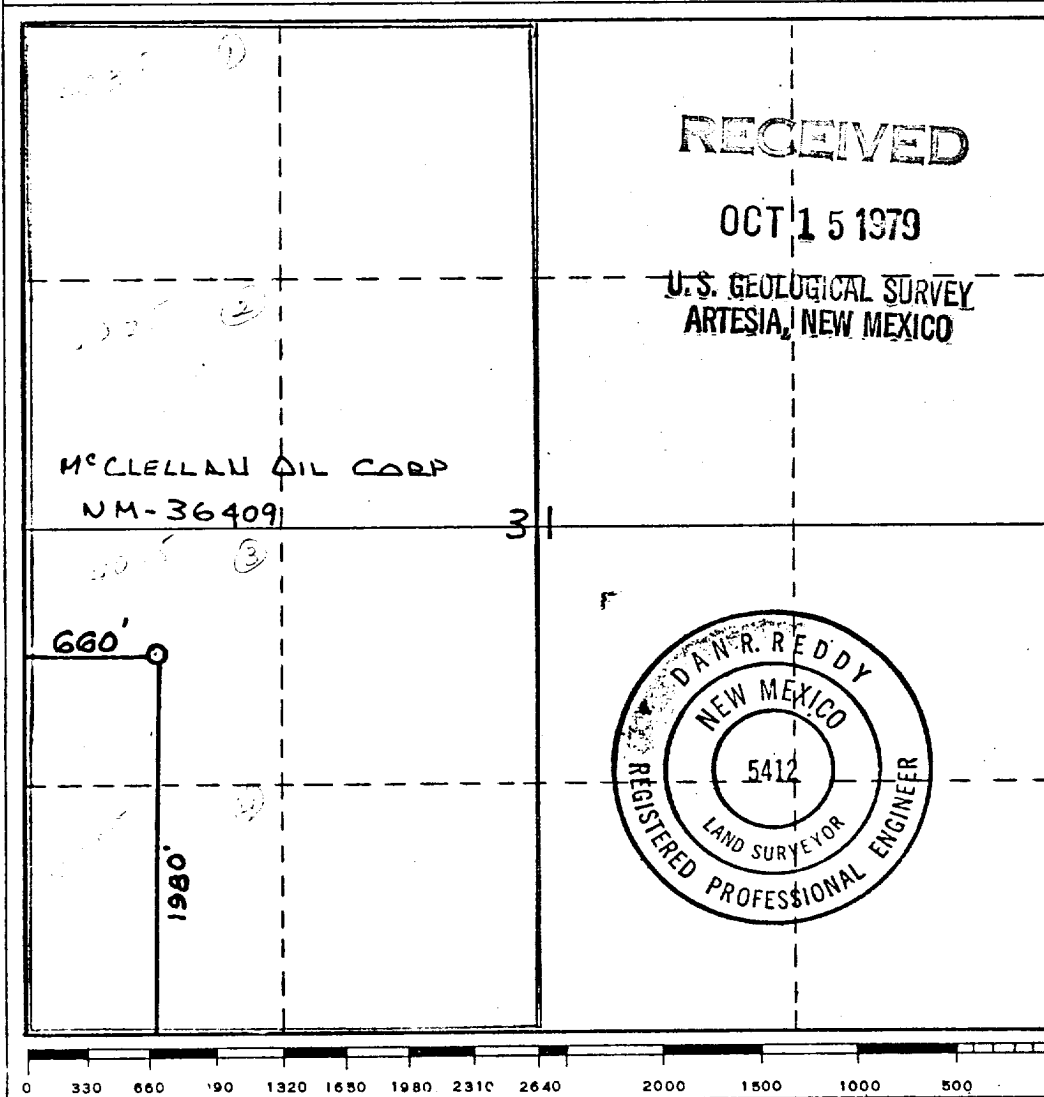

CERTIFICATION

I hereby certify that the information contained herein is true and complete to the best of my knowledge and belief.

Gliserio Rodriguez
Name

GLISERIO RODRIGUEZ
Position

GEOGRAPHER
Company

YATES PETROLEUM CORP
Date

10-11-79

I hereby certify that the well location shown on this plat was plotted from field notes of actual surveys made by me or under my supervision, and that the same is true and correct to the best of my knowledge and belief.

Date Surveyed

October 2, 1979

Registered Professional Engineer and/or Land Surveyor

Dan R. Reddy
Certificate No.

NM PE&LS #5412

RECEIVED

NOV 9 1979

O. C. C.
ARTESIA, OFFICE

United States Department of the Interior

GEOLOGICAL SURVEY

P. O. Drawer U
Artesia, New Mexico 88210

November 7, 1979

Yates Petroleum Corporation
207 South Fourth Street
Artesia, New Mexico 88210

Gentlemen:

YATES PETROLEUM CORPORATION
McClellan "MB" Federal No. 1
1980 FSL 660 FWL Sec. 31 T.5S R.25E
Chaves County Lease No. NM 36409

Above Data Required on Well Sign

Your APPLICATION FOR PERMIT TO DRILL the above-described well to a depth of 5,100 feet to test the Pennsylvanian is hereby approved subject to compliance with the OIL AND GAS OPERATING REGULATIONS (30 CFR 221) and the following conditions:

1. Drilling operations authorized are subject to compliance with the attached General Requirements for Oil and Gas Operations on Federal Leases, dated July 1, 1978.
2. Prior to commencing construction of road, pad, or other associated developments, operator will provide the dirt contractor with a copy of the Surface Use Plan and these Conditions of Approval including the attached General Requirements.
3. Submit a Daily Report of Operations from spud date until the well is completed and the Well Completion Report (form 9-330) is filed. The report should not be less than 8" x 5" in size and each page should identify the well.
4. All permanent above-ground structures and equipment shall be painted in accordance with the attached Painting Guidelines. The color used should simulate Sandstone Brown (Federal Standard No. 595A, color 20318 or 30318).
5. Before drilling below the 8-5/8" casing, the blowout preventer assembly will consist of a minimum of one annular type and two ram type preventers.
6. A kelly cock will be installed and maintained in operable condition.



7. After setting the 8-5/8" casing string and before drilling into the Wolfcamp formation, the blowout preventers and related control equipment shall be pressure tested to rated working pressures by an independent service company. Any equipment failing to test satisfactorily shall be repaired or replaced. This office should be notified in sufficient time for a representative to witness the tests and shall be furnished a copy of the pressure test report.
8. Mud system monitoring equipment, with derrick floor indicators and visual and audio alarms, shall be installed and operating before drilling into the Wolfcamp formation and used until production casing is run and cemented. Monitoring equipment shall consist of the following:
 - (1) A recording pit level indicator to determine pit volume gains and losses.
 - (2) A mud volume measuring device for accurately determining mud volume necessary to fill the hole on trips.
 - (3) A flow sensor on the flow-line to warn of any abnormal mud returns from the well.
9. Cement behind the 8-5/8" casing must be circulated.
10. Please have anyone contacting the Survey in regard to this well to identify the well with all of the information required above for the well sign.

Sincerely yours,

(Sgd.) GEORGE H. STEWART

George H. Stewart
Acting District Engineer

Yates Petroleum Corporation
McClellan "MB" Federal #1
1980' FSL and 660' FWL
Section 31-T5S-R25E
Chaves County, New Mexico

In conjunction with Form 9-331C, Application for Permit to Drill subject well, Yates Petroleum Corporation submits the following ten items of pertinent information in accordance with USGS requirements:

1. The geologic surface formation is sandy alluvium.
2. The estimate tops of geologic markers are as follows:

San Andres	584'
Glorieta	1444'
Abo	3584'
Wolfcamp	4262'
Penn	4857'
T.D.	5100'

3. The estimated depths at which anticipated water, oil, or gas formations are expected to be encountered:

Water: Approximately 250'-300'

Oil or Gas: Wolfcamp - 4275'
Penn - 4890'

4. Proposed Casing Program: See Form 9-331C.
5. Pressure Control Equipment: See Form 9-331C and Exhibit B.
6. Mud Program: See Form 9-331C
7. Auxiliary Equipment: Kelly Cock, pit level indicators and flow sensor equipment;
sub with full-opening valve on floor, drill pipe connection.
8. Testing, Logging and Coring Program:

Samples:-Surface casing to T.D.
DST's: -As Warranted
Logging:-Surface casing to T.D.
Coring: -CNL-FDC T.D. to casing with GR-CNL on to surface and DLL from T.D. to casing.
9. No abnormal pressures or temperatures are anticipated.
10. Anticipated starting date: As soon as possible after approval.

RECEIVED

OCT 15 1979

U.S. GEOLOGICAL SURVEY
ARTESIA, NEW MEXICO

Yates Petroleum Corporation
McClellan "MB" Federal #1
Section 31 - T5S - R25E
1980' FSL and 660' FWL
(Exploratory Well)

This plan is submitted with Form 9-331C, Application for Permit to Drill, covering the above described well. The purpose of this plan is to describe the location, the construction activities and operations plan, the surface disturbance involved, and the procedures to be followed in rehabilitating the surface after completion of the operations, so that a complete appraisal can be made of the environmental effect associated with the drilling of this well.

1. EXISTING ROADS.

Exhibit A is a portion of a county map showing the roads in the vicinity of the proposed location. The proposed wellsite is located approximately 3 miles NNE of Roswell, New Mexico and the access route to the location is indicated in red and green on Exhibit A.

DIRECTIONS:

1. Proceed north from Roswell on Highway 285 for a distance of approximately 31 miles.
2. Turn east for approximately 8 miles and continue NE for 2 miles.
3. Then turn SE on the Mapco Pipeline right-of-way, go for 2 miles then turn northeast to Grynberg "LZ" State #1 staked location. The new road will start at the state location going east for 1200' to federal location.

2. PLANNED ACCESS ROAD.

- A. The proposed new access will be approximately 1200' in length from point of origin to the southwest edge of the drilling pad. The road will lie in a west-to-east direction.
- B. The new road will be 12 feet in width (driving surface).
- C. The new road will be covered with the necessary depth of caliche or other suitable material. The surface will be crowned, with drainage on one side. No turnouts will be built.
- D. The new road has been flagged and the route of the road is visible.

3. LOCATION OF EXISTING WELL.

- A. There are no existing wells within a mile of wellsite.

4. LOCATION OF EXISTING AND/OR PROPOSED FACILITIES.

- A. There are no production facilities on this lease at the present time.

- B. In the event that the well is productive, the necessary production facilities will be installed on the drilling pad. If the well is productive oil, a gas or diesel self-contained unit will be used to provide the necessary power. No power will be required if the well is productive of gas.

5. LOCATION AND TYPE OF WATER SUPPLY.

- A. It is planned to drill the proposed well with a fresh water system. The water will be obtained from the ranches and trucked to the location.

6. SOURCE OF CONSTRUCTION MATERIALS.

- A. Any material required for construction of the drilling pad and the new access road will be obtained from the nearest existing pit. If possible, we will open one private surface.

7. METHODS OF HANDLING WASTE DISPOSAL.

- A. Drill cuttings will be disposed of in the reserve pits.
- B. Drilling fluids will be allowed to evaporate in the reserve pits until the pits are dry.
- C. Water produced during operations will be collected in tanks until hauled to an approved disposal system, or separate disposal application will be submitted to the USGS for appropriate approval.
- D. Oil produced during operation will be stored in tanks until sold.
- E. Current laws and regulations pertaining to the disposal of human waste will be complied with.
- F. Trash, waste paper, garbage and junk will be buried in a separate trash pit and covered with a minimum of 24 inches dirt. All waste material will be contained or prevent scattering by the wind.
- G. All trash and debris will be buried or removed from the wellsite within 30 days after finishing drilling and/or completion operations.

8. ANCILLARY FACILITIES.

- A. None required.

9. WELLSITE LAYOUT.

- A. Exhibit C shows the relative location and dimensions of the well pad, the reserve pits, etc.
- B. The location surface is on a minor slope so cut and fill will be needed.
- C. The reserve pits will be plastic lined.
- D. A 400' X 400' area and road has been staked and flagged.

10. PLANS FOR RESTORATION OF THE SURFACE.

- A. After finishing drilling and/or completion operations, all equipment and other material not needed for further operations will be removed. The location will be cleaned of all trash and junk to leave the wellsite in as pleasing a condition as possible.
- B. Unguarded pits, if any, containing fluids will be fenced until they have dried and leveled.
- C. If the proposed well is non-productive, all rehabilitation requirements of the BLM and the USGS will be complied with and will be as expeditiously as possible. All pits will be filled leveled within 90 days after abandonment.

11. OTHER INFORMATION.

- A. Topography: The land surface in the vicinity of the wellsite is sloping. The immediate area of the wellsite is discussed above in paragraph 9B.
- B. Flora and Fauna: The vegetation cover consists of tobosa, terpetine, pepper weed, and some mesquite. No wildlife was observed, but the wildlife in the area probably includes those typical of semi-arid desert land. The area is used for cattle grazing.
- C. The Pecos River is approximately three and a half miles east.
- D. There are no inhabited dwellings but there are windmills within a mile of the vicinity of the proposed well.
- E. Surface Ownership: The wellsite is on federal surface.
- F. There is no evidence of any archeological, historical or cultural sites in the area.

12. OPERATOR'S REPRESENTATIVE.

- A. The field representative responsible for assuring compliance with the approved surface use plan is:

Gliserio "Rod" Rodriguez
Yates Petroleum Corporation
207 South 4th Street
Artesia, New Mexico 88210
(505) 746-3558

13. CERTIFICATION.

I hereby certify that I, or persons under my direct supervision, have inspected the proposed drillsite and access route, that I am familiar with the conditions which presently exist; that the statements made in this plan are to the best of my knowledge true and correct; and, that the work associated with the operations proposed herein will be performed by Yates Petroleum Company and its contractors and subcontractors in conformity with this plan and the terms and conditions under which it is approved.

10-11-79
Date

Gliserio Rodriguez
Gliserio Rodriguez, Geographer

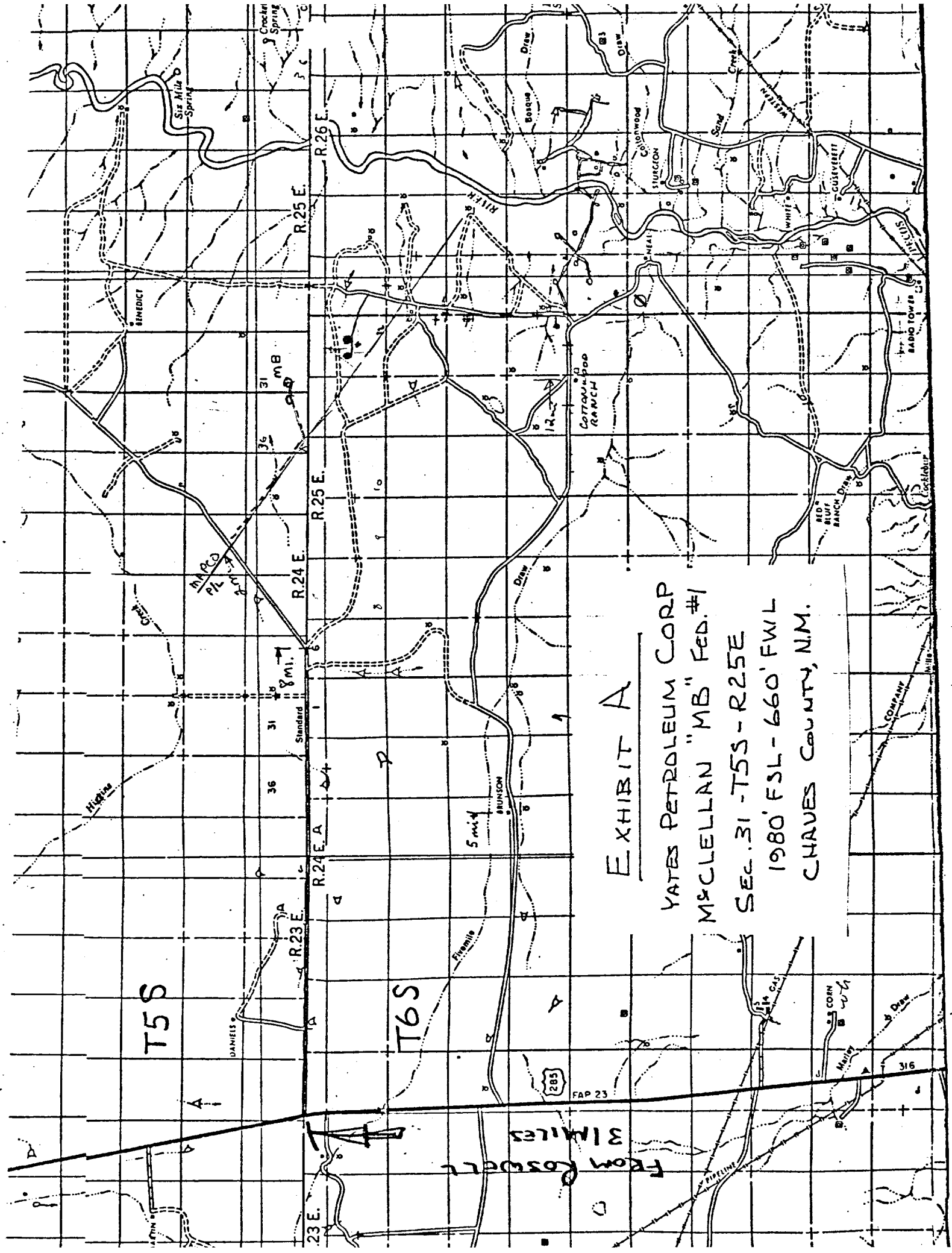
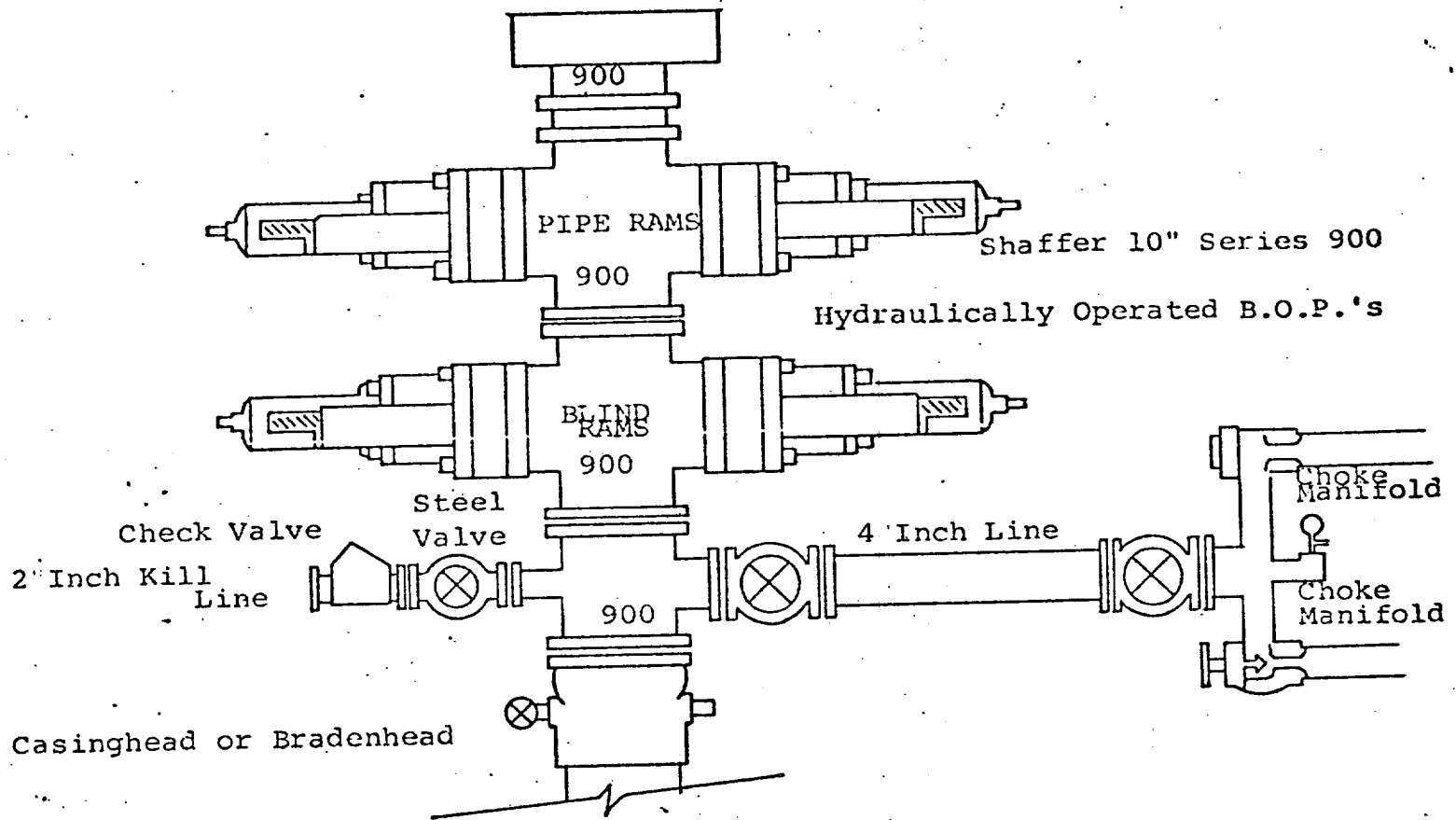

EXHIBIT A
YATES PETROLEUM CORP
MACLELLAN "MB" FED. #1
SEC. 31 - T5S - R25E
1980' FSL - 660' FWL
CHAVES COUNTY, N.M.

EXHIBIT B



THE FOLLOWING CONSTITUTE MINIMUM BLOWOUT PREVENTER REQUIREMENTS

1. All preventers to be hydraulically operated with secondary manual controls installed prior to drilling out from under casing.
2. Choke outlet to be a minimum of 4" diameter.
3. Kill line to be of all steel construction of 2" minimum diameter.
4. All connections from operating manifolds to preventers to be all steel. hole or tube a minimum of one inch in diameter.
5. The available closing pressure shall be at least 15% in excess of that required with sufficient volume to operate the B.O.P.'s.
6. All connections to and from preventer to have a pressure rating equivalent to that of the B.O.P.'s.
7. Inside blowout preventer to be available on rig floor.
8. Operating controls located a safe distance from the rig floor.
9. Hole must be kept filled on trips below intermediate casing. Operator not responsible for blowouts resulting from not keeping hole full.
10. D. P. float must be installed and used below zone of first gas intrusion.

0-6000 FT.

