

UNITED STATES  
DEPARTMENT OF THE INTERIOR  
GEOLOGICAL SURVEY

SUBMIT IN DUPLICATE\*

(See r in-  
struc on  
reverse side)

Form approved.  
Budget Bureau No. 42-R355.6.

WELL COMPLETION OR RECOMPLETION REPORT LOG\*

RECEIVED

FEB 25 1980

U.S. GEOLOGICAL SURVEY  
ARTESIA, NEW MEXICO

1a. TYPE OF WELL: OIL WELL ☐ GAS WELL ☒ DRY ☐ Other ☐  
b. TYPE OF COMPLETION: NEW WELL ☒ WORK OVER ☐ DEEP-EN ☐ PLUG BACK ☐ DIFF-RESVR. ☐ Other ☐

2. NAME OF OPERATOR  
Yates Petroleum Corporation

3. ADDRESS OF OPERATOR  
207 South 4th Street - Artesia, NM 88210

4. LOCATION OF WELL (Report location clearly and in accordance with any State requirements)\*  
At surface 1980' FSL & 660' FWL of Sec. 31-5S-25E  
At top prod. interval reported below  
At total depth

14. PERMIT NO. DATE ISSUED

15. DATE SPUDDED 1-12-80 16. DATE T.D. REACHED 1-26-80 17. DATE COMPL. (Ready to prod.) 2-20-80 18. ELEVATIONS (DF, REB, RT, GR, ETC.)\* 3856' GR 19. ELEV. CASINGHEAD

20. TOTAL DEPTH, MD & TVD 4650' 21. PLUG, BACK T.D., MD & TVD 4174' 22. IF MULTIPLE COMPL., HOW MANY\* 23. INTERVALS DRILLED BY 0-4650' ROTARY TOOLS CABLE TOOLS

24. PRODUCING INTERVAL(S), OF THIS COMPLETION—TOP, BOTTOM, NAME (MD AND TVD)\* 3930-3960' Abo 25. WAS DIRECTIONAL SURVEY MADE No

26. TYPE ELECTRIC AND OTHER LOGS RUN CNL/FDC, DLL 27. WAS WELL CORED No

28. CASING RECORD (Report all strings set in well)					
CASING SIZE	WEIGHT, LB./FT.	DEPTH SET (MD)	HOLE SIZE	CEMENTING RECORD	AMOUNT PULLED
10-3/4"	32#	360'	15"	250 sacks	
5 1/2"	14#	4214'	7-7/8"	450 sacks	

29. LINER RECORD					30. TUBING RECORD		
SIZE	TOP (MD)	BOTTOM (MD)	SACKS CEMENT*	SCREEN (MD)	SIZE	DEPTH SET (MD)	PACKER SET (MD)
					2-7/8"	3914'	3914'

31. PERFORATION RECORD (Interval, size and number)		32. ACID, SHOT, FRACTURE, CEMENT SQUEEZE, ETC.	
3930-3960' w/120 .50" holes (#spf)		DEPTH INTERVAL (MD)	AMOUNT AND KIND OF MATERIAL USED
		3930-3960'	Sand Frac'd w/27150 g trtd fluid, 2000g Titan II 2000g 15% spearhead acid 5150g CO-2 & 60000# sand

33. PRODUCTION							
DATE FIRST PRODUCTION		PRODUCTION METHOD (Flowing, gas lift, pumping—size and type of pump)				WELL STATUS (Producing or shut in)	
2-20-80		Flowing				SIWOPLC	
DATE OF TEST	HOURS TESTED	CHOKE SIZE	PROD'N. FOR TEST PERIOD	OIL—BBL.	GAS—MCF.	WATER—BBL.	GAS-OIL RATIO
2-20-80	2	1/2			117		
FLOW. TUBING PRESS.	CASING PRESSURE	CALCULATED 24-HOUR RATE	OIL—BBL.	GAS—MCF.	WATER—BBL.	OIL GRAVITY-API (CORR.)	
230#	Pkr			1400			

34. DISPOSITION OF GAS (Sold, used for fuel, vented, etc.) Vented TEST WITNESSED BY Harvey Apple

35. LIST OF ATTACHMENTS Plat

36. I hereby certify that the foregoing and attached information is complete and correct as determined from all available records

SIGNED Christine J. Anderson TITLE Geol. Secty. DATE 2-23-80

\*(See Instructions and Spaces for Additional Data on Reverse Side)

# INSTRUCTIONS

**General:** This form is designed for submitting a complete and correct well completion report and log on all types of lands and leases to either a Federal agency or a State agency, or both, pursuant to applicable Federal and/or State laws and regulations. Any necessary special instructions concerning the use of this form and the number of copies to be submitted, particularly with regard to local, area, or regional procedures and practices, either are shown below or will be issued by, or may be obtained from, the local Federal and/or State office. See instructions on Items 22 and 24, and 33, below regarding separate reports for separate completions.

If not filed prior to the time this summary record is submitted, copies of all currently available logs (drillers, geologists, sample and core analysis, all types electric, etc.), formation and pressure tests, and directional surveys, should be attached hereto, to the extent required by applicable Federal and/or State laws and regulations. All attachments should be listed on this form, see item 33.

**Item 4:** If there are no applicable State requirements, locations on Federal or Indian land should be described in accordance with Federal requirements. Consult local State or Federal office for specific instructions.

**Item 18:** Indicate which elevation is used as reference (where not otherwise shown) for depth measurements given in other spaces on this form and in any attachments.

**Items 22 and 24:** If this well is completed for separate production from more than one interval zone (multiple completion), so state in item 22, and in item 24 show the producing interval, or intervals, top(s), bottom(s) and name(s) (if any) for only the interval reported in item 33. Submit a separate report (page) on this form, adequately identified, for each additional interval to be separately produced, showing the additional data pertinent to such interval.

**Item 29:** "Sacks Cement". Attached supplemental records for this well should show the details of any multiple-stage cementing and the location of the cementing tool.

**Item 33:** Submit a separate completion report on this form for each interval to be separately produced. (See instruction for items 22 and 24 above.)

## 37. SUMMARY OF POROUS ZONES:

SHOW ALL IMPORTANT ZONES OF POROSITY AND CONTENTS THEREOF; CORREL INTERVALS; AND ALL DRILL-STEM TESTS, INCLUDING DEPTH INTERVAL TESTED, CUSHION USED, TIME TOOL OPEN, PLOWING AND SHUT-IN PRESSURES, AND RECOVERIES

FORMATION	TOP	BOTTOM	DESCRIPTION, CONTENTS, ETC.	NAME	MEAS. DEPTH	TRUE VERT. DEPTH
				San Andres	565'	
				Glorieta	1570'	
				Abo	3638'	
				Wolfcamp	4410'	

38.

## GEOLOGIC MARKERS

**NEW MEXICO OIL CONSERVATION COMMISSION  
WELL LOCATION AND ACREAGE DEDICATION PLAT**

Form C-102  
Supersedes C-128  
Effective 1-1-65

All distances must be from the outer boundaries of the Section.

Operator <b>Yates Petroleum Corporation</b>		Lease <b>McClellan MB Federal</b>		Well No. <b>1</b>
Unit Letter <b>L</b>	Section <b>31</b>	Township <b>5 South</b>	Range <b>25 East</b>	County <b>Chaves</b>
Actual Footage Location of Well: <b>1980.</b> feet from the <b>South</b> line and <b>660</b> feet from the <b>West</b> line				
Ground Level Elev. <b>3855.9'</b>	Producing Formation <b>Abo</b>	Pool <del>Wildcat</del> <b>Landmark</b>	Dedicated Acreage: <b>160.20</b> Acres	

1. Outline the acreage dedicated to the subject well by colored pencil or hatchure marks on the plat below.
2. If more than one lease is dedicated to the well, outline each and identify the ownership thereof (both as to working interest and royalty).
3. If more than one lease of different ownership is dedicated to the well, have the interests of all owners been consolidated by communitization, unitization, force-pooling, etc?

☐ Yes    ☐ No    If answer is "yes," type of consolidation \_\_\_\_\_

If answer is "no," list the owners and tract descriptions which have actually been consolidated. (Use reverse side of this form if necessary.) \_\_\_\_\_

No allowable will be assigned to the well until all interests have been consolidated (by communitization, unitization, forced-pooling, or otherwise) or until a non-standard unit, eliminating such interests, has been approved by the Commission.

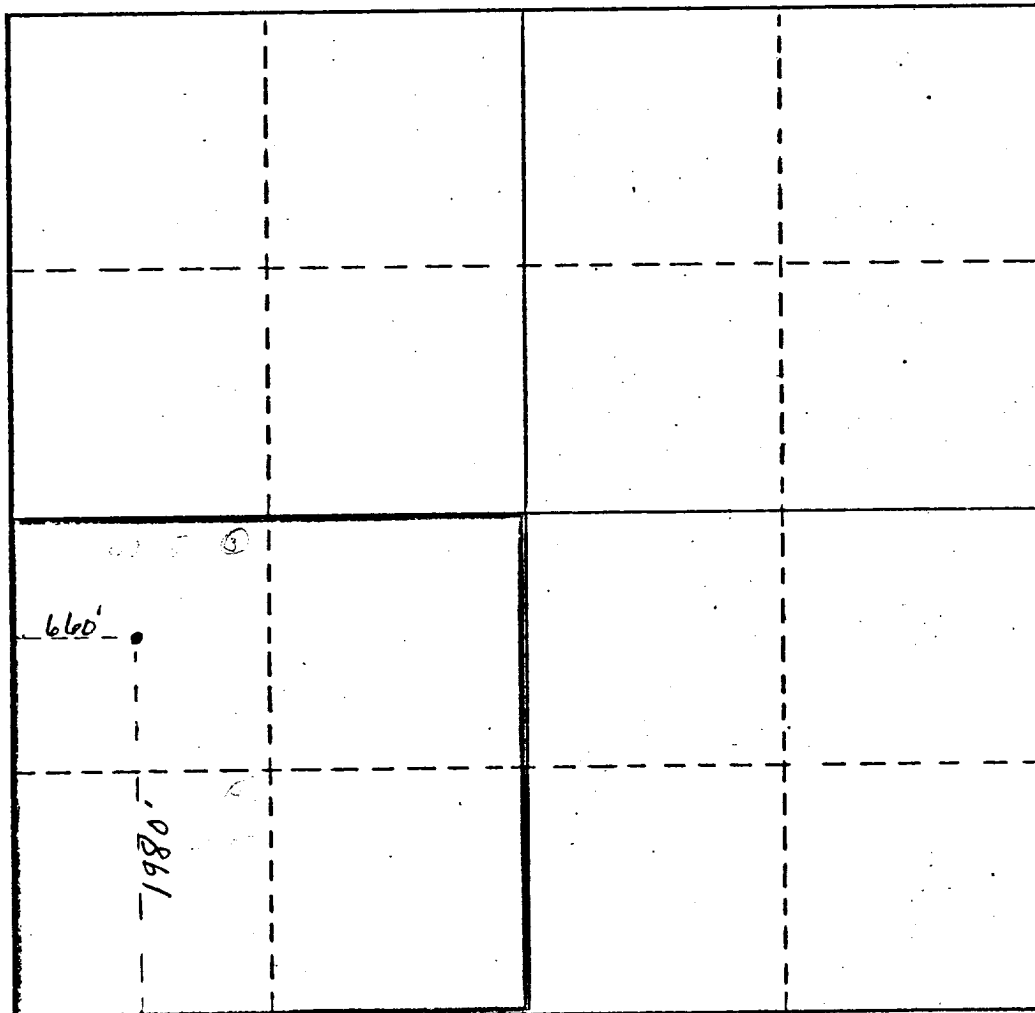

**CERTIFICATION**

I hereby certify that the information contained herein is true and complete to the best of my knowledge and belief.

*Christine Tomlinson*  
Name

**Christine Tomlinson**

Position

**Geol. Secty.**

Company

**Yates Petroleum Corp**

Date

**2-23-80**

I hereby certify that the well location shown on this plat was plotted from field notes of actual surveys made by me or under my supervision, and that the same is true and correct to the best of my knowledge and belief.

**Refer to Original Plat**

Date Surveyed

**Dated 10-2-79**

Registered Professional Engineer  
and/or Land Surveyor

Certificate No.

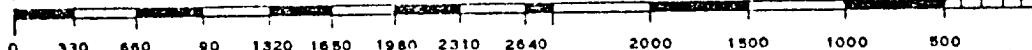



# LaRue Drilling Co., Inc.

JAN 30 1980

PHONE: 505-746-4405

P. O. BOX 202

ARTESIA, NEW MEXICO 88210

January 28, 1980

Yates Petroleum Corporation  
207 South Fourth St.  
Artesia, New Mexico 88210

RECEIVED

MAY 22 1980

O. C. D.  
ARTESIA, OFFICE

Re: McClellan MB Fed #1  
1980' FSL & 660' FWL  
Section 31, T5S, R25E  
Chaves County, New Mexico

Gentlemen:

The following is a Deviation Survey of the above captioned well:

Depth	Deviation
362'	1/4°
979'	1/4°
1530'	1/2°
2339'	1/2°
3088'	1°
3410'	1°
3584'	1°
3850'	1°
4485'	1°
4650'	1°

Very truly yours,

B. N. Muncy, Jr.  
Secretary

STATE OF NEW MEXICO  
COUNTY OF EDDY

The foregoing was acknowledged before me this 28th day of January, 1980.

