

NO. OF COPIES RECEIVED		
DISTRIBUTION		
SANTA FE	1	
FILE	1	✓
U.S.G.S.	2	
LAND OFFICE	1	
OPERATOR	1	

NEW MEXICO OIL CONSERVATION COMMISSION

JAN 11 1980

O. C. D.
ARTESIA, COLORADO

30-005-60637

Form C-101
Revised 1-1-65

5A. Indicate Type of Lease	
STATE <input checked="" type="checkbox"/>	FEE <input type="checkbox"/>
5. State Oil & Gas Lease No.	
L 4039	

APPLICATION FOR PERMIT TO DRILL, DEEPEN, OR PLUG BACK

1a. Type of Work		7. Unit Agreement Name	
b. Type of Well DRILL <input checked="" type="checkbox"/> DEEPEN <input type="checkbox"/> PLUG BACK <input type="checkbox"/> OIL WELL <input checked="" type="checkbox"/> GAS WELL <input type="checkbox"/> OTHER <input type="checkbox"/> SINGLE ZONE <input checked="" type="checkbox"/> MULTIPLE ZONE <input type="checkbox"/>		8. Farm or Lease Name WFM State	
2. Name of Operator Martin B. Muncy ✓		9. Well No. 1	
3. Address of Operator P.O. Box 196 Artesia, New Mexico 88210		10. Field and Pool, or Wildcat WILDCAT	
4. Location of Well UNIT LETTER A LOCATED 330 FEET FROM THE NORTH LINE 330 EAST 36 6 S 27 E AND FEET FROM THE LINE OF SEC. TWP. RGE. NMPM		12. County Chaves	
19. Proposed Depth 2600		19A. Formation San Andres	20. Rotary or C.T. C.T.
21. Elevations (Show whether DF, RT, etc.) 3940.8 GL	21A. Kind & Status Plug. Bond single well	21B. Drilling Contractor Fred Cogburn	22. Approx. Date Work will start January 18, 1980

23.

PROPOSED CASING AND CEMENT PROGRAM

SIZE OF HOLE	SIZE OF CASING	WEIGHT PER FOOT	SETTING DEPTH	SACKS OF CEMENT	EST. TOP
12"	8 5/8"	20#	250'	120	circulated
8"	4 1/2"	10 1/2#	2600'	200	1400'

APPROVAL VALID
FOR 90 DAYS UNLESS
DRILLING COMMENCED,

EXPIRES 4-17-80

IN ABOVE SPACE DESCRIBE PROPOSED PROGRAM: IF PROPOSAL IS TO DEEPEN OR PLUG BACK, GIVE DATA ON PRESENT PRODUCTIVE ZONE AND PROPOSED NEW PRODUCTIVE ZONE. GIVE BLOWOUT PREVENTER PROGRAM, IF ANY.

I hereby certify that the information above is true and complete to the best of my knowledge and belief.

Signed Martin B. Muncy Title OPERATOR Date Jan. 10. 1980

(This space for State Use)

APPROVED BY W.A. Gressett TITLE SUPERVISOR, DISTRICT II DATE JAN 17 1980

CONDITIONS OF APPROVAL, IF ANY:

Cement must be circulated to
surface behind 8 5/8" casing

NEW MEXICO OIL CONSERVATION COMMISSION
WELL LOCATION AND ACREAGE DEDICATION PLAT

Form C-102
Supersedes C-128
Effective 1-1-65

All distances must be from the outer boundaries of the Section

Operator Martin B Muncy			Lease WIM State		Well No. 1
Unit Letter A	Section 36	Township 6 South	Range 27 East	County Chaves	
Actual Footage Location of Well: 330 feet from the North line and 330 feet from the East line					
Ground Level Elev. 3940.8	Producing Formation Son Ardo		Pool W 22 East	Dedicated Acreage: 40 Acres	

- Outline the acreage dedicated to the subject well by colored pencil or hachure marks on the plat below.
- If more than one lease is dedicated to the well, outline each and identify the ownership thereof (both as to working interest and royalty).
- If more than one lease of different ownership is dedicated to the well, have the interests of all owners been consolidated by communitization, unitization, force-pooling, etc?

☐ Yes ☐ No If answer is "yes," type of consolidation _____

If answer is "no," list the owners and tract descriptions which have actually been consolidated. (Use reverse side of this form if necessary.) _____

No allowable will be assigned to the well until all interests have been consolidated (by communitization, unitization, forced-pooling, or otherwise) or until a non-standard unit, eliminating such interests, has been approved by the Commission.

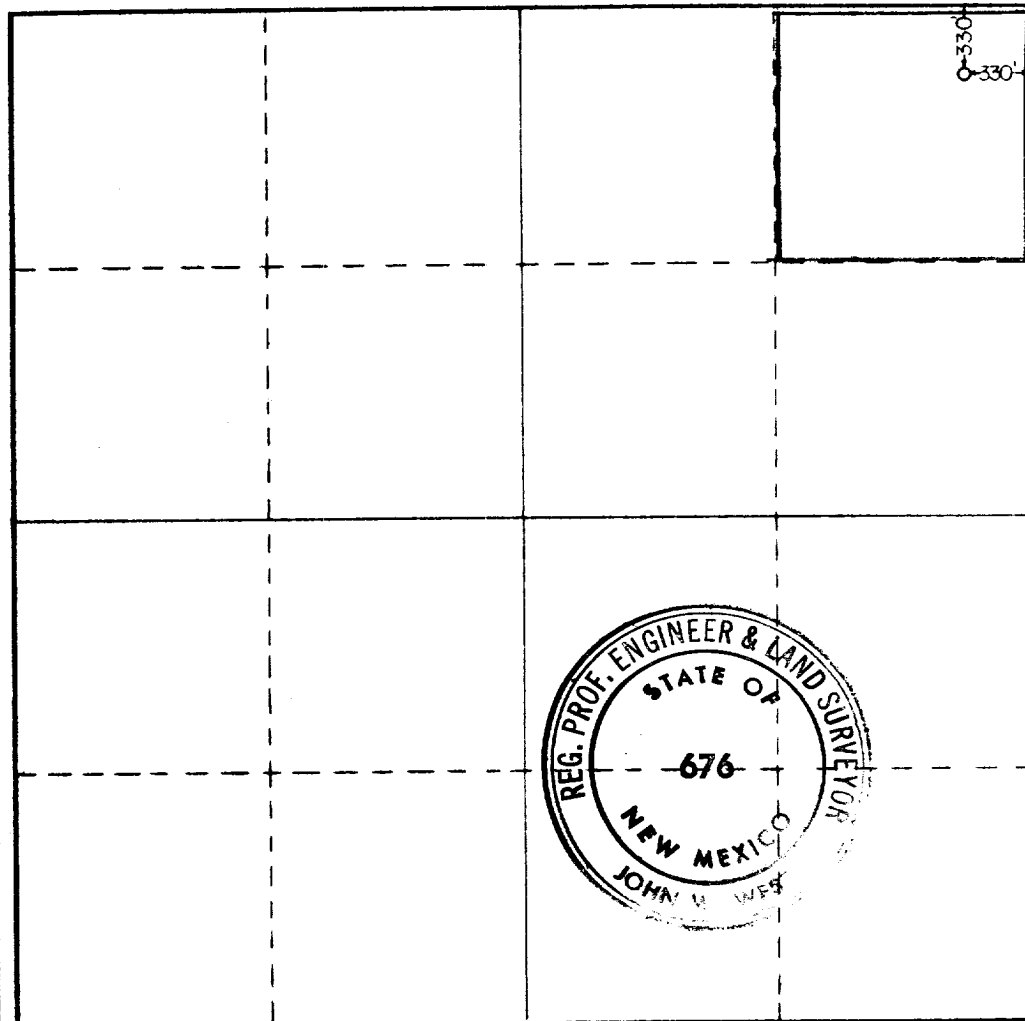

CERTIFICATION

I hereby certify that the information contained herein is true and complete to the best of my knowledge and belief.

Name: **Martin B Muncy**

Position: **operator**

Company: **MARTIN B MUNCY**

Date: **January 9, 1980**

I hereby certify that the well location shown on this plat was plotted from field notes of actual surveys made by me or under my supervision, and that the same is true and correct to the best of my knowledge and belief.

Date surveyed: **January 4, 1980**

Registered Professional Engineer and Land Surveyor

John W. West

Certificate No. **John W. West 676**
Ronald J. Eidson 3239

