

NO. OF COPIES RECEIVED	
DISTRIBUTION	
SANTA FE	1
FILE	1 ✓
U.S.G.S.	2
LAND OFFICE	
OPERATOR	1

NEW MEXICO OIL CONSERVATION COMMISSION

JAN 22 1980

O. C. D.  
ARTESIA OFFICE

30-005-60638

Form C-101  
Revised 1-1-65

5A. Indicate Type of Lease STATE <input type="checkbox"/> FEE <input checked="" type="checkbox"/>
5. State Oil & Gas Lease No.
7. Unit Agreement Name
8. Farm or Lease Name UNION - JOY
9. Well No. 1
10. Field and Pool, or Wildcat Wildcat
12. County Chaves
18. Proposed Depth 2800'
19A. Formation San Andres
20. Rotary or C.T. C.T.
21. Elevation (Show whether D.P., R.T., etc.) 4020'
21A. Kind & Status Plug Bond Blanket
21B. Drilling Contractor J. B. Adamson
22. Approx. Date Work will start As soon as approved

APPLICATION FOR PERMIT TO DRILL, DEEPEN, OR PLUG BACK

1a. Type of Work b. Type of Well OIL WELL <input checked="" type="checkbox"/> GAS WELL <input type="checkbox"/> OTHER <input type="checkbox"/> 2. Name of Operator Ralph Nix ✓ 3. Address of Operator P. O. Box 617, Artesia, New Mexico 88210 4. Location of Well UNIT LETTER L LOCATED 2310 FEET FROM THE South LINE AND 330 FEET FROM THE West LINE OF SEC. 32 TWP. 7-S RGE. 29-E NMRM	5. Type of Well DRILL <input checked="" type="checkbox"/> DEEPEN <input type="checkbox"/> PLUG BACK <input type="checkbox"/> 6. Name of Operator Ralph Nix ✓ 7. Address of Operator P. O. Box 617, Artesia, New Mexico 88210 8. Location of Well UNIT LETTER L LOCATED 2310 FEET FROM THE South LINE AND 330 FEET FROM THE West LINE OF SEC. 32 TWP. 7-S RGE. 29-E NMRM
--	---

PROPOSED CASING AND CEMENT PROGRAM					
SIZE OF HOLE	SIZE OF CASING	WEIGHT PER FOOT	SETTING DEPTH	SACKS OF CEMENT	EST. TOP
10"	8 5/8"	24#	650'	Mud	
8"	4 1/2"	10.5#	T.D.	100	

Before the oil string is run, surface pipe will be cemented with fifty sacks.

4-23-80

IN ABOVE SPACE DESCRIBE PROPOSED PROGRAM; IF PROPOSAL IS TO DEEPEN OR PLUG BACK, GIVE DATA ON PRESENT PRODUCTIVE ZONE AND PROPOSED NEW PRODUCTIVE ZONE. GIVE BLOWOUT PREVENTER PROGRAM, IF ANY.

I hereby certify that the information above is true and complete to the best of my knowledge and belief.

Signed William J. Mitchell Title Operations Manager Date 1/21/80

(This space for State Use)

APPROVED BY W. A. Grassett TITLE SUPERVISOR, DISTRICT II DATE JAN 23 1980

CONDITIONS OF APPROVAL, IF ANY:

8 5/8"

NEW MEXICO OIL CONSERVATION COMMISSION  
WELL LOCATION AND ACREAGE DEDICATION PLAT

Form C-102  
Supersedes C-128  
Effective 1-1-65

All distances must be from the outer boundaries of the Section.

Operator <b>Ralph Nix</b>			Lease <b>Union - Joy</b>		Well No. <b>1</b>
Unit Letter <b>L</b>	Section <b>32</b>	Township <b>7 South</b>	Range <b>29 East</b>	County <b>Chaves</b>	
Actual Footage Location of Well: <b>2310</b> feet from the <b>South</b> line and <b>330</b> feet from the <b>West</b> line					
Ground Level Elev. <b>4020</b>	Producing Formation <b>San Andres</b>		Pool <b>Wildcat San Andres</b>		Dedicated Acreage: <b>40</b> Acres

1. Outline the acreage dedicated to the subject well by colored pencil or hatchure marks on the plat below.
2. If more than one lease is dedicated to the well, outline each and identify the ownership thereof (both as to working interest and royalty).
3. If more than one lease of different ownership is dedicated to the well, have the interests of all owners been consolidated by communitization, unitization, force-pooling, etc?

☐ Yes ☐ No If answer is "yes," type of consolidation \_\_\_\_\_

If answer is "no," list the owners and tract descriptions which have actually been consolidated. (Use reverse side of this form if necessary.) \_\_\_\_\_

No allowable will be assigned to the well until all interests have been consolidated (by communitization, unitization, forced-pooling, or otherwise) or until a non-standard unit, eliminating such interests, has been approved by the Commission.

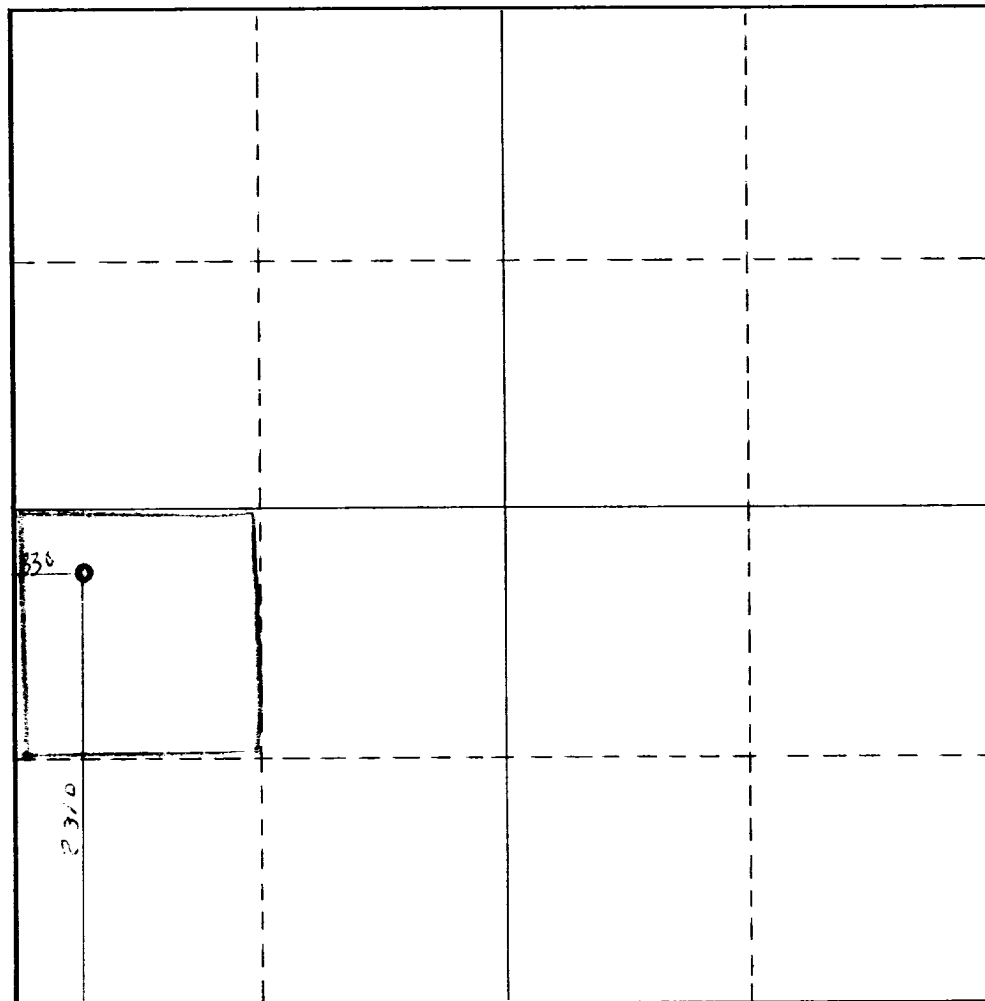

CERTIFICATION

I hereby certify that the information contained herein is true and complete to the best of my knowledge and belief.

Name *John J. Nix*  
Position  
**Operations Manager**  
Company  
**Ralph Nix Oil Co.**  
Date  
**January 21, 1980**

I hereby certify that the well location shown on this plat was plotted from field notes of actual surveys made by me or under my supervision, and that the same is true and correct to the best of my knowledge and belief.

Date Surveyed  
**January 18, 1980**

Registered Professional Engineer  
and/or Land Surveyor

*John A. Mathis Jr*

Certificate No.

**1502**

0 330 660 990 1320 1650 1980 2310 2640 2000 1500 1000 500 0