

NO. OF COPIES RECEIVED	
DISTRIBUTION	
SANTA FE	1
FILE	1
U.S.G.S.	2
LAND OFFICE	
OPERATOR	1

NEW MEXICO OIL CONSERVATION COMMISSION

RECEIVED

JAN 28 1980

O. C. O.

ARTESIA OFFICE

30-005-60641

Form C-101  
Revised 1-1-65

5A. Indicate Type of Lease  
STATE ☐ FILE ☒

5. State Oil & Gas Lease No.

APPLICATION FOR PERMIT TO DRILL, DEEPEN, OR PLUG BACK

1a. Type of Work b. Type of Well OIL WELL <input checked="" type="checkbox"/> GAS WELL <input type="checkbox"/> OTHER <input type="checkbox"/> DRILL <input checked="" type="checkbox"/> DEEPEN <input type="checkbox"/> PLUG BACK <input type="checkbox"/> SINGLE ZONE <input checked="" type="checkbox"/> MULTIPLE ZONE <input type="checkbox"/>		7. Unit Agreement Name
2. Name of Operator C. E. LaRue and B. N. Muncy, Jr.		8. Farm or Lease Name Eddie
3. Address of Operator P. O. Box 196 Artesia, N. M. 88210		9. Well No. 1
4. Location of Well UNIT LETTER L LOCATED 2310 FEET FROM THE South LINE AND 330 FEET FROM THE West LINE OF SEC. 29 TWP. 7S RGE. 29E N41PM		10. Field and Pool, or Well Unit Wildcat San Andres
		11. County Chaves
		12. Proposed Depth 2750'
		13. Formation San Andres
		14. Property or C.T. C. T.
21. Elevations (Show whether DT, KI, etc.) 4018 GL	21A. Kind of States Plug. Bond Statewide ;	21B. Drilling Contractor J. B. Adamson
		22. Approx. Date Work will start 1/29/80

PROPOSED CASING AND CEMENT PROGRAM

SIZE OF HOLE	SIZE OF CASING	WEIGHT PER FOOT	SETTING DEPTH	SACKS OF CEMENT	EST. TOP
12"	8 5/8"	20#	200'	100	Circulated
8"	4 1/2"	10 1/2#	2,750'	250	1400'

APPROVAL VALID  
FOR 90 DAYS UNLESS  
DRILLING COMMENCED,

EXPIRES 4-30-80

IN ABOVE SPACE DESCRIBE PROPOSED PROGRAM; IF PROPOSAL IS TO DEEPEN OR PLUG BACK, GIVE DATA ON PRESENT PRODUCTIVE ZONE AND PROPOSED NEW PRODUCTIVE ZONE. GIVE BLOWOUT PREVENTER PROGRAM, IF ANY.

I hereby certify that the information above is true and complete to the best of my knowledge and belief.

Signed [Signature] Title Operator Date 1/21/80

(This space for State Use)

APPROVED BY [Signature] TITLE SUPERVISOR, DISTRICT II DATE JAN 30 1980

CONDITIONS OF APPROVAL, IF ANY:

additional surface casing may  
be necessary

NEW MEXICO OIL CONSERVATION COMMISSION  
WELL LOCATION AND ACREAGE DEDICATION PLAT

Form C-102  
Supersedes C-128  
Effective 1-1-65

All distances must be from the outer boundaries of the Section.

Operator <b>CE. LaRue &amp; Muncy, Jr.</b>		Lease <b>Eddie</b>		Well No. <b>1</b>
Unit Letter <b>L</b>	Section <b>29</b>	Township <b>7 South</b>	Range <b>29 East</b>	County <b>Chaves</b>
Actual Footage Location of Well: <b>2310</b> feet from the <b>South</b> line and <b>330</b> feet from the <b>West</b> line				
Ground Level Elev. <b>4038</b>	Producing Formation <b>San Andres</b>	Pool <b>Wildcat</b>	Dedicated Acreage: <b>40</b> Acres	

1. Outline the acreage dedicated to the subject well by colored pencil or hatchure marks on the plat below.
2. If more than one lease is dedicated to the well, outline each and identify the ownership thereof (both as to working interest and royalty).
3. If more than one lease of different ownership is dedicated to the well, have the interests of all owners been consolidated by communitization, unitization, force-pooling, etc?

RECEIVED

JAN 28 1980

O. C. D.

ARTERIAL C. 1978

☐ Yes ☐ No If answer is "yes," type of consolidation \_\_\_\_\_

If answer is "no," list the owners and tract descriptions which have actually been consolidated. (Use reverse side of this form if necessary.) \_\_\_\_\_

No allowable will be assigned to the well until all interests have been consolidated (by communitization, unitization, forced-pooling, or otherwise) or until a non-standard unit, eliminating such interests, has been approved by the Commission.

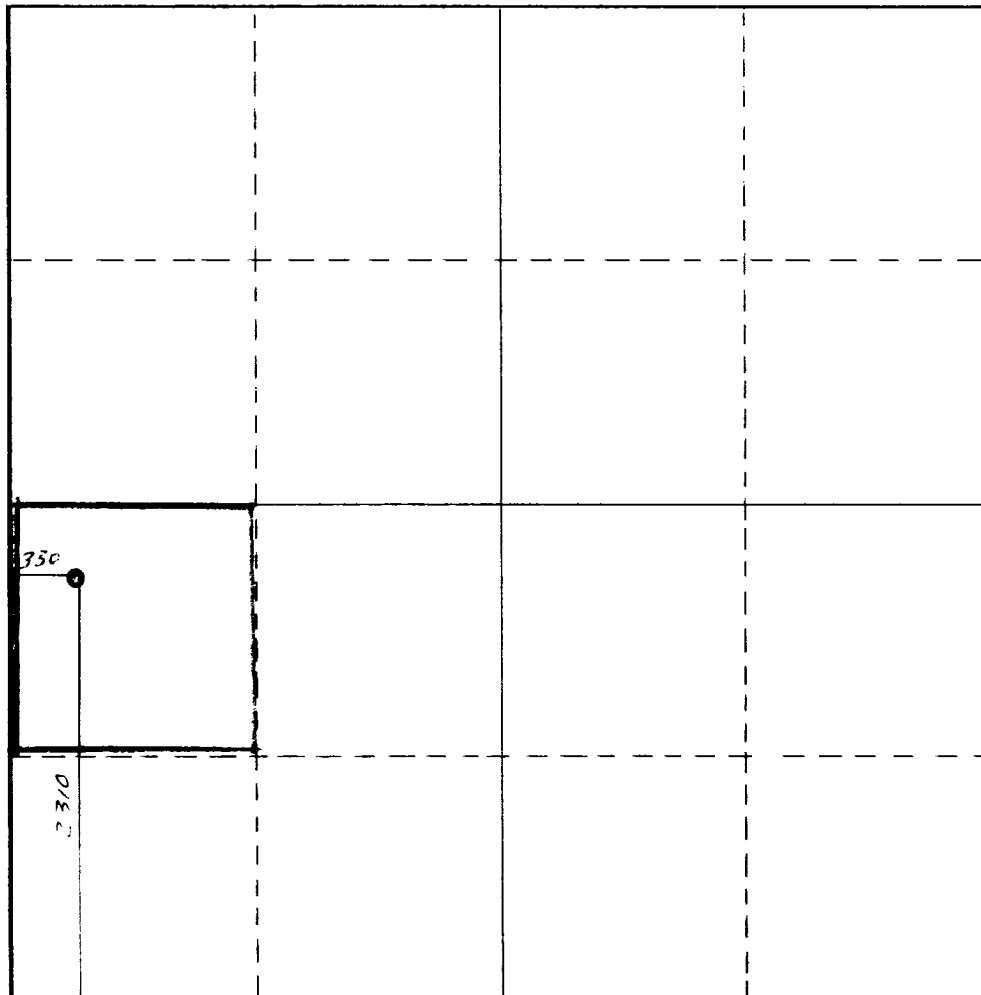

CERTIFICATION

I hereby certify that the information contained herein is true and complete to the best of my knowledge and belief.

Name  
*[Signature]*  
Position  
Operator  
Company  
**LaRue and Muncy**  
Date  
**January 21, 1980**

I hereby certify that the well location shown on this plat was plotted from field notes of actual surveys made by me or under my supervision, and that the same is true and correct to the best of my knowledge and belief.

Date Surveyed  
**January 18, 1980**  
Registered Professional Engineer and/or Land Surveyor  
*[Signature]*

Certificate No.  
**1502**

