

NEW MEXICO OIL CONSERVATION COMMISSION
WELL LOCATION AND ACREAGE DEDICATION PLAT

Form C-102
Supersedes C-128
Effective 1-4-65

All distances must be from the outer boundaries of the Section.

Operator H. E. PRINCE			Lease FED. #12		Well No. 12
Unit Letter N	Section 33	Township 6 S	Range 26 E	County CHAVEZ	
Actual Footage Location of Well: 1650 feet from the West line and 990 feet from the South line					
Ground Level Elev. 3603.0	Producing Formation SAN ANDRES	Pool LINDA SAN ANDRES	Dedicated Acreage: 40 Acres		

1. Outline the acreage dedicated to the subject well by colored pencil or hachure marks on the plat below.
2. If more than one lease is dedicated to the well, outline each and identify the ownership thereof (both as to working interest and royalty).
3. If more than one lease of different ownership is dedicated to the well, have the interests of all owners been consolidated by communitization, unitization, force-pooling, etc?

☐ Yes ☐ No If answer is "yes," type of consolidation _____

If answer is "no," list the owners and tract descriptions which have actually been consolidated. (Use reverse side of this form if necessary.) _____

No allowable will be assigned to the well until all interests have been consolidated (by communitization, unitization, forced-pooling, or otherwise) or until a non-standard unit, eliminating such interests, has been approved by the Commission.

R26E

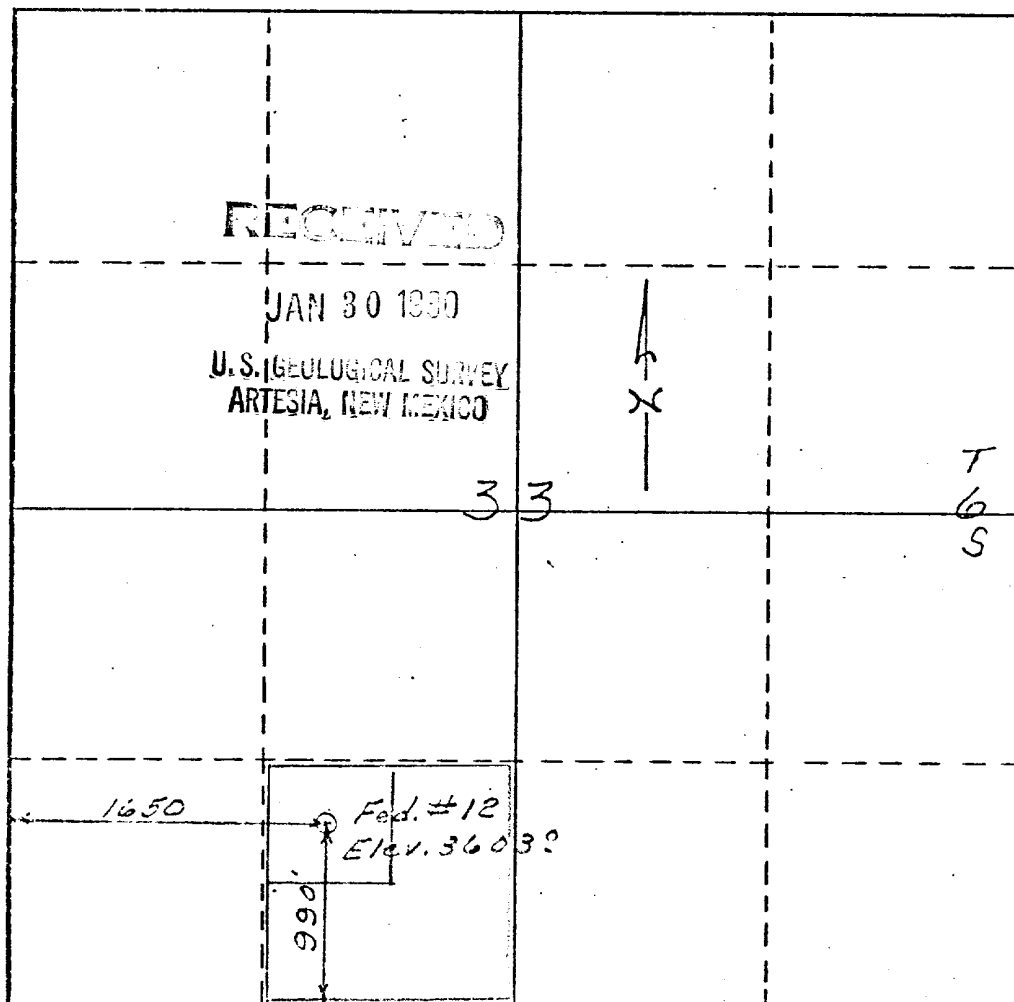

CERTIFICATION

I hereby certify that the information contained herein is true and complete to the best of my knowledge and belief.

H. E. Prince
Name
owner-operator
Position
Company
Date
1/2/80

I hereby certify that the well location shown on this plat was plotted from field notes of actual surveys made by me or under my supervision, and that the same is true and correct to the best of my knowledge and belief.

Jan. 3, 1930
Date Surveyed
W. H. Q. [Signature]
Registered Professional Engineer
and/or Land Surveyor
1111 #3954
Certificate No.

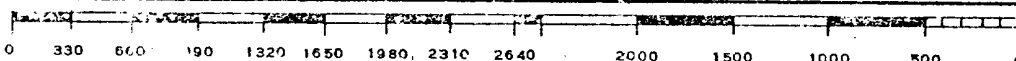



N.M.O.C.D. COPY

United States Department of the Interior

GEOLOGICAL SURVEY

P. O. Drawer U
Artesia, New Mexico 88210

RECEIVED

FEB 15 1980

O. C. D.
ARTESIA, OFFICE

February 14, 1980

H. E. Prince
P. O. Box 129
Roswell, New Mexico 88201

Gentlemen:

H. E. PRINCE
Federal No. 12
990 FSL 1650 FWL Sec. 33 T.6S R.26E
Chaves County Lease No. LC 068127

Above Data Required on Well Sign

Your APPLICATION FOR PERMIT TO DRILL the above-described well to a depth of 1,169 feet to test the San Andres formation is hereby approved subject to compliance with the OIL AND GAS OPERATING REGULATIONS (30 CFR 221) and the following conditions:

1. Drilling operations authorized are subject to compliance with the GENERAL REQUIREMENTS FOR OIL AND GAS OPERATIONS ON FEDERAL LEASES, dated July 1, 1978.
2. Prior to commencing construction of road, pad, or other associated developments, operator will provide the dirt contractor with a copy of the SURFACE USE PLAN and this approval including the GENERAL REQUIREMENTS.
3. Submit a Daily Report of Operations from spud date until the Well Completion Report (form 9-330) is filed. The progress report should be not less than 8" x 5" in size and each page should identify the well.
4. All permanent above-ground structures and equipment shall be painted in accordance with the attached Painting Requirements. The color used should simulate Sandstone Brown (Federal Standard No. 595A, color 20318 or 30318).
5. Cement behind the 8-5/8" casing must be circulated.
6. Please have anyone contacting the Survey in regard to this well to identify the well with all of the information required above for the well sign.

Sincerely yours,

GEORGE H. STEWART

George H. Stewart
Acting District Engineer





H. E. PRINCE

Construction & Petroleum

BOX 129

ROSWELL, NEW MEXICO 88201 U.S.A.

622-7708



Federal Well # 12
1650 FWL & 990 FSL
Sec.33 TS 6S R. 26E
Chaves County
New Mexico

In conjunction with form 9-331C the following information is provided for U. S. G. S. requirements.

1. The geologic surface formation is loamy sand with gravel.
2. The estimate tops of geologic markers are as follows;
Queen 700 feet, San Andres 1160feet.
3. The estimated depths of anticipated water, oil and gas formations are expected as follows:
Water: 1100' to 1150'
Gas: None except a small amount at 1160' in San Andres
Oil: Approximately 1160' to 1176'
4. Proposed casing program: See Form 9-331C.
5. Pressure Control Equipment: None
6. Mud program: None
7. Auxiliary equipment: None
8. Testing, logging and coring program:
Testing - as warranted
Logging - Gamma Ray and neutron
9. No adnormal pressures or temperatures are anticipated
10. Anticipated starting date: As soon as possible.



H. E. PRINCE

Construction & Petroleum

BOX 129

ROSWELL, NEW MEXICO 88201 U.S.A.

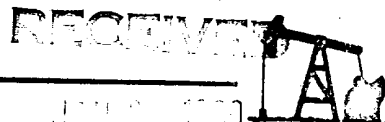

622-7708

U.S. DEPARTMENT OF THE INTERIOR
BUREAU OF LAND MANAGEMENT

MULTI-POINT SURFACE USE AND OPERATION

This plan is submitted with Form 9-331C, Application for Permit to Drill, covering the described well. The purpose of this plan is to describe the location of the proposed well, the proposed construction activities and operation plan, the magnitude of surface disturbance involved, and the procedures to be followed in rehabilitating the surface after completion of the operations, so that a complete appraisal can be made of the environmental effect associated with the operation.

1. EXISTING ROADS.

- A. Exhibit A State and County road map marked in red shows route off of highway 70 north of Roswell to well site on existing road. Exhibit D, U.S.G.S. quadrangle map showing location of proposed well site.

DIRECTIONS:

- 1. Proceed north east of Roswell on highway 70 twenty miles to an old abandoned school building. Turn left on existing access road ten miles to a tall metal sign, turn left and go one mile to Sturgeon ranch continue thru yard to right and go one mile to site it being of the left at this point.

2. PLANNED ACCESS ROAD.

- A. The proposed new road will be 100 feet long from the point of origin the edge of pad. The road will be in a north to south direction.
- B. The new road will be 12 feet wide except at the point of origin, adjacent to the existing road, at this point additional width will be provided to allow turning of equipment.
- C. The new road will be graded using existing sand and gravel as surface. The surface will be crowned, with drainage on both sides. No turnouts will be necessary.
- D. The center line of the new road has been center flagged thus making the route of the road clearly visible.

3. LOCATION OF EXISTING WELLS

- A. The well location in the vicinity of the proposed well are shown of map exhibit B. There is no drilling activity within a one mile radius.

4. LOCATION OF EXISTING AND PROPOSED FACILITIES.

- A. There is a producing well on this lease at the present time.
- B. If the well is productive, the necessary production facilities will be installed on the drilling pad. All production equipment will be electrical. Existing tank battery to be used.

5. LOCATION AND TYPE OF WATER SUPPLY.

- A. Fresh water will be used for drilling purposes. The water will be obtained from commercial sources and will be trucked to site over existing access road as shown on exhibit A.

6. SOURCE OF CONSTRUCTION MATERIALS.

- A. All materials used in construction of pad and new access road will be from existing surface material on the pad and road it being sand and gravel surface.

7. METHODS OF HANDLING WASTE DISPOSAL.

- A. Drill cutting will be disposed of in the reserve pit.
- B. Drilling fluids will be allowed to evaporate in the reserve pits until pits are dry.
- C. Water produced during operation will be collected and removed to an approved disposal site.
- D. Oil produced during operation will be stored in tanks until sold.
- E. Current laws and regulations pertaining to disposal of human waste will be complied with.
- F. All trash, garbage and etc. will be contained and later buried 24" deep.
- G. All trash and debris will be buried or removed from site within 30 days after completion of well.

8. ANCILLARY FACILITIES.

- A. None required

9. WELLSITE LAYOUT.

- A. Exhibit C shows dimensions of well pad and reserve pit, and location of drilling unit, pipe rack and other components.
- B. The ground surface at the drilling location will require no cutting or leveling.
- C. The reserve pit will be plastic lined.
- D. The pad and pit area have been center flagged.

10. PLANS FOR RESTORATION OF THE SURFACE.

- A. After completion, all equipment and other material not needed for further operations will be removed leaving the site cleared of all debris and in as aesthetically pleasing condition as possible.
- B. All pits will be fenced until filled.
- C. If the proposed well is non-productive, all rehabilitation and or vegetation requirements of the B. L. M. and the U. S. G. S. will be complied with and will be accomplished as expeditiously as possible. All pits will be filled and leveled within 90 days after abandonment.

11. TOPOGRAPHY.

- A. The well site and access route are located in a flat area.
- B. The top soil at the well site is sand and gravel.
- C. The vegetation cover at the well site is miscue bushes, prairie grasses and weeds.
- D. No wildlife was observed but it is likely that some rabbits, insects, and rodents are in the area. The area is used for cattle grazing.
- E. The Pecos River is about 3/4 of a mile away and an irrigation pond about 1/2 mile away from the well site.
- F. There is an existing ranch house and pens about one mile from the well site.
- G. The well site is located on Federal surface.
- H. There is no evidence of any archaeological, historical, or cultural sites in the vicinity of the location.

12. OPERATORS'S REPRESENTATIVES.

A. The field representatives responsible for assuring compliance with the approved surface use plan are:

H. E. Prince
Operator
622-7708
Roswell, New Mexico

Steve Prince
Supertendent
623-7708
Roswell, New Mexico

13. CERTIFICATION.

I hereby certify that I, or persons under my direction supervision, have inspected the proposed drill site and access route; that I am familiar with the conditions which presently exist; that the statements made in this plan are, to the best of my knowledge, true and correct; and that the work associated with the operation proposed herein will be performed by H. E. Prince Construction and Petroleum in conformity with this plan and the terms and conditions under which it is approved.

11/10/80
Date

H.E. Prince

PHD 44Y001
EXHIBIT-C
Fed. Well #12
1660' F.W.D. & 990' F.S.L.
SEC. 33 T6S R. 26E

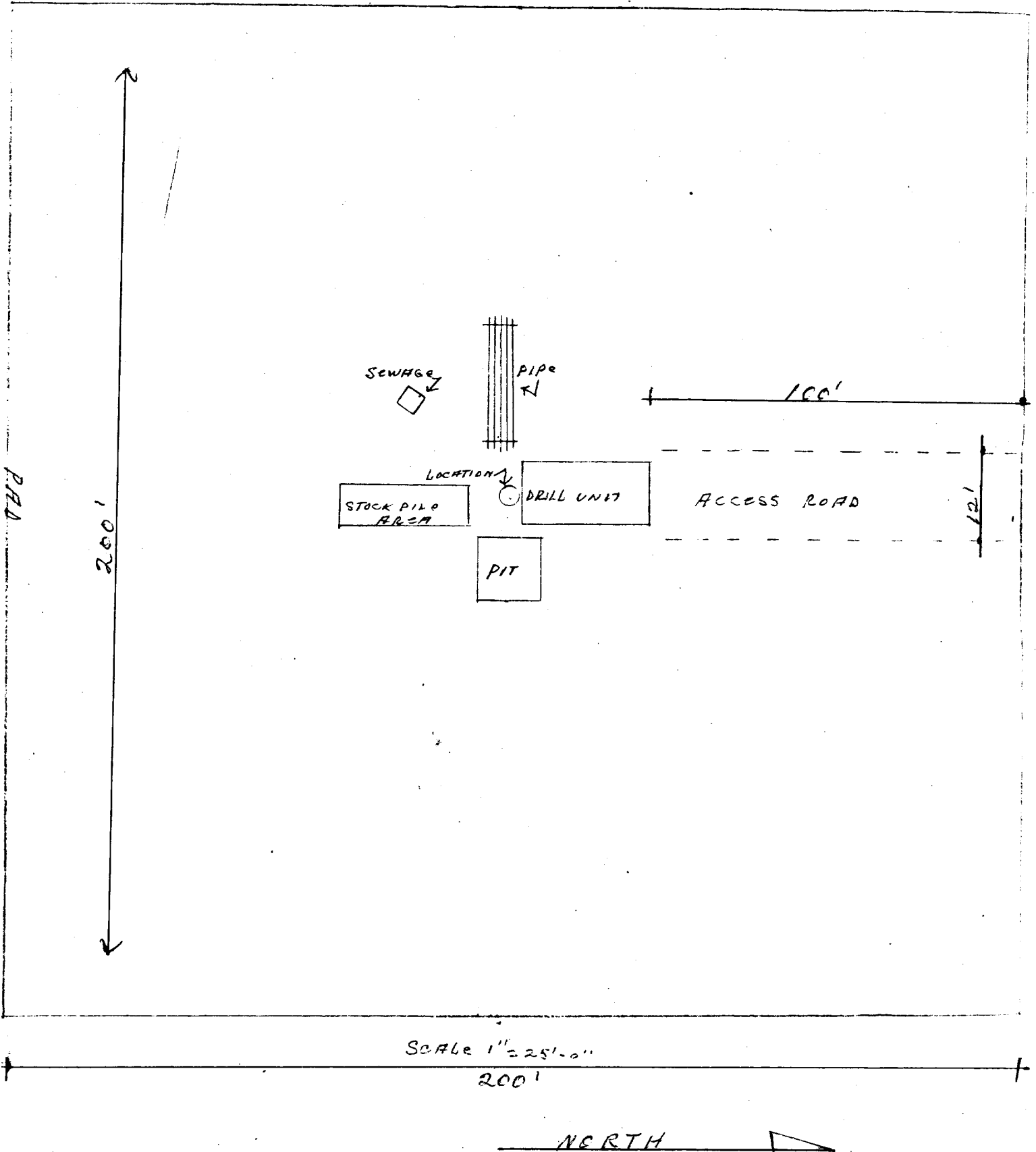

NORTH

LOCATION OF EXISTING & PROPOSED FACILITIES

1961
PROPOSED & EXISTING
EXISTING



