

NO. OF COPIES RECEIVED	
DISTRIBUTION	
SANTA FE	1
FILE	1
U.S.G.S.	2
LAND OFFICE	
OPERATOR	1

NEW MEXICO OIL CONSERVATION COMMISSION

30-005-60656

Form C-101
Revised 1-1-66

5A. Indicate Type of Lease	
STATE <input type="checkbox"/>	FILE <input checked="" type="checkbox"/>
5. State Oil & Gas Lease No.	

APPLICATION FOR PERMIT TO DRILL, DEEPEN, OR PLUG BACK

1a. Type of Work		7. Unit Agreement No.	
b. Type of Well DRILL <input checked="" type="checkbox"/> DEEPEN <input type="checkbox"/> PLUG BACK <input type="checkbox"/> OIL WELL <input checked="" type="checkbox"/> GAS WELL <input type="checkbox"/> OTHER <input type="checkbox"/> SINGLE ZONE <input checked="" type="checkbox"/> MULTIPLE ZONE <input type="checkbox"/>		8. Name of Lessee Name J.P. White G	
c. Name of Operator Coronado Exploration Corp. ✓		9. Well No. #1	
3. Address of Operator 1005 Marquette NW Albuquerque, NM 87102		10. Field and Pool, or Wildcat X Wildcat	
4. Location of Well UNIT LETTER J LOCATED 1980 FEET FROM THE south LINE AND 1980 FEET FROM THE east LINE OF SEC. 26 TWP. 10S RGE. 28E N. 10W		11. County Chaves	
12. Proposed Depth 2800'		13A. Formation San Andres	
13B. Kind & Status Plug. Bond Statewide		14. Kind of C.T. Cable Tool	
21. Blowout (State whether DP, KI, etc.) 3822.2 Gr		21B. Drilling Contractor Cortez Drilling Co.	
22. Approx. Date Work will start February 18, 1980			

PROPOSED CASING AND CEMENT PROGRAM

SIZE OF HOLE	SIZE OF CASING	WEIGHT PER FOOT	SETTING DEPTH	SACKS OF CEMENT	EST. TOP
10"	8 5/8"	20	400	85	Circ.
8"	4 1/2"	9.5	2800	145	2000'

We propose to:

Drill a 10" hole and set 8 5/8" casing to 400'; circulate cement to surface; WOC 12 hrs. Test hole for fluid entry. If bailed dry commence drilling an 8" hole to 2800'. Run DLL with Microlaterolog; GR-CNL-D. Set 4 1/2" casing, to either TD or above P1 zone depending on the outcome of the logs. In latter case open hole completion will be attempted, in former case casing will be perforated.

APPROVAL VAND
FOR 90 DAYS UNLESS
DRILLING COMMENCED,

EXPIRES 5-18-80

IN ABOVE SPACE DESCRIBE PROPOSED PROGRAM: IF PROPOSAL IS TO DEEPEN OR PLUG BACK, GIVE DATA ON PRESENT PRODUCTIVE ZONE AND PROPOSED NEW PRODUCTIVE ZONE. GIVE BLOWOUT PREVENTER PROGRAM, IF ANY.

I hereby certify that the information above is true and complete to the best of my knowledge and belief.

Signed BY: W.A. Gussert Title ENGINEER Date FEBRUARY 11, 1980

(This space for State Use)

APPROVED BY W.A. Gussert TITLE SUPERVISOR, DISTRICT II DATE FEB 18 1980

CONDITIONS OF APPROVAL, IF ANY:

Minimum W.C.C. time 18 hrs. or refer to Rule 107 option 2

**NEW MEXICO OIL CONSERVATION COMMISSION
WELL LOCATION AND ACREAGE DEDICATION PLAT**

Form O-102
Supersedes O-128
Effective 1-1-65

All distances must be from the outer boundaries of the Section

Project Coronado Exploration			Lease J. P. White "G"		Well No. 1
Section J	Center 26	Township 10 South	Range 28 East	County Chaves	
A well is located on the South line and East line and					
1980 feet from the South line and		1980 feet from the East line			
Ground Level Elev 3822.2	Producing Formation San Andres	Well Wildcat	Estimated Acreage 40 Acres		

1. Outline the acreage dedicated to the subject well by colored pencil or hachure marks on the plat below.
2. If more than one lease is dedicated to the well, outline each and identify the ownership thereof (both as to working interest and royalty).
3. If more than one lease of different ownership is dedicated to the well, have the interests of all owners been consolidated by communitization, unitization, force-pooling, etc?

☒ Yes ☐ No If answer is "yes," type of consolidation **unitization**

If answer is "no," list the owners and tract descriptions which have actually been consolidated. (Use reverse side of this form if necessary) _____

No allowable will be assigned to the well until all interests have been consolidated (by communitization, unitization, forced-pooling, or otherwise) or until a non-standard unit, eliminating such interests, has been approved by the Commission.

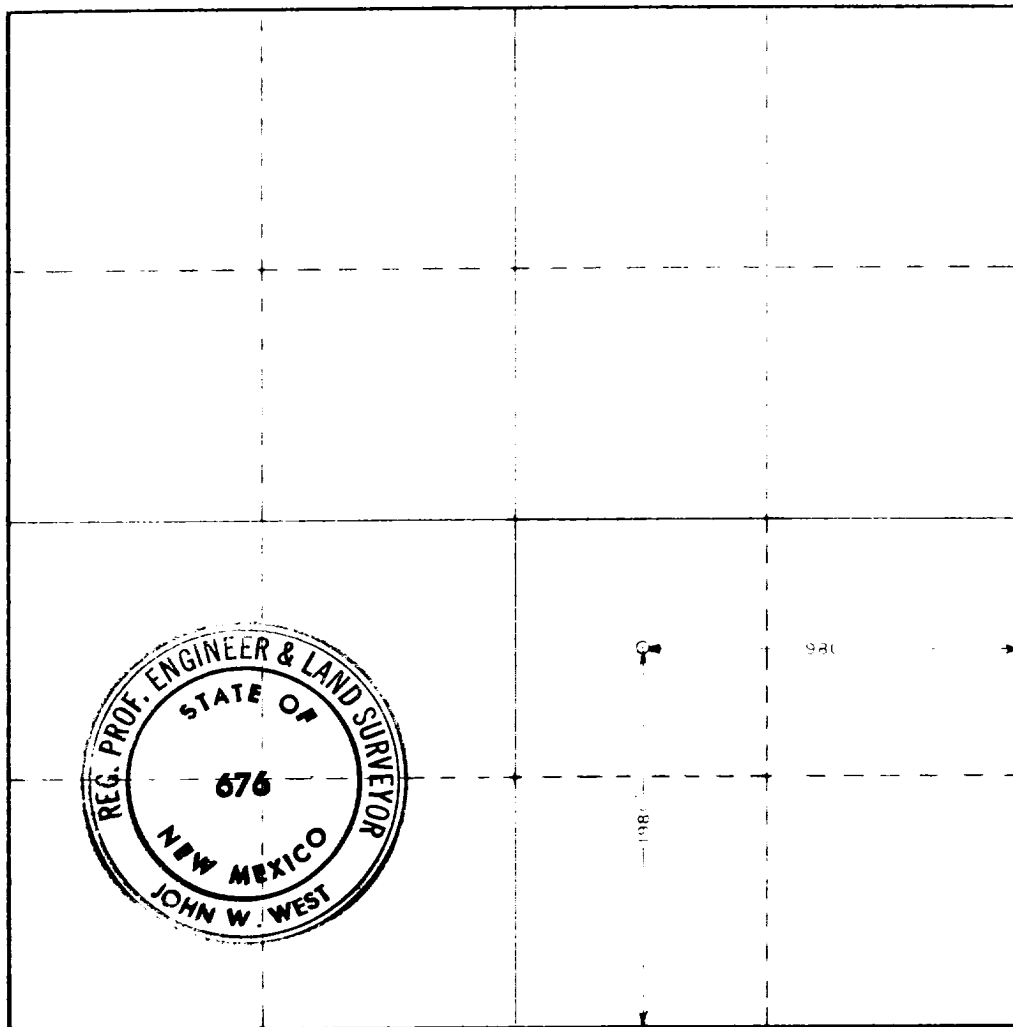

CERTIFICATION

I hereby certify that the information contained herein is true and complete to the best of my knowledge and belief

[Signature]
Phelps White

Position
Engineer

Company
Coronado Exploration Corp.

Date
February 11, 1980

I hereby certify that the well location shown on this plat was plotted from field notes of actual surveys made by me or under my supervision, and that the same is true and correct to the best of my knowledge and belief.

Date Surveyed
January 31, 1979

Registered Professional Engineer
and/or Land Surveyor

[Signature]
Certificate No. **John W. West**

676
Ronald J. Fidant 3230

