

NO. OF COPIES RECEIVED	
DISTRIBUTION	
AMOUNT	1
FILE	1
U.S.G.S.	2
LAND OFFICE	
OPERATOR	1

NEW MEXICO OIL CONSERVATION COMMISSION

30-005-60658

Form C-101
Revised 1-1-65

FEB 12 1980

O. C. D.
ARTESIA, OFFICE

5A. Indicate Type of Lease STATE <input type="checkbox"/> FEE <input checked="" type="checkbox"/>
5. State Oil & Gas Lease No.
7. Unit Agreement Name
8. Farm or Lease Name O'Brien "I"
9. Well No. 4
10. Field and Pool, or Wildcat Assoc. Twin Lakes-San Andres
12. County Chaves
19. Proposed Depth 2780'
19A. Formation San Andres
20. Rotary or C.T. Rotary
21. Elevations (Show whether DF, RT, etc.) 3974.0 Gr., 3980.0 KB
21A. Kind & Status Plug. Bond Statewide
21B. Drilling Contractor Fred Pool
22. Approx. Date Work will start 3-3-80

APPLICATION FOR PERMIT TO DRILL, DEEPEN, OR PLUG BACK

1a. Type of Work b. Type of Well OIL WELL <input checked="" type="checkbox"/> GAS WELL <input type="checkbox"/> OTHER <input type="checkbox"/> 2. Name of Operator STEVENS OIL COMPANY 3. Address of Operator P. O. Box 2203 - Roswell, New Mexico 88201 4. Location of Well UNIT LETTER C LOCATED 990 FEET FROM THE North LINE AND 1650 FEET FROM THE West LINE OF SEC. 31 TWP. 8-S RGE. 29-E NMPM	5. State Oil & Gas Lease No.	6. Farm or Lease Name O'Brien "I"	7. Unit Agreement Name	8. Field and Pool, or Wildcat Assoc. Twin Lakes-San Andres	9. County Chaves	10. Proposed Depth 2780'	10A. Formation San Andres	10B. Rotary or C.T. Rotary	11. Elevations (Show whether DF, RT, etc.) 3974.0 Gr., 3980.0 KB	11A. Kind & Status Plug. Bond Statewide	11B. Drilling Contractor Fred Pool	11C. Approx. Date Work will start 3-3-80
--	------------------------------	--------------------------------------	------------------------	---	---------------------	-----------------------------	------------------------------	-------------------------------	---	--	---------------------------------------	---

PROPOSED CASING AND CEMENT PROGRAM

SIZE OF HOLE	SIZE OF CASING	WEIGHT PER FOOT	SETTING DEPTH	SACKS OF CEMENT	EST. TOP
12-1/2"	8-5/8"	24#	100'	75 sxs.	
7-7/8"	4-1/2"	9.5#	2780'	225 sxs.	

Will drill with water & mud to T.D., log, and if indicated productive, case to T.D. & perforate in producing interval.

Adequate blowout preventers will be used.

EXPIRES 5-18-80

IN ABOVE SPACE DESCRIBE PROPOSED PROGRAM: IF PROPOSAL IS TO DEEPEN OR PLUG BACK, GIVE DATA ON PRESENT PRODUCTIVE ZONE AND PROPOSED NEW PRODUCTIVE ZONE. GIVE BLOWOUT PREVENTER PROGRAM, IF ANY.

I hereby certify that the information above is true and complete to the best of my knowledge and belief.

Signed [Signature] Title Owner Date 02-11-80

(This space for State Use)

APPROVED BY [Signature] TITLE SUPERVISOR, DISTRICT II DATE FEB 18 1980

CONDITIONS OF APPROVAL, IF ANY:

NEW MEXICO OIL CONSERVATION COMMISSION
WELL LOCATION AND ACREAGE DEDICATION FORM

Form 7-10,
Supersedes 6-128
Effective 1-1-78

All distances must be from the outer boundaries of the Section

Operator Stevens Oil Co.			Lease O'Brien "I"		Section 4
Section C	Section 31	Section 8 South	Section 29 East	County Chaves	
Actual Well Location of Well: 990 feet from the North line and 1650 feet from the West line					
Ground Level Elev. 3974.0	Producing Formation San Andres	Pool Twin Lakes-San Andres Assoc.		Dedicated Acreage: 40 Acres	

1. Outline the acreage dedicated to the subject well by colored pencil or hachures on the plat below.
2. If more than one lease is dedicated to the well, outline each and identify the ownership thereof (both as to working interest and royalty).
3. If more than one lease of different ownership is dedicated to the well, have all interests of all owners been consolidated by communitization, unitization, force-pooling, etc?

RECEIVED

FEB 12 1980

ARTESIA, OFFICE

☐ Yes ☐ No If answer is "yes," type of consolidation _____

If answer is "no," list the owners and tract descriptions which have actually been consolidated. (Use reverse side of this form if necessary.) _____

No allowable will be assigned to the well until all interests have been consolidated (by communitization, unitization, forced-pooling, or otherwise) or until a non-standard unit, eliminating such interests, has been approved by the Commission.

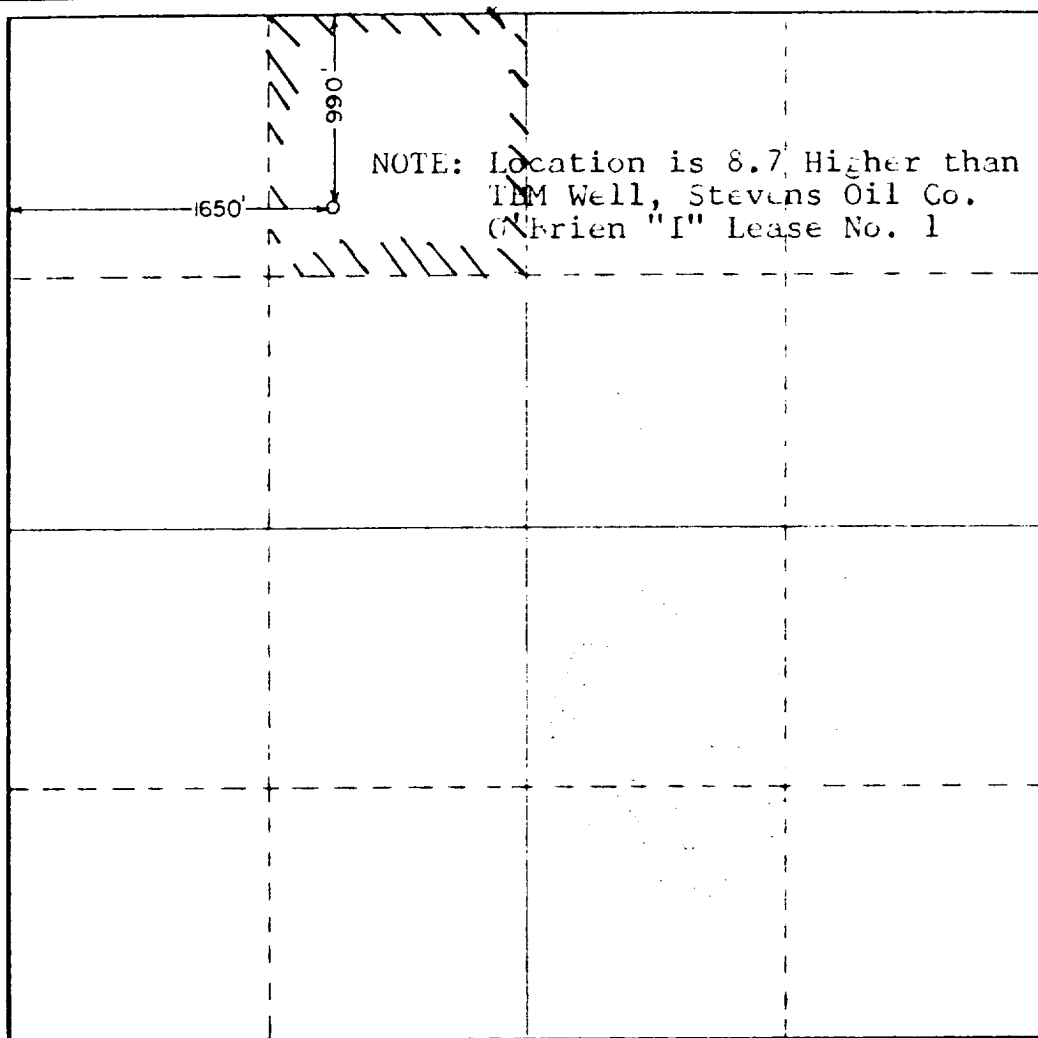

CERTIFICATION

I hereby certify that the information contained herein is true and complete to the best of my knowledge and belief.

[Signature]

Owner

STEVENS OIL COMPANY

February 4, 1980

I hereby certify that the well location shown on this plat was plotted from field notes of actual surveys made by me or under my supervision and that the same is true and correct to the best of my knowledge and belief.

Date Surveyed

February 1, 1980

Registered Professional Engineer
Professional Surveyor

[Signature]

Certificate No. **JOHN W. WEST 676**
PATRICK A. ROMERO 6688
Ronald J. Eidson 3239

0 330 660 990 1320 1650 1980 2310 2640 2970 3300 3630 3960 4290 4620 4950 5280 5610 5940 6270 6600