

NO. OF COPIES RECEIVED	
DISTRIBUTION	
ALTA FE	1
FILE	1
U.S.G.S.	2
LAND OFFICE	
OPERATOR	1

NEW MEXICO OIL CONSERVATION COMMISSION

FEB 14 1980

ARTESIA, OFFICE

30-005-60659

Form C-101  
Revised 1-1-65

5A. Indicate Type of Lease

STATE ☐ FEE ☒

5. State Oil & Gas Lease No.

APPLICATION FOR PERMIT TO DRILL, DEEPEN, OR PLUG BACK

1a. Type of Work		7. Unit Agreement Name	
b. Type of Well OIL WELL <input checked="" type="checkbox"/> GAS WELL <input type="checkbox"/> OTHER <input type="checkbox"/> DRILL <input checked="" type="checkbox"/> DEEPEN <input type="checkbox"/> PLUG BACK <input type="checkbox"/>		8. Farm or Lease Name O'Brien "E"	
2. Name of Operator STEVENS OIL COMPANY		9. Well No. 3	
3. Address of Operator P. O. Box 2203 - Roswell, New Mexico 88201		10. Field and Pool, or Wildcat ASSOC. Twin Lakes-San Andres	
4. Location of Well UNIT LETTER O LOCATED 990 FEET FROM THE South LINE AND 2310 FEET FROM THE East LINE OF SEC. 1 TWP. 9-S RGE. 28-E NMPM		12. County Chaves	
19. Proposed Depth 2800'		19A. Formation San Andres	
20. Rotary or C.T. Rotary		21. Elevations (Show whether DF, RT, etc.) 3953.9 Gr., 3959.9 K.B.	
21A. Kind & Status Plug. Bond Statewide		21B. Drilling Contractor Fred Pool	
22. Approx. Date Work will start 3-10-80			

23.

PROPOSED CASING AND CEMENT PROGRAM

SIZE OF HOLE	SIZE OF CASING	WEIGHT PER FOOT	SETTING DEPTH	SACKS OF CEMENT	EST. TOP
12-1/2"	8-5/8"	24#	120'	75 sx.	
7-7/8"	4-1/2"	9.5#	2800'	225 sx.	

Will drill with water & mud to T.D., log, and if indicated productive, case to T.D. & perforate in producing interval.

Adequate blowout preventers will be used.

APPROVAL VALID  
FOR 90 DAYS UNLESS  
DRILLING COMMENCED,

EXPIRES 5-18-80

IN ABOVE SPACE DESCRIBE PROPOSED PROGRAM: IF PROPOSAL IS TO DEEPEN OR PLUG BACK, GIVE DATA ON PRESENT PRODUCTIVE ZONE AND PROPOSED NEW PRODUCTIVE ZONE. GIVE BLOWOUT PREVENTER PROGRAM, IF ANY.

I hereby certify that the information above is true and complete to the best of my knowledge and belief.

Signed W. A. Gressett Title Owner Date 2-13-80

(This space for State Use)

APPROVED BY W. A. Gressett TITLE SUPERVISOR, DISTRICT II DATE FEB 18 1980

CONDITIONS OF APPROVAL, IF ANY:

NEW MEXICO OIL CONSERVATION COMMISSION  
WELL LOCATION AND ACREAGE DEDICATION AT

Form No. 1  
Adopted by the Commission  
March 1978

All distances must be from the outer boundaries of the Section

Stevens Oil Co.

O'Brien E

3

Q

1

9 South

20 East

Chaves

990

South

2310

East

3953.9

San Andres

Twin Lakes-San Andres Assoc.

40

- Outline the acreage dedicated to the subject well by colored pencil or hatchure marks on the plat below.
- If more than one lease is dedicated to the well, outline each and identify the ownership thereof (both as to working interest and royalty).
- If more than one lease of different ownership is dedicated to the well, have the interests of all owners been consolidated by communitization, unitization, force-pooling, etc?

☐ Yes ☐ No If answer is "yes," type of consolidation \_\_\_\_\_

If answer is "no," list the owners and tract descriptions which have actually been consolidated (Use reverse side of this form if necessary.) \_\_\_\_\_

No allowable will be assigned to the well until all interests have been consolidated (by communitization, unitization, force-pooling, or otherwise) or until a non-standard unit, eliminating such interests, has been approved by the Commission.

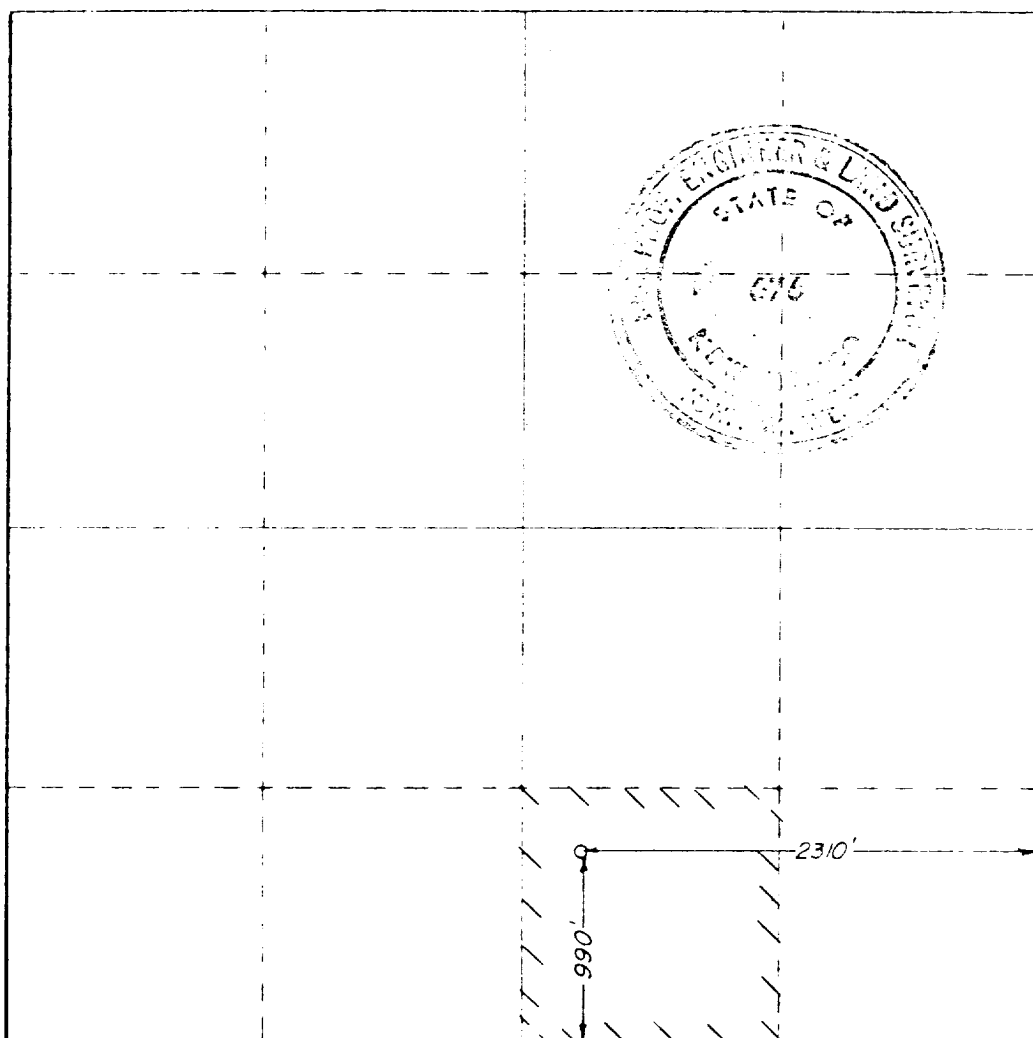

CERTIFICATION

I hereby certify that the information contained herein is true and complete to the best of my knowledge and belief.

*Reginald J. Eidson*

Owner

STEVENS OIL COMPANY

2-13-80

I hereby certify that the well location shown on this plat was plotted from field notes of actual surveys made by me or under my supervision, and that the same is true and correct to the best of my knowledge and belief.

February 11, 1980

Registered Professional Engineer and Land Surveyor

*John W. West*

Certificate No. JOHN W. WEST 676  
PATRICK A. ROMERO 8863  
Reginald J. Eidson 3239